

2267 ORCHARD LAKE ROAD
SYLVAN LAKE, MICHIGAN

RETAIL FOR SALE OR LEASE
2,573 Square Feet Available



**SIGNATURE
ASSOCIATES**
KNOW SIGNATURE | KNOW RESULTS



PROPERTY FEATURES

- 2,573 square feet available
- Dry cleaners building on busy Orchard Lake Road
- Ideal for owner/user, new business opportunity or development
- 10 parking spaces
- Building signage available
- Do not approach current tenant
- Available January 2025
- Lease Rate: \$15.00/sq. ft. NNN
- Sale Price: \$399,00 (\$155.07/sq. ft.)



For more information, please contact:

MARVIN PETROUS
(248) 359 0647
mpetrous@signatureassociates.com

CHRIS SECONTINE
(248) 799 3174
csecontine@signatureassociates.com

SIGNATURE ASSOCIATES
One Towne Square, Suite 1200
Southfield, MI 48076
www.signatureassociates.com

2267 Orchard Lake Road – Sylvan Lake, Michigan

Retail For Sale or Lease

2,573
Square Feet
AVAILABLE



DEMOGRAPHICS

	POPULATION	MED. HH INCOME
1 MILE	6,524	\$93,600
3 MILE	55,352	\$104,281
5 MILE	163,551	\$99,949

TRAFFIC COUNTS (TWO-WAY)

40,887	Orchard Lake Rd. NE. of Middlebelt Rd.
37,696	Orchard Lake Rd. SW. of Middlebelt Rd.
15,859	Middlebelt Rd. S. of Orchard Lake Rd.

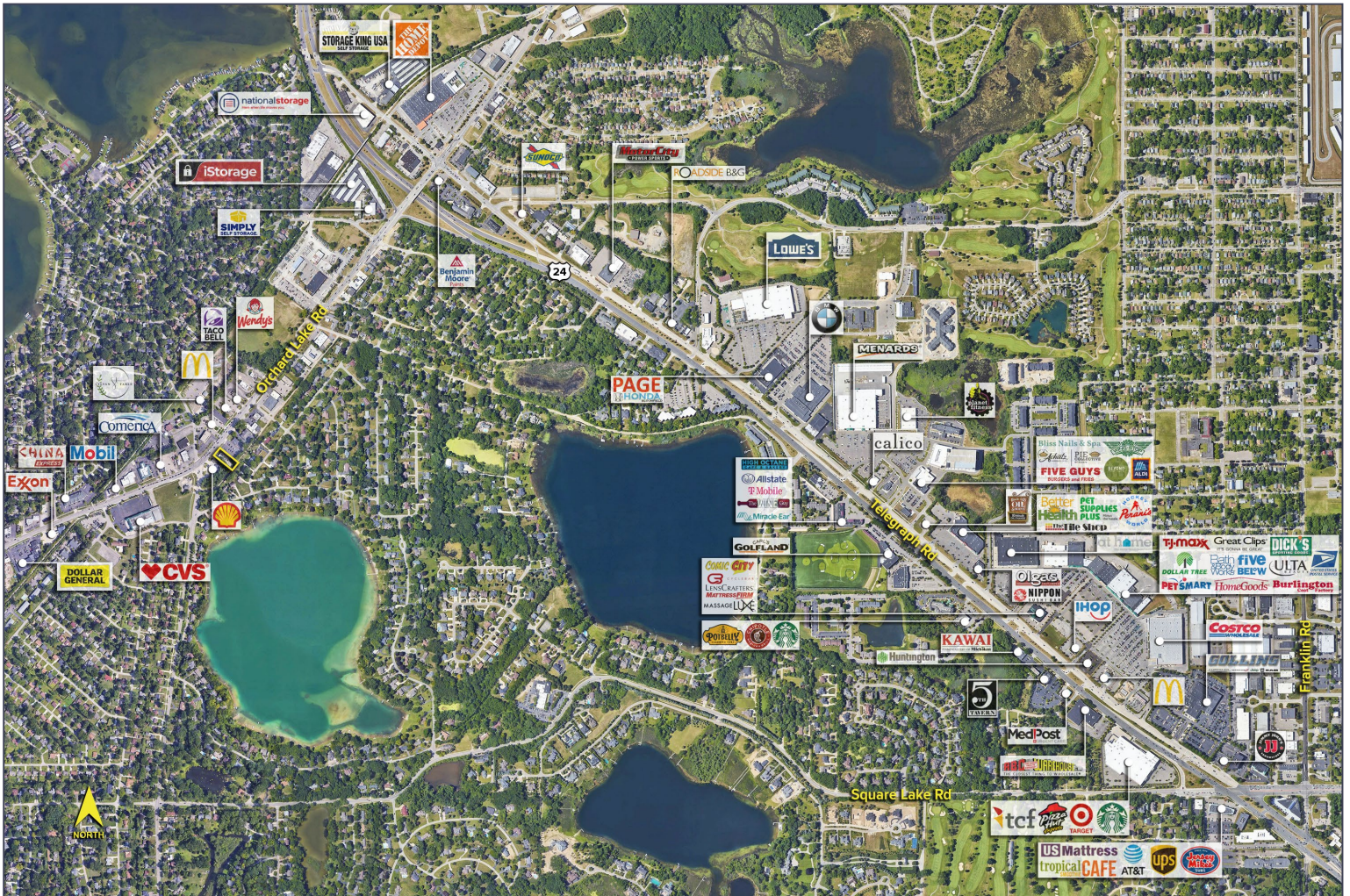

For more information, please contact:

MARVIN PETROUS
(248) 359 0647
mpetrous@signatureassociates.com

CHRIS SECONTINE
(248) 799 3174
csecontine@signatureassociates.com

SIGNATURE ASSOCIATES
One Towne Square, Suite 1200
Southfield, MI 48076
www.signatureassociates.com

2267 Orchard Lake Road – Sylvan Lake, Michigan

Retail For Sale or Lease

2,573
Square Feet
AVAILABLE

Site Plan

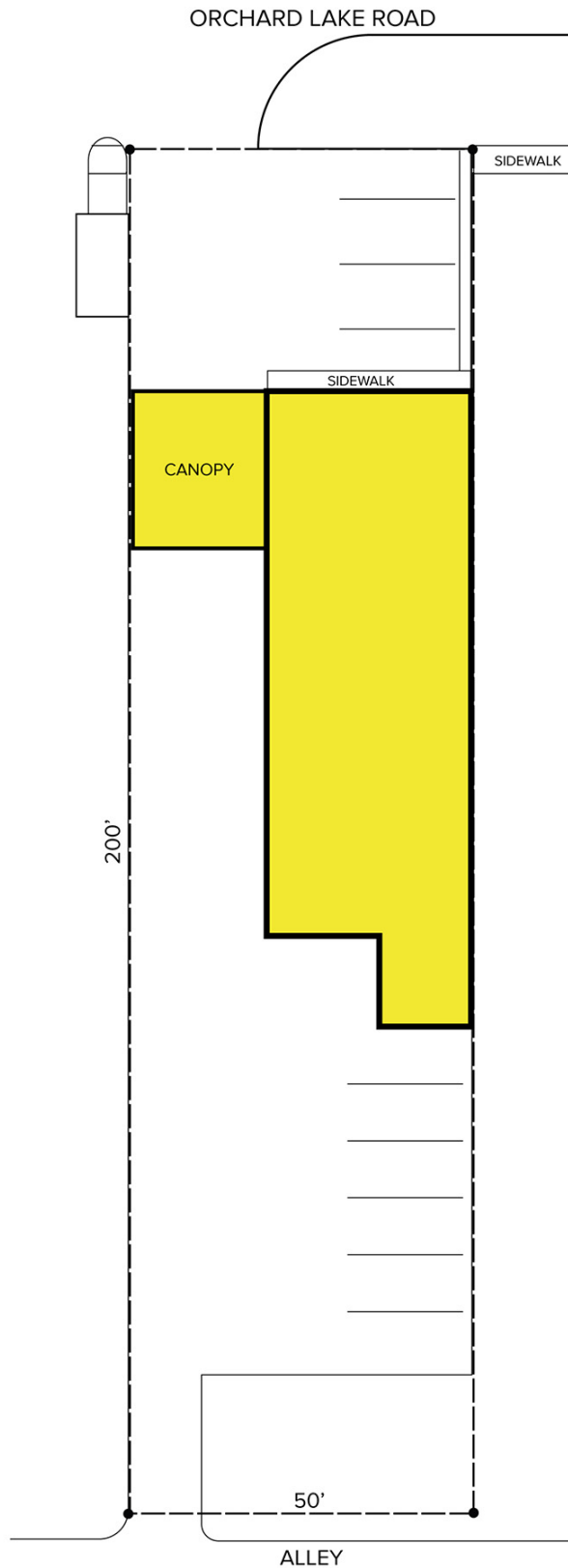

For more information, please contact:

MARVIN PETROUS
(248) 359 0647
mpetrous@signatureassociates.com

CHRIS SECONTINE
(248) 799 3174
csecontine@signatureassociates.com

SIGNATURE ASSOCIATES
One Towne Square, Suite 1200
Southfield, MI 48076
www.signatureassociates.com