

# For Lease Unit D +/-13,916 SF

1275 HALL AVE., RICHMOND, CA 94804



## Marina Center Business Park

1275 Hall Ave. is part of the Marina Center, an expanding Flex/Light Industrial business park located in the historic Richmond Harbor.

The Marina Center is adjacent to the San Francisco Bay Trail and within walking distance to restaurants, Red & White Ferry, and has an on-site AC Bus Stop.

## Unit D Specs

- +/-13,916 SF
- 1 Grade Door 12'x12'
- +/- 18'-24' Clear Height
- Fire Sprinklers
- End Unit
- Bow Truss Roof with Skylights
- One Bath & Small Office
- On-site Bus Stop for AC Line #74
- Asking Lease Rate \$1.40 PSF I.G.

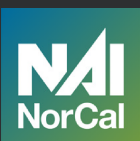

**Dante Guazzo**  
NAINORCAL.COM

**Dante Guazzo**  
Vice President  
dguazzo@nainorcal.com  
510.336.4714  
CalDRE #01301236

## Additional Photos



## Location Information



## For More Information

**Dante Guazzo**  
Vice President  
dguazzo@nainorcal.com  
510.336.4714  
CalDRE #01301236

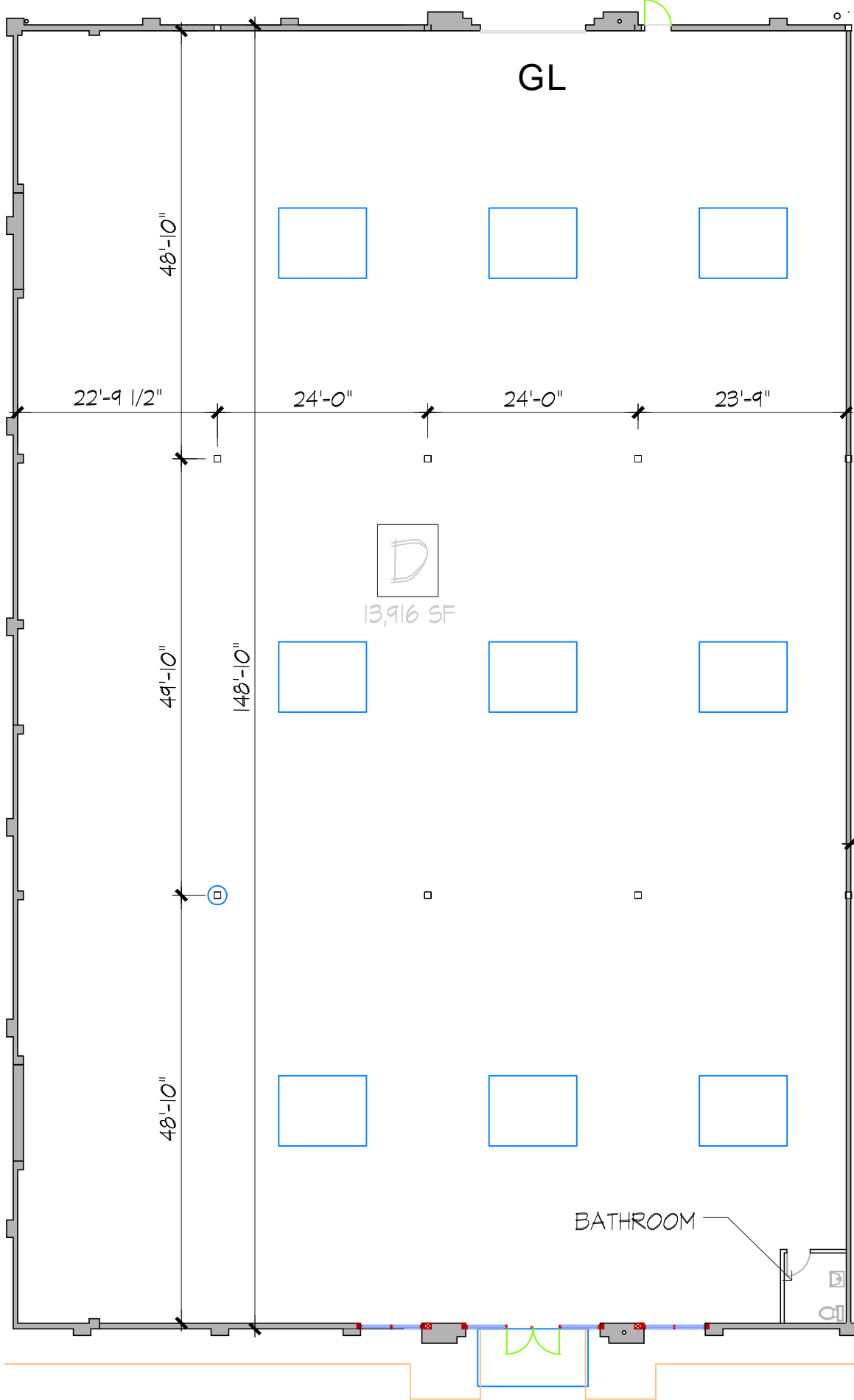

GL

22'-9 1/2"

24'-0"

24'-0"

23'-9"

48'-10"

49'-10"

48'-10"

148'-10"

13,916 SF

D

BATHROOM