

Address: 5360 W LAKE RD

Owner: CALABRESE JOHN A UX DOREEN M

Parcel: 33023120001400

Parcel Profile

Address 5360 | W | LAKE | RD

Street Status PAVED

School District MILLCREEK SCHOOL

Acreage 0.3995

Classification C

Land Use Code RESTAURANTS, STORES (RETAIL)

Legal Description 5360 W LAKE RD 121.62 X 152.39

Square Feet 3506

Topo LEVEL

Utility ALL PUBLIC

Zoning Please contact your municipal zoning officer

Deed Book 0009

Deed Page 0062

2024 Tax Values

Land Value / Taxable 43,500 / 43,500.00

Building Value / Taxable 102,200 / 102,200.00

Total Value / Taxable 145,700 / 145,700.00

Clean & Green Inactive

Homestead Status Inactive

Farmstead Status Inactive

Lerta Amount 0

Lerta Expiration Year 0

Commercial Data

Card 1 RETAIL MULTI OCCUP

Business Living Area - 3506

Year Built - 1970

Improvement Name - LAKE SHORE CLEANERS

Value - 90230

Other Buildings & Yards

Description	Built	Width	Length	Area
PAVING ASPHALT PARKING	1970	0	0	10000
FRAME UTILITY SHED	2003	12	24	288

Sales History

Sale Date	From	To	Type	Price	Book / Page	Other Info
5/7/1987				0	0009 / 0062	

Parcel Sketches

Commercial Card 1

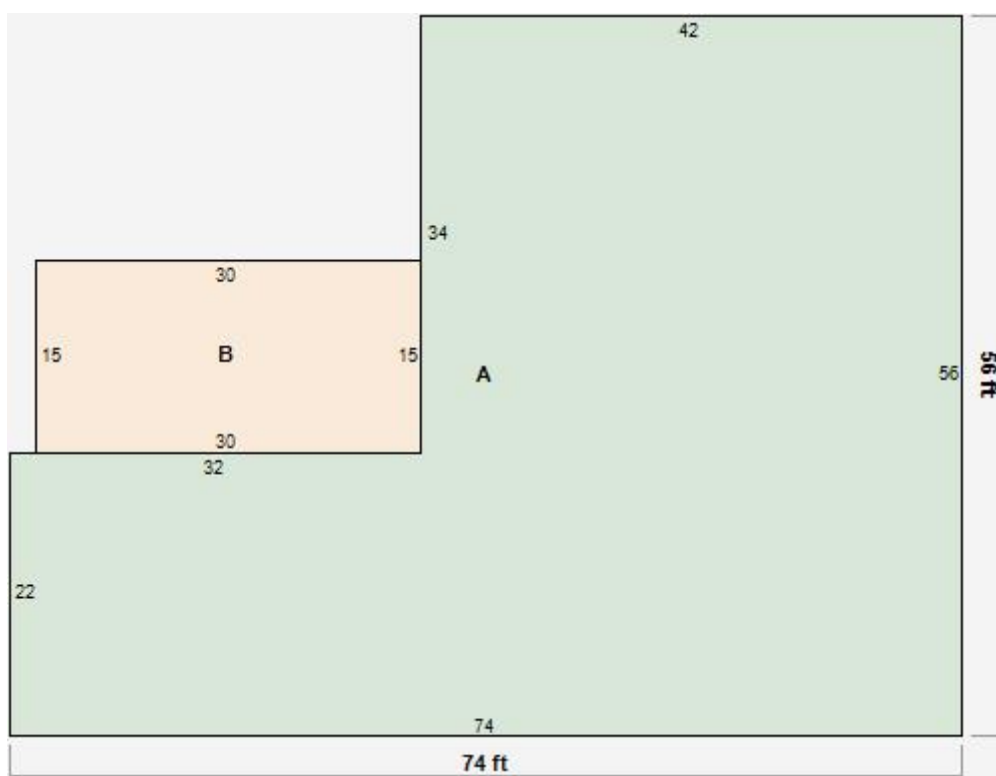

- A** MAIN
- B** MAIN

3056 square feet
450 square feet

Parcel Images



Annual Taxes

Attention City of Erie Residents

Please be advised that due to the recent change in the billing cycle for the City of Erie school taxes, the total for Year 2012 (school tax column) will now include the total amounts for both the 2011-12 AND the 2012-13 tax years.

Year	County	City/Township	School	Library	Total
2024	963.08	612.48	2370.45	0	3946.01
2023	868.37	576.05	2323.97	0	3768.39
2022	868.37	517.77	2236.74	0	3622.88
2021	868.37	517.77	2150.72	0	3536.86
2020	831.95	517.77	2112.69	0	3462.41
2019	831.95	517.77	2112.69	0	3462.41
2018	788.24	517.77	2055.16	0	3361.17
2017	788.24	517.77	2014.86	0	3320.87
2016	751.81	517.77	2007.57	0	3277.15
2015	718.30	517.77	1978.88	0	3214.95
2014	718.30	517.77	1934.40	0	3170.47
2013	718.30	372.07	1846.02	0	2936.39
2012	550.55	269.31	1354.08	0	2173.94
2011	550.55	223.81	1354.08	0	2128.44
2010	550.55	223.81	1331.33	0	2105.69
2009	495.95	223.81	1286.74	0	2006.50
2008	473.20	223.81	1286.74	0	1983.75
2007	450.45	223.81	1286.74	0	1961.00
2006	450.45	223.81	1286.74	0	1961.00
2005	425.88	223.81	1253.07	0	1902.76
2004	425.88	232.03	1193.92	0	1851.83

2003

418.60

232.03

1136.59

0

1787.22

Delinquent Taxes

No Delinquent Taxes

Owner Info

PARCEL ID: 33-023-120.0-014.00

OWNER 1: CALABRESE JOHN A UX DOREEN M

OWNER 2:

ADDRESS 1: 5360 W LAKE RD

ADDRESS 2:

ADDRESS 3:

CITY: ERIE

STATE: PA

ZIP 1: 16505

ZIP 2: 2842

LEGAL 1: 5360 W LAKE RD 121.62 X 152.39

LEGAL 2:

LEGAL 3: