

P:\Retail Asset Management Site plans\SR 60 & St. Cloud - Hillsborough Co. 20-0075.mkt\site plans\20-0075.001 sp-1.dwg Plotted: May 13, 2020 - 2:54pm by jbrown

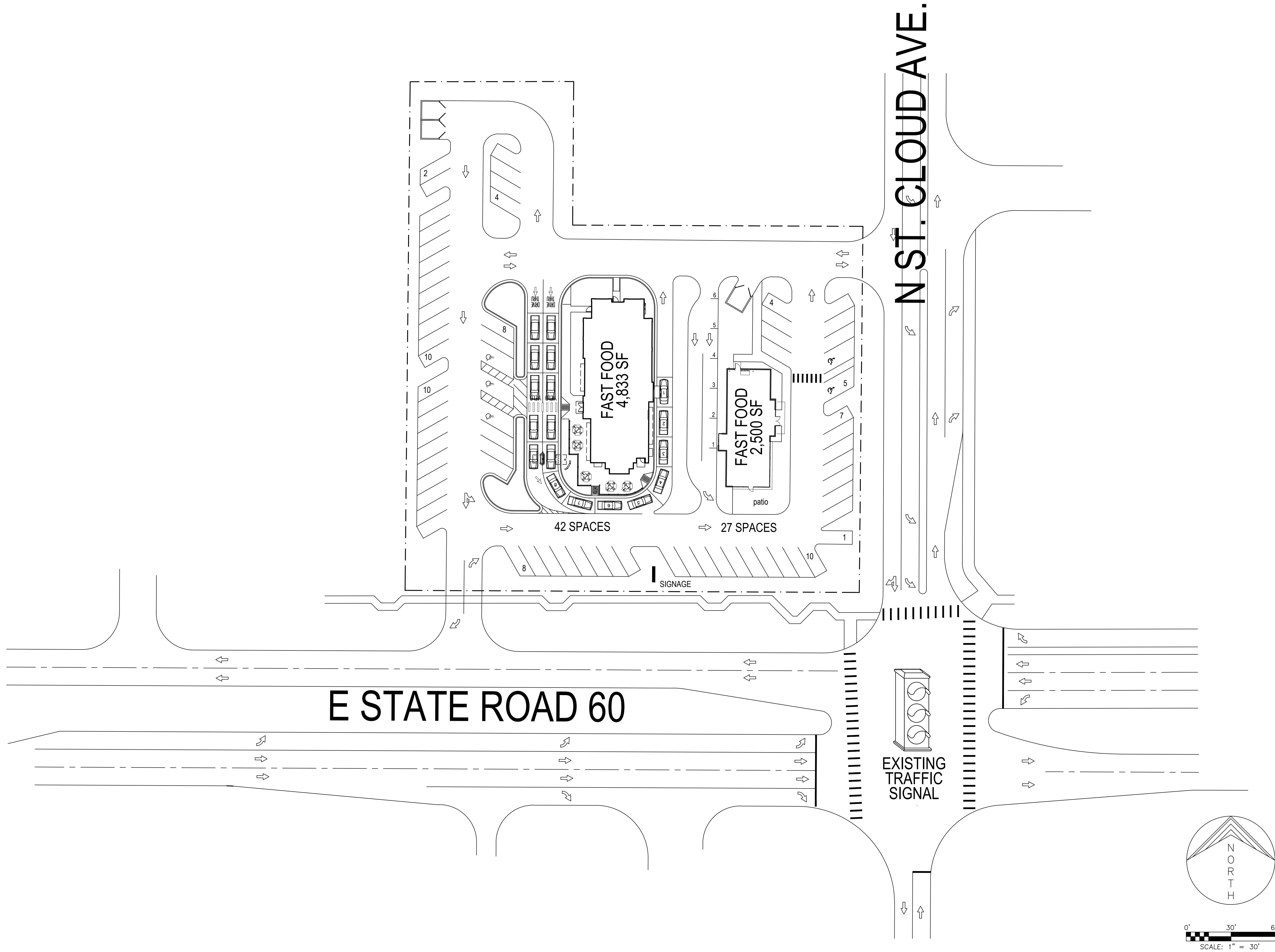

REVISIONS	BY

KPMFranklin
 ENGINEERS • PLANNERS • SURVEYORS
 6300 HAZELTINE NATIONAL DRIVE, STE. 118
 ORLANDO, FL 32822 | PHONE (407) 410-8624
 CERTIFICATE OF AUTHORIZATION: 32058

WARNING
 IF THIS SCALE DOES NOT MEASURE THIS COPY OF THIS DOCUMENT IS NOT TO SCALE

JAMES D. BROWN, RLA
 FLORIDA #001508

Retail @ S.R. 60 & N. St. Cloud
 Hillsborough County, Florida
 Retail Asset Management, Inc.
 P.O. Box 5666
 Clearwater, Florida 33758-5666

DRAWN:	JDB
CHECKED:	JDB
DATE:	5/13/20
SCALE:	1" = 30'
JOB No:	2-0075.mkt
SHEET:	SP-1

SITE PLAN