

FOR LEASE

2,054 SF Industrial Space

Eastridge Business Park, Bldg. C

12606 NE 95th St., Suite 120, Vancouver, WA 98682



Features of Suite 120:

- 799 SF Warehouse Area with Grade Door
- 1,255 SF Office Area -
3 Private Offices, Open Office Area,
1 Restroom and Kitchen Bar
- 12' Grade Door
- 14' Clear Height
- Well Maintained Property
- Ample Parking
- Easy Access to NE 117th Ave. (SR 503),
Padden Pkwy, NE Fourth Plain Blvd.,
SR 500 and I-205 Freeways

Rate:

\$2,900 per Month + NNN

Available with 30 days' notice.

For more information contact
Coleman Brown, CCIM
(360) 952-4758
Coleman@CCPprop.com



**Columbia
Commercial**
Commercial Leasing | Sales | Property Management

9120 NE Vancouver Mall Loop, Suite 266, Vancouver, WA 98662
www.CCPprop.com • (360) 735-8001

*The information contained herein has been obtained from sources we deem reliable.
We do not, however, guarantee its accuracy. All information should be verified prior to purchase or lease.*

Site Plan - 12606 NE 95th St.
Eastridge Business Park, Bldg. C

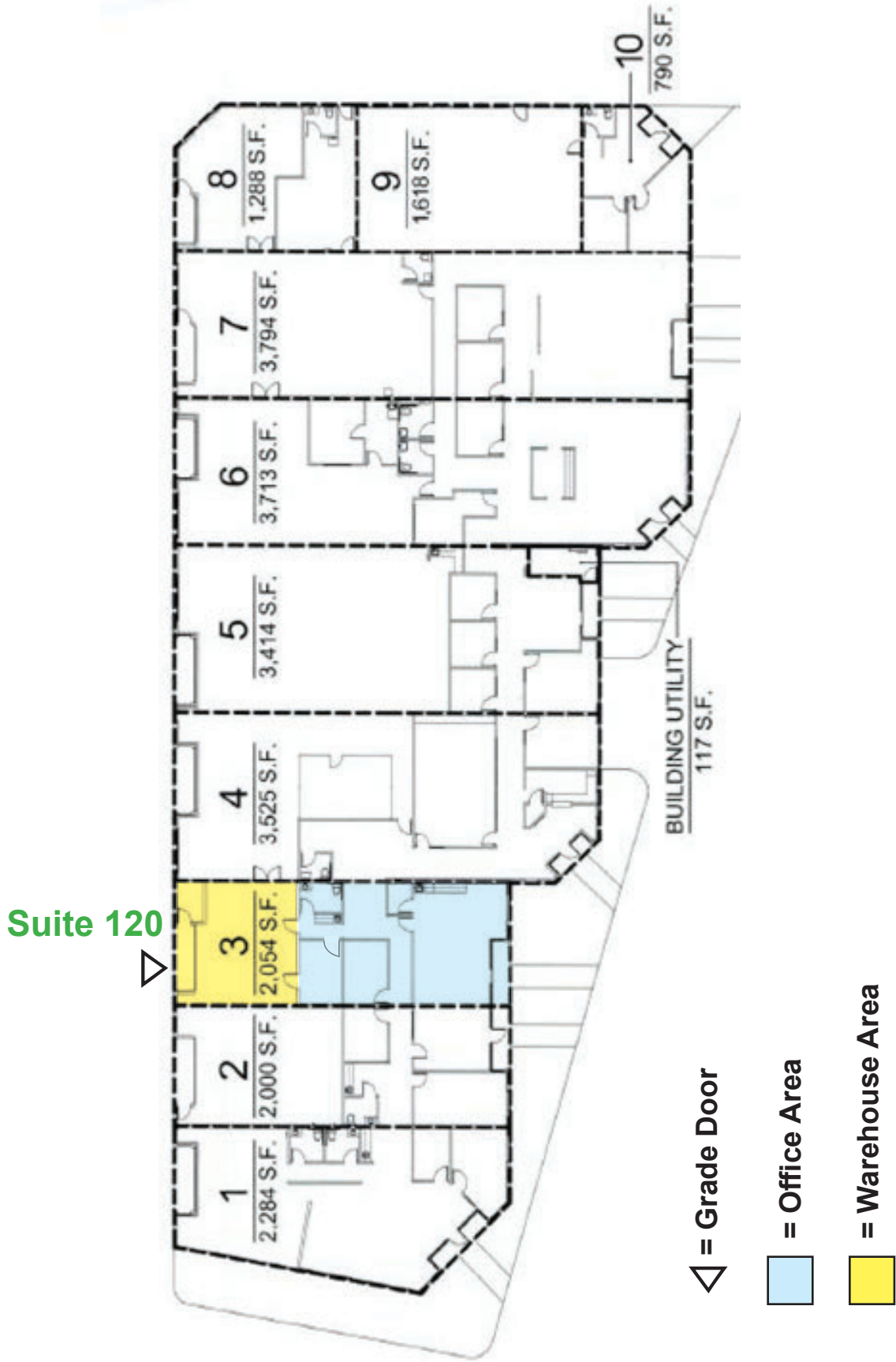

Suite 120

