

FOR LEASE

[View this property on our website](#)

Bohannon Commerce Center Building 5

6524 Lewis Lane, Louisville, KY 40272

COMING SOON!



PROPERTY FEATURES:

- + Q4 2025 Delivery
- + 181,800+/- SF (Divisible)
- + BTS office space
- + 15 (9' X10') dock doors
- + 2 (14' X 16') drive-in doors
- + 32' clear height
- + ESFR
- + 50' X 50' column spacing
- + LED lighting
- + 3,000 amp service
- + 129 car parking spaces
- + 61 trailer parking spaces
- + Zoned EZ-1
- + Contact agent for pricing



CBRE

BOHANNON COMMERCE CENTER | BUILDING 5
6524 LEWIS LANE, LOUISVILLE, KY

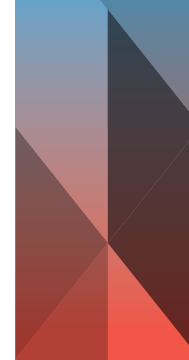

Property Specifications

Building Size	181,800+/- square feet	Dock Doors	15 (9' X 10')
Available Square Feet	181,800+/- square feet (Divisible)	Drive-In Doors	2 (14' X 16')
Site Size	21.46+/- acres	Slab	7" unreinforced
Building Dimensions	210' X 870'	Roof	45 mil TPO (R-24)
Fire Suppression	ESFR	Car Parking	129
Clear Height	32'	Power	3,000 amps
Column Spacing	50' X 50'	Office	BTS
Lighting	LED	Zoning	EZ-1
HVAC	60 degrees at 0 outside	Location	Riverport Submarket

Location Highlights



BOHANNON COMMERCE CENTER | BUILDING 5
6524 LEWIS LANE, LOUISVILLE, KY

SITE PLAN

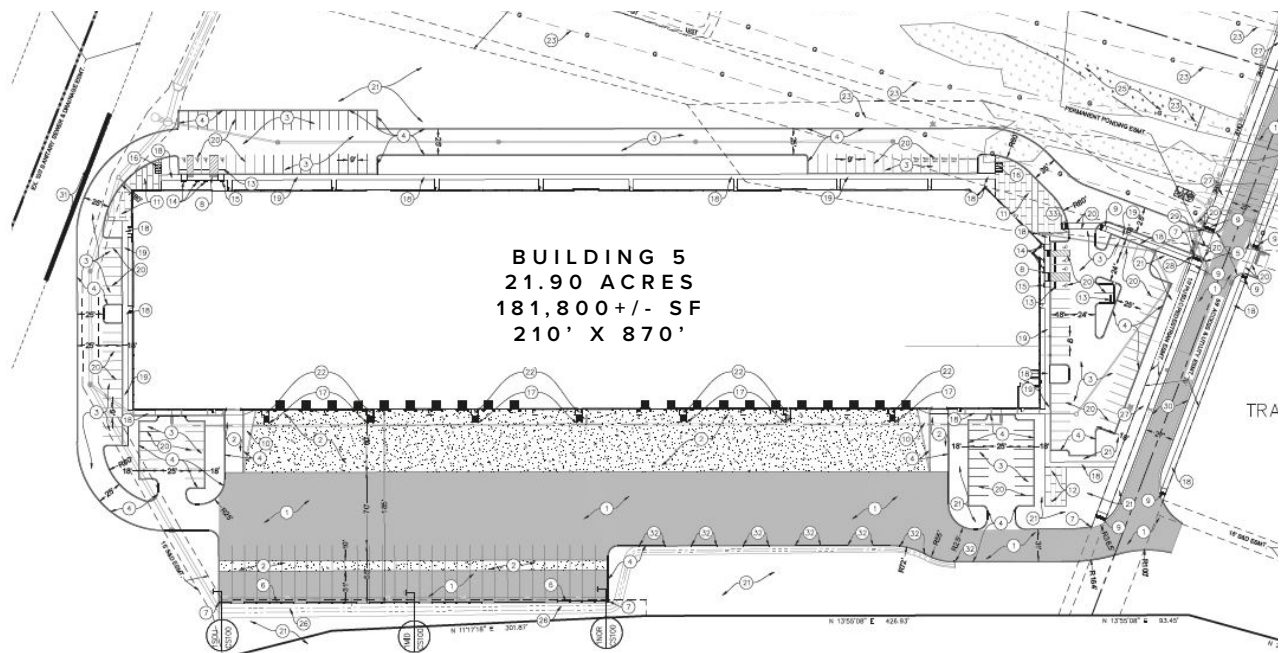
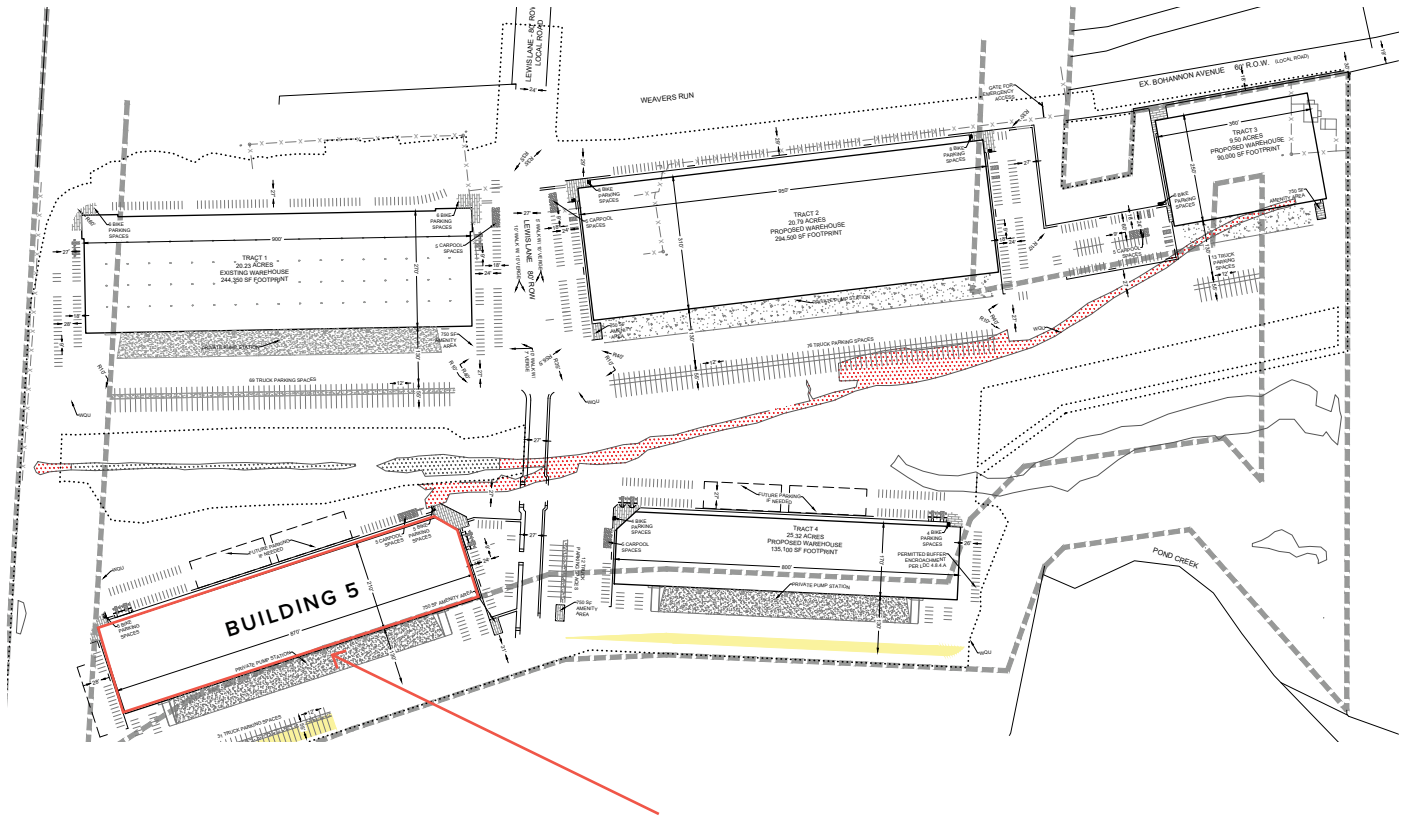
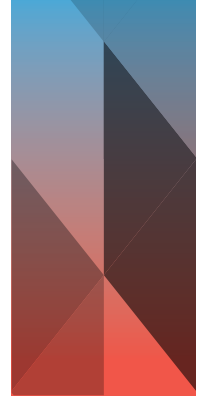

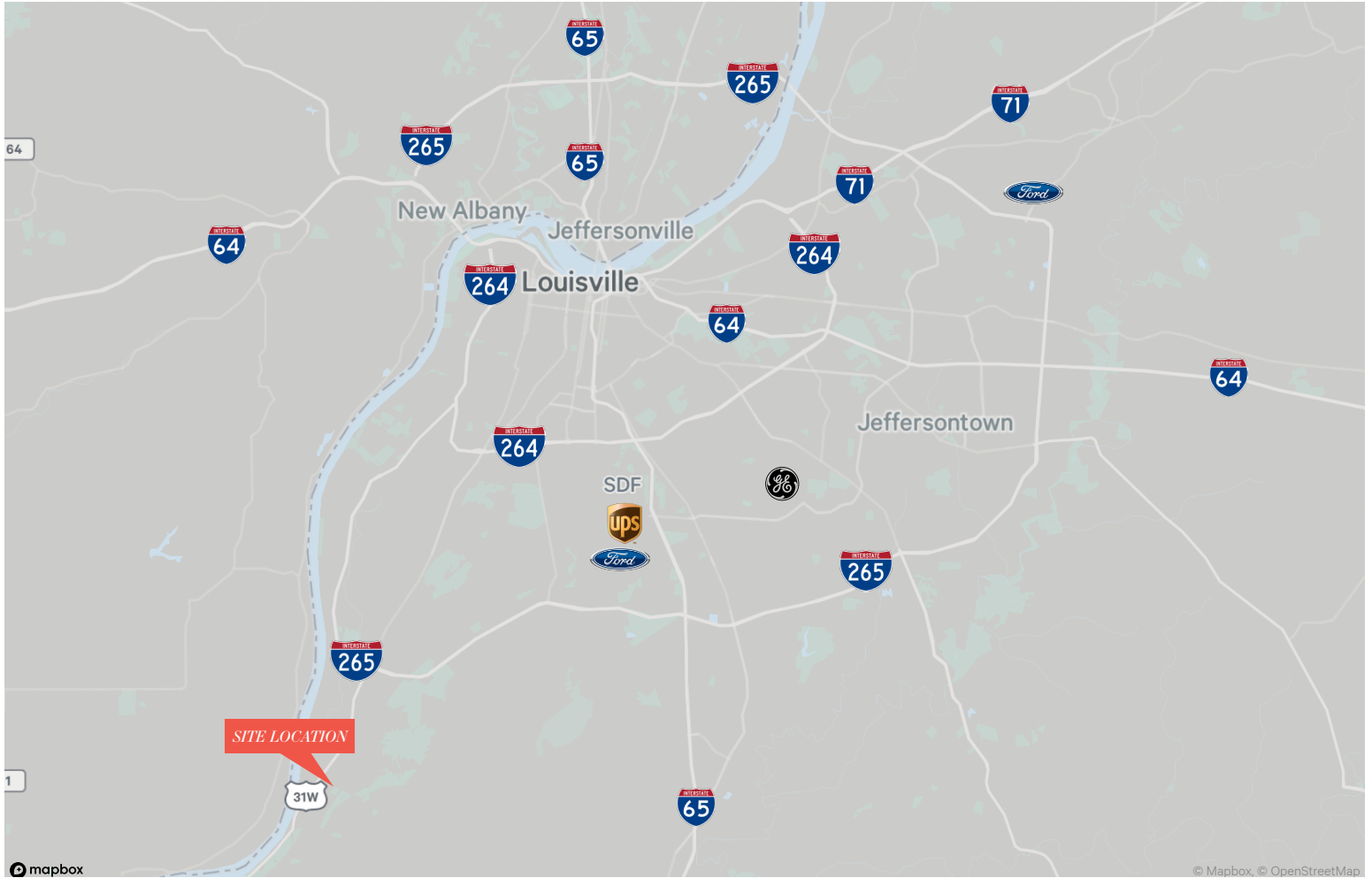

PLEASE CONTACT:

[View this property on our website](#)



Doug Butcher, SIOR
Executive Vice President
+1 502 412 7641
doug.butcher@cbre.com



Alex Grove
Senior Associate
+1 502 412 7655
alex.grove@cbre.com



© 2024 CBRE, Inc. All rights reserved. This information has been obtained from sources believed reliable, but has not been verified for accuracy or completeness. You should conduct a careful, independent investigation of the property and verify all information. Any reliance on this information is solely at your own risk. CBRE and the CBRE logo are service marks of CBRE, Inc. All other marks displayed on this document are the property of their respective owners, and the use of such logos does not imply any affiliation with or endorsement of CBRE. Photos herein are the property of their respective owners. Use of these images without the express written consent of the owner is prohibited.