



**For Sale or Lease
0.69 to 3.03 Acres**

**Proposed
Retail/Office Space
For Lease**

FOR LEASE

REED'S POINTE

E. 21st St. N. & N.143rd St. E. | Wichita, KS

High-Growth Area in Northeast Wichita

1,400 SF to 17,600+ SF



Scan QR to view property on website

Occidental Management, Inc.

165 S. Rock Island, Ste. 300, Wichita, KS 67202

| occmgmt.com

| 316.262.3331



PLANNED RETAIL/OFFICE ON-SITE*



* Conceptual & subject to change

PROPERTY OVERVIEW

PRIME DEVELOPMENT SITE

This exciting new 20-acre development in Northeast Wichita is primed for commercial development.

The Reed's Pointe retail/professional office development is located at 21st Street N. and 143rd Street E., a heavily trafficked, four-lane arterial that carries commuters between Wichita and Andover.

This area of NE Wichita features the best income demographics in the city of Wichita, and is one of the fastest-growing areas of the city.

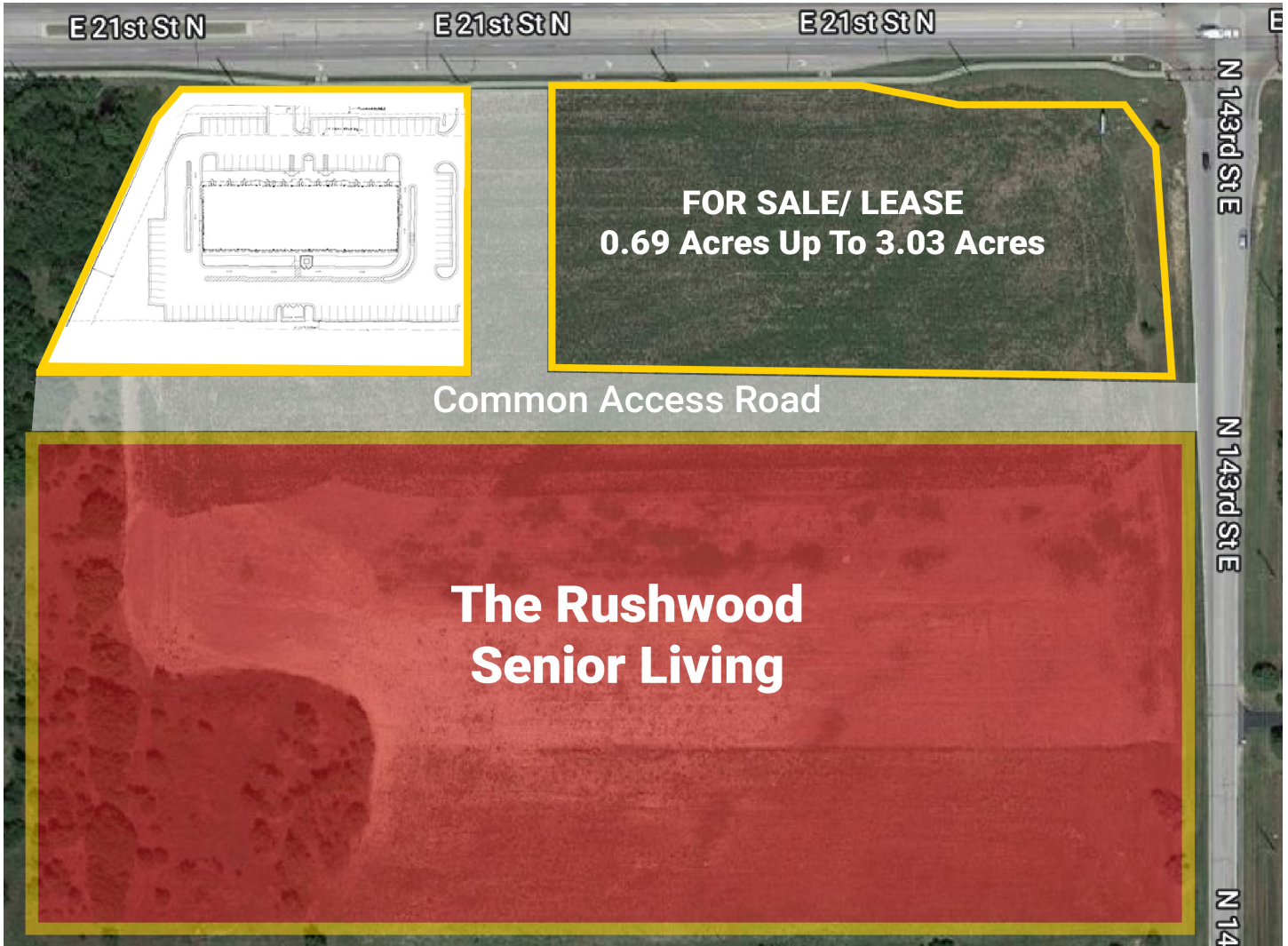

PROPERTY DETAILS

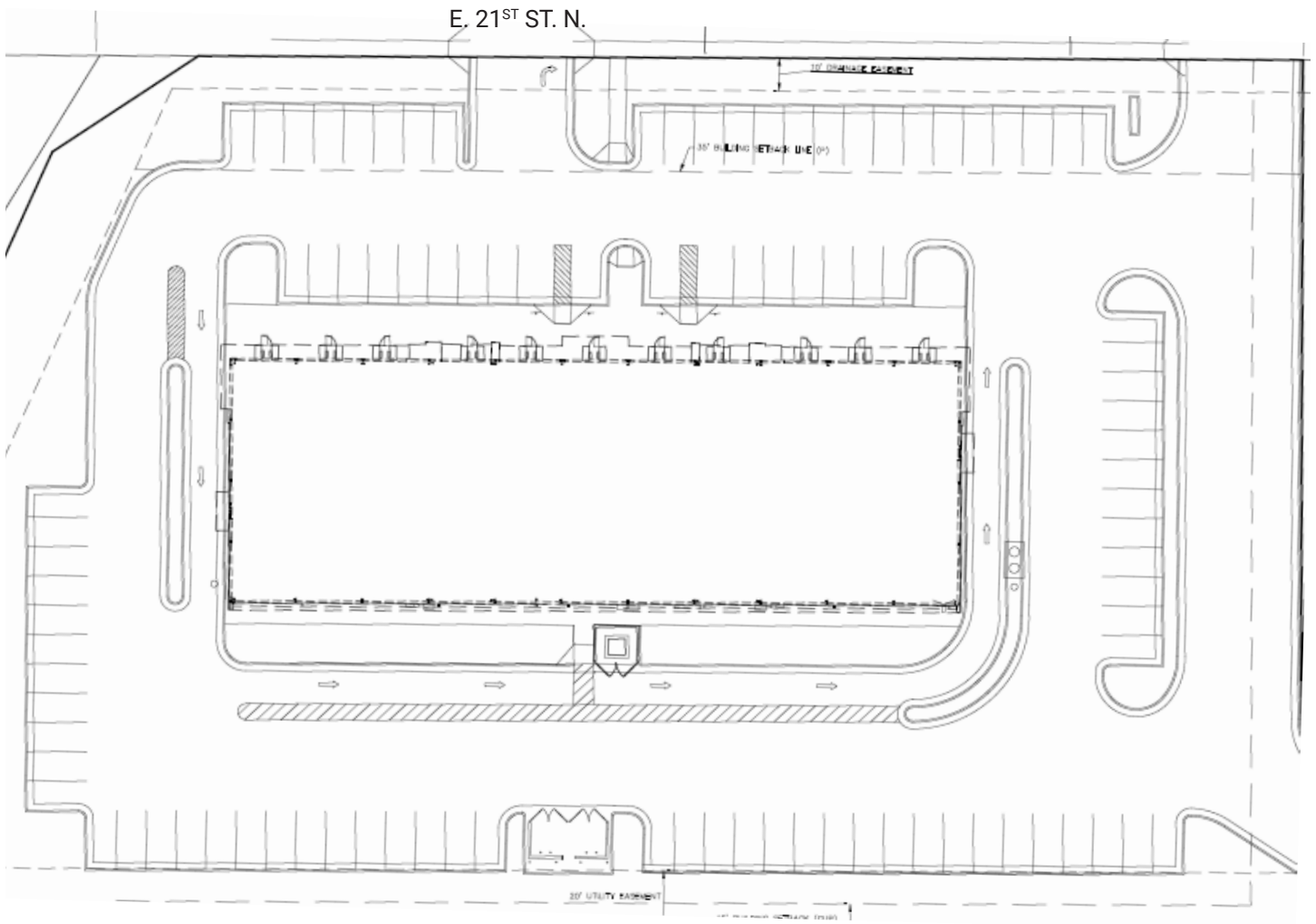

* Conceptual & subject to change

AVAILABLE SPACE

For Lease | 1,400 - 17,600+ SF

PROPERTY DETAILS



LOCATION DEMOGRAPHICS



HOUSEHOLD INCOME

MILE 1	106,000
MILE 3	110,000
MILE 5	90,000

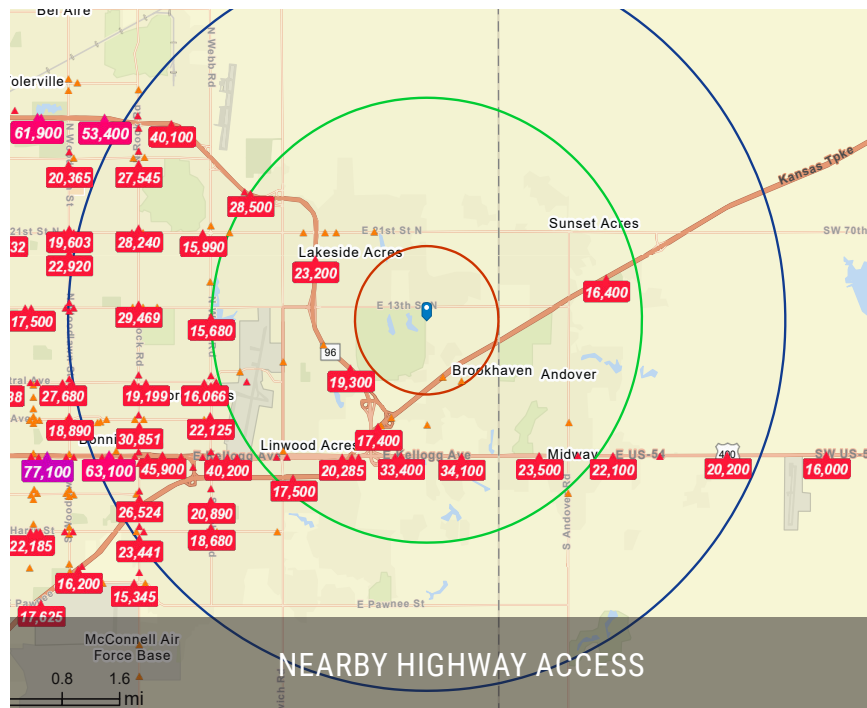



BUSINESSES NEARBY

Wheatland Elementary School, Firefly Farm, Reeds Cove Health & Rehabilitation, QuikTrip, Simmons Bank, Security 1st Title, Christ Church, Ziggy's Pizza