



SPACE AVAILABLE FOR LEASE AT RAIL CENTRAL!

RAIL CENTRAL 1790 BONANZA DRIVE #275 | PARK CITY, UTAH

Suite 275 in Rail Central is 2,218 sq.ft. and is located on the second floor with elevator access. Features include five private offices, three common area offices, a filing room, kitchenette, conference room and a large balcony with resort views. There are two common area restrooms, one located on the second-floor hallway and the other on the first-floor lobby of the building. Rail Central is conveniently located on Bonanza Drive adjacent to the Rail Trail. This is a great location to office in the middle of town within walking distance to numerous restaurants.

RENT \$28/SF CAM \$10/SF

**BERKSHIRE
HATHAWAY** | UTAH
HOMESERVICES | PROPERTIES

COMMERCIAL DIVISION



PROPERTY DETAILS

RAIL CENTRAL 1790 BONANZA DRIVE #275 | PARK CITY, UTAH



FLOOR PLANS

RAIL CENTRAL 1790 BONANZA DRIVE #275 | PARK CITY, UTAH

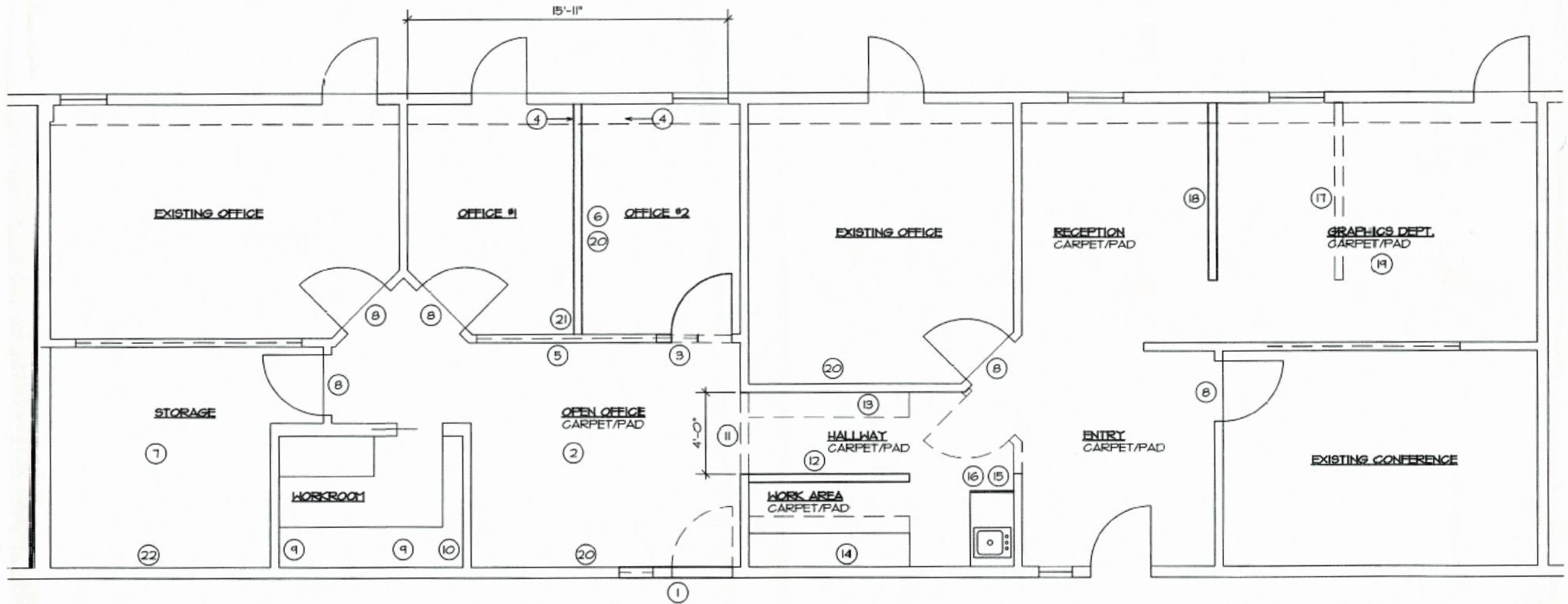

LOCATION

RAIL CENTRAL 1790 BONANZA DRIVE #275 | PARK CITY, UTAH

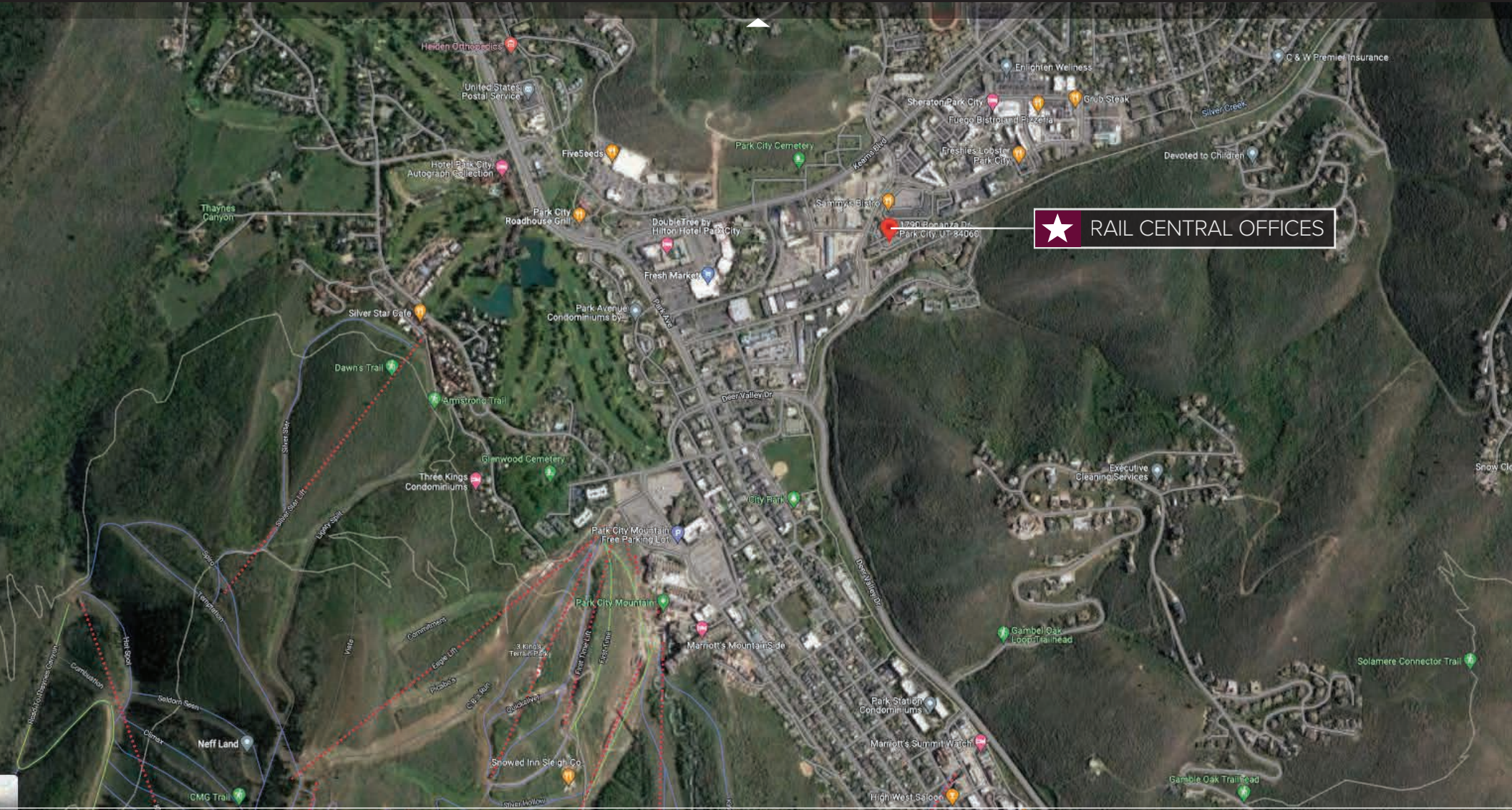



RAIL CENTRAL

1790 BONANZA DRIVE #275
PARK CITY, UTAH

- 2,218 SF
- Five private offices
- Reception
- Open Office
- Kitchenette
- Printing Room/ Work Area
- Conference room
- Large balcony with views

Rent - **\$28 psf**

CAM - **\$10 psf**

Almost full service, includes: Janitorial, gas, electric, water, sewer, property tax, insurance along with exterior maintenance. Tenant is responsible for their own communications.



MICHAELFISCHER.BHHSUTAH.COM



MICHAEL FISCHER REALTOR®

(435) 659-7973 | michaelfischer@bhhsutah.com

www.michaelfischer.bhhsutah.com

2200 Park Avenue, Bldg B | Park City, Utah | BHHSUtah.com

© 2024 BHH Affiliates, LLC. An independently owned and operated franchisee of BHH Affiliates, LLC. Berkshire Hathaway HomeServices and the Berkshire Hathaway HomeServices symbol are registered service marks of Columbia Insurance Company, a Berkshire Hathaway affiliate. Equal Housing Opportunity. Information not verified or guaranteed. Berkshire Hathaway HomeServices and/or its representatives do not warrant or guarantee this information. Information herein was provided by Owner/Seller. Lessee/Purchaser is responsible to confirm any information considered a factor in a decision to lease or purchase.

**BERKSHIRE
HATHAWAY** | UTAH
HOMESERVICES | PROPERTIES

COMMERCIAL DIVISION