



## FOR SALE - HARV'S CAR WASH

75015 Sheryl Ave  
Palm Desert, CA 92211



Sale Price

\$3,899,000

### Property Overview

### Location Overview

### Offering Summary

Property Type:	Special Purpose
Building Size:	17,100 SF
Price / SF:	\$228.01
Cap Rate:	7.29%
NOI:	\$284,280

The Coachella Valley's iconic Harv's Car Wash was built in 1991, and has been a very popular spot in Palm Desert for customers to have their cars washed and detailed. The current operator has been in the car wash business for over 30+ years, and recently executed a 10 year, single tenant NNN lease. Currently, the lease terms still has approximately 9 years remaining (Exp. 8/31/34).

The current CAP Rate is 7.29%, with 3% annual Base Rent escalations.

The Seller had a \$300k solar panel system installed on the building in 2018, which has been paid for in full, and is part of the sale.

Centrally located in Palm Desert, this site offers easy access to all of the neighboring businesses and residents in the area. Located on Cook St., between Fred Waring and Hovley Lane, just minutes from the I-10 freeway.

The car wash equipment was replaced in 2018. The Lessee is responsible for the maintenance, repair, and replacement (if needed) of the equipment.

Matthew V. Johnson  
760.779.4000 (Direct)  
matt@johnsoncommercial.net  
CalDRE #00927239

760.779.4000  
72000 Magnesia Falls Drive  
Rancho Mirage, CA 92270  
www.johnsoncommercial.net

Johnson Commercial Copyright 2017. No warranty or representation, express or implied, is made to the accuracy or completeness of the information contained herein, and same is submitted subject to errors, omissions, change of price, rental or other conditions, withdrawal without notice, and to any special listing conditions imposed by the property owner(s). As applicable, we make no representation as to the condition of the property (or properties) in question.





**FOR SALE**  
75015 Sheryl Ave  
Palm Desert, CA 92211



Matthew V. Johnson  
760.779.4000 (Direct)  
matt@johnsoncommercial.net  
CalDRE #00927239

Johnson Commercial Copyright 2017. No warranty or representation, express or implied, is made to the accuracy or completeness of the information contained herein, and same is submitted subject to errors, omissions, change of price, rental or other conditions, withdrawal without notice, and to any special listing conditions imposed by the property owner(s). As applicable, we make no representation as to the condition of the property (or properties) in question.

760.779.4000  
72000 Magnesia Falls Drive  
Rancho Mirage, CA 92270  
www.johnsoncommercial.net





**JOHNSON**  
COMMERCIAL REAL ESTATE

**FOR SALE**  
75015 Sheryl Ave  
Palm Desert, CA 92211



**Matthew V. Johnson**  
**760.779.4000 (Direct)**  
matt@johnsoncommercial.net  
CalDRE #00927239

Johnson Commercial Copyright 2017. No warranty or representation, express or implied, is made to the accuracy or completeness of the information contained herein, and same is submitted subject to errors, omissions, change of price, rental or other conditions, withdrawal without notice, and to any special listing conditions imposed by the property owner(s). As applicable, we make no representation as to the condition of the property (or properties) in question.

**760.779.4000**  
72000 Magnesia Falls Drive  
Rancho Mirage, CA 92270  
www.johnsoncommercial.net





**FOR SALE**  
75015 Sheryl Ave  
Palm Desert, CA 92211



**Matthew V. Johnson**  
**760.779.4000 (Direct)**  
matt@johnsoncommercial.net  
CalDRE #00927239

Johnson Commercial Copyright 2017. No warranty or representation, express or implied, is made to the accuracy or completeness of the information contained herein, and same is submitted subject to errors, omissions, change of price, rental or other conditions, withdrawal without notice, and to any special listing conditions imposed by the property owner(s). As applicable, we make no representation as to the condition of the property (or properties) in question.

**760.779.4000**  
72000 Magnesia Falls Drive  
Rancho Mirage, CA 92270  
www.johnsoncommercial.net





75015 Sheryl Ave  
Palm Desert, CA 92211

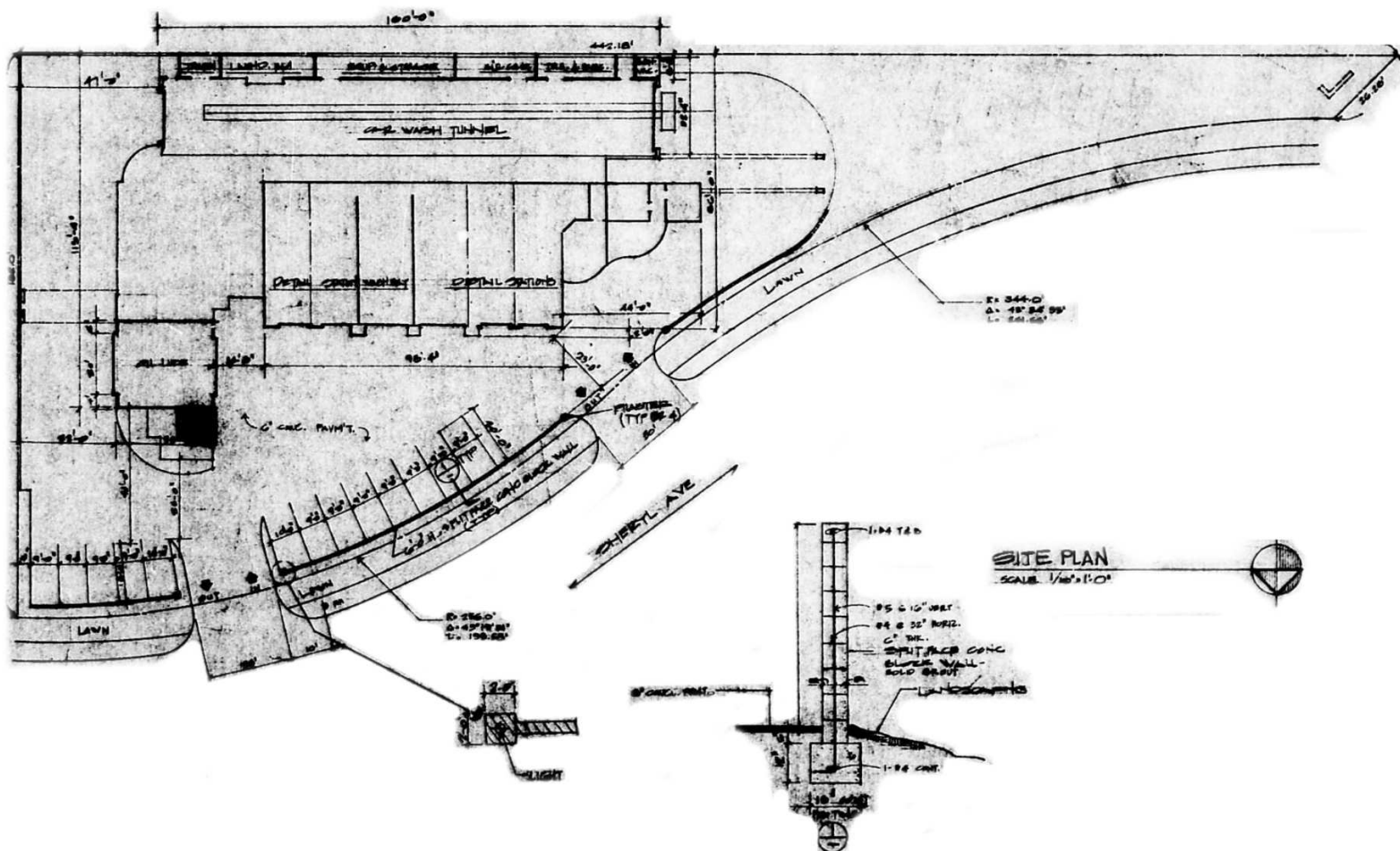

**Matthew V. Johnson**  
**760.779.4000 (Direct)**  
 matt@johnsoncommercial.net  
 CalDRE #00927239

Johnson Commercial Copyright 2017. No warranty or representation, express or implied, is made to the accuracy or completeness of the information contained herein, and same is submitted subject to errors, omissions, change of price, rental or other conditions, withdrawal without notice, and to any special listing conditions imposed by the property owner(s). As applicable, we make no representation as to the condition of the property (or properties) in question.

**760.779.4000**  
72000 Magnesia Falls Drive  
Rancho Mirage, CA 92270  
[www.johnsoncommercial.net](http://www.johnsoncommercial.net)





FOR SALE  
75015 Sheryl Ave  
Palm Desert, CA 92211



Demographics	0.3 Miles	0.5 Miles	1 Mile
Total population	590	1,942	7,461
Median age	46	47	49
Median age (Male)	44	45	47
Median age (Female)	48	49	51
Total households	238	805	3,192
Total persons per HH	2.5	2.4	2.3
Average HH income	\$79,919	\$91,844	\$109,049

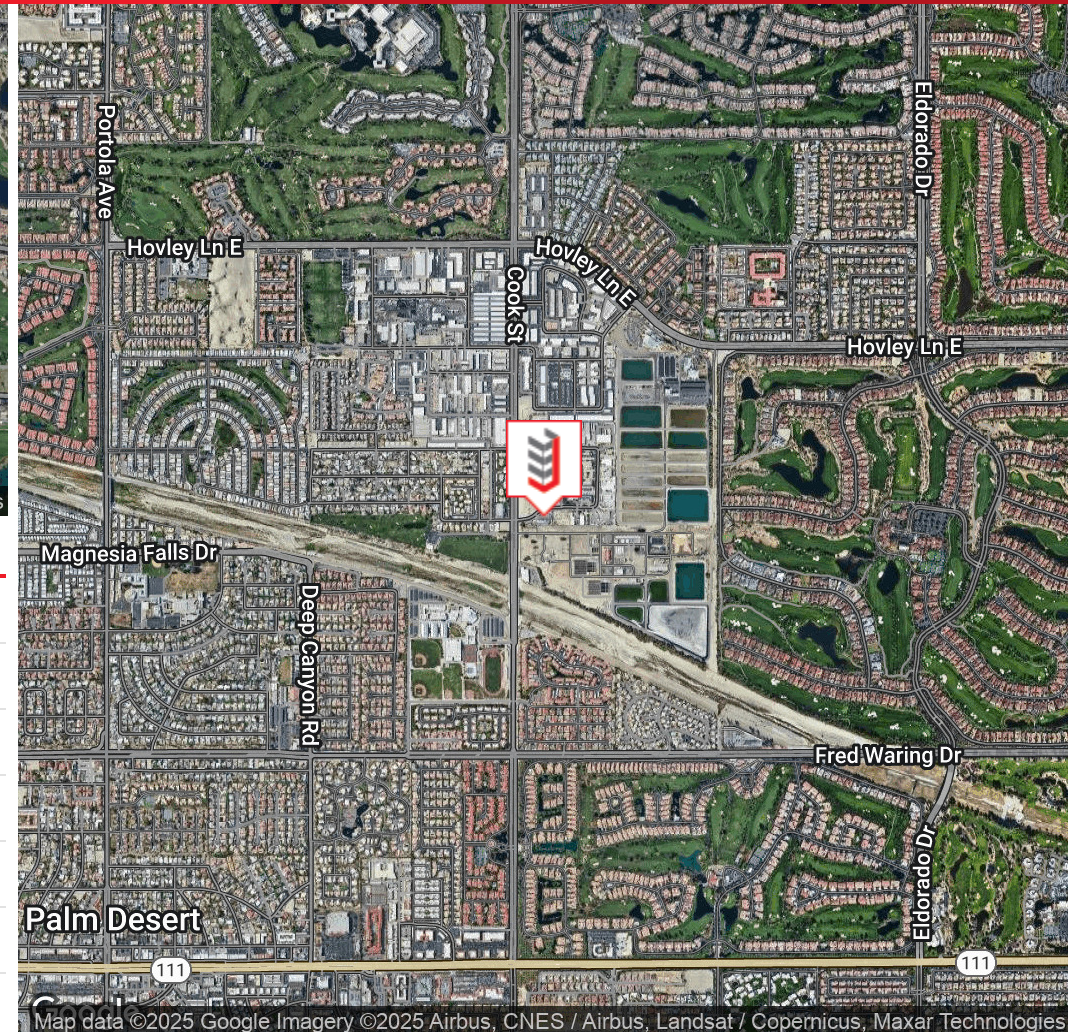

Matthew V. Johnson  
760.779.4000 (Direct)  
matt@johnsoncommercial.net  
CalDRE #00927239

Johnson Commercial Copyright 2017. No warranty or representation, express or implied, is made to the accuracy or completeness of the information contained herein, and same is submitted subject to errors, omissions, change of price, rental or other conditions, withdrawal without notice, and to any special listing conditions imposed by the property owner(s). As applicable, we make no representation as to the condition of the property (or properties) in question.

760.779.4000  
72000 Magnesia Falls Drive  
Rancho Mirage, CA 92270  
www.johnsoncommercial.net