

FOR LEASE - RETAIL SPACE
HAZELDEAN MALL



Enclosed Mall Retail Opportunity in the Heart of Kanata

Hazeldean Mall

257sf to 40,000sf available

Hazeldean Mall is the only enclosed shopping centre in Kanata, providing a year-round climate-controlled retail experience to the communities of Kanata, Stittsville, and beyond. Now over 40 years as the prominent retail centre in the area, the mall has a long tradition of serving the area with a comprehensive roster of national and local tenants, local community support and seasonal events, serving over 100,000 neighbours.

Recently upgraded features such as interior and exterior LED lighting, exterior and interior signage, and renovated entrances, create a welcoming and engaging environment which is enjoyed by a diverse demographic throughout the year. A prolific marketing program featuring a rich calendar of seasonal and recurring events stimulate interaction and draw steady traffic.

Bruce Barrett
Director, Leasing
(613) 219-7184 Direct
bbarrett@regionalgroup.com

Regional Group
1737 Woodward Drive, 2nd
Floor
Ottawa, ON
K2C 0P9

(613) 230-2100

info@regionalgroup.com



Statistics &

- Car count over 25,000 daily
- Average household income is \$133,308, 21% greater than the Ottawa average.
- 5 km radius has a highly educated population- 65% of adults have a post-secondary education.
- Projected strong population growth of 15.1% by 2028
- Over 100,000 residents, 26% of whom are bilingual.
- Surge in development with over 2,100 residential units within a 3km radius of Hazeldean Mall.

Strategic Location

- 2km south of Highway 417 and Eagleson OC Transpo Park & Ride
- 6m from future LRT Moodie Station (Confederation Line)
- Serviced by 6 major OC Transpo routes

Highlights

- Full roster of marketing initiatives and events to generate year-round interest.
- Strong community involvement.
- Undergoing sustainability upgrades to lighting and operations systems.
- Newly designed seasonal decor.
- 1,294 Parking stalls
- Ceiling height up to 18.75'



Major Tenants

Anchors

- T & T Supermarket
- GoodLife Fitness
- Rexall
- Sharks Cheer Sports

Major Retail Tenants

- Reitmans
- Pearle Vision

Key Food Service

- Shaaz Indian Restaurant



Availability

Type	Area (sf)
Unit 11A	406
Unit 11B	453
Unit 12- Cafe	775
Unit 22	1,954
Unit 27	4,076
Unit 28	1,956
Unit 29	1,346
Unit 33	1,039
Unit 37 & 45	2,216
Unit 43	851
Unit 56	3,998
Unit 76	257
Big Box	up to 43,878

Big Box Spaces can be further subdivided



276- 43,878sf

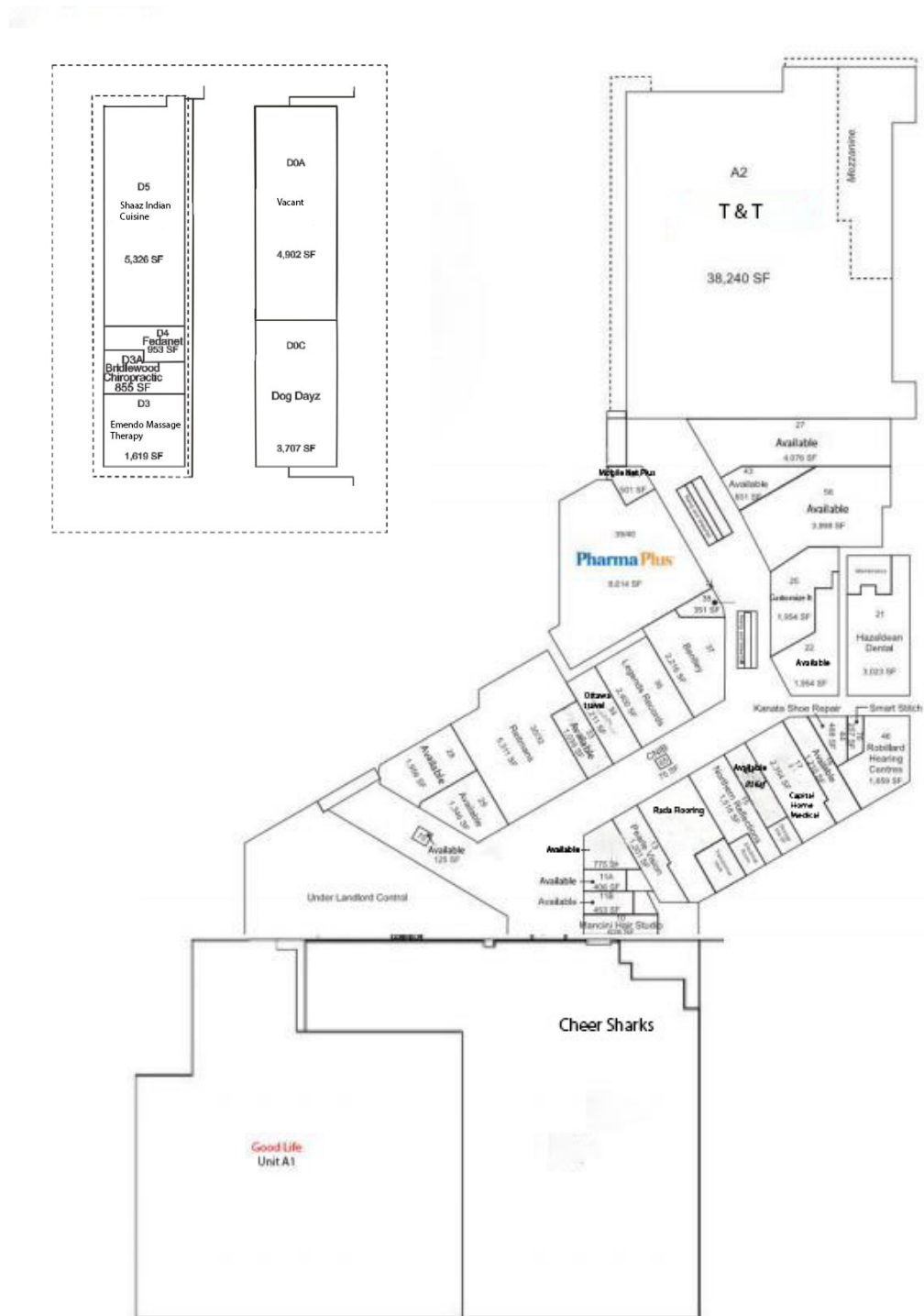

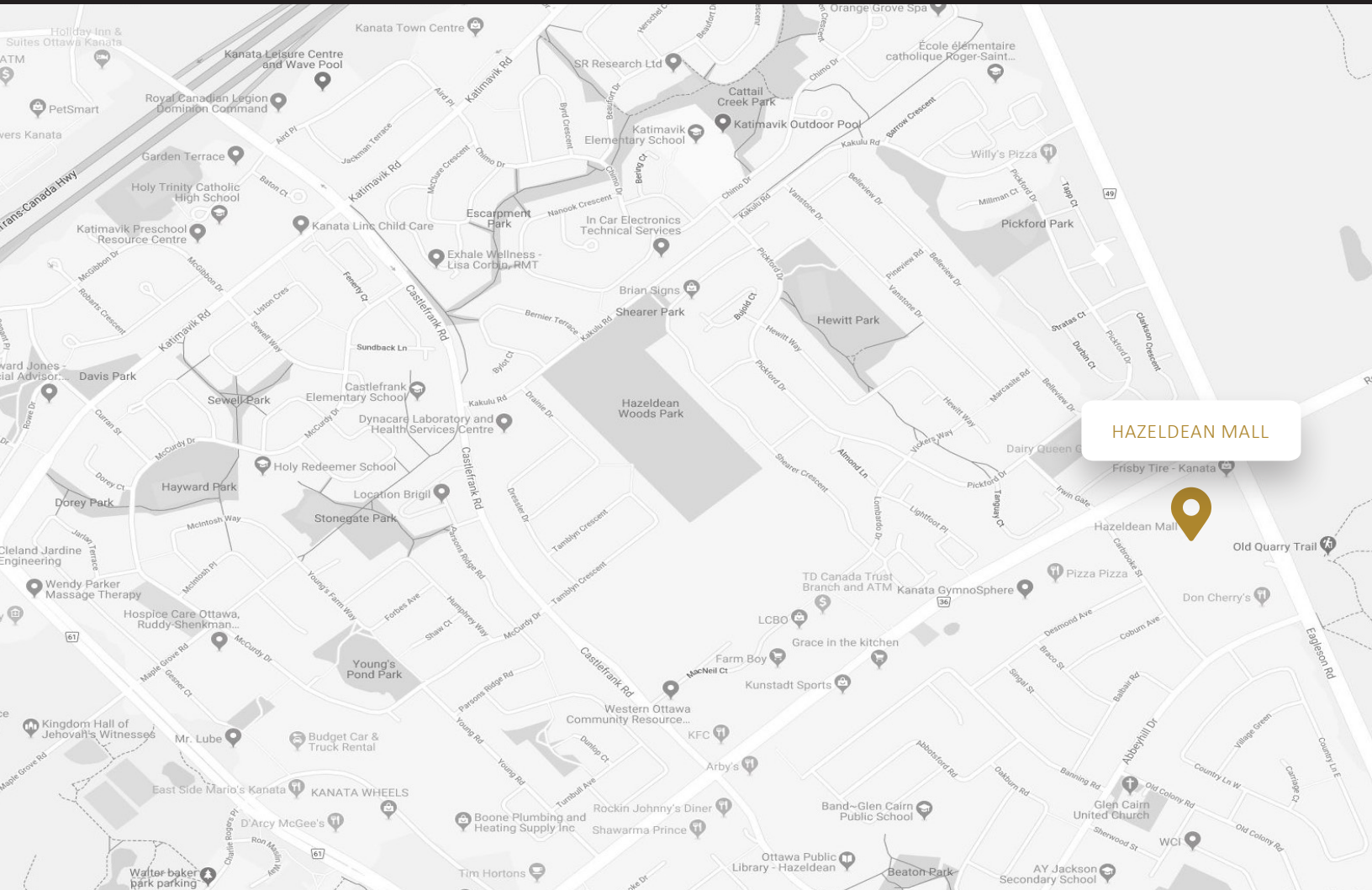







Contact us

Bruce Barrett
Director, Leasing
(613) 219-7184 Direct
bbarrett@regionalgroup.com

Regional Group
1737 Woodward Drive, 2nd Floor
Ottawa, ON
K2C 0P9

(613) 230-2100
info@regionalgroup.com
regionalgroup.com

The information herein contained has not been verified by The Regional Group of Companies Inc. (the 'Agent'). The Agent does not warrant in any manner, implied or otherwise, that the information herein contained is accurate. The Agent does not, and will not, accept or assume any liability for any consequence or result, negative or otherwise, arising from the reliance of the party receiving the information (the 'Recipient') on the information herein contained. It is the sole and exclusive responsibility of the Recipient to independently verify all information herein contained and perform all due diligence as reasonably required. The information herein contained is subject to change and / or alteration without prior notice, and the Agent hereby reserves the exclusive right to remove from the market said information and / or the Property / Space for Lease to which it pertains. The Regional Group of Companies Inc. is acting solely as an agent for its client, and is not acting in its personal or corporate capacity.

