

For Lease  
**±2,270 SF**  
Office Space

# Cypress Plaza

6365 NW 6<sup>th</sup> Way, Fort Lauderdale, FL 33309

## Property Features

- Recently upgraded three-story office building in Corporate Park at Cypress Creek
- Excellent location with easy access to highways and public transit
- Nearby businesses include Chili's, Starbucks, LA Fitness, Office Depot, Chipotle, CVS and more
- Near Fort Lauderdale Executive Airport

For more information:

**Lesley Sheinberg**, Managing Director

[lsheinberg@mhcreal.com](mailto:lsheinberg@mhcreal.com)

C: 561 254 7810 | O: 561 471 8000

## Key Highlights



Fully renovated first-class office building



Adjacent to I-95 and minutes from the Florida Turnpike



Nearby numerous retail, dining, and lifestyle amenities



Ample parking





## FOR LEASE: CYPRESS PLAZA, FORT LAUDERDALE

# ±2,270 SF Office Space Near I-95



### Available Space:

Suite 220: 2,270 SF

### Rental Rate:

\$17.50/SF NNN  
\$13.50/SF CAM ; includes  
janitorial; tenant pays separately  
metered electric

### Parking:

Ample parking (4:1,000)

For more information:

**Lesley Sheinberg**, Managing Director

[lsheinberg@mhcreal.com](mailto:lsheinberg@mhcreal.com)

C: 561 254 7810 | O: 561 471 8000

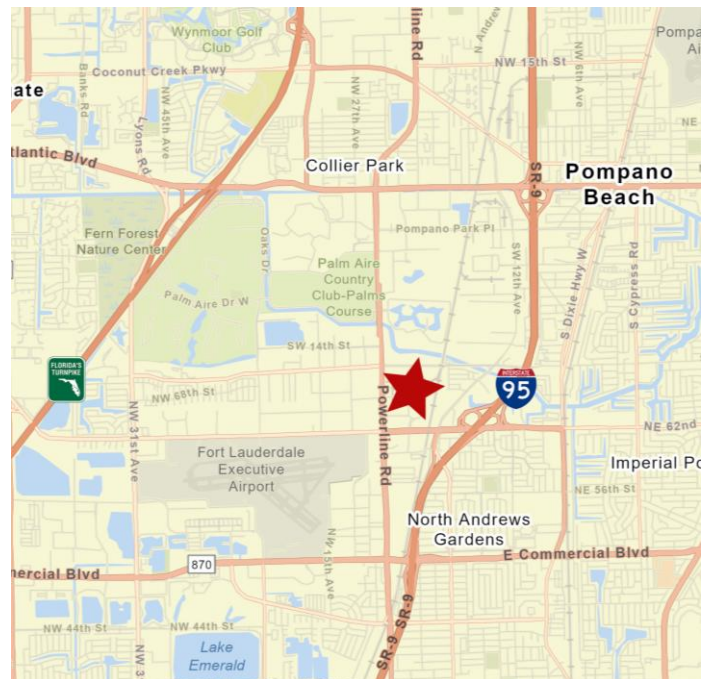

NO WARRANTY OR REPRESENTATION, EXPRESS OR IMPLIED, IS MADE AS TO THE ACCURACY OF THE INFORMATION CONTAINED HEREIN, AND THE SAME IS SUBMITTED SUBJECT TO ERRORS, OMISSIONS, CHANGE OF PRICE, OR WITHDRAWAL WITHOUT NOTICE.



561 471 8000



1601 Forum Place, Suite 700  
West Palm Beach, FL 33401



[www.mhcreal.com](http://www.mhcreal.com)

## FOR LEASE: CYPRESS PLAZA, FORT LAUDERDALE

### Spacious & Business-Ready

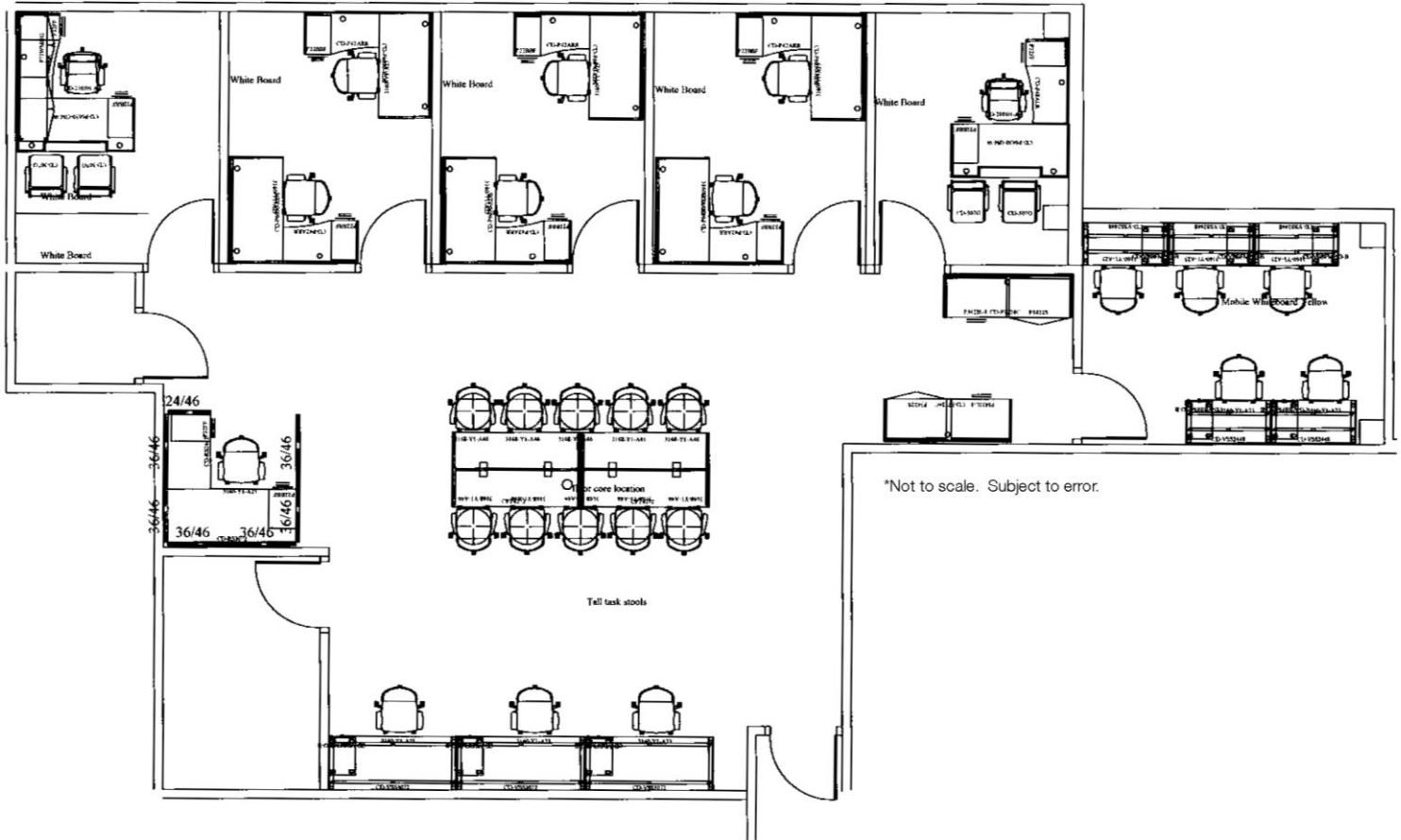

### Suite 220 ±2,270 SF

This business-ready space is designed for productivity and flexibility.

- 6 private offices
- Large open workspace
- Storage areas

**Lesley Sheinberg**, Managing Director  
[lsheinberg@mhcreal.com](mailto:lsheinberg@mhcreal.com)  
C: 561 254 7810 | O: 561 471 8000

Call today for more information!



**561 471 8000**