



1200

Crown
Colony Drive
QUINCY, MA

± 11,883 SF Plug & Play Sublease Available

Term Through May 2030

CBRE

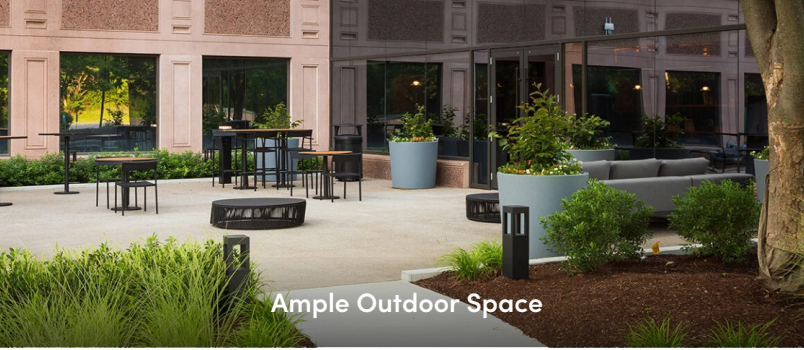

Ample Outdoor Space



Cafeteria & Collaboration Areas



Fitness Center

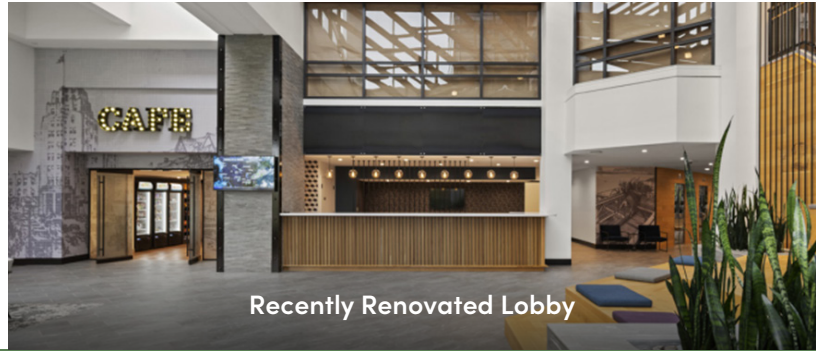

Recently Renovated Lobby

Property Overview

CBRE is pleased to present a ±11,883 SF office suite available for sublease on the sixth floor of 1200 Crown Colony Drive in Quincy, Massachusetts.

Located within the 175-acre master-planned Crown Colony Office Park, this this plug-and-play sublease opportunity features a modern design and recent buildout including 15 executive offices/meeting rooms, 45 standard workstations, and 13 compact workstations, enabling immediate move-in capability. 1200 Crown Colony Drive has been completely remodeled and is home to market leading common area amenities and finishes. The building benefits from convenient access to I-93 and nearby transportation services, including the Quincy Adams Red Line, Quincy Center Commuter Rail, and the Marina Bay Commuter Ferry—providing employees with seamless travel to and from the workplace.

BUILDING SPECIFICATIONS

Building SF:	±245,668 SF
Available SF:	±11,883 SF 6th Floor
Sublease Term:	Through May 2030
Year Built:	1988
Land Area:	14 Acres
Number of Floors:	7
Structure:	Steel Beam
Core Factor:	18%
Parking:	3.50/1,000 SF 833 Spaces; 19 Handicapped
Elevator:	3 Passenger Elevators (3,500 lbs.) 1 Freight Elevator

HVAC:	Fan Powered VAV System, Perimeter Hot Water Heating
Electrical:	4,000 Amps, 277/480 V
Security:	Card Access, Exterior Cameras, Monday - Friday Front Desk Security (7 AM - 7 PM)
Fire Protection:	100% Wet Sprinkler System Coverage
Loading Docks:	2 Exterior Tailboard Docks
Building Owner:	FoxRock Properties
Utilities	
Gas:	National Grid
Electricity:	National Grid
Water/Sewer:	City of Quincy

Floor Plan

TERM THROUGH
MAY 2030

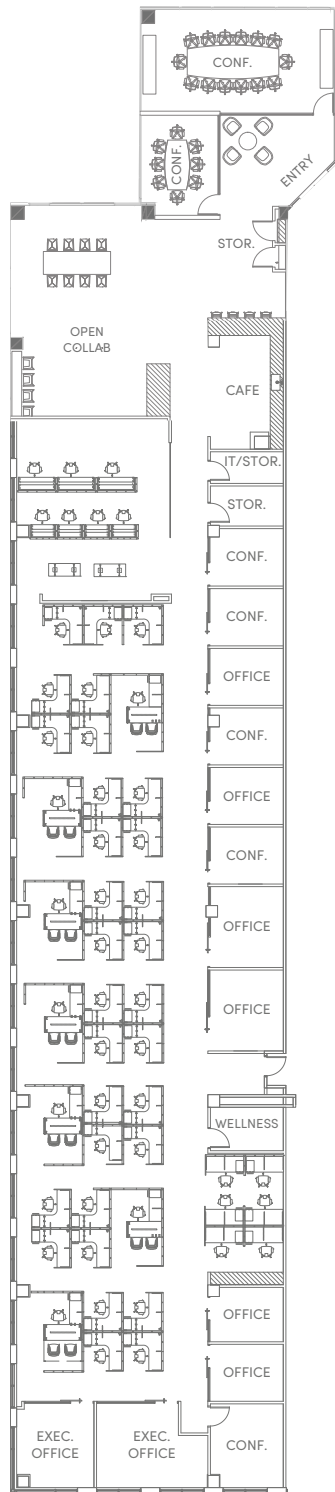

PROPERTY HIGHLIGHTS

15
Executive Offices/
Conference Rooms

45
Standard
Workstations

13
Compact
Workstations



In-Suite Café



Collaboration Area



Compact Workstations



Standard Workstations



Large Board Room



Executive Offices & Huddle Rooms



1200
Crown Colony Drive

Boston
11.7 Miles

CROWN COLONY DRIVE

93

3

Harvard Pilgrim Health Care

Solli

Quest

DECO

PHIFER | PINKHAM LLC
ENVIRONMENTAL PARTNERS

ACLS ACADEMY
Lynch Medical Consulting
Research Institute for Aging and Health Care

ARBELLA INSURANCE

Baker, Braverman & Barbadoro, P.C.

MARRIOTT

BAYADA

Quincy Adams

NEW ENGLAND TRIPS inc

J.Jill

MBA Mortgage
We've mastered the business of mortgages.

VOYA

Greater Quinoy Childcare Center

MARCUS ERICCO EMMER & BROOKS

BATTERYMARCH PARK

Nestlé

BC Law
BELLUSO CRUM & LEVIN

withum+

Flatley Co.

NetTelOne

Boston CBD	11.7 Miles
Marina Bay Commuter Ferry	6.5 Miles
Quincy Adams Station MBTA	0.8 Miles
Quincy Center Commuter Rail	1.9 Miles
South Shore Plaza (180+ Retailers)	2.3 Miles

1200

Crown Colony Drive
QUINCY, MA



CONTACTS

ROB BYRNE
Executive Vice President
+1 617 827 7486
robert.byrne@cbre.com

RYAN ROMANO
Executive Vice President
+1 617 7635402
ryan.romano@cbre.com

THOMAS TSANDILAS
Senior Associate
+1 413 563 9373
thomas.tsandilas@cbre.com

EMILY MURPHY
Associate
+1 617 320 3132
emily.murphy@cbre.com

© 2026 CBRE, Inc. All rights reserved. This information has been obtained from sources believed reliable but has not been verified for accuracy or completeness. CBRE, Inc. makes no guarantee, representation or warranty and accepts no responsibility or liability as to the accuracy, completeness, or reliability of the information contained herein. You should conduct a careful, independent investigation of the property and verify all information. Any reliance on this information is solely at your own risk. CBRE and the CBRE logo are service marks of CBRE, Inc. All other marks displayed on this document are the property of their respective owners, and the use of such marks does not imply any affiliation with or endorsement of CBRE. Photos herein are the property of their respective owners. Use of these images without the express written consent of the owner is prohibited.