

Flex Space For Lease

VALLEY GROVE FLEX

2315 & 2415 West Sam White Lane

Pleasant Grove, UT 84062



Jarrod Hunt

+1 801 787 8940

jarrod.hunt@colliers.com



Andy Blunt

+1 801 870 9648

jarrod.hunt@colliers.com

SITE PLANS

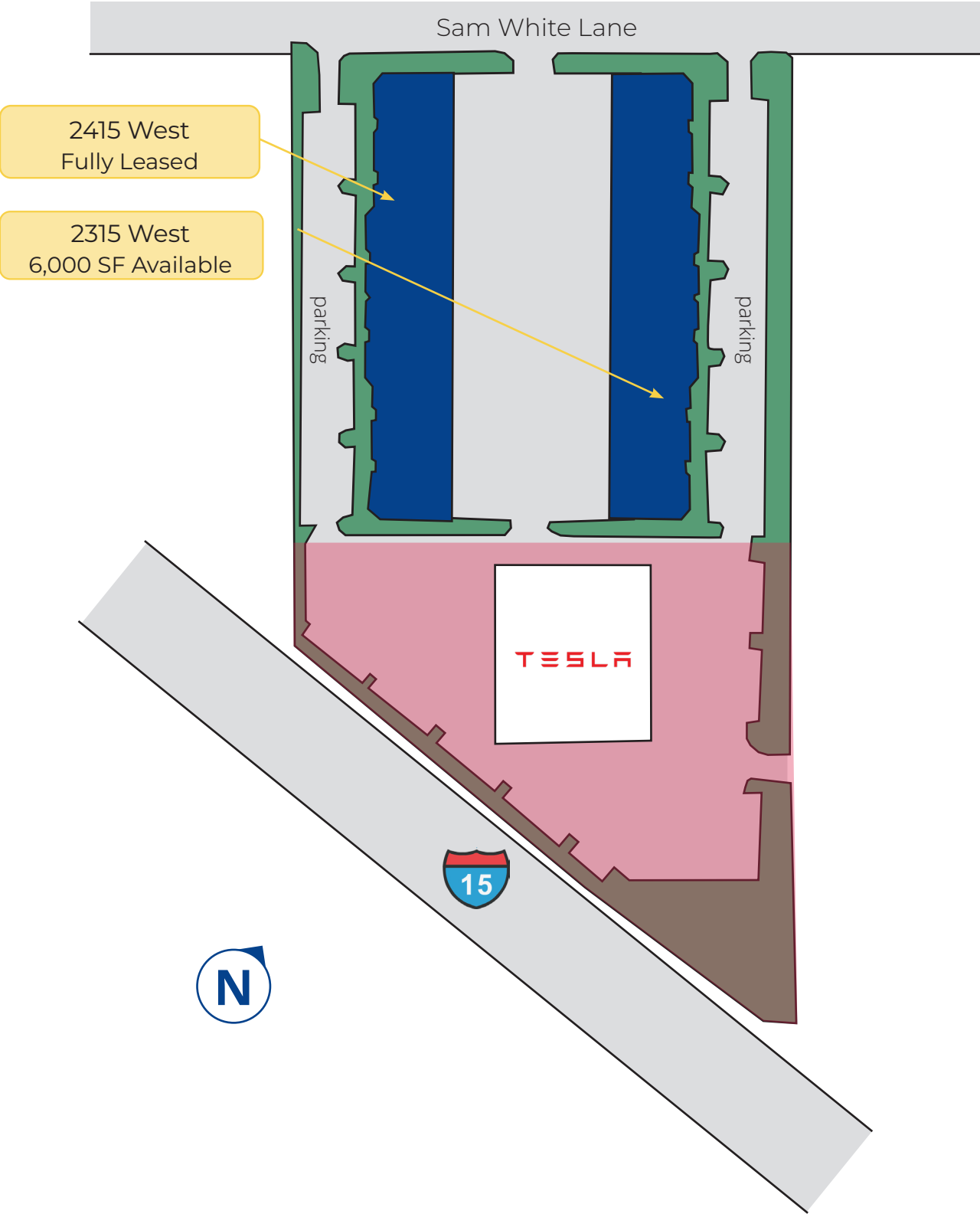

2315 WEST BUILDING

6,000 SF Available

- Direct-entry flexible space
- LEED designed
- 18' minimum clear height
- Up to 6/1,000 parking ratio
- 208 Volt 3-Phase , 200A per suite
- Office space under construction

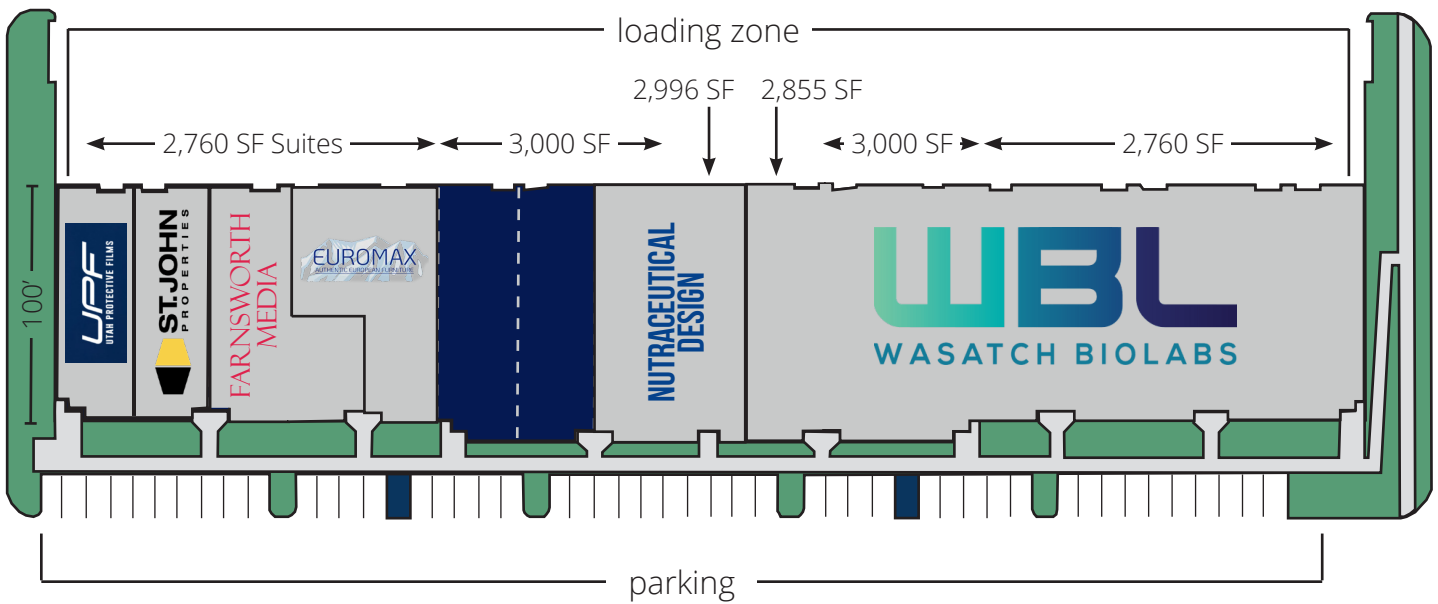

Spec office space currently under construction:

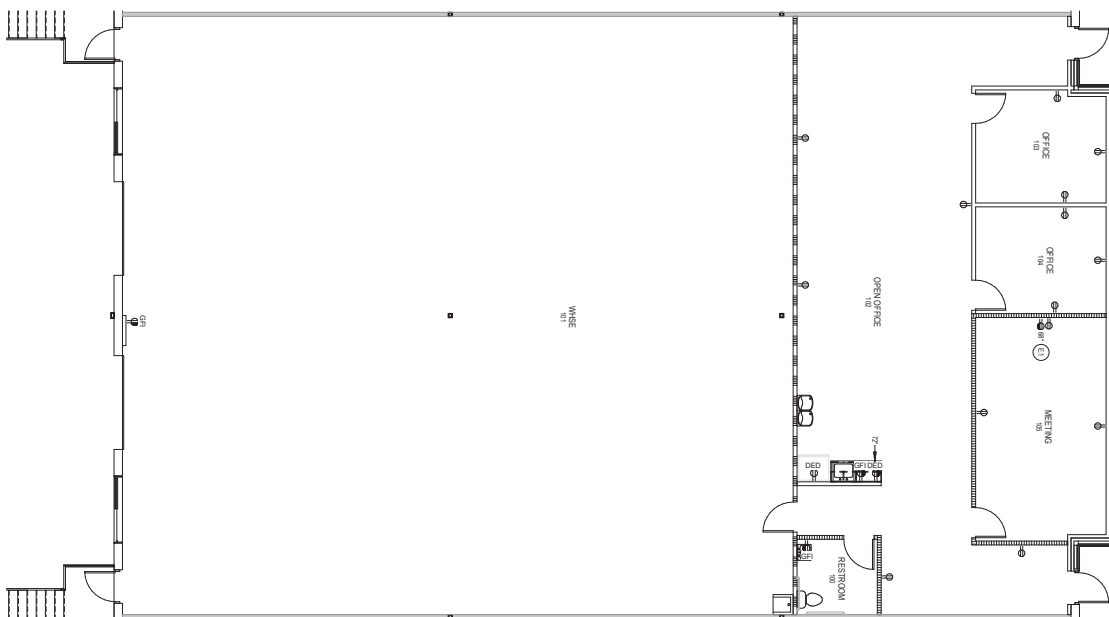

2415 WEST BUILDING

Fully Leased

- Direct-entry flexible space
- LEED designed
- 18' minimum clear height
- Up to 6/1,000 parking ratio

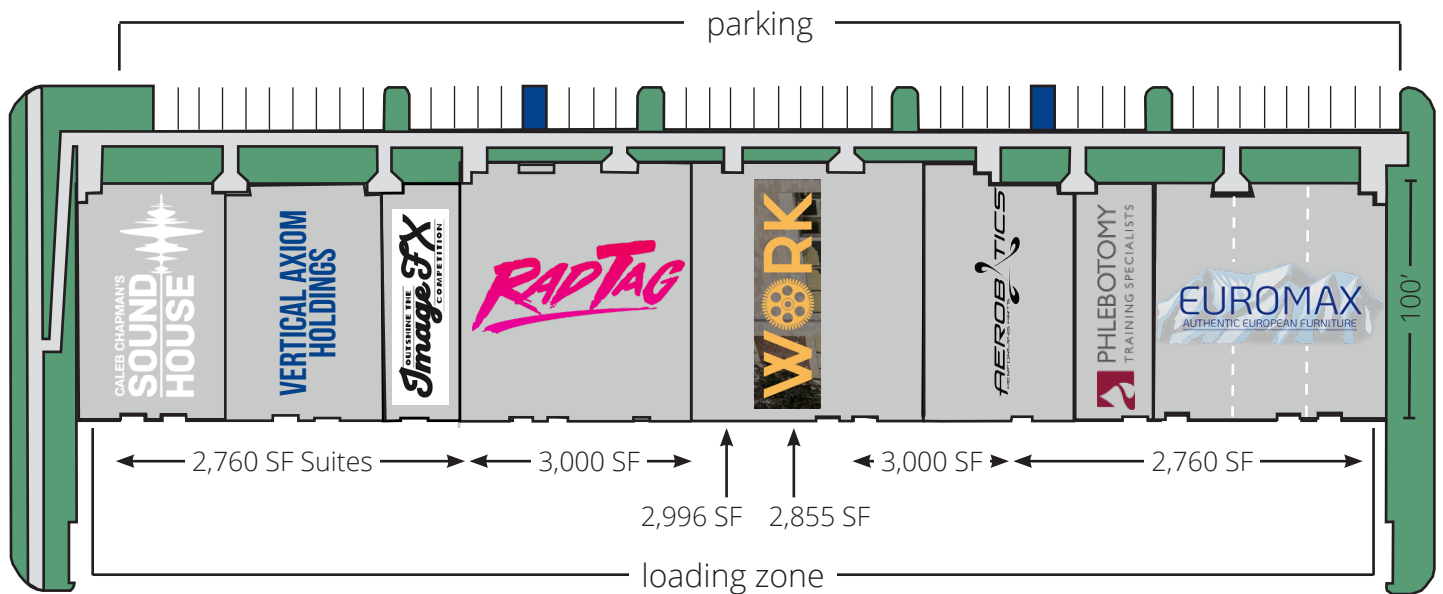
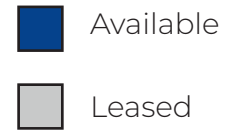

LOCATION



VALLEY GROVE

Overview



Valley Grove is a 100-acre mixed-use destination rising in the heart of Utah County. With unmatched access to I-15 and North County Boulevard, Valley Grove provides people more time to eat, sleep, play and work instead of waiting in traffic. Upon completion, the \$500 million Valley Grove development will contain over one million square feet of Class A office, retail and restaurants as well as a hotel.



► [visit website](#)



This document has been prepared by Colliers International for advertising and general information only. Colliers International makes no guarantees, representations or warranties of any kind, expressed or implied, regarding the information including, but not limited to, warranties of content, accuracy and reliability. Any interested party should undertake their own inquiries as to the accuracy of the information. Colliers International excludes unequivocally all inferred or implied terms, conditions and warranties arising out of this document and excludes all liability for loss and damages arising there from. This publication is the copyrighted property of Colliers International and/or its licensor(s). ©2023. All rights reserved.