

SECTION 10, TOWNSHIP 29 SOUTH, RANGE 18 EAST, HILLSBOROUGH COUNTY, FLORIDA

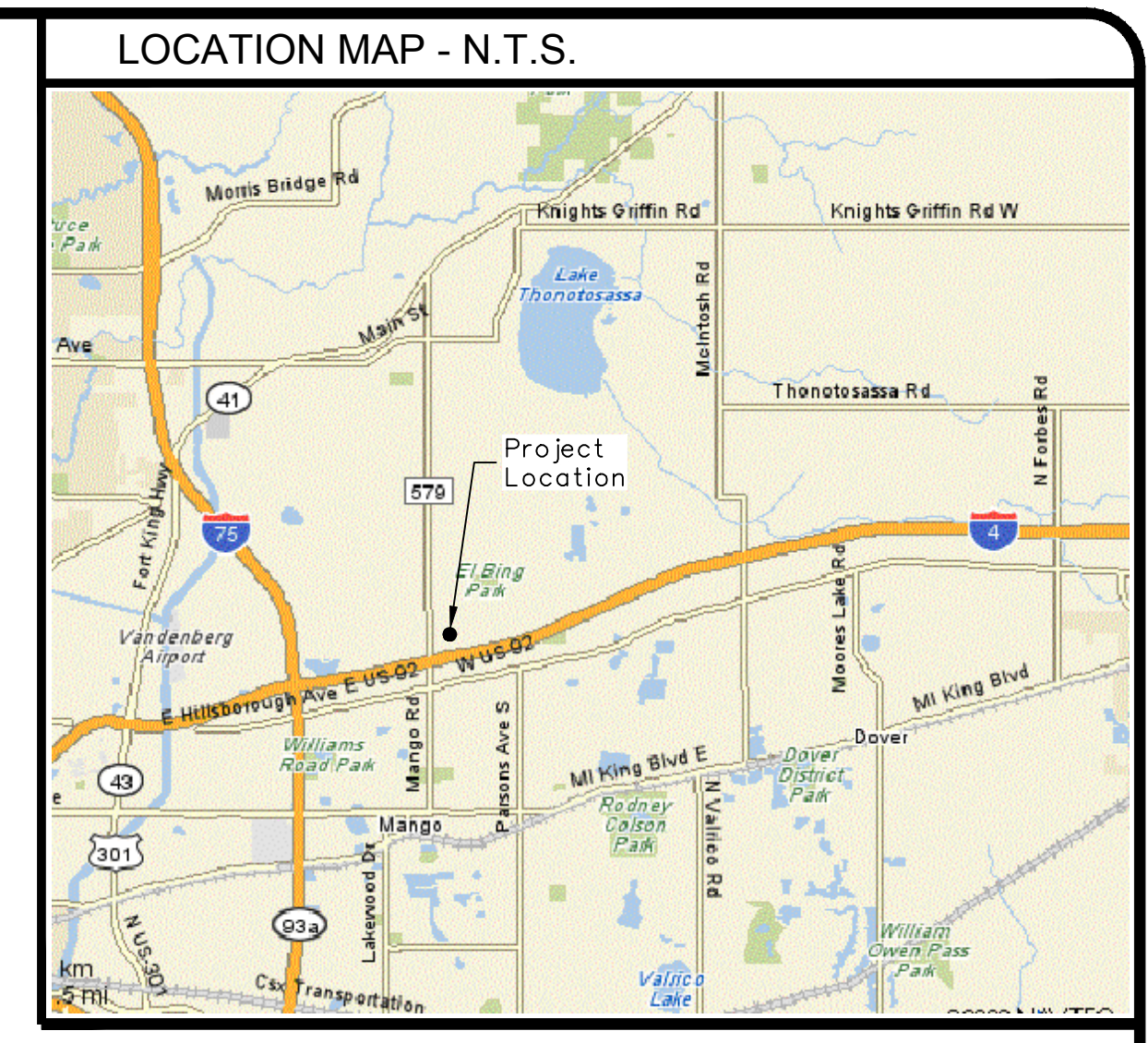
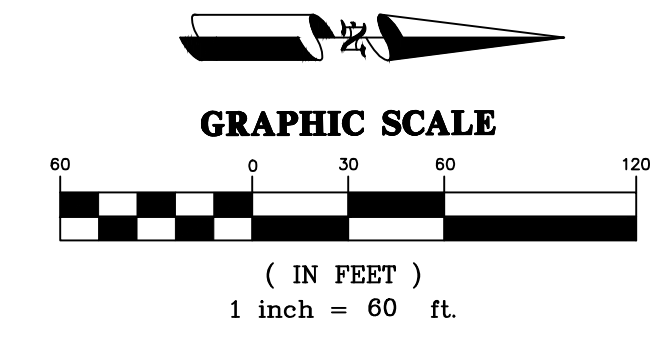
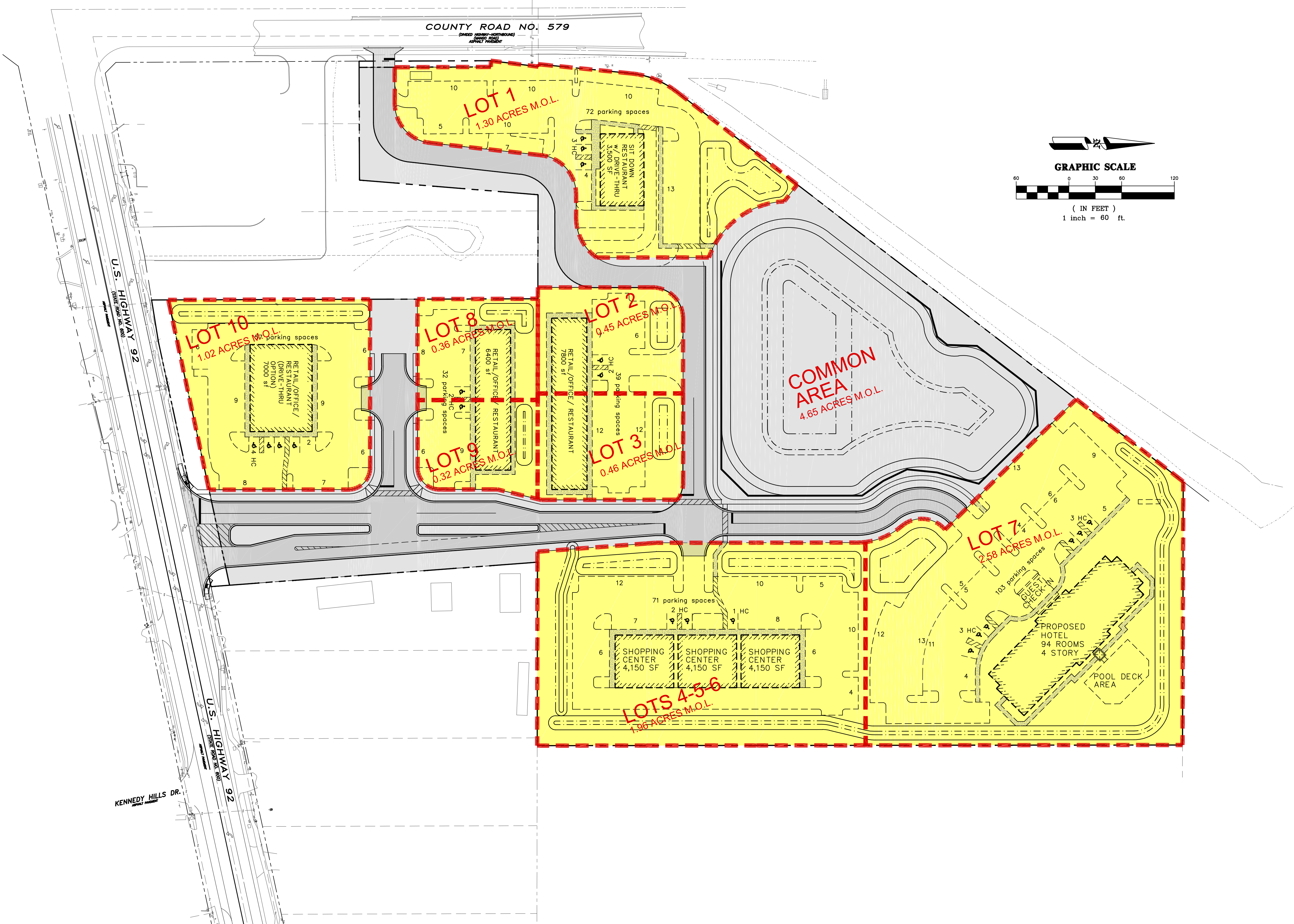

PARCEL PLAN  
NLG INVESTMENTS, INC.  
NE CORNER OF US HWY 92 & CR 579  
HILLSBOROUGH COUNTY, FLORIDA

**A. D. ENGINEERING, P. A.**  
"ENGINEERING EXCELLENCE"  
CERTIFICATE OF AUTHORIZATION NUMBER 27016  
P.O. BOX 292038 Tampa, Florida 33687 ph: (813) 579-7254  
email: adengineering@myrapidsys.com fax: (813) 868-0055  
web: www.adengineeringpa.com

SHEET 1 OF 1

| DATE | REVISION DESCRIPTION | NUMBER |
|------|----------------------|--------|
|      |                      |        |
|      |                      |        |
|      |                      |        |

A.D.E. PROJECT NO. AD15001

D:\projects\AD15001\Drawings\AD15001.dwg  
 Date: 05/11/2015 10:00 AM  
 User: AD15001  
 Plot: 05/11/2015 10:00 AM  
 Plotter: HP DesignJet 5000  
 Scale: 1:1  
 Sheet: 1 of 1