

# OFFERING MEMORANDUM

1506 Northern Blvd Manhasset NY | 1506 Northern Blvd Manhasset, NY 11030-3006



Commercial

## FOR LEASE



# EXECUTIVE SUMMARY

1506 Northern Blvd Manhasset NY | 1506 Northern Blvd Manhasset, NY 11030-3006

<b>Building Size:</b>	12,928 SF	<b>Zoning:</b>	Business A
<b>Available SF:</b>	2,900 SF	<b>Basement:</b>	Yes
<b>Parking:</b>	Rear Lot	<b>Lease Rate:</b>	\$55.00 PSF NNN

## Property Overview

Incredible Opportunity to lease 2,900 SF Retail Space in PRIME Location on the Miracle Mile in one of Manhasset's highest trafficked intersections (1 Block East of Northern Blvd & Shelter Rock Road). Share frontage with T.G.I. FRIDAYS, Lord & Taylor, WINDOW Rama, Nubest, Staples, Jos A. Bank and many others. Zoned Business-A in the Town of North Hempstead. Large parking lot in rear of the building and just seconds from the world-renowned Americana Mall. The space was formerly used for a learning center and is ideal for similar use or any retail or professional business. Clean basement for storage. Will not last!

*Exclusively represented by:*

**Michael G. Murphy**

President | Commercial Division  
631.858.2460 Email: michael.murphy@elliman.com

**STUART BAYER**

Licensed Associate Real Estate Broker  
516.375.1005 Email: stuart.bayer@elliman.com



# PROPERTY HIGHLIGHTS

1506 Northern Blvd Manhasset NY | 1506 Northern Blvd Manhasset, NY 11030-3006

- Amazing Miracle Mile Location
- 1/2 Mile to Renowned Americana Mall
- Large Parking Lot in Rear Offers Ample Parking
- Over 30,000 Cars Pass this Site Daily
- Ideal for Any Retail or Professional Use
- Clean Basement for Storage
- Highly Visible Location Surrounded by Major Retailers
- Tremendous Demographics

## Join Neighbors:



Exclusively represented by:

**Michael G. Murphy**

President | Commercial Division

631.858.2460 Email: michael.murphy@elliman.com

**STUART BAYER**

Licensed Associate Real Estate Broker

516.375.1005 Email: stuart.bayer@elliman.com

# ADDITIONAL PHOTOS

1506 Northern Blvd Manhasset NY | 1506 Northern Blvd Manhasset, NY 11030-3006



*Exclusively represented by:*

**Michael G. Murphy**

President | Commercial Division

631.858.2460 Email: michael.murphy@elliman.com

**STUART BAYER**

Licensed Associate Real Estate Broker

516.375.1005 Email: stuart.bayer@elliman.com



# FLOOR PLAN

1506 Northern Blvd Manhasset NY | 1506 Northern Blvd Manhasset, NY 11030-3006

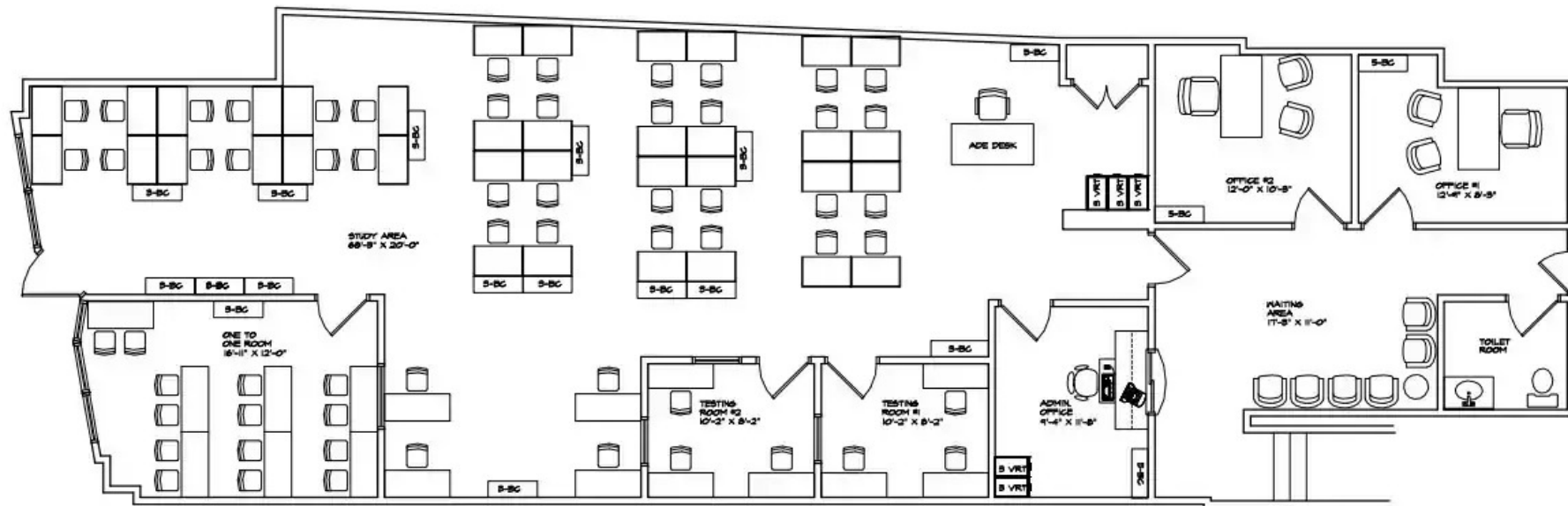

Exclusively represented by:

**Michael G. Murphy**

President | Commercial Division  
631.858.2460 Email: michael.murphy@elliman.com

**STUART BAYER**

Licensed Associate Real Estate Broker  
516.375.1005 Email: stuart.bayer@elliman.com

# DEMOGRAPHICS MAP & REPORT

1506 Northern Blvd Manhasset NY | 1506 Northern Blvd Manhasset, NY 11030-3006



## 1 Mile Radius

**Population**  
10,202  
**Households**  
3,592  
**Average HH Income**  
\$289,161

## 3 Miles Radius

**Population**  
111,157  
**Households**  
43,085  
**Average HH Income**  
\$204,645

## 5 Miles Radius

**Population**  
354,949  
**Households**  
134,355  
**Average HH Income**  
\$162,211

Exclusively represented by:

**Michael G. Murphy**

President | Commercial Division  
631.858.2460 Email: michael.murphy@elliman.com

**STUART BAYER**

Licensed Associate Real Estate Broker  
516.375.1005 Email: stuart.bayer@elliman.com



# RETAILER MAP

1506 Northern Blvd Manhasset NY | 1506 Northern Blvd Manhasset, NY 11030-3006



Exclusively represented by:

**Michael G. Murphy**

President | Commercial Division  
631.858.2460 Email: michael.murphy@elliman.com

**STUART BAYER**

Licensed Associate Real Estate Broker  
516.375.1005 Email: stuart.bayer@elliman.com



1506 Northern Blvd Manhasset NY | 1506 Northern Blvd Manhasset, NY 11030-3006

## EXCLUSIVELY REPRESENTED BY:

---



**Michael G. Murphy**

President | Commercial Division

631.858.2460

Email: [michael.murphy@elliman.com](mailto:michael.murphy@elliman.com)



**STUART BAYER**

Licensed Associate Real Estate Broker

516.375.1005

Email: [stuart.bayer@elliman.com](mailto:stuart.bayer@elliman.com)



550 Smithtown Bypass Suite 117

Smithtown, NY 11787

631.858.2405

[ellimancommercial.com](http://ellimancommercial.com)





## We Are Commercial Real Estate

550 Smithtown Bypass Suite 117  
Smithtown, NY 11787  
631.858.2405  
ellimancommercial.com

Commercial real estate involves more than just property listings. To get the most effective results, you need to partner with a company that has a full complement of services and an in-depth team of professionals to help with all your needs. Douglas Elliman's team of commercial real estate experts is committed to unrivaled performance standards when working with tenants, investors, purchasers and owners. We represent all major property types including office, industrial, retail, apartment and land. We treat each other each assignment with commitment and focus, from a single transaction in a local market to national and multi-market assignments. We help negotiate contracts, coordinate construction and provide both property management as well as ongoing advisory service to satisfy your changing real estate needs. Our breadth of market knowledge, unprecedented network and use of innovative technology extend to all types of property transactions. For information on our services please contact us today.