



FOR LEASE - ±5,725 SF INDUSTRIAL UNIT

1856 CARNEGIE AVENUE | SANTA ANA, CA



PROPERTY FEATURES:

- » Part of a Larger ±25,087 SF Building
- » ±5,725 SF Unit
- » ±1,400 SF of Office
- » 14' Warehouse Clearance
- » One (1) Ground Level Loading Door
- » 200 Amps (verify)
- » 2:1,000 Car Parking (Secured Rear Parking Possible)
- » Drive Around Access
- » Great Access to Costa Mesa (55) Freeway
- » Irvine Business Complex Location
- » In Close Proximity to the District at Tustin Legacy and Diamond Jamboree Shopping Destination

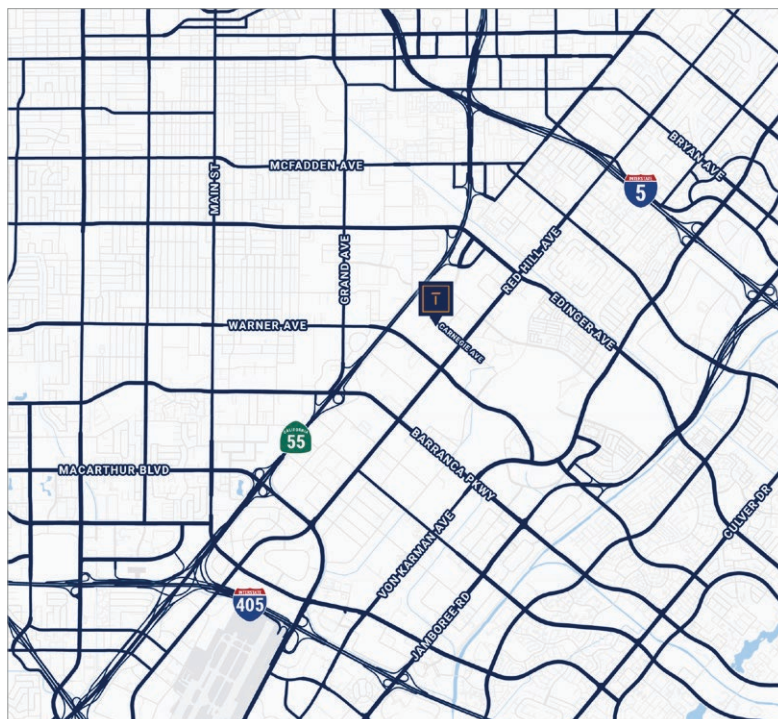

CONTACT US:

PAT LACEY
Executive Director

(714) 875-4134
pat@tidemarkrealestate.com
DRE Lic. 00988663

TAYLOR SNYDER, MBA
Senior Vice President

(949) 533-1321
taylor@tidemarkrealestate.com
DRE Lic. 02092420

WILL GREUBEL
Senior Vice President

(714) 614-7623
will@tidemarkrealestate.com
DRE Lic. 02039807

STEPHEN MARGARETIS
Senior Associate

(949) 439-1988
stephen@tidemarkrealestate.com
DRE Lic. 02112014

TIDEMARK
Real Estate Services

DISCLAIMER: The information contained herein has been obtained from the property owner or other third party and is provided to you without verification as to accuracy. We (Tidemark Real Estate Services, Inc., its brokers, employees, agents, principals, officers, directors and affiliates) make no warranty or representation regarding the information, property, or transaction. You and your attorneys, advisors and consultants should conduct your own investigation of the property and transaction.

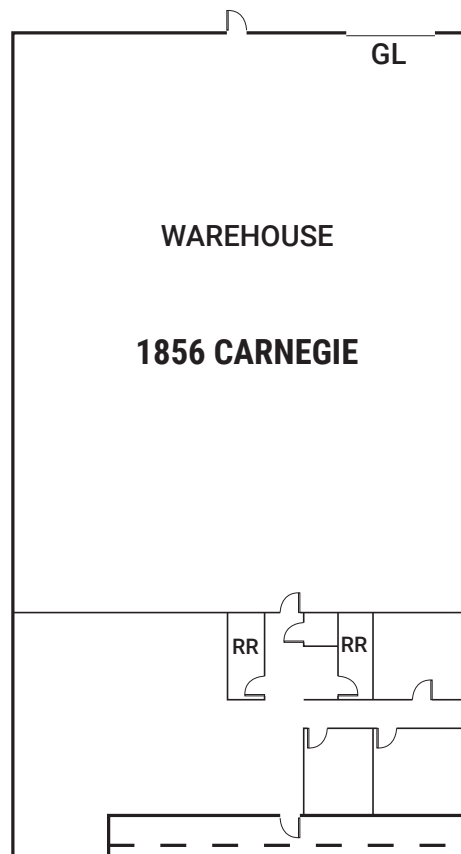

CONTACT US:

PAT LACEY
Executive Director
(714) 875-4134
pat@tidemarkrealestate.com
DRE Lic. 00988663

TAYLOR SNYDER, MBA
Senior Vice President
(949) 533-1321
taylor@tidemarkrealestate.com
DRE Lic. 02092420

WILL GREUBEL
Senior Vice President
(714) 614-7623
will@tidemarkrealestate.com
DRE Lic. 02039807

STEPHEN MARGARETIS
Senior Associate
(949) 439-1988
stephen@tidemarkrealestate.com
DRE Lic. 02112014

TIDEMARK
Real Estate Services

DISCLAIMER: The information contained herein has been obtained from the property owner or other third party and is provided to you without verification as to accuracy. We (Tidemark Real Estate Services, Inc., its brokers, employees, agents, principals, officers, directors and affiliates) make no warranty or representation regarding the information, property, or transaction. You and your attorneys, advisors and consultants should conduct your own investigation of the property and transaction.