

INDUSTRIAL LAND FOR

# LEASE

**LEE & ASSOCIATES**  
COMMERCIAL REAL ESTATE SERVICES

**Major Price Reduction!**



**909-911 Center St, Riverside, CA 92507**  
**±1.61 Acres (±70,000 SF) of Industrial Land**

### PROPERTY HIGHLIGHTS

- ±1.61 Acres Contractor Yard
- ±9,600 SF of Metal Warehouse
- Secured Fenced Yard
- New Concrete
- Two Street Access
- Renovated Offices

### PRICING SUMMARY

- **LEASE RATE: \$23,100/Mo GRS (\$0.33 PSF)**

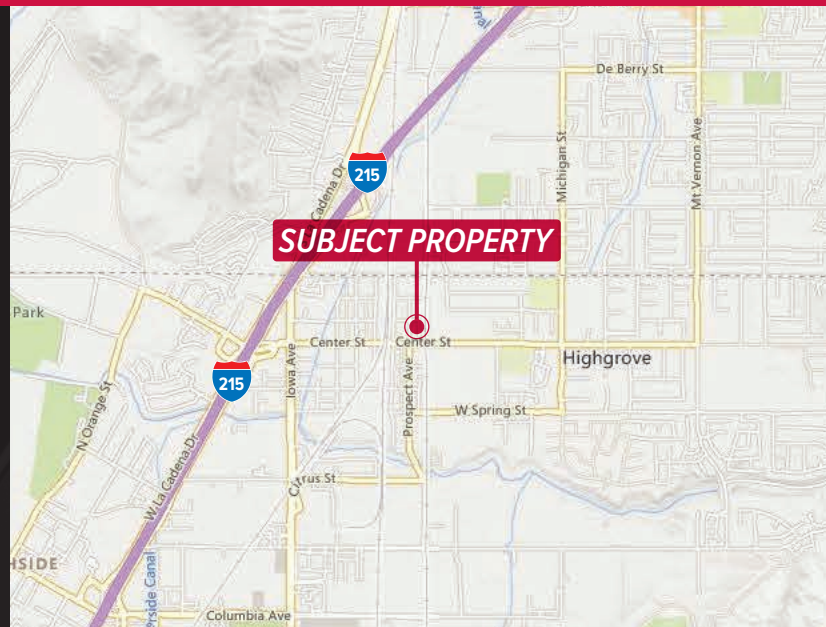

### Peter D. Bacci

SIOR | Executive VP, Principal | LIC NO 00946253  
pbacci@lee-associates.com  
323.767.2022

### Michael H. Tsaparian

SIOR | CCIM Executive VP, Principal | LIC NO 0901326  
mtsaparian@lee-associates.com  
323.767.2111

### Steve R. Espinoza

Industrial Specialist | LIC NO 02025080  
sespinoza@lee-associates.com  
562.457.7746

Lee & Associates | Los Angeles Central  
5675 Telegraph Rd, Ste 300, Commerce, CA 90040

**LEE-ASSOCIATES.COM**  
CORP ID 01125429

The information contained herein is obtained from sources believed to be reliable. However, we have not verified it and make no guarantees, warranties or representations as to the completeness or accuracy thereof. The presentation of this property is used for example and is submitted subject to errors, omissions, change of price or conditions, and is subject to prior sale, lease or withdrawal without notice.

# INDUSTRIAL LAND FOR LEASE

## PROPERTY SITE PLAN

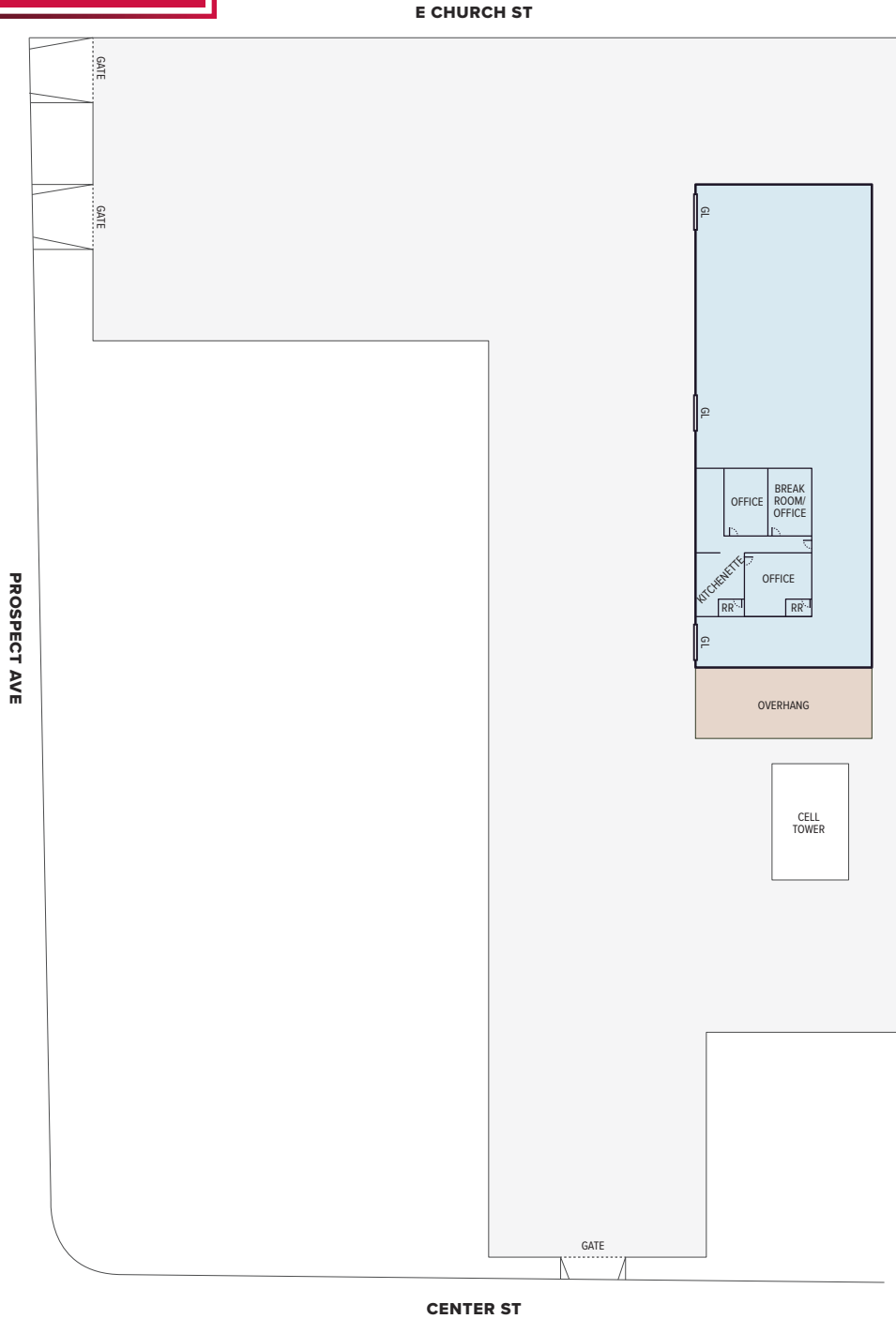

NOTE: Drawing not to scale. All measurements and sizes are approximate.

909-911 Center St, Riverside, CA 92507

**±1.61 Acres (±70,000 SF) of Industrial Land**

**Peter D. Bacci**

SIOR | Executive VP, Principal | LIC NO 00946253

[pbacci@lee-associates.com](mailto:pbacci@lee-associates.com)

323.767.2022

**Michael H. Tsaparian**

SIOR | CCIM Executive VP, Principal | LIC NO 0901326

[mtsaparian@lee-associates.com](mailto:mtsaparian@lee-associates.com)

323.767.2111

**Steve R. Espinoza**

Industrial Specialist | LIC NO 02025080

[sespinoza@lee-associates.com](mailto:sespinoza@lee-associates.com)

562.457.7746