

# The Obama

22000 GRAND RIVER AVENUE, DETROIT  
UNIT 1

## AVAILABLE SQUARE FEET:

# 912

### DIMENSIONS

26' 4" x 31' 6"

### DETAILS

- Turnkey project delivery
- Secure access
- Shared common bathroom
- Shared kitchenette
- Large window along Redford St.
- HVAC & electric distributed
- 12' ceiling
- Wifi available

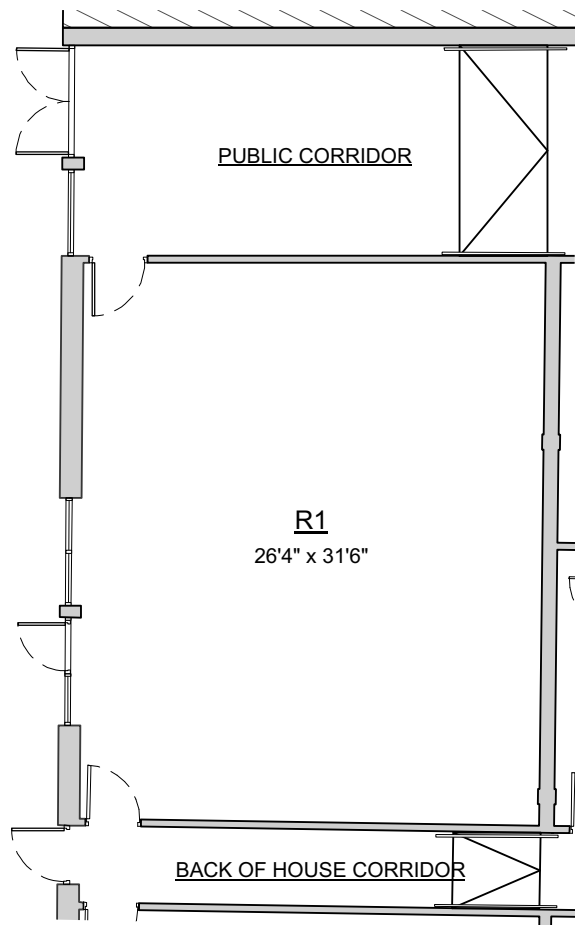

### BUILDING KEY

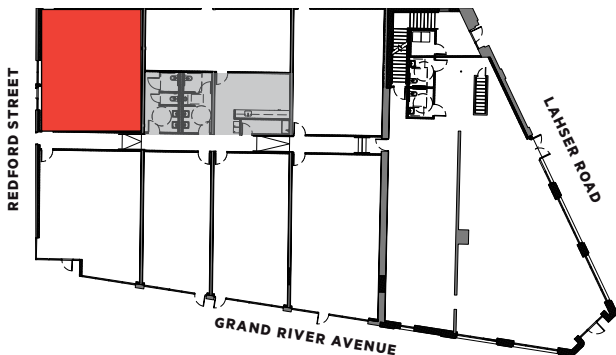

# The Obama

22000 GRAND RIVER AVENUE, DETROIT  
UNIT 2

## AVAILABLE SQUARE FEET:

# 948

### DIMENSIONS

26' x 31' 4"

### DETAILS

- Turnkey project delivery
- Secure access
- Shared common bathroom
- Shared kitchenette
- Large window storefront along Grand River
- HVAC & electric distributed
- 12' ceiling
- Wifi available

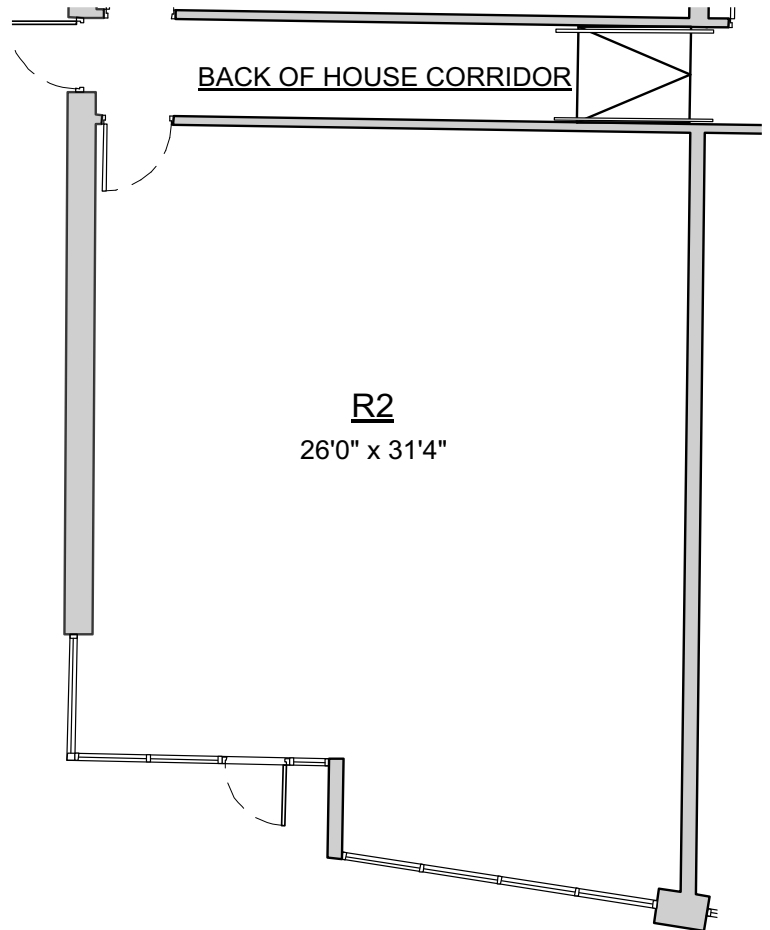

### BUILDING KEY

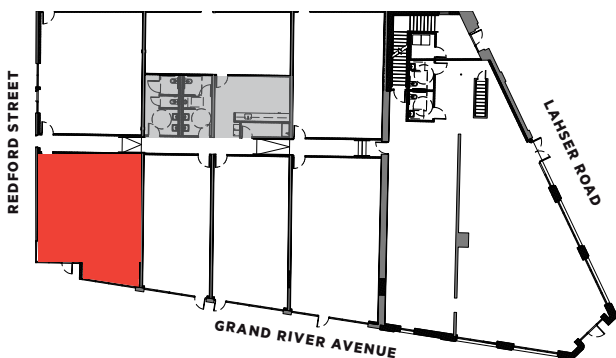

# The Obama

22000 GRAND RIVER AVENUE, DETROIT  
UNIT 3

## AVAILABLE SQUARE FEET:

# 722

### DIMENSIONS

17' 6" x 35' 4"

### DETAILS

- Turnkey project delivery
- Secure access
- Shared common bathroom
- Shared kitchenette
- Large window storefront along Grand River
- HVAC & electric distributed
- 12' ceiling
- Wifi available

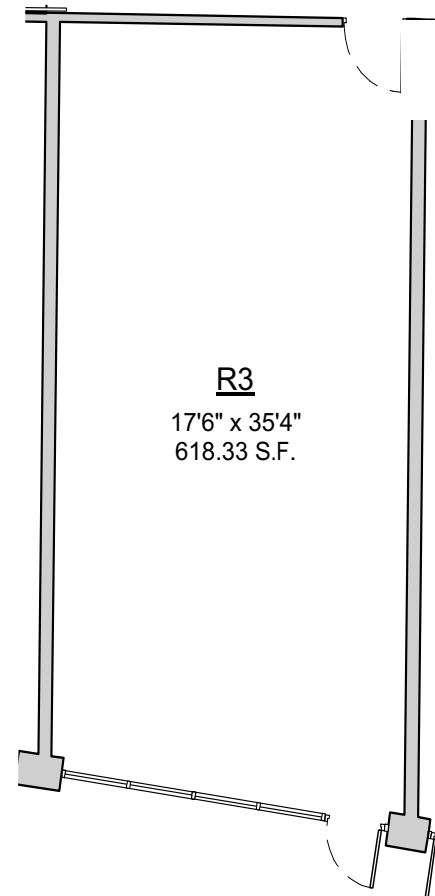

### BUILDING KEY

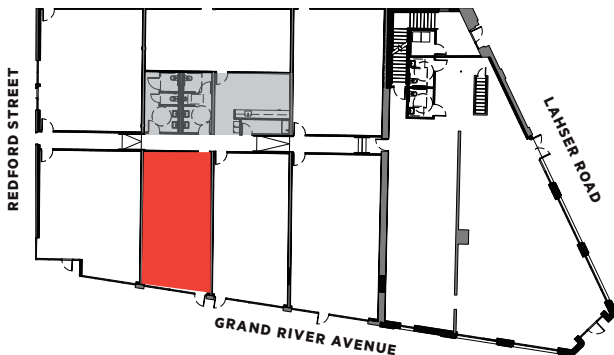

# The Obama

22000 GRAND RIVER AVENUE, DETROIT  
UNIT 4

## AVAILABLE SQUARE FEET:

# 812

### DIMENSIONS

19' 6" x 38' 3"

### DETAILS

- Turnkey project delivery
- Secure access
- Shared common bathroom
- Shared kitchenette
- Large window storefront along Grand River
- HVAC & electric distributed
- 12' ceiling
- Wifi available

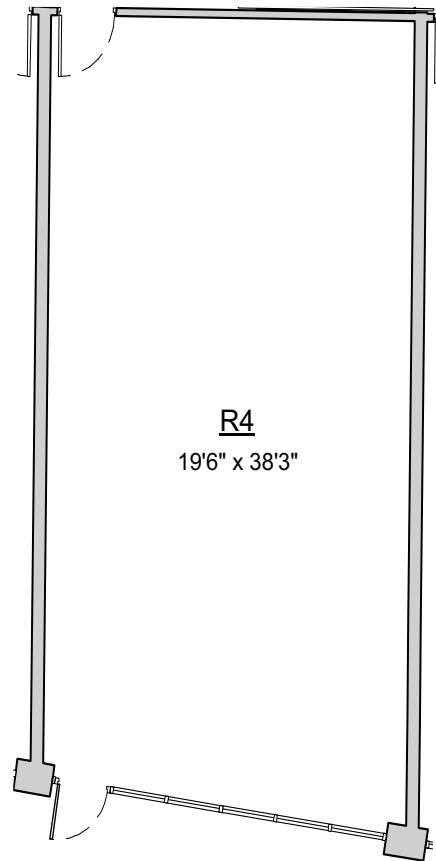

### BUILDING KEY

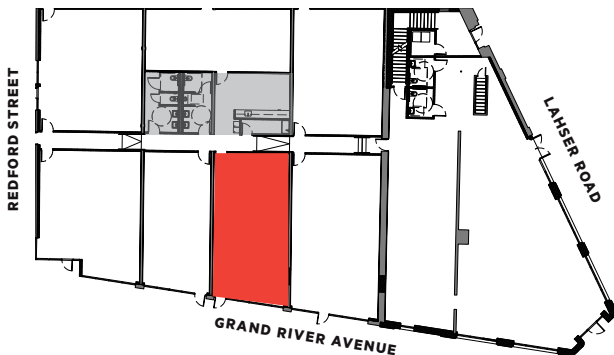

RETAIL SPACE FOR LEASE

PLATFORM LEASING & BROKERAGE

# The Obama

22000 GRAND RIVER AVENUE, DETROIT  
UNIT 5

## AVAILABLE SQUARE FEET:

# 1,123

### DIMENSIONS

23' x 42'

### DETAILS

- Turnkey project delivery
- Secure access
- Shared common bathroom
- Shared kitchenette
- Large window storefront along Grand River
- HVAC & electric distributed
- 12' ceiling
- Wifi available

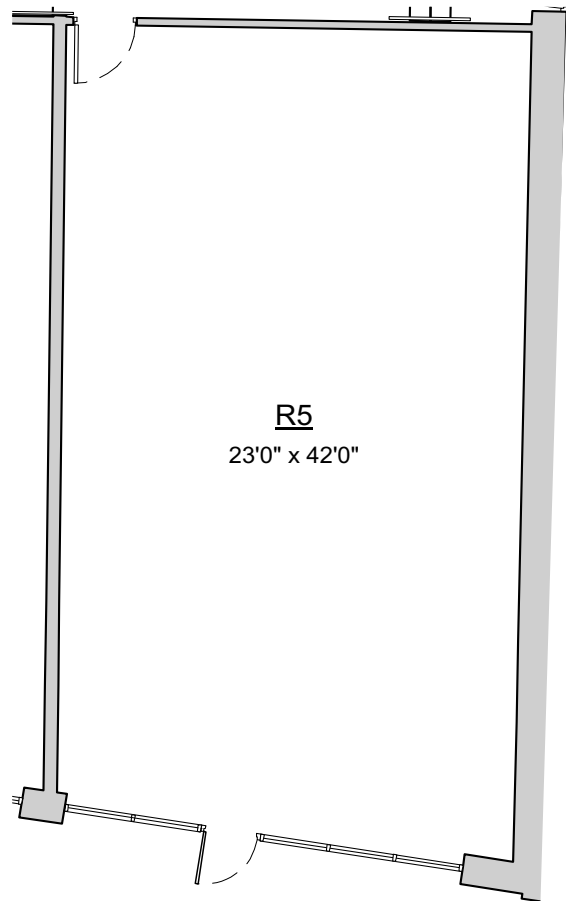

### BUILDING KEY

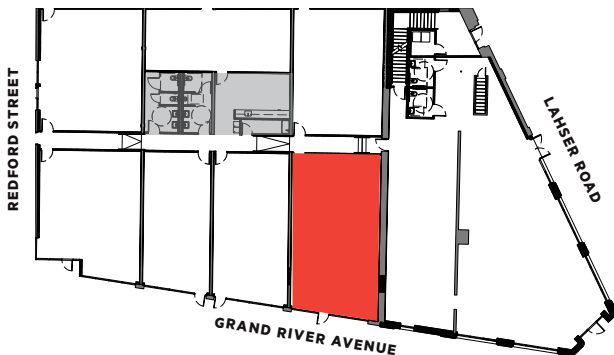

# The Obama

22000 GRAND RIVER AVENUE, DETROIT  
UNIT 6

## AVAILABLE SQUARE FEET:

# 825

### DIMENSIONS

23' 3" x 32' 6"

### DETAILS

- Turnkey project delivery
- Secure access
- Shared common bathroom
- Shared kitchenette
- HVAC & electric distributed
- 12' ceiling
- Wifi available

### BUILDING KEY

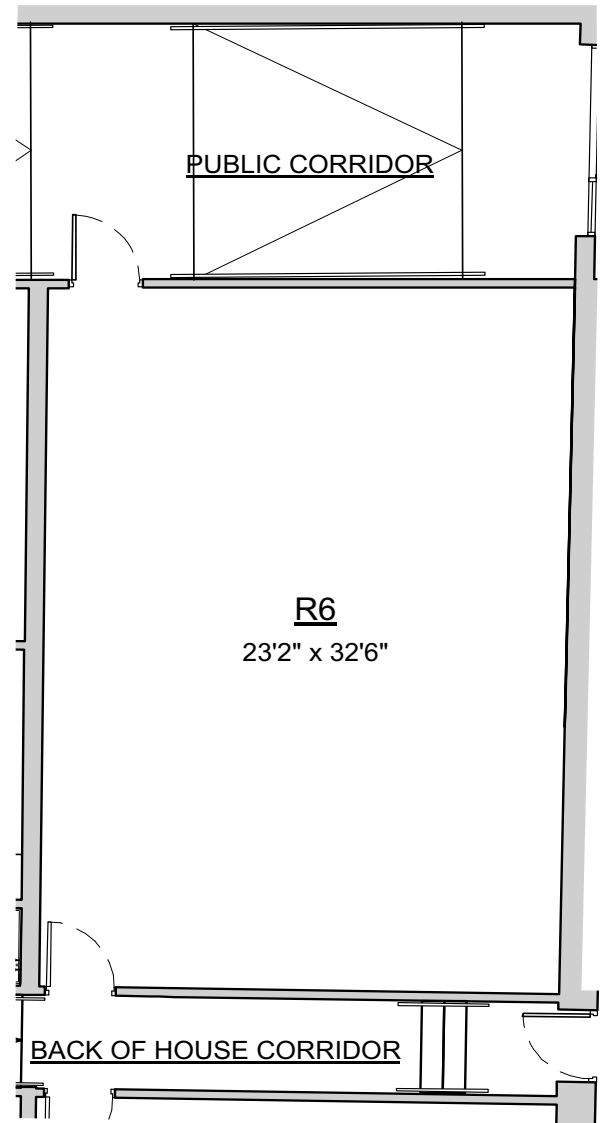
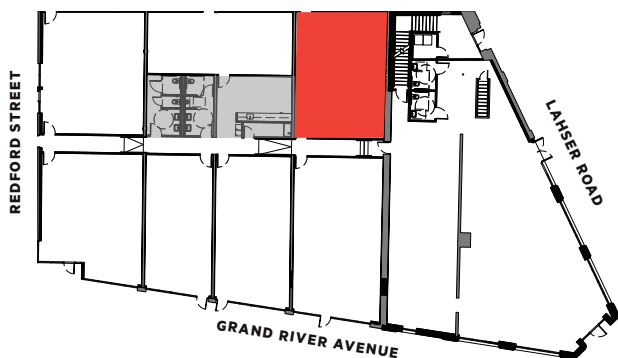

# The Obama

22000 GRAND RIVER AVENUE, DETROIT  
UNIT 7

## AVAILABLE SQUARE FEET:

# 657

### DIMENSIONS

37' 6" x 16' 1"

### DETAILS

- Turnkey project delivery
- Secure access
- Shared common bathroom
- Shared kitchenette
- HVAC & electric distributed
- 12' ceiling
- Wifi available

### BUILDING KEY

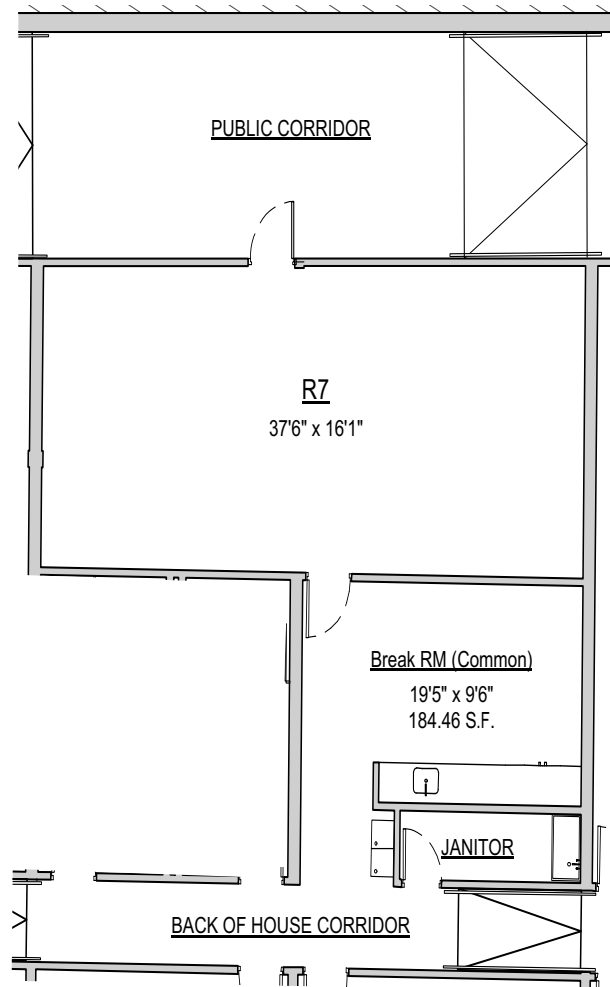
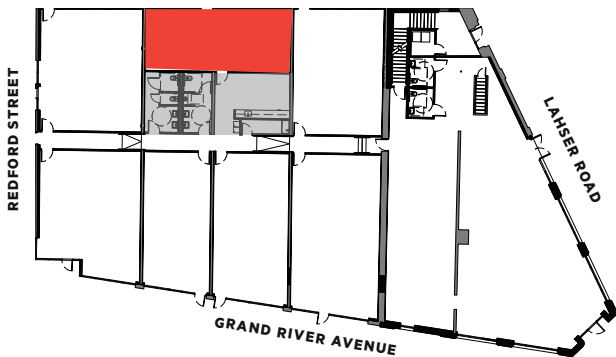

# The Obama

22000 GRAND RIVER AVENUE, DETROIT  
UNIT 8

## AVAILABLE SQUARE FEET:

# 2,990

### DIMENSIONS

- Turnkey project delivery
- Frontage along Grand River and Lahser Rd.
- HVAC & electric distributed
- 2 restrooms installed
- 12' ceiling
- Wifi available

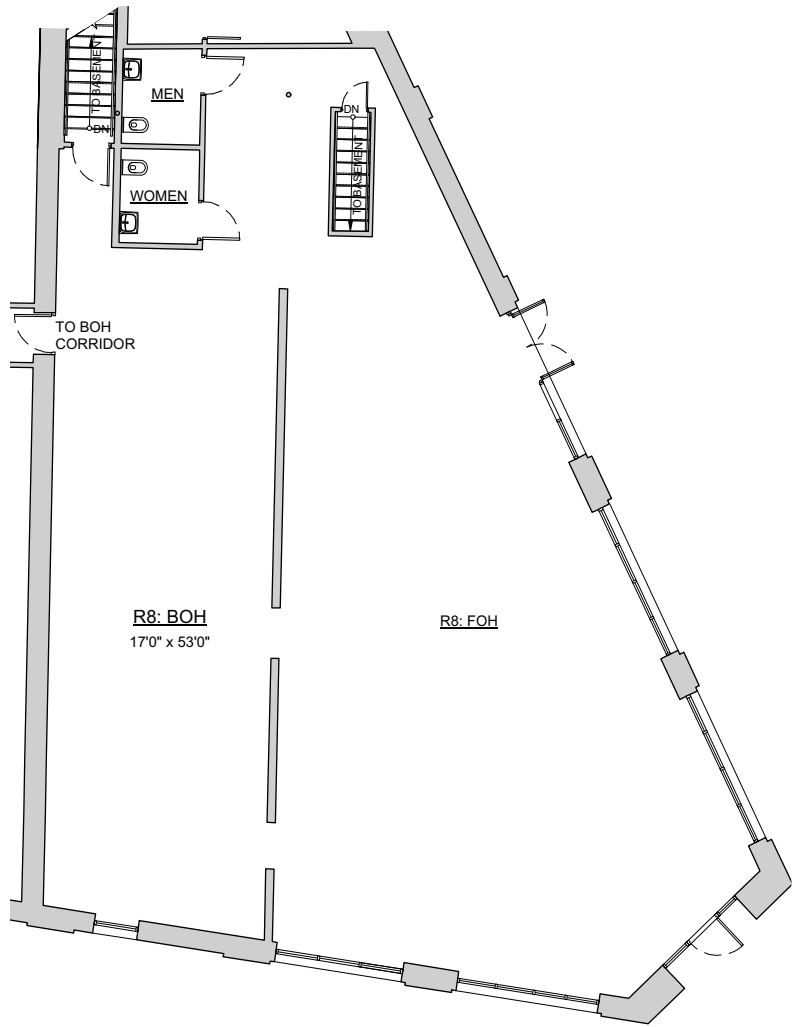

### BUILDING KEY

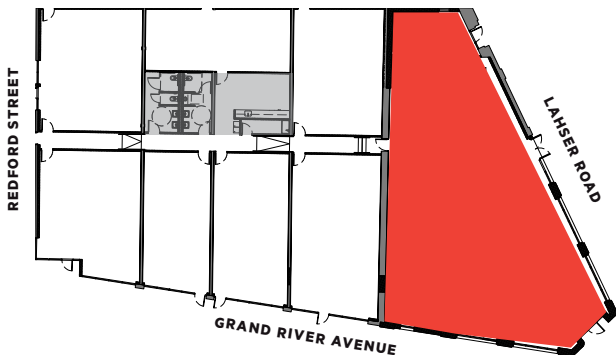

RETAIL SPACE FOR LEASE

PLATFORM LEASING & BROKERAGE