



FOR LEASE
±20,613 SF
INDUSTRIAL BUILDING

7240
E SLAUSON AVE
COMMERCE, CA 90040

PRICING SUMMARY:
LEASE RATE ▶
\$22,468/ MO
\$1.09/ MO GROSS (OPEX: \$0.03)

PROPERTY HIGHLIGHTS



HIGH IMAGE BUILDING



PRESTIGIOUS OXFORD BUSINESS PARK



LARGE SHOWROOM



18' CLEARANCE



MAJOR BOULEVARD FRONTAGE



EXCELLENT ACCESS TO 5 & 710 FREEWAYS

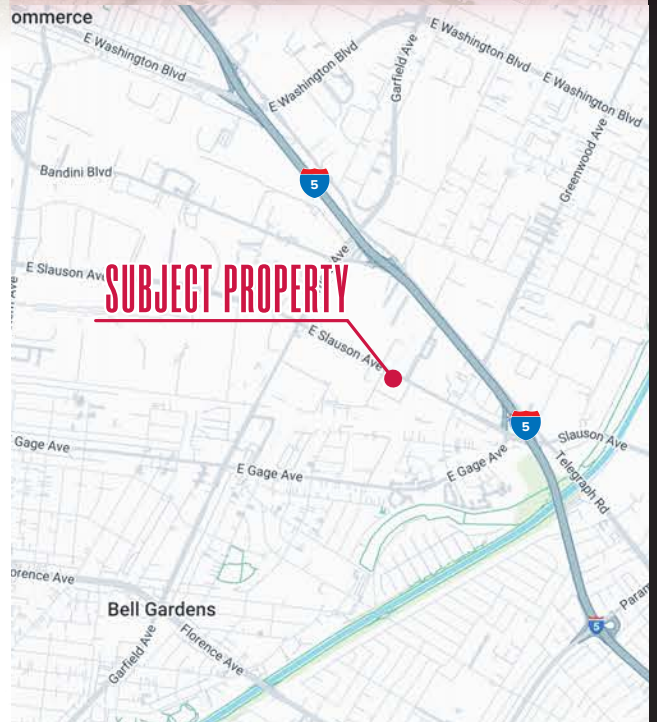

Peter D. Bacci
SIOR | Executive VP, Principal | LIC #00946253
pbacci@lee-associates.com
323.767.2022

Jeff Bethel
SVP, Principal | LIC #00158766
jbethel@lee-associates.com
562.568.2002

Caroline Bethel
LIC #02117058
cbethel@lee-associates.com
562.568.2029

Bob Drown
Associate | LIC #02163092
bdrown@lee-associates.com
626.701.2402

±20,613 SF Industrial Building

7240 S SLAUSON AVE • COMMERCE 90040

LEE & ASSOCIATES
COMMERCIAL REAL ESTATE SERVICES

IA IG
BACCI • TSAPARIAN • GORMLY
INDUSTRIAL GROUP

PROPERTY SITE PLAN

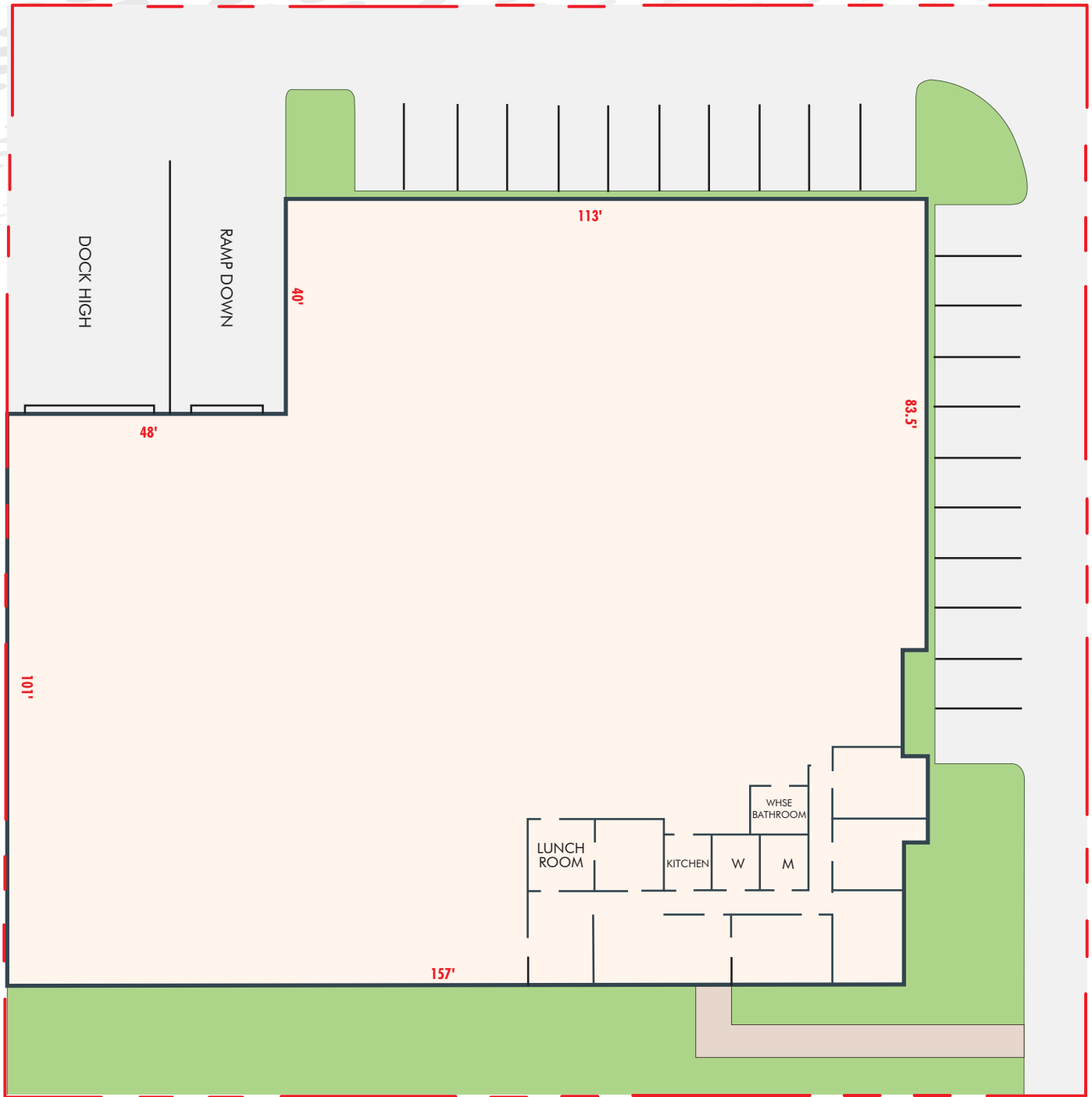

NOTE: Drawing not to scale. All measurements and sizes are approximate.

Peter D. Bacci

SIOR | Executive VP, Principal | LIC #00946253

pbacci@lee-associates.com
323.767.2022

Jeff Bethel

SVP, Principal | LIC #00158766

jbethel@lee-associates.com
562.568.2002

Caroline Bethel

LIC #02117058

cbethel@lee-associates.com
562.568.2029

Bob Drown

Associate | LIC #02163092

bdrown@lee-associates.com
626.701.2402

Lee & Associates | Los Angeles Central
5675 Telegraph Rd, Ste 300, Commerce, CA 90040

LEE-ASSOCIATES.COM
CORP ID 01125429

The information contained herein is obtained from sources believed to be reliable. However, we have not verified it and make no guarantees, warranties or representations as to the completeness or accuracy thereof. The presentation of this property is used for example and is submitted subject to errors, omissions, change of price or conditions, and is subject to prior sale, lease or withdrawal without notice.