



NEW DISCOUNTED RATE! ONLY \$5.00/SF + NNN!

PROPERTY DETAILS

ADDRESS:	1351 East Bardin Road, Arlington, Texas 76018
TOTAL SF:	116,760 SF
AVAILABLE SF:	46,228 SF
YEAR BUILT:	2003
PARKING SPACES:	649 (5.62 per 1,000 SF)
ELECTRICITY:	2,400-Amp, 480/277-Volt
RATE:	\$5.00/SF + NNN



TIM TERRELL
214.267.0406 | tterrell@streamrealty.com

CHRIS DOGGETT
817.877.1316 | chris.doggett@streamrealty.com





SUITE 100 DETAILS

ADDRESS:	1351 East Bardin Road, Suite 100, Arlington, Texas 76018
AVAILABLE SF:	46,228 SF
YEAR BUILT:	2003
PARKING SPACES:	649 (5.62 per 1,000 SF)
ELECTRICITY:	2,400-Amp, 480/277-Volt
RATE:	\$5.00/SF + NNN

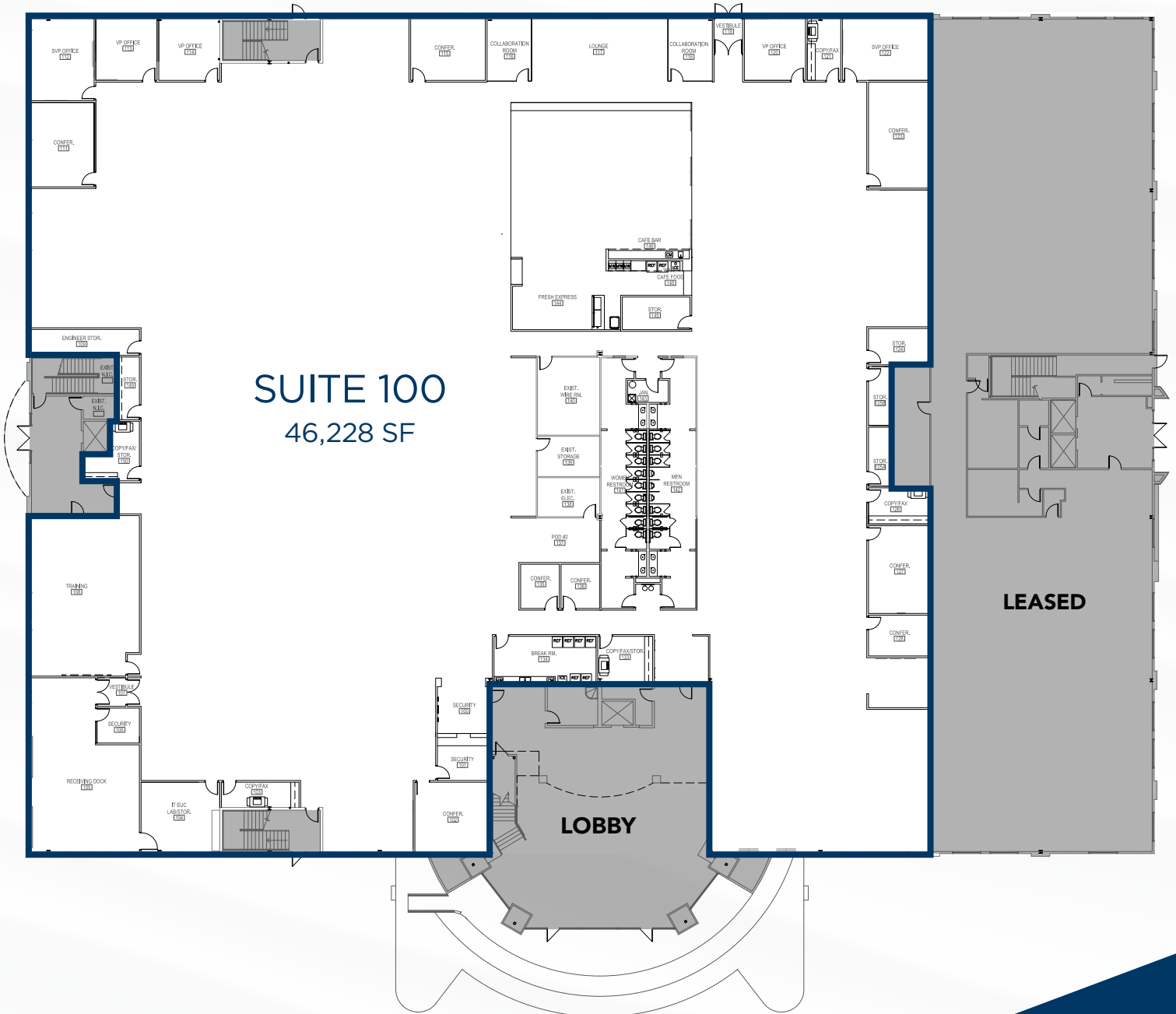

TIM TERRELL

214.267.0406 | tterrell@streamrealty.com

CHRIS DOGGETT

817.877.1316 | chris.doggett@streamrealty.com

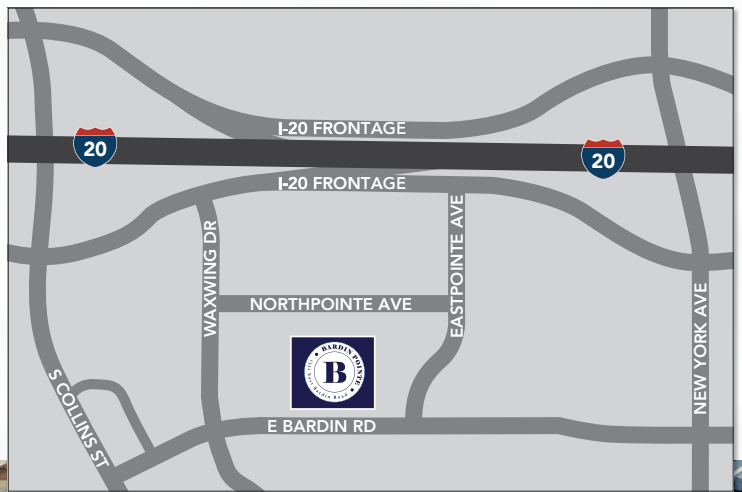

Recently Completed
Parking Expansion

TIM TERRELL

214.267.0406 | tterrell@streamrealty.com

CHRIS DOGGETT

817.877.1316 | chris.doggett@streamrealty.com



LOCATION HIGHLIGHTS



ENTERTAINMENT CAPITAL OF TEXAS

Arlington hosts over 14 million visitors each year.



AT&T STADIUM

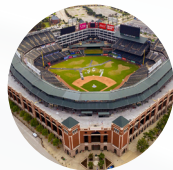

GLOBE LIFE PARK

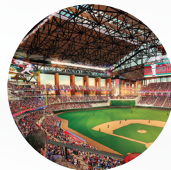

GLOBE LIFE FIELD



TEXAS LIVE!



SIX FLAGS OVER TEXAS



THE PARKS MALL

FORMER HOST CITY OF:



TIM TERRELL

214.267.0406 | tterrell@streamrealty.com

CHRIS DOGGETT

817.877.1316 | chris.doggett@streamrealty.com

STREAM

www.streamrealty.com