

Lease
1541 South 300 West
Salt Lake City, UT



LEASE RATE

\$1.18
PSF NNN



PROPERTY DETAILS

Total SF: 3,600 SF
Office: 750 SF
Warehouse: 2,850 SF
Doors: (1) 10' x 10' GL
Ceiling: 12' Clear



HIGHLIGHTS

- Direct signage to high traffic 300 West (60 linear feet)
- Great layout with two private offices and two restrooms
- Fully fenced parking in the rear of the building
- Great location with freeway access within minutes
- Space to get updated LED lighting and fresh paint
- Large glass storefront windows allowing for ample natural light

CONTACT

Bob Mills

385.988.6477
bob@adventut.com

Riley Mills

385.988.6478
riley@adventut.com



5284 S. Commerce Dr. #C 274, Murray, Utah 84107 / o:801.433.2480 f: 801.290.3172

Lease
1541 South 300 West
Salt Lake City, UT

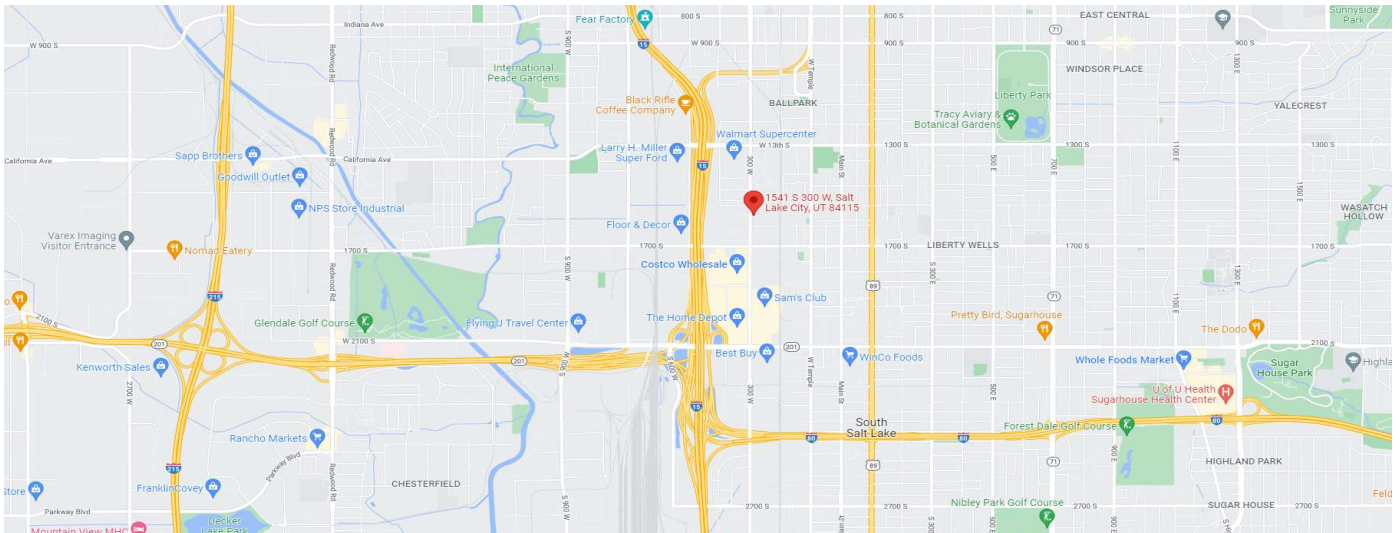
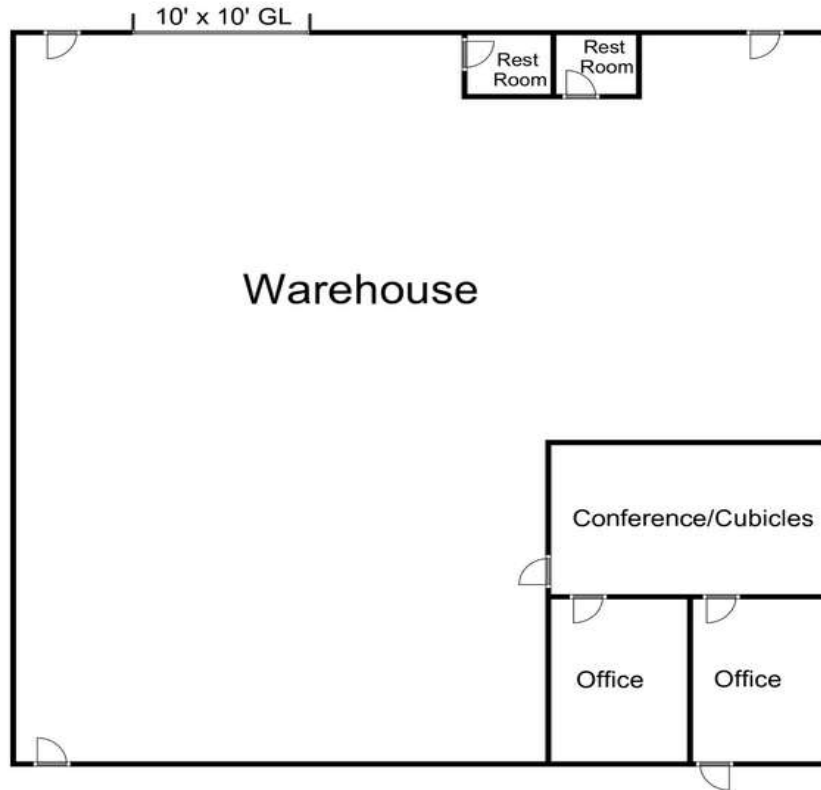

5284 S. Commerce Dr. #C 274, Murray, Utah 84107 / o:801.433.2480 f: 801.290.3172