

# 40,338 SF

For Sublease



## 2680 W. Lake Street

Melrose Park, IL

### 40,338 SF

For Sublease

### Trailer Parking

6 Stalls

### Sublease

through September 30, 2026



## Specifications

- **±40,338 SF Available for Sublease**
- 22' ceiling height
- 7 exterior docks, 2 interior docks
- 1 drive-in door
- Trailer parking: 6 stalls
- Car parking: 20 spaces
- 3,752 sf office
- T-5 lighting
- ±102,153 sf building
- Lease Rate: Subject to Offer
- Sublease through September 30, 2026



**NICK KREJCI**  
Partner  
[nkrejci@coreindrealty.com](mailto:nkrejci@coreindrealty.com)  
630-200-3874

**MATTHEW LEE**  
Partner  
[mlee@coreindrealty.com](mailto:mlee@coreindrealty.com)  
847-715-8538

2680 W. Lake Street  
Melrose Park, IL

**40,338 SF** For Sublease

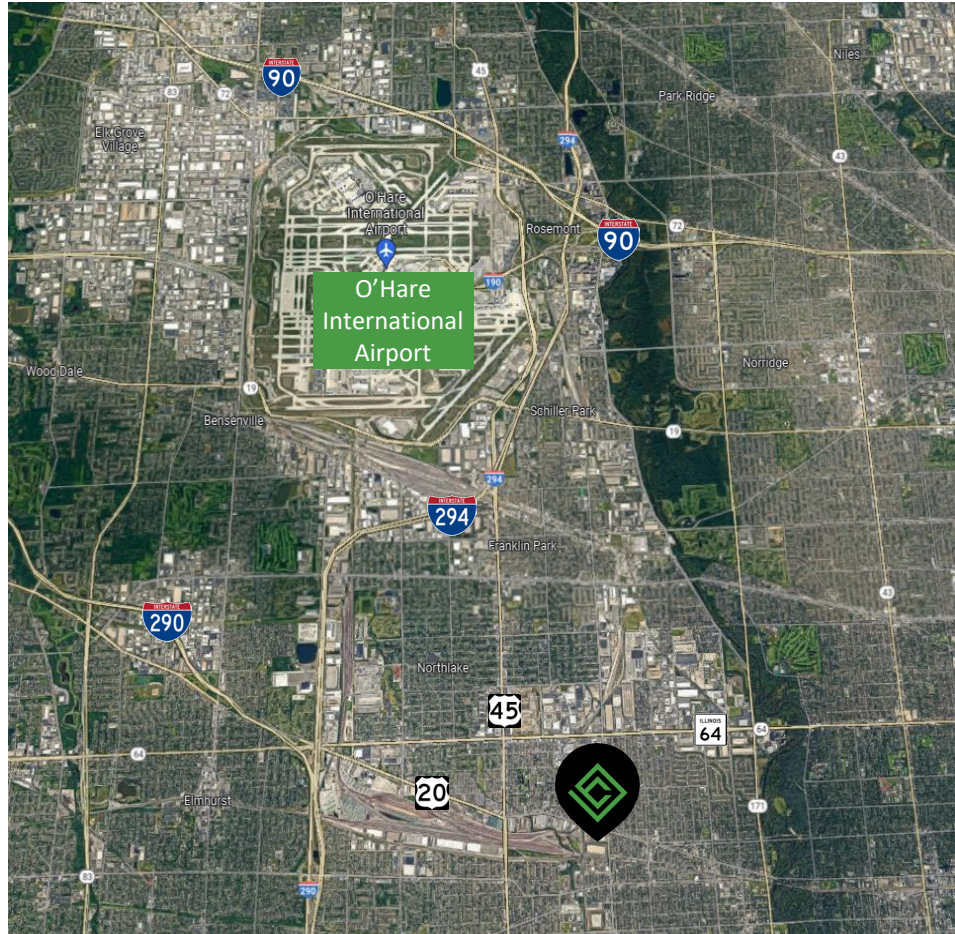
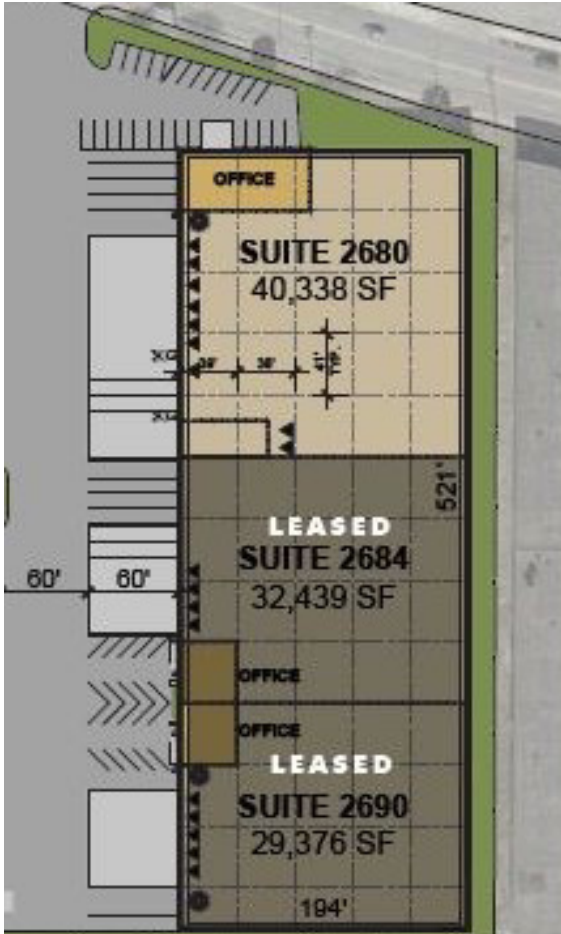

**CORE INDUSTRIAL REALTY**

1211 W. 22nd Street, Suite 529  
Oak Brook, IL 60523  
[coreindrealty.com](http://coreindrealty.com) | 630-786-2424

**NICK KREJCI**  
Partner  
[nkrejci@coreindrealty.com](mailto:nkrejci@coreindrealty.com)  
630-200-3874

**MATTHEW LEE**  
Partner  
[mlee@coreindrealty.com](mailto:mlee@coreindrealty.com)  
847-715-8538

Submitted subject to error, change in status or withdrawal without notice.