

- LEGEND**
- EX. MANHOLE
  - ▽ EX. VESICANT
  - EX. LIGHTPOLE
  - ⊞ EX. TRAFFIC SIGNAL
  - EX. PEDESTAL
  - EX. TRANSFORMER
  - FOUND IRON

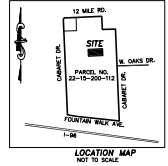

COMMERCIAL  
 CITY OF INDIANAPOLIS  
 INDUSTRIAL & BUILDING  
 CONSTRUCTION LAYOUT  
 PARCEL NO. 25-14-200-112

RESIDENTIAL  
 CITY OF INDIANAPOLIS  
 MULTIFAMILY HOUSING  
 CONSTRUCTION LAYOUT  
 PARCEL NO. 25-14-200-112

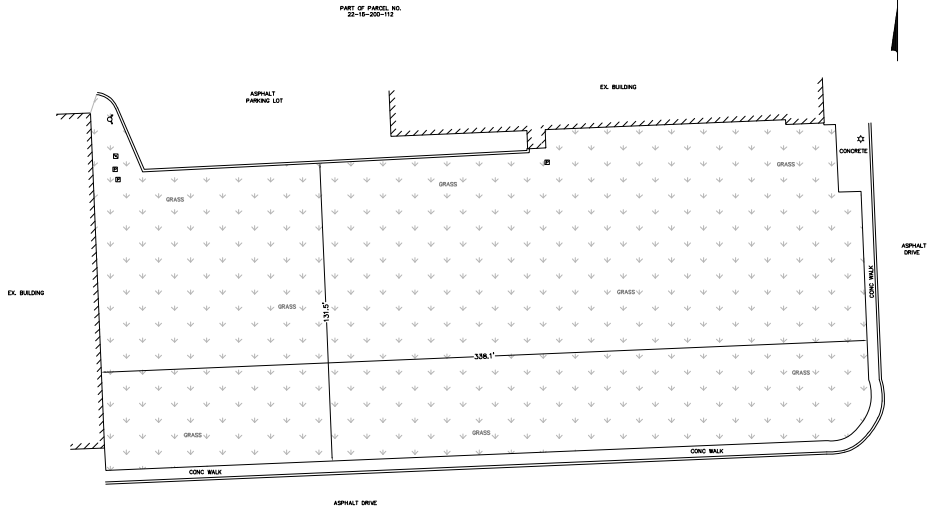

**811**  
 Dig safely below  
 Call before you dig

CLIENT: GREEN EARTH REALTY  
**AREA PLAN**  
 TWELVE MILE CROSSING - PAD SITES  
 SECTION 16  
 CITY OF INDIANAPOLIS  
 INDIANA, MICHIGAN

DATE:	2-17-21
DRAWN BY:	JIV
CHECKED BY:	GLM
SCALE:	AS SHOWN
FIG. NO.:	379/282
DATE PLOTTED:	
SCALE:	1/8" = 1'-0" (20 FT)
DATE:	2-17-21

**NOTICE:**  
 CONSTRUCTION SITE SAFETY IS THE SOLE RESPONSIBILITY OF THE CONTRACTOR WITHIN THE DRAINAGE DISTRICT. THE DESIGNER SHALL BE RESPONSIBLE TO ISSUE AN INDICATION OF THE SAFETY OF THE WORK, OF PERSONS INVOLVED IN THE WORK, OF ANY NEARBY STRUCTURES OR OF ANY OTHER PERSONS.

**NOTE:**  
 THE LOCATION OF EXISTING UNDERGROUND UTILITIES AND SHOWN IN AN APPROPRIATE MANNER AND DISCLOSED BY AVAILABLE UTILITY COMPANY RECORDS AND THAT NOT BEEN RECORDED BY THE CITY OF INDIANAPOLIS. TO GUARANTEE THE EXACT LOCATION OF ALL EXISTING UTILITIES BEFORE CONSTRUCTION WORK, AND JAMES TO BE FULLY RESPONSIBLE FOR ANY AND ALL DAMAGES WHICH MAY BE OCCURRED BY THE CONTRACTOR'S FAILURE TO EXACTLY LOCATE AND PROTECT ANY AND ALL UNDERGROUND UTILITIES. THE CONTRACTOR SHALL NOTIFY THE DESIGN ENGINEER IMMEDIATELY IF A CONFLICT IS APPARENT.