

1316-1334 MICHIGAN AVENUE &  
40 YPSI COURT  
YPSILANTI, MICHIGAN



**SIGNATURE  
ASSOCIATES**  
KNOW SIGNATURE | KNOW RESULTS

RETAIL LAND FOR SALE  
1.32 Acres Available



## PROPERTY FEATURES

- (2) buildings (1,073 square feet & 1,877 square feet) and land totaling 1.32 acres available
- Can be used for redevelopment purposes for many mixed-use opportunities that include Retailers, Car Wash, Restaurants, Financial Institutions, Medical and more
- Surrounded by national and local retailers along high traffic Michigan Avenue corridor
- Property addresses include: 1316, 1326, 1332, 1334 E. Michigan Avenue & 40 Ypsi Court
- Not sold separately
- Contact Brokers for more details
- Sale Price: \$520,000



For more information, please contact:

**MARVIN PETROUS**  
(248) 359 0647  
mpetrous@signatureassociates.com

**JAY CHAVEY**  
(248) 948 4196  
jchavey@signatureassociates.com

**SIGNATURE ASSOCIATES**  
One Towne Square, Suite 1200  
Southfield, MI 48076  
www.signatureassociates.com

# 1316 – 1334 Michigan Avenue – Ypsilanti, Michigan

## Retail Land For Sale

1.32  
Acres  
AVAILABLE

### Site Plan



For more information, please contact:

**MARVIN PETROUS**  
(248) 359 0647  
mpetrous@signatureassociates.com

**JAY CHAVEY**  
(248) 948 4196  
jchavey@signatureassociates.com

**SIGNATURE ASSOCIATES**  
One Towne Square, Suite 1200  
Southfield, MI 48076  
www.signatureassociates.com

# 1316 – 1334 Michigan Avenue – Ypsilanti, Michigan

## Retail Land For Sale

1.32  
Acres  
AVAILABLE

### Floor Plan

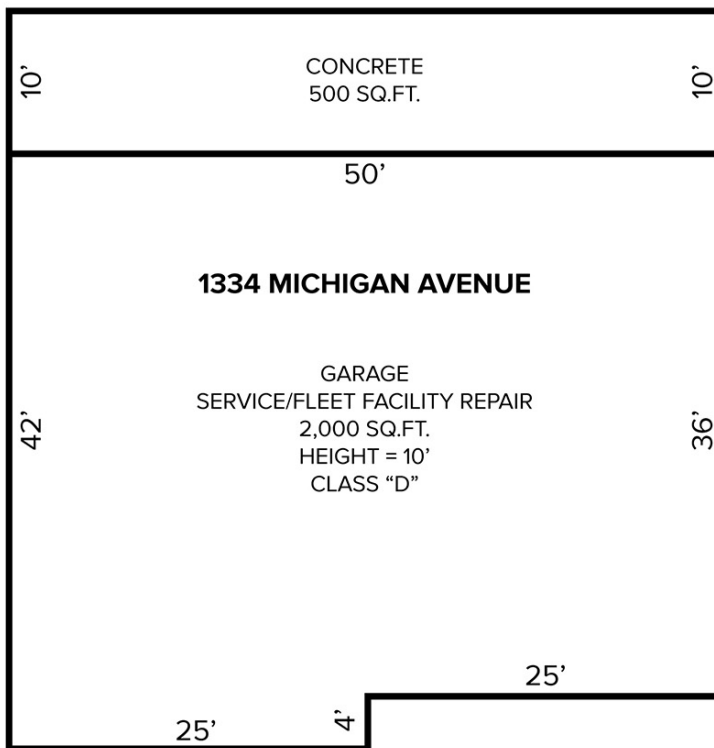
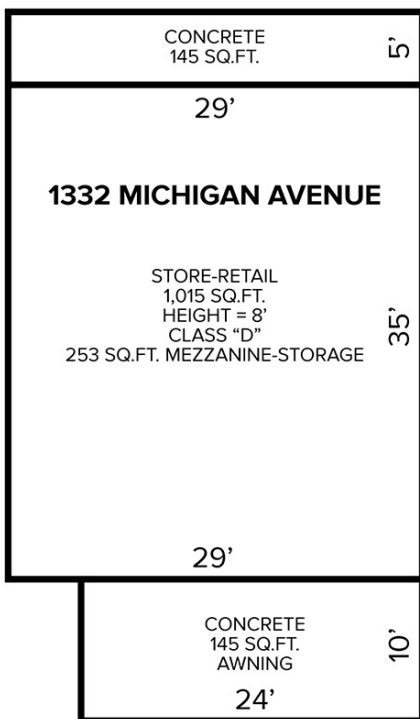

For more information, please contact:

**MARVIN PETROUS**  
(248) 359 0647  
mpetrous@signatureassociates.com

**JAY CHAVEY**  
(248) 948 4196  
jchavey@signatureassociates.com

**SIGNATURE ASSOCIATES**  
One Towne Square, Suite 1200  
Southfield, MI 48076  
www.signatureassociates.com

# 1316 – 1334 Michigan Avenue – Ypsilanti, Michigan

## Retail Land For Sale

1.32  
Acres  
AVAILABLE

DEMOGRAPHICS		
	POPULATION	MED. HH INCOME
1 MILE	9,862	\$46,052
3 MILE	61,282	\$53,634
5 MILE	121,383	\$71,098

TRAFFIC COUNTS (TWO-WAY)	
12,679	N. Ford Blvd. N of E. Michigan Ave.
12,858	N. Ford Blvd. S of E. Michigan Ave.
17,851	E. Michigan Ave. E of Ford Blvd
17,998	E. Michigan Ave. W of Ford Blvd



For more information, please contact:

**MARVIN PETROUS**  
(248) 359 0647  
mpetrous@signatureassociates.com

**JAY CHAVEY**  
(248) 948 4196  
jchavey@signatureassociates.com

**SIGNATURE ASSOCIATES**  
One Towne Square, Suite 1200  
Southfield, MI 48076  
www.signatureassociates.com

Information is subject to verification and no liability for errors or omissions is assumed. Price is subject to change and listing withdrawal.