

# NEW - TO - MARKET

7343 PIERCE AVE, WHITTIER, CA 90602

±10,500 SF INDUSTRIAL BUILDING ON ± 1.21 ACRES OF LAND



## AVAILABLE

### PROPERTY FEATURES

- ± 10,500 SF of RBA
- ± 52,654 SF Lot
- 4 Exterior Dock High
- 3 Grade Level Doors
- Sublease thru October 2027
- Longer Term Possible
- 12' Clear Height
- Private & Secure Yard Space

NICK THORPE (213) 892-8881 x 393 | NTHORPE@RAGINC.COM | ID:02021894

CORPORATE HQ: 545 SOUTH FIGUEROA STREET, SUITE 1209, LOS ANGELES, CA 90071  
CORPORATE ID: 01301202



**REALTY  
ADVISORY  
GROUP INC.**

RAGINC.COM

Neither owner nor broker make any representations or warranties as to the accuracy or completeness of any evaluations materials, including building dimensions, any assumptions and resulting projections or that actual results will conform to any projections contained herein. Owner and broker expressly disclaim any liability for representations or warranties, expressed or implied, contained in this brochure, or in any other written, oral, or other communications transmitted or made available to prospective buyers, including and without limitation to, electronic brochures, computer disks containing files with floor plans, financial data and projections, etc.





## SITE PLAN

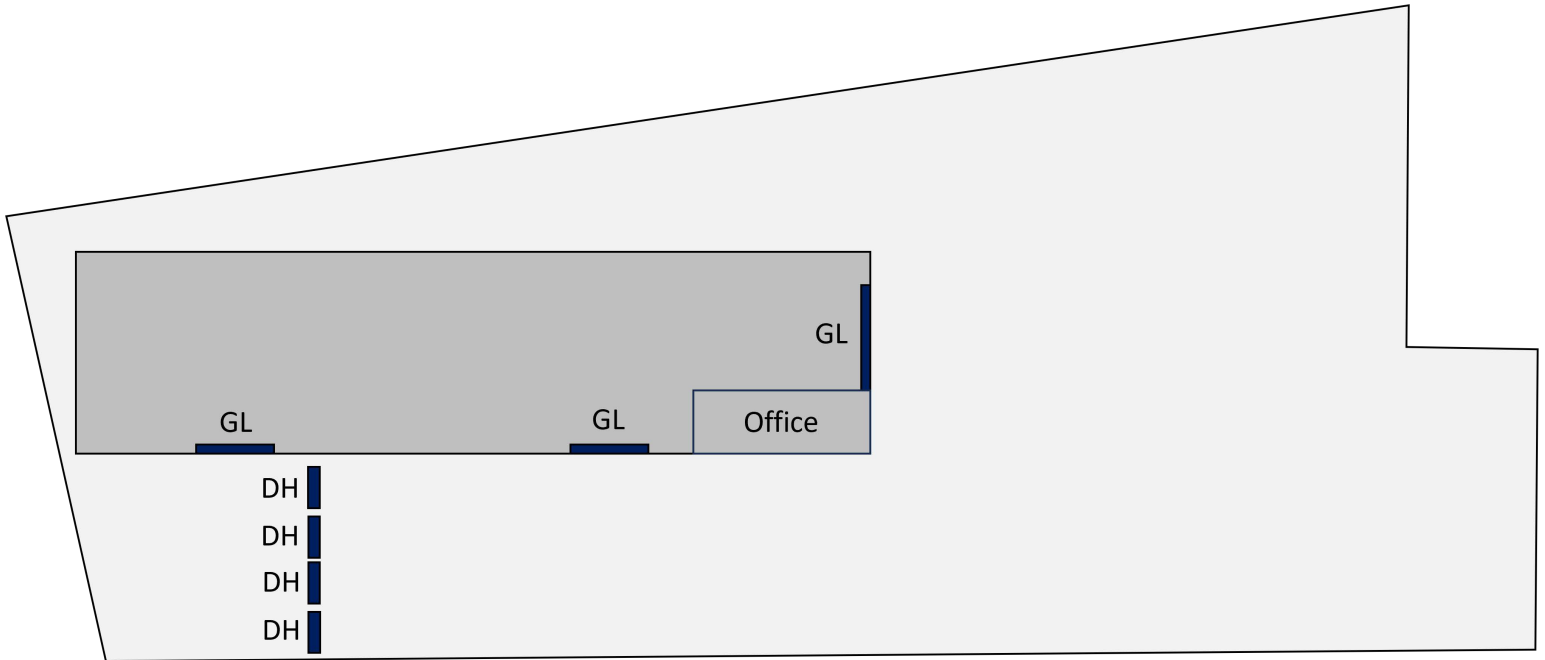

## MAP

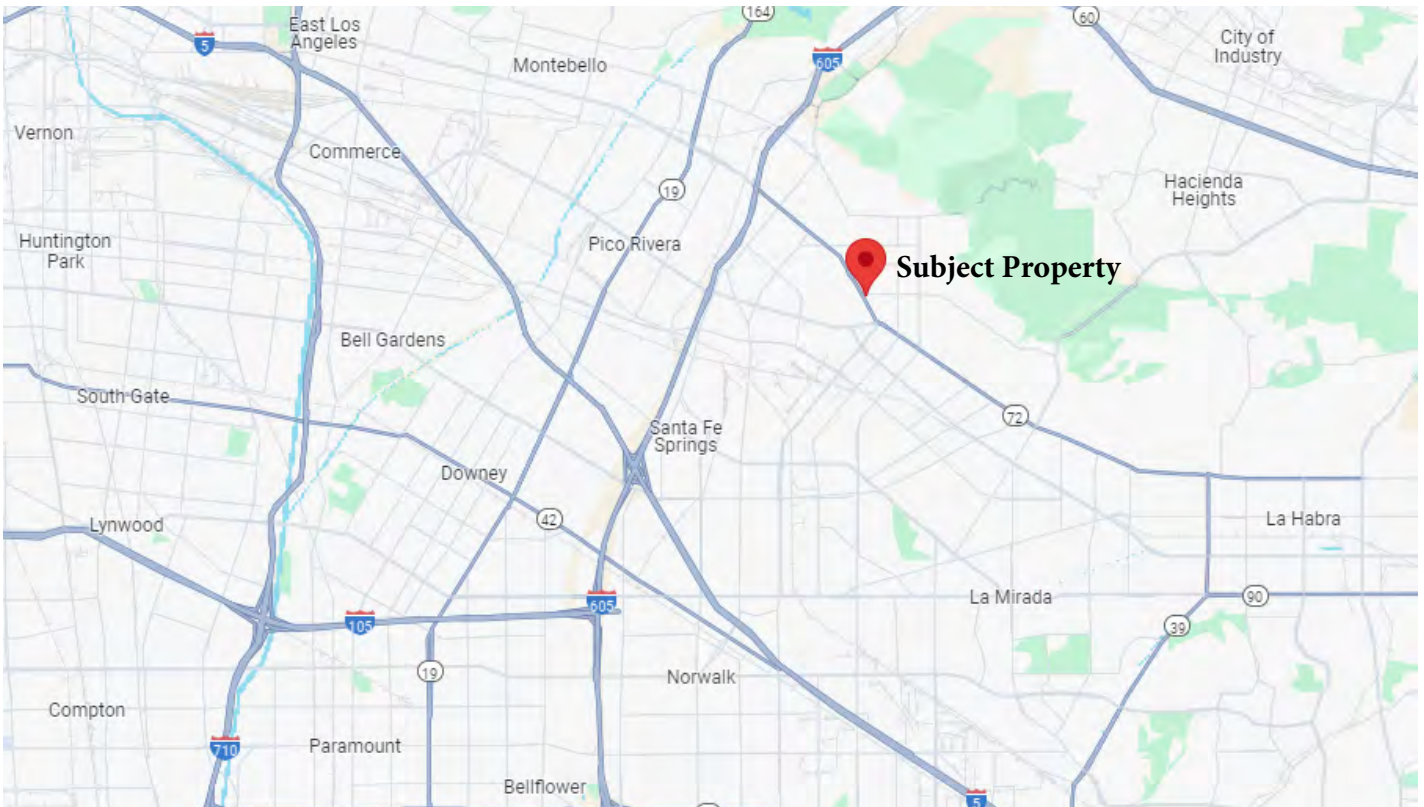

## CONTACT

**NICK THORPE** (213) 892-8881 x 393 | [NTHORPE@RAGINC.COM](mailto:NTHORPE@RAGINC.COM) | ID:02021894



**REALTY  
ADVISORY  
GROUP INC.**

EST. 1995

[RAGINC.COM](http://RAGINC.COM)

CORPORATE HQ: 545 SOUTH FIGUEROA STREET, SUITE 1209, LOS ANGELES, CA 90071  
CORPORATE ID: 01301202

Neither owner nor broker make any representations or warranties as to the accuracy or completeness of any evaluations materials, including building dimensions, any assumptions and resulting projections or that actual results will conform to any projections contained herein. Owner and broker expressly disclaim any liability for representations or warranties, expressed or implied, contained in this brochure, or in any other written, oral, or other communications transmitted or made available to prospective buyers, including and without limitation to, electronic brochures, computer disks containing files with floor plans, financial data and projections, etc.





# AERIAL PHOTOS



## CONTACT

**NICK THORPE** (213) 892-8881 x 393 | [NTHORPE@RAGINC.COM](mailto:NTHORPE@RAGINC.COM) | ID:02021894



**REALTY  
ADVISORY  
GROUP INC.**

EST. 1995

[RAGINC.COM](http://RAGINC.COM)

CORPORATE HQ: 545 SOUTH FIGUEROA STREET, SUITE 1209, LOS ANGELES, CA 90071  
CORPORATE ID: 01301202

Neither owner nor broker make any representations or warranties as to the accuracy or completeness of any evaluations materials, including building dimensions, any assumptions and resulting projections or that actual results will conform to any projections contained herein. Owner and broker expressly disclaim any liability for representations or warranties, expressed or implied, contained in this brochure, or in any other written, oral, or other communications transmitted or made available to prospective buyers, including and without limitation to, electronic brochures, computer disks containing files with floor plans, financial data and projections, etc.





## ADDITIONAL PHOTOS



## CONTACT

**NICK THORPE** (213) 892-8881 x 393 | [NTHORPE@RAGINC.COM](mailto:NTHORPE@RAGINC.COM) | ID:02021894

CORPORATE HQ: 545 SOUTH FIGUEROA STREET, SUITE 1209, LOS ANGELES, CA 90071  
CORPORATE ID: 01301202

Neither owner nor broker make any representations or warranties as to the accuracy or completeness of any evaluations materials, including building dimensions, any assumptions and resulting projections or that actual results will conform to any projections contained herein. Owner and broker expressly disclaim any liability for representations or warranties, expressed or implied, contained in this brochure, or in any other written, oral, or other communications transmitted or made available to prospective buyers, including and without limitation to, electronic brochures, computer disks containing files with floor plans, financial data and projections, etc.



**REALTY  
ADVISORY  
GROUP INC.**

EST. 1995

[RAGINC.COM](http://RAGINC.COM)