

# ZINFANDEL CROSSING

2810 ZINFANDEL DR

RANCHO CORDOVA, CA

FOR LEASE

26,350 SF ANCHOR SPACE AVAILABLE

**ETHAN CONRAD**  
PROPERTIES INC.



## REMODEL COMPLETED

FOR MORE INFORMATION CONTACT:

**Race Merritt**

DRE: #1700569

[race@ethanconradprop.com](mailto:race@ethanconradprop.com)

**916.779.1000**

ETHAN CONRAD PROPERTIES, INC.

1300 NATIONAL DRIVE, SUITE 100 | SACRAMENTO CA, 95834 | FAX: 916.779.1200

[www.ethanconradprop.com](http://www.ethanconradprop.com)



**FEATURES:**

- Former gym space w/ newer improvements
- ±26,350 SF Anchor space available
- Prominent location at the intersection of Zinfandel Dr & Folsom Blvd
- Easy access to Hwy 50 at Zinfandel Dr
- Dense residential and daytime population
- Monument signage available
- Adjacent to Zinfandel light rail station

**PROPERTY DETAILS:**

Zinfandel Crossing is a prominent neighborhood shopping center that benefits from many national neighboring tenants such as: Walmart Supercenter, Target, Michaels, Ross Dress for Less, Boot Barn, PetSmart and More. Also adjacent to several hotels, Rancho Cordova City Hall, Sacramento Children's Museum and many corporate businesses.

Surrounded by 12 million square feet of office and industrial space. Rancho Cordova is Sacramento's largest employment core with a daytime population of over 51,000 workers.

**LEASE RATE:**

Negotiable

NNN costs are approximately \$0.31 PSF.

<b>DEMOGRAPHICS:</b>	1 miles	3 miles	5 miles
2018 Population (est):	18,958	82,706	218,366
2018 Avg. HH Income:	\$70,073	\$81,188	\$92,782

Daily Traffic Count: Zinfandel Dr & Folsom Blvd 43,917

**Race Merritt**

DRE: #01700659

race@ethanconradprop.com

**ETHAN CONRAD PROPERTIES, INC.**

1300 NATIONAL DRIVE, SUITE 100 | SACRAMENTO CA, 95834 | 916.779.1000

www.ethanconradprop.com

The information contained herein has been obtained from sources we believe to be reliable. However, we cannot guarantee, warrant or represent its accuracy and all information is subject to error, change or withdrawal. An interested party and their advisors should conduct an independent investigation of the property to determine to your satisfaction the suitability of the property for your needs.

FOR LEASE

SITE PLAN

ZINFANDEL CROSSING | ANCHOR SPACE

2810 ZINFANDEL DR  
RANCHO CORDOVA, CA

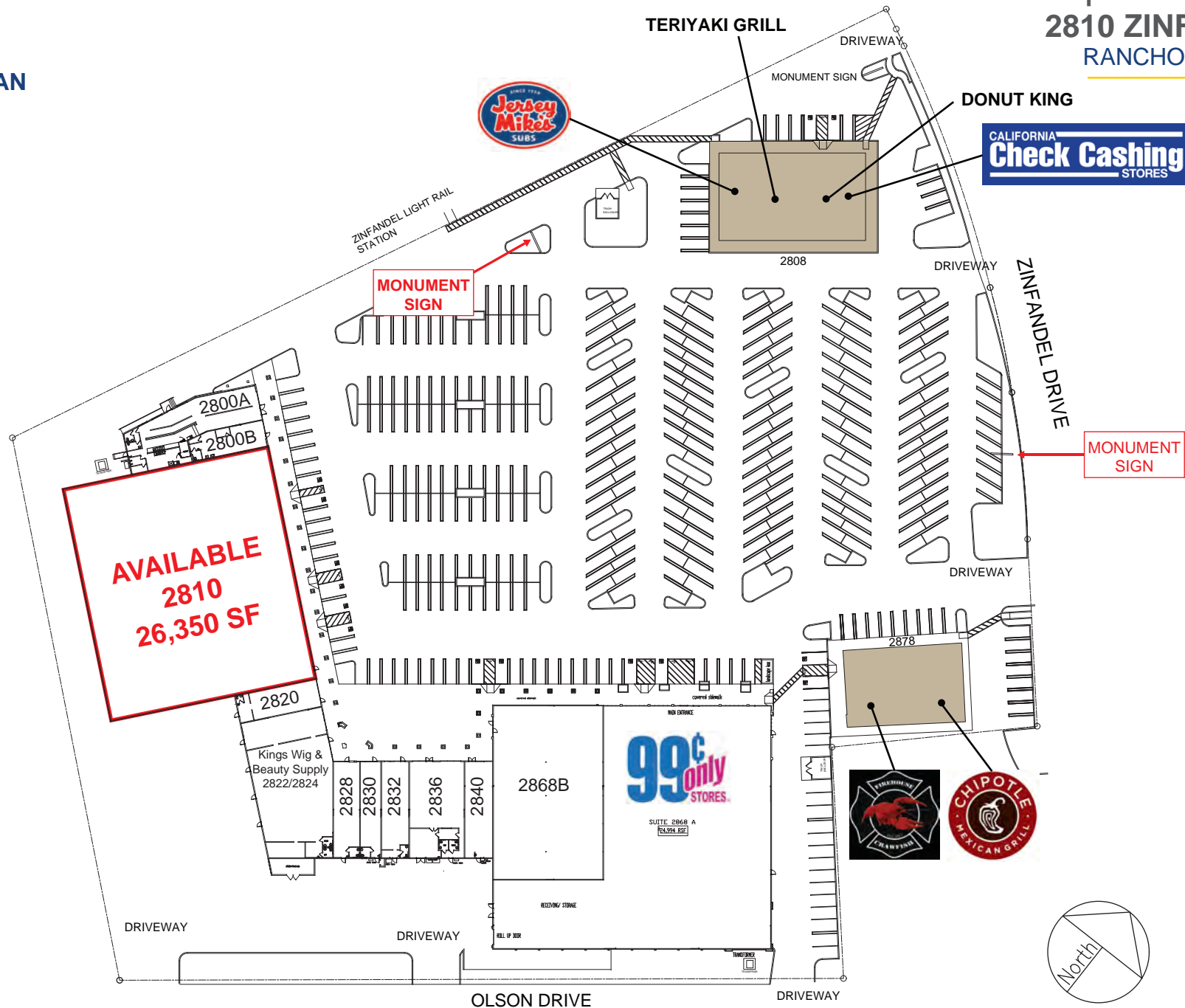

The information contained herein has been obtained from sources we believe to be reliable. However, we cannot guarantee, warrant or represent its accuracy and all information is subject to error, change or withdrawal. An interested party and their advisors should conduct an independent investigation of the property to determine to your satisfaction the suitability of the property for your needs.

FOR LEASE

ZINFANDEL CROSSING | ANCHOR SPACE

2810 ZINFANDEL DR  
RANCHO CORDOVA, CA

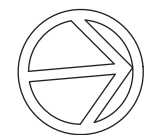
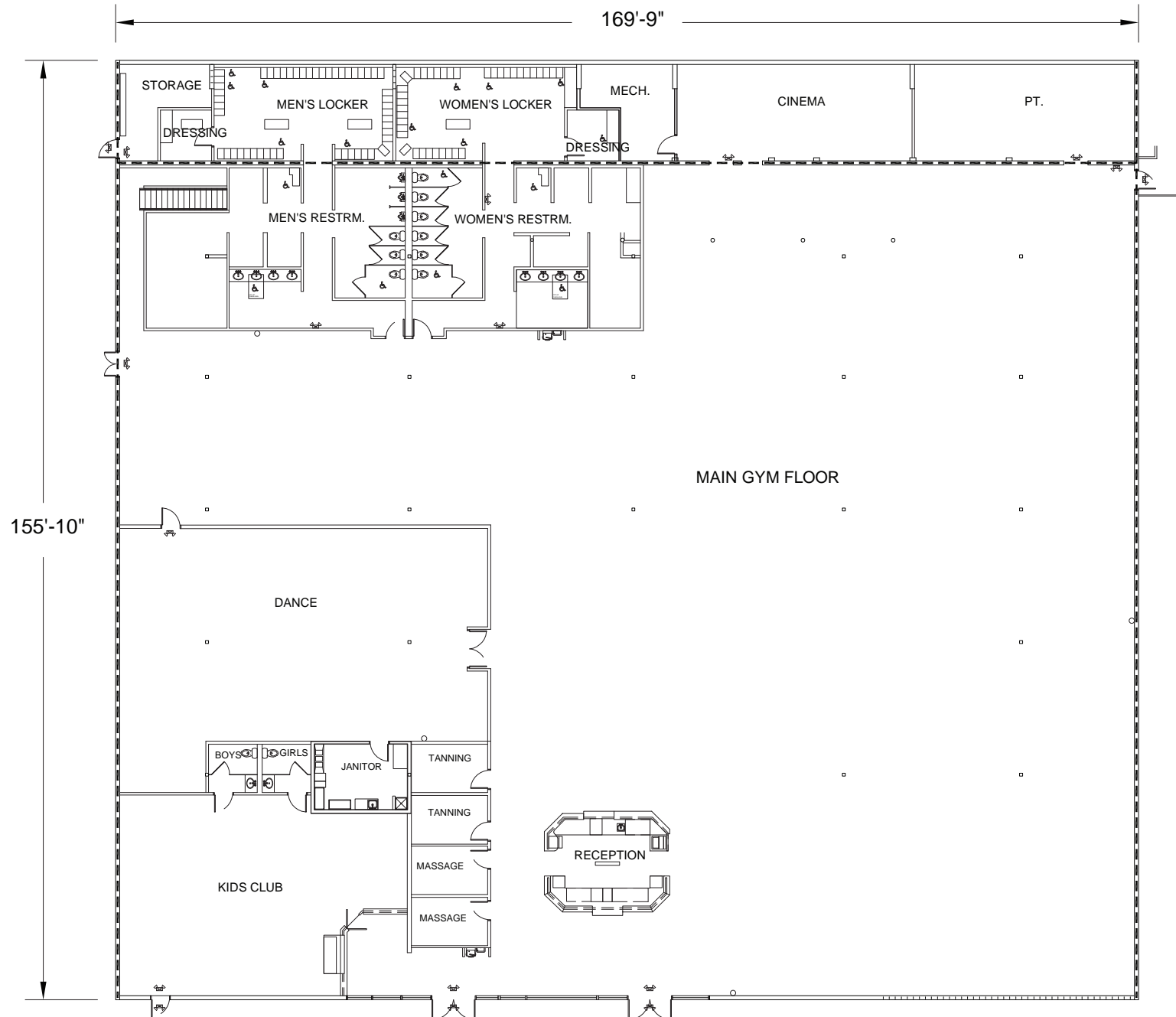

NORTH

The information contained herein has been obtained from sources we believe to be reliable. However, we cannot guarantee, warrant or represent its accuracy and all information is subject to error, change or withdrawal. An interested party and their advisors should conduct an independent investigation of the property to determine to your satisfaction the suitability of the property for your needs.





**Race Merritt**  
 DRE: #01700659  
[race@ethanconradprop.com](mailto:race@ethanconradprop.com)

**ETHAN CONRAD PROPERTIES, INC.**  
 1300 NATIONAL DRIVE, SUITE 100 | SACRAMENTO CA, 95834 | 916.779.1000  
[www.ethanconradprop.com](http://www.ethanconradprop.com)

The information contained herein has been obtained from sources we believe to be reliable. However, we cannot guarantee, warrant or represent its accuracy and all information is subject to error, change or withdrawal. An interested party and their advisors should conduct an independent investigation of the property to determine to your satisfaction the suitability of the property for your needs.