

SITE DATA

TOTAL BLDG AREA

TOTAL BLDG AREA **48,374 S.F.**

PARKING SPACES

TOTAL PARKING REQ'D **194 SPACES**
 TOTAL PARKING PROVIDED **265 SPACES**

NOTE:

THIS SITE PLAN IS SCHEMATIC AND IS PROVIDED TO SHOW APPROXIMATE AGREEMENT AND LOCATIONS OR SIZES OF A BUILDING (OR BUILDINGS) THAT WILL FIT ON THIS SITE. CHANGES MAY BE REQUIRED ONCE A FINAL SURVEY WITH CURRENT BOUNDARIES, EASEMENTS, RIGHT-OF-WAYS AND DIMENSIONS OR AFTER FINAL ZONING REVIEW IS COMPLETED.

THE INFORMATION CONTAINED HEREIN IS BELIEVED TO BE CORRECT AND IS OBTAINED FROM SOURCES WE REGARD AS RELIABLE. WE ASSUME NO LIABILITY FOR ERRORS OR OMISSIONS HEREIN. ALL DIMENSIONS ARE APPROXIMATE.

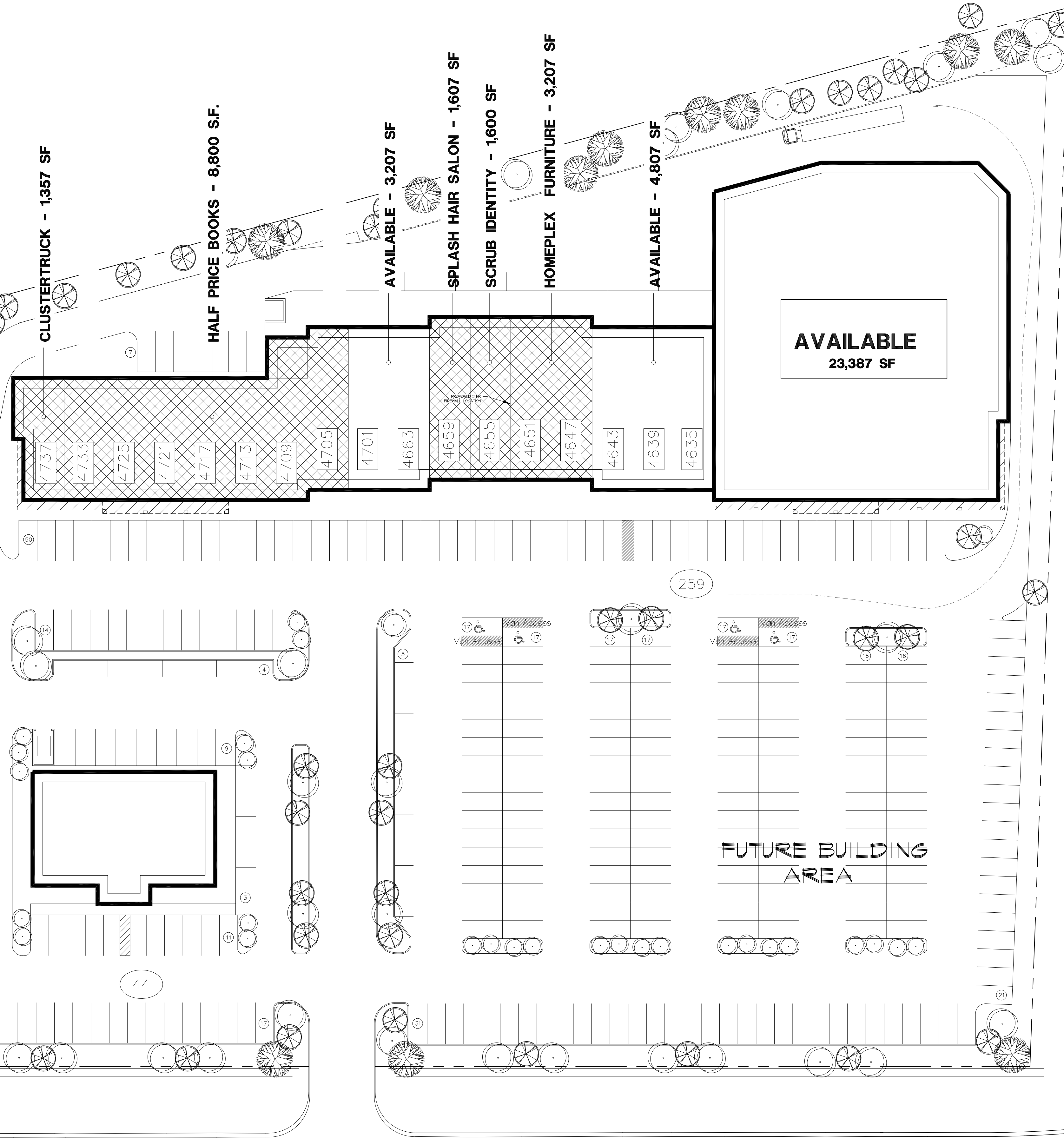

Sycamore Springs Drive

82nd Street

The Broadbent Company

117 E Washington Street, Suite 300
 Indianapolis, Indiana 46204
www.broadbentcompany.com
 (317) 237-2900

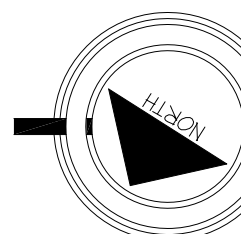

Schematic Site Plan

SCALE: 1" = 30'

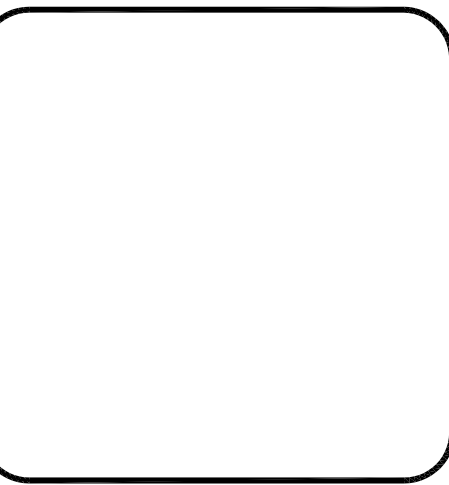

LEECH ARCHITECTS INC
 7785 E 126TH STREET
 FISHERS, INDIANA 46038
 TELEPHONE 317 842 1931

DATE	April 21, 2023
FILE - DATE - TIME	4594-31.dwg 3-14-22 11:30:14 am EST
PLOT SCALE	DRAWN BY:
1/32" = 1'-0"	GAS

Clearwater Village
 4603-4737 EAST 82ND STREET
 INDIANAPOLIS, INDIANA

developed by:
The Broadbent Company

Scheme #
31
 PROJECT NO.
 4594