



4,090 - 16,673 SF AVAILABLE

6438-6452 Warren Drive

NORCROSS, GA 30093



FOR LEASE



### BUILDING INFORMATION

- Total Size:** 28,031 SF
- Clear Height:** 18'
- Loading:** Eight (8) Dock High Door
- Available:** October 1, 2024
- Location:**
  - +/- 1.5 miles to I - 85
  - +/- 5 miles to I - 285
  - +/- 15 miles to I - 75
  - +/- 25 miles to Atlanta Airport

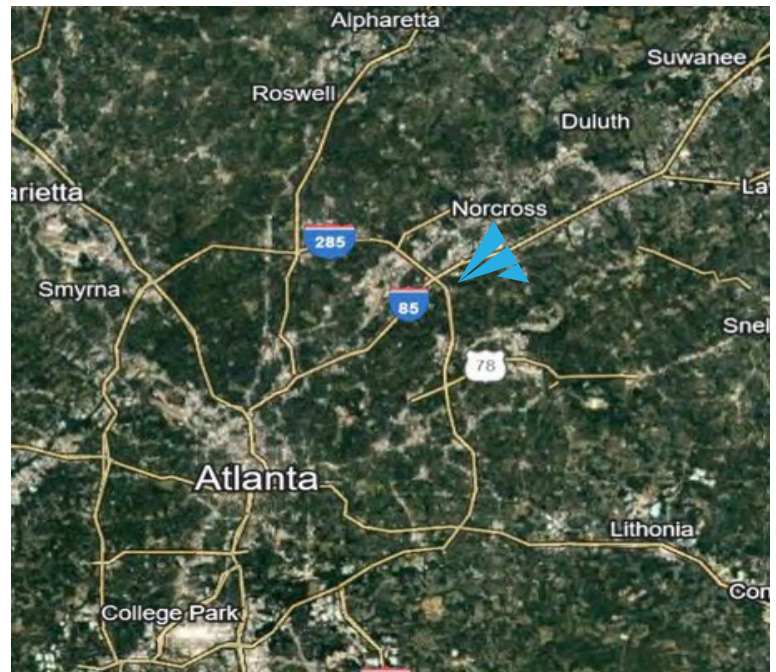

**APEX INDUSTRIAL**  
REAL ESTATE ADVISORS

3500 Lenox Road, Suite 1275 | Atlanta, GA 30326 | [apexindustrialre.com](http://apexindustrialre.com)

For more information, please contact:

**TREY WEGHORST**

Office: (770) 264-9420  
Cell: (404) 276-9314  
[tweghorst@apexindustrialre.com](mailto:tweghorst@apexindustrialre.com)

**RYAN BLACKBURN**

Office: (404) 974-2716  
Cell: (404) 821-7715  
[rblackburn@apexindustrialre.com](mailto:rblackburn@apexindustrialre.com)

**MORGAN MCMENAMY**

Office: (404) 595-1524  
Cell: (404) 771-1199  
[mmcmenary@apexindustrialre.com](mailto:mmcmenary@apexindustrialre.com)

Although the information contained therein was provided from sources believed to be reliable, Apex Industrial makes no representation, expressed or implied, as to its accuracy and said information is subject to errors, omissions or changes.



**4,524 SF AVAILABLE**

6440 Warren Drive

NORCROSS, GA 30093



## PROPERTY INFORMATION

**Total Size:** 4,524 SF  
**Office:** 1,076 SF  
**Warehouse:** 3,448 SF  
**Clear Height:** 18'  
**Loading:** One (1) Dock High Door  
**Available:** Immediately

## KEYPLAN

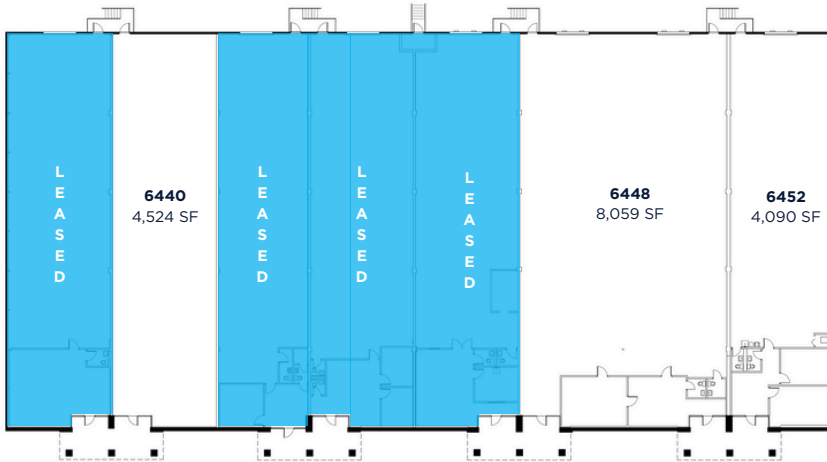

## FLOORPLAN



**APEX INDUSTRIAL**  
REAL ESTATE ADVISORS

3500 Lenox Road, Suite 1275 | Atlanta, GA 30326 | [apexindustrialre.com](http://apexindustrialre.com)

For more information, please contact:

### TREY WEGHORST

Office: (770) 264-9420  
Cell: (404) 276-9314  
[tweghorst@apexindustrialre.com](mailto:tweghorst@apexindustrialre.com)

### RYAN BLACKBURN

Office: (404) 974-2716  
Cell: (404) 821-7715  
[rblackburn@apexindustrialre.com](mailto:rblackburn@apexindustrialre.com)

### MORGAN MCMENAMY

Office: (404) 595-1524  
Cell: (404) 771-1199  
[mmcmenamya@apexindustrialre.com](mailto:mmcmenamya@apexindustrialre.com)

Although the information contained therein was provided from sources believed to be reliable, Apex Industrial makes no representation, expressed or implied, as to its accuracy and said information is subject to errors, omissions or changes.



**8,059 SF AVAILABLE**  
 6448 Warren Drive  
 NORCROSS, GA 30093



## PROPERTY INFORMATION

**Total Size:** 8,059 - 12,149 SF  
**Office:** 1,015 SF  
**Warehouse:** 7,044 SF  
**Clear Height:** 18'  
**Loading:** Two (2) Dock High Doors  
**Available:** Immediately

## KEYPLAN

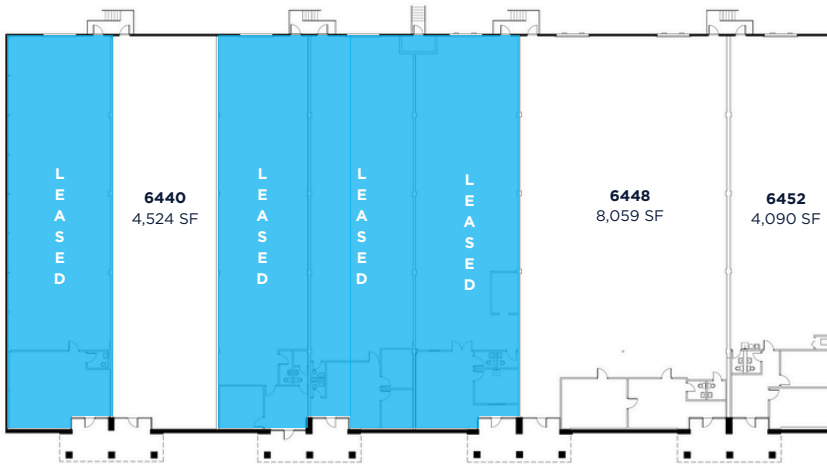

## FLOORPLAN

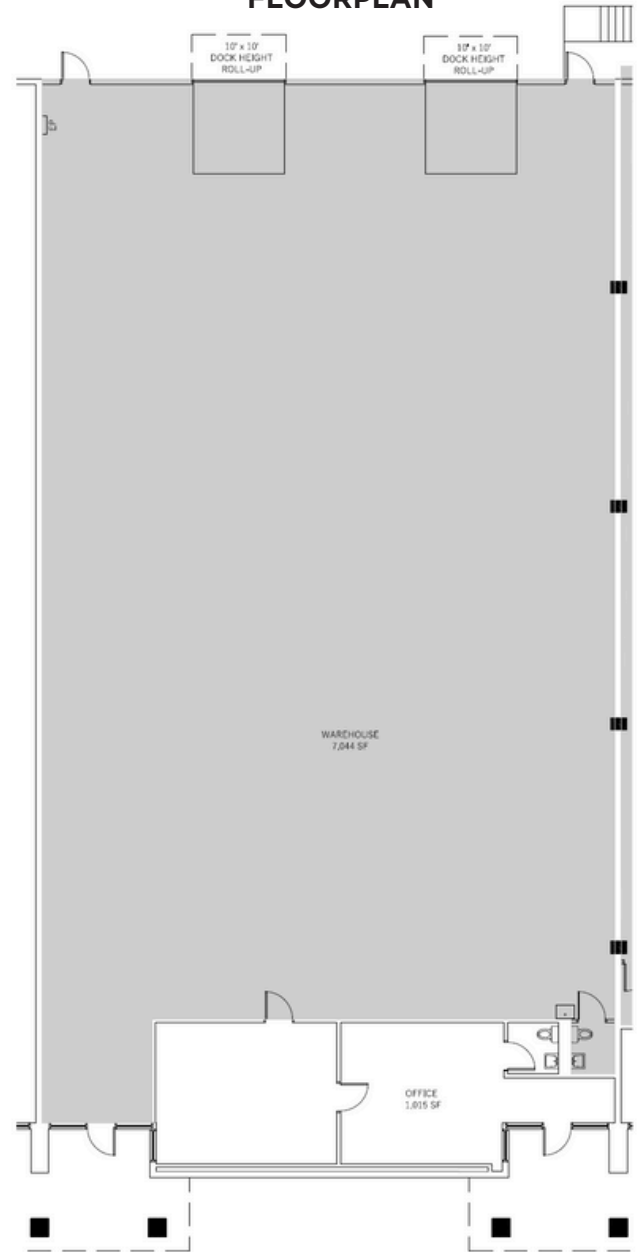

**APEX INDUSTRIAL**  
 REAL ESTATE ADVISORS

3500 Lenox Road, Suite 1275 | Atlanta, GA 30326 | [apexindustrialre.com](http://apexindustrialre.com)

For more information, please contact:

### TREY WEGHORST

Office: (770) 264-9420  
 Cell: (404) 276-9314  
[tweghorst@apexindustrialre.com](mailto:tweghorst@apexindustrialre.com)

### RYAN BLACKBURN

Office: (404) 974-2716  
 Cell: (404) 821-7715  
[rblackburn@apexindustrialre.com](mailto:rblackburn@apexindustrialre.com)

### MORGAN MCMENAMY

Office: (404) 595-1524  
 Cell: (404) 771-1199  
[mmcmenamya@apexindustrialre.com](mailto:mmcmenamya@apexindustrialre.com)

Although the information contained therein was provided from sources believed to be reliable, Apex Industrial makes no representation, expressed or implied, as to its accuracy and said information is subject to errors, omissions or changes.



**4,090 SF AVAILABLE**

**6452 Warren Drive**

NORCROSS, GA 30093



## PROPERTY INFORMATION

**Total Size:** 4,090 - 12,149 SF  
**Office:** 872 SF  
**Warehouse:** 3,218 SF  
**Clear Height:** 18'  
**Loading:** One (1) Dock High Door  
**Available:** October 1, 2024

## KEYPLAN

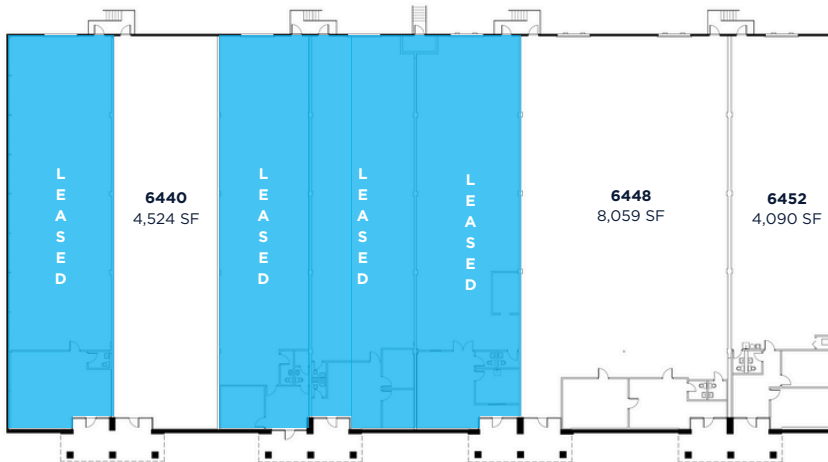

## FLOORPLAN

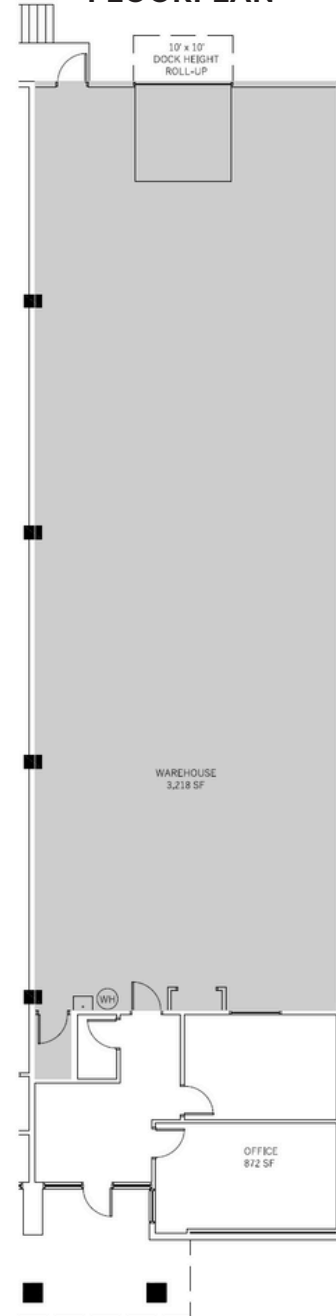

**APEX INDUSTRIAL**  
 REAL ESTATE ADVISORS

3500 Lenox Road, Suite 1275 | Atlanta, GA 30326 | [apexindustrialre.com](http://apexindustrialre.com)

For more information, please contact:

### TREY WEGHORST

Office: (770) 264-9420  
 Cell: (404) 276-9314  
[tweghorst@apexindustrialre.com](mailto:tweghorst@apexindustrialre.com)

### RYAN BLACKBURN

Office: (404) 974-2716  
 Cell: (404) 821-7715  
[rblackburn@apexindustrialre.com](mailto:rblackburn@apexindustrialre.com)

### MORGAN MCMENAMY

Office: (404) 595-1524  
 Cell: (404) 771-1199  
[mmcmenamya@apexindustrialre.com](mailto:mmcmenamya@apexindustrialre.com)

Although the information contained therein was provided from sources believed to be reliable, Apex Industrial makes no representation, expressed or implied, as to its accuracy and said information is subject to errors, omissions or changes.

