

NEW PAD BUILD OPPORTUNITY

3155 – 3175 MARKHAM RD. & 215 SELECT AVE.,
SCARBOROUGH, ONTARIO



Len Goudy

Broker of Record
Goudy Real Estate Corp.
Real Estate Brokerage
(416) 830-0880
lgoudy@goudyrealestatecorp.com

Carrie Walkden

Sales Representative
Goudy Real Estate Corp.
Real Estate Brokerage
(647) 825-1392
carrie@goudyrealstatecorp.com

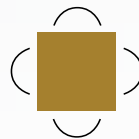

Goudy Real Estate Corp.

Real Estate Brokerage

Commercial Real Estate
Sales & Leasing

505 Hood Rd., Unit 20, Markham, ON L3R 5V6 | **(905) 477-3000**

The information contained herein has been provided to Goudy Real Estate Corp. by others. We do not warrant its accuracy. You are advised to independently verify the information prior to submitting an Offer and to provide for sufficient due diligence in an offer. The information contained herein may change from time to time without notice. The property may be withdrawn from the market at any time without notice.

3155 – 3175 MARKHAM RD. & 215 SELECT AVE. SITE PLAN & DETAILS

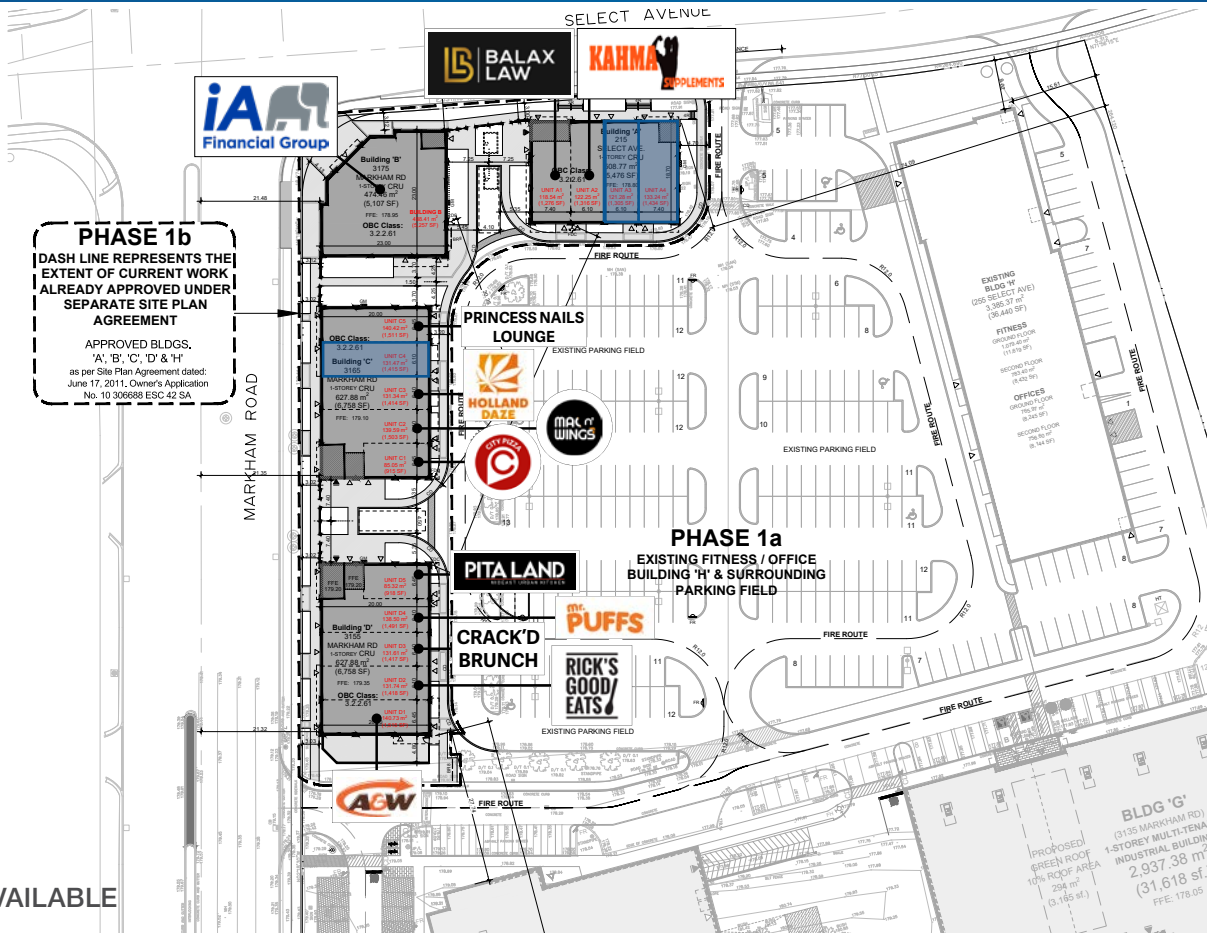

NEW BUILD OPPORTUNITIES:

Building A: 1,305 - 2,739 Sq Ft (Retail, Personal Service)

Building B: 5,107 Sq Ft (Financial Institution) - **Fully Leased**

Building C: 1,415 Sq Ft (Retail, Personal Service Shops)

Building D: 6,758 Sq Ft, Patio space available (Retail, Restaurant) - **Fully Leased**

*Loading space has been provided, see site plan

DETAILS:

- Amenities include GoodLife Fitness on site, plenty of restaurants, shopping in the immediate area, plenty of parking.
- Pylon Signage
- Bus stops in front of property at Select Avenue and Markham Road.
- Estimated population within 0-3km is 93,824, and within 0-5km is 240,364.
- **Traffic counts on Markham Rd:** 50,837 cars per day (source: sitewise)



**VIDEO
WALK-THRU**

3155 – 3175 MARKHAM RD. & 215 SELECT AVE. AERIALS



SITUATED IN A HEAVY RESIDENTIAL AREA



215 SELECT AVENUE

BUILDING A FLOOR PLAN

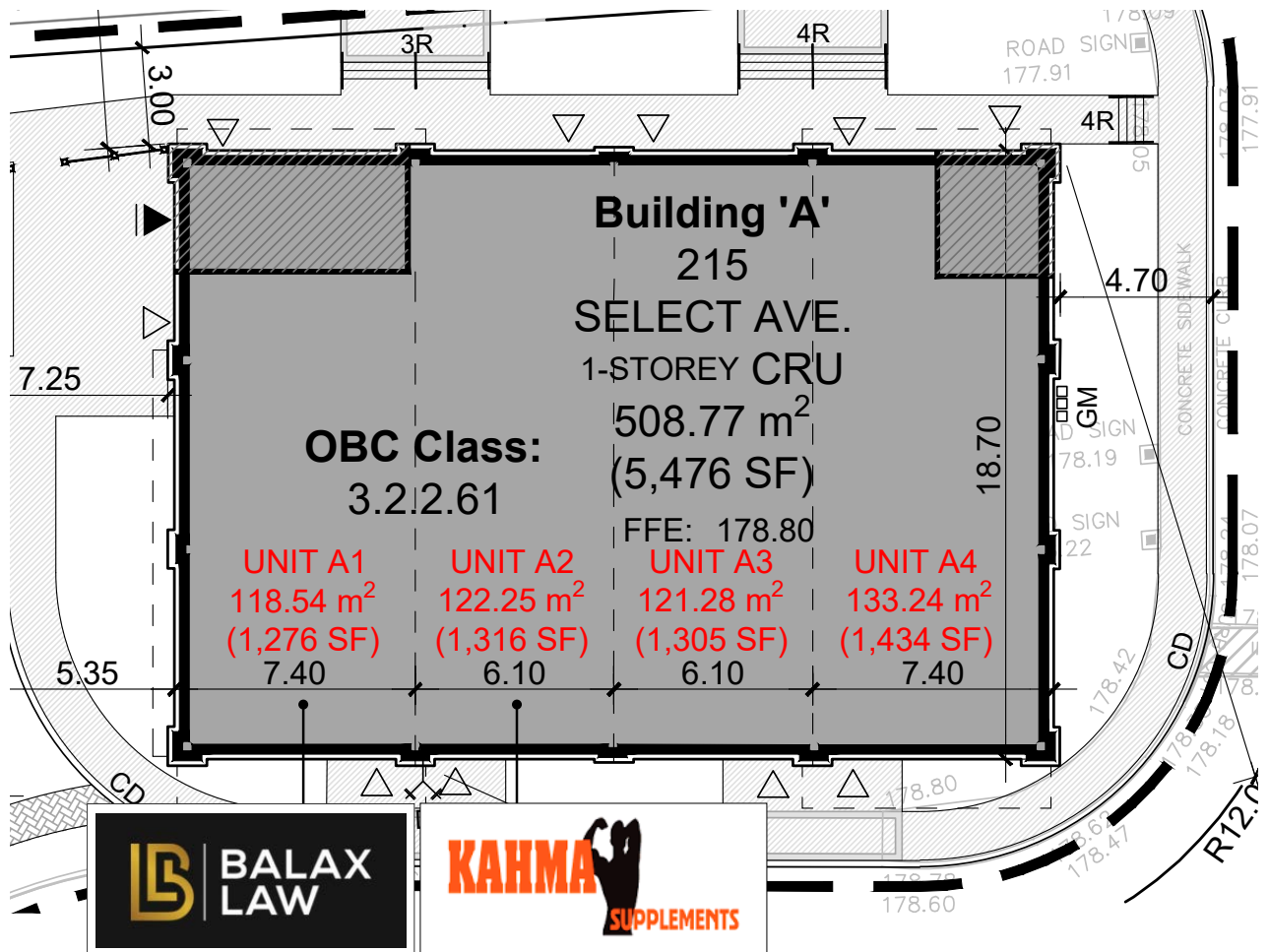

3175 MARKHAM ROAD BUILDING B FLOOR PLAN

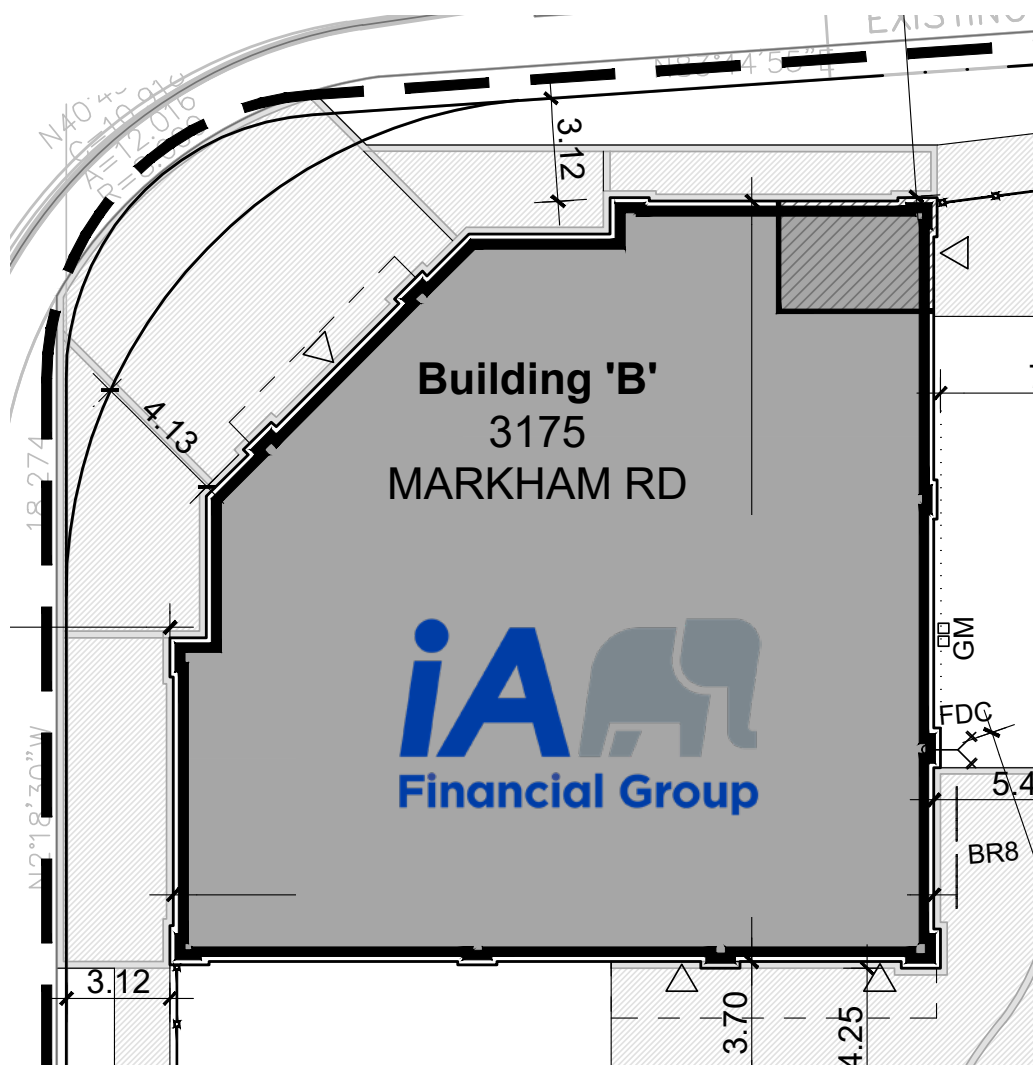

3165 MARKHAM ROAD BUILDING C FLOOR PLAN

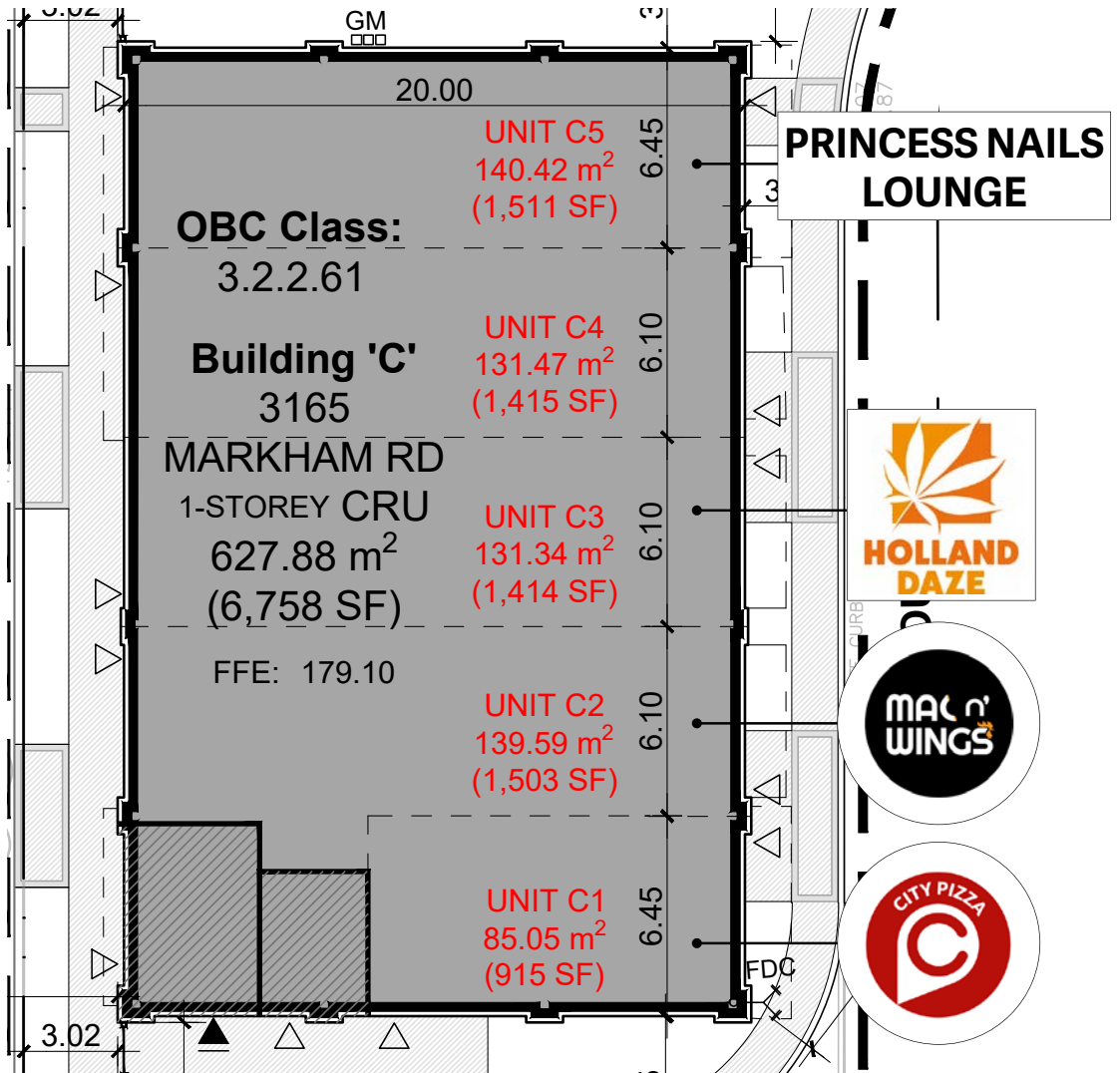

3155 MARKHAM ROAD BUILDING D FLOOR PLAN

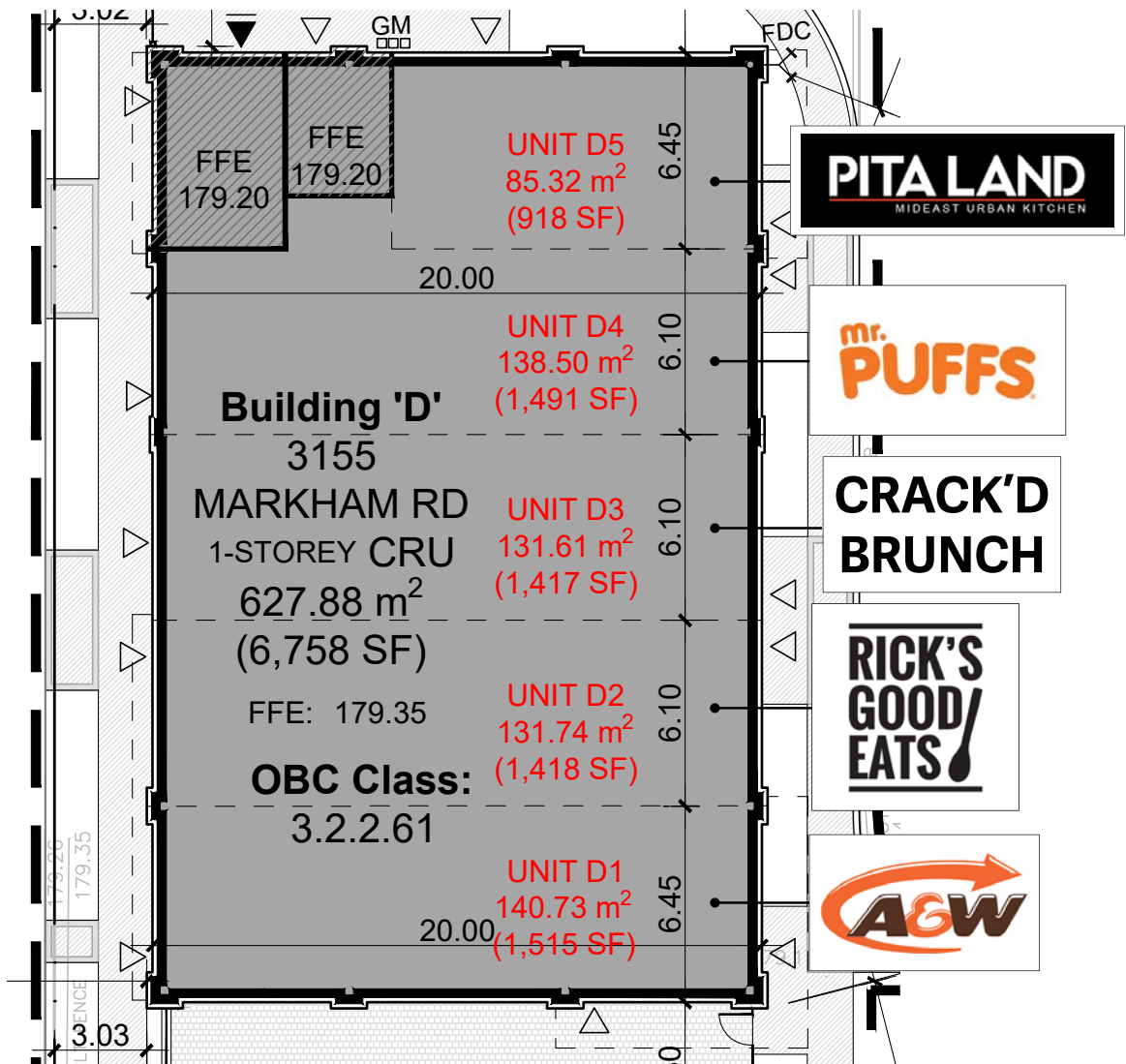

3155 – 3175 MARKHAM RD. & 215 SELECT AVE. TRADE AREA MAP

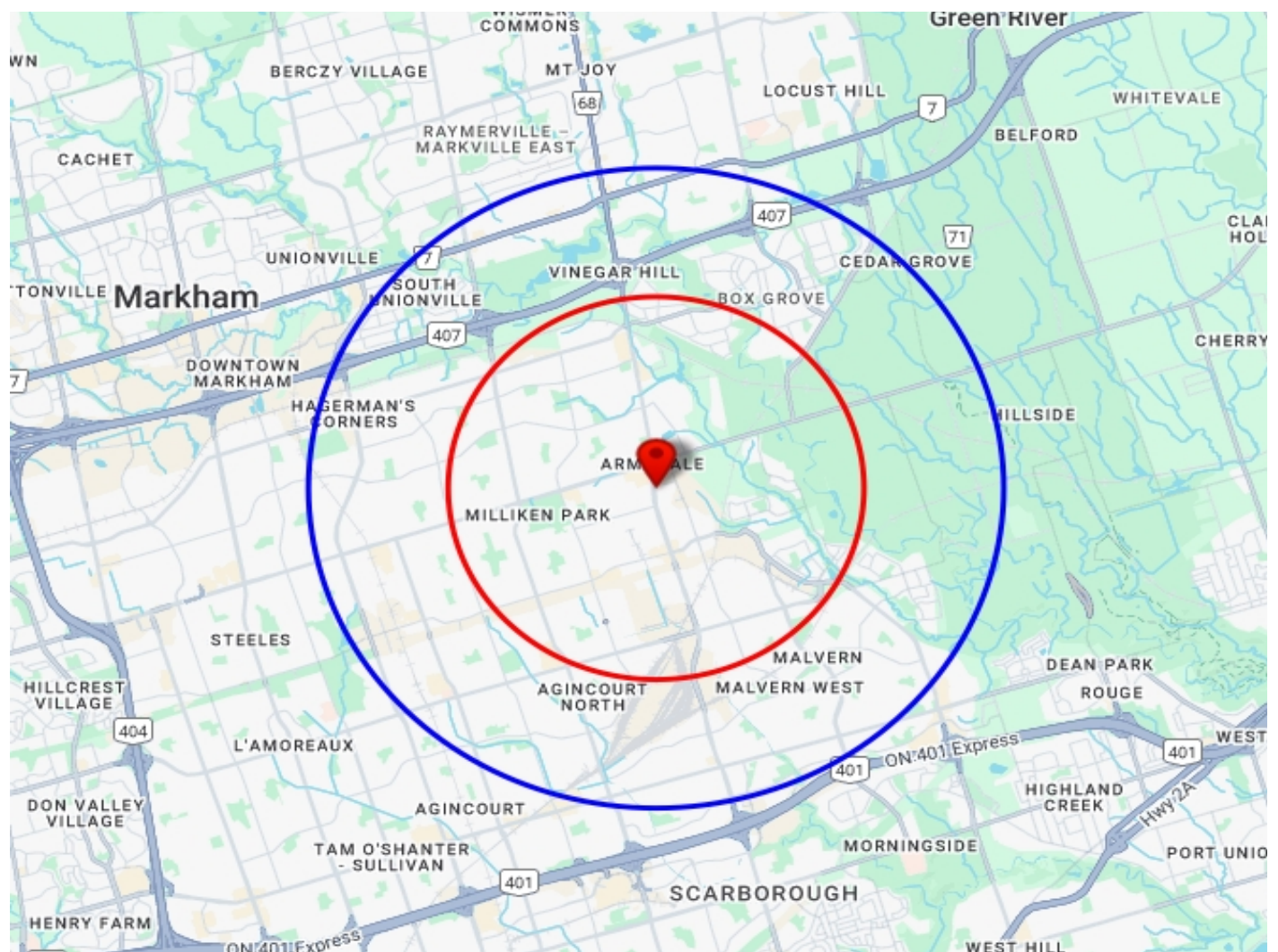

2024 Daytime Population	3175 Markham Rd, Toronto, ON M1X 1C8 0 - 3 km		3175 Markham Rd, Toronto, ON M1X 1C8 0 - 5 km	
		%		%
Total Estimated Population	93,824		240,364	
Total Daytime Population	95,920		224,197	
Daytime Population at Home	52,921	55.2%	135,283	60.3%
0 to 14 years	12,752	13.3%	32,017	14.3%
15 to 64 years	24,423	25.5%	61,391	27.4%
65 years and over	15,746	16.4%	41,874	18.7%
Daytime Population at Work	43,230	45.1%	93,210	41.6%
Work At Usual Place	28,912	30.1%	59,420	26.5%
Work Mobile	5,856	6.1%	12,486	5.6%
Work At Home	8,462	8.8%	21,304	9.5%

3155 – 3175 MARKHAM RD. & 215 SELECT AVE.

DEMOGRAPHICS

2024 Demographic Snapshot	3175 Markham Rd, Toronto, ON M1X 1C8 0 - 3 km		3175 Markham Rd, Toronto, ON M1X 1C8 0 - 5 km	
		%		%
Total Population				
2019 estimated	91,191		230,850	
2024 estimated	93,824		240,364	
2029 Projected	98,912		253,663	
% Pop. Change (2019-2024)	2.9%		4.1%	
% Pop. Change (2024-2029)	5.4%		5.5%	
2024 Total Population by Age	93,824		240,364	
0 to 4 years	3,785	4.0%	9,480	3.9%
5 to 19 years	14,577	15.5%	36,717	15.3%
20 to 24 years	8,000	8.5%	20,582	8.6%
25 to 34 years	14,777	15.7%	36,501	15.2%
35 to 44 years	11,661	12.4%	29,847	12.4%
45 to 54 years	10,167	10.8%	26,872	11.2%
55 to 64 years	12,987	13.8%	32,820	13.7%
65 to 74 years	10,631	11.3%	27,020	11.2%
75 years & over	7,239	8%	20,525	9%
Median Age	39.5		40.3	
2024 Total Census Families	21,395		56,267	
Average Persons Per Family	3.7		3.6	
Total Couples	19,406	90.7%	48,841	86.8%
Without children at home	5,616	26.2%	15,463	27.5%
With children at home	13,790	64.5%	33,377	59.3%
Lone-parent families	1,990	9.3%	7,427	13.2%
Children Per Census Family	1.5		1.4	
2024 Educational Attainment (15 years+)	80,678		206,727	
Less than a bachelor degree	56,766	70.4%	143,015	69.2%
Bachelor degree & higher	23,912	29.6%	63,712	30.8%
2024 Households	25,697		70,312	
Persons per household	3.64		3.39	
Average household income	\$ 122,993		\$ 120,581	
2024 Occupied Dwellings	25,697		70,312	
Owned dwellings	21,011	81.8%	55,639	79.1%
Rented dwellings	4,686	18.2%	14,673	20.9%
Dominant building type	Houses		Houses	
Dominant period of construction	1981-1990		1981-1990	