

**FOR SUBLEASE - 21,001 SF**  
**1418 DUNN DRIVE**  
**CARROLLTON, TX 75006**



## LOCATION

COUNTY	Dallas
MARKET	Northwest Dallas
SUBMARKET	N Stemmons/Valwood

## BUILDING HIGHLIGHTS

TOTAL BUILDING SF	29,500 SF
CLEAR HEIGHT	21'

## LISTING HIGHLIGHTS

AVAILABLE SF	21,001 SF
OFFICE SF	±2,500 SF
LOADING	5 Dock Doors & 1 Ramped Dock Door

COMMENTS	Available June 1, 2025 Term through January 31, 2026 Front Load Pin-Weld Insulation Throughout Small Outside Storage Area
----------	---

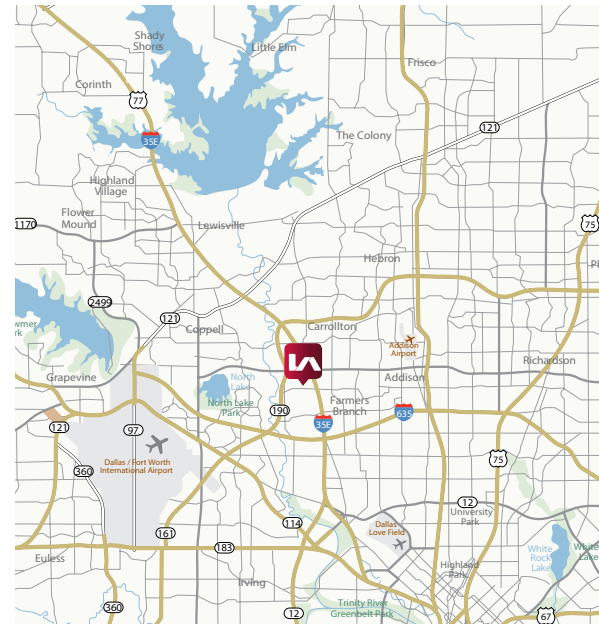

Corbin Blount, SIOR  
Principal

[cblount@lee-associates.com](mailto:cblount@lee-associates.com)  
D: (972) 934-4035  
C: (214) 577-1984

FOR SUBLEASE - 21,001 SF  
1418 DUNN DRIVE  
CARROLLTON, TX 75006

## FLOOR PLAN

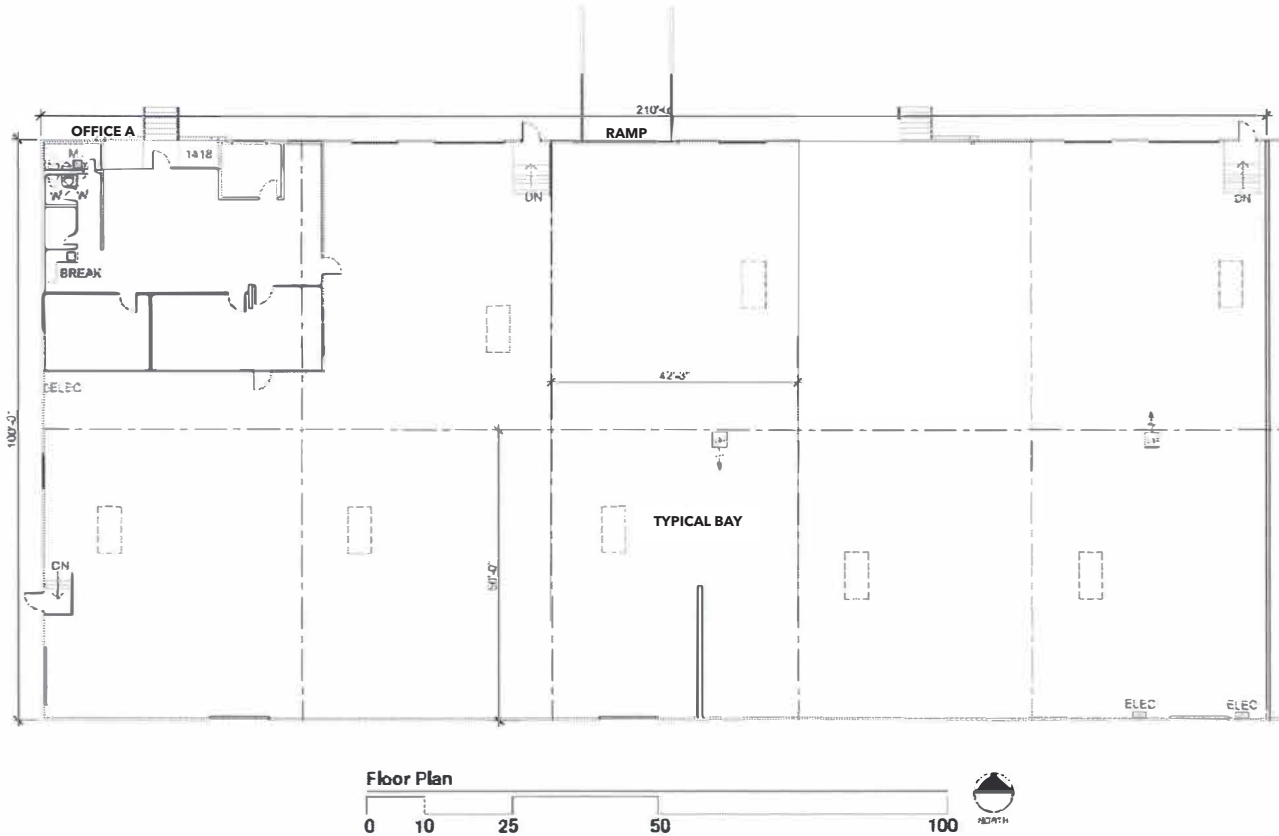

All information furnished regarding property for sale, rental or financing is from sources deemed reliable, but no warranty or representation is made to the accuracy thereof and same is submitted to errors, omissions, change of price, rental or other conditions prior to sale, lease or financing or withdrawal without notice. No liability of any kind is to be imposed on the broker herein.