

DEVELOPER'S DREAM

ASKING \$5,688,500.00



Aztec Real Estate and
Developers

367 Acres with 5 proposed
Commercial lots totaling
63.53 acres & 314 proposed
Residential lots





Contact me for more info



JOHN OCHIPINTI

Broker

License #00560647

 j@aztecred.com
 530-301-4422
 530-674-2370



*Disclaimer: This information is deemed reliable, but cannot be guaranteed. All parties interested are encouraged to any and all inspections to satisfy themselves as to condition of property.

DEVELOPER'S DREAM

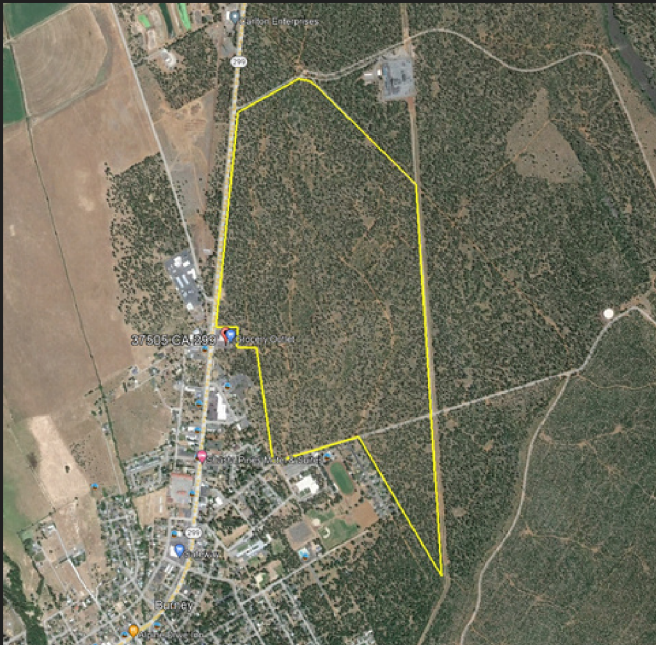

Aztec Real Estate and Developers

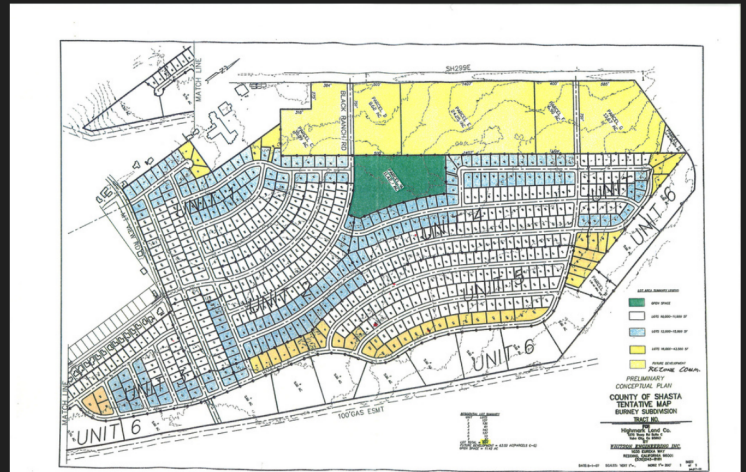

367 Acres with 5 proposed Commercial lots totaling 63.53 acres & 314 proposed Residential lots as shown below



Contact me for more info



JOHN OCHIPINTI
Broker
License #00560647

 j@aztecred.com
 530-301-4422
 530-674-2370



DEVELOPER'S DREAM

This property is located in Shasta County, in the city of Burney, California. The property fronts on the south side of Highway 299 and Mountain View Road, with over 2,275 sq. ft. of frontage on Highway 299. Burney is a full service town that serves the communities of Johnson Park, Cassel, Hat Creek, Old Station, Montgomery Creek, Round Mountain, and Big Bend.

Burney offers a host of activities such as; fishing, hunting, water skiing, swimming, kayaking, rafting, camping, hiking, site seeing, hang gliding, golfing, picnicking, winter sports, and Indian gaming. Living in Burney is all about simple pleasures, the skies are blue, the air is clean and our clean waterways are spring-fed. Burney offers McArthur-Burney Falls Memorial State Park and Lassen Volcanic National Park as points of interest.



Contact me for more info



JOHN OCHIPINTI

Broker

License #00560647

 j@aztecred.com
 530-301-4422
 530-674-2370