

Valley View Farms Business Center

6,400 SF AVAILABLE
\$1.50 PSF NNN | LOW NET FEES

13957 VALLEY VIEW AVENUE
LA MIRADA, CA 90638



BUILDING FEATURES

- ±6,400 Square Feet
- ±840 SF Office Area
- High Image Business Park
- Frontage along Valley View Avenue
- Excellent Retail/Manufacturing Space
- 18' Minimum Clearance
- One (1) Grade Level Loading
- Fire Sprinklers
- 200 Amps, 277/480 Volt Power
- Immediate Access to 5 and 91 Freeways
- Vacant & Available

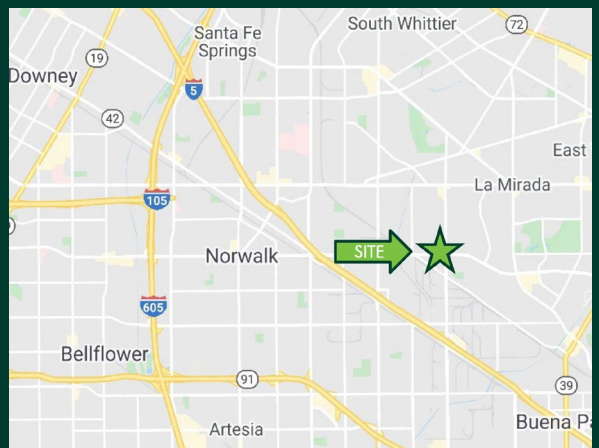

Valley View Farms Business Center

For Lease

6,400 SF AVAILABLE
\$1.50 PSF NNN | LOW NET FEES

13957 VALLEY VIEW AVENUE
LA MIRADA, CA 90638

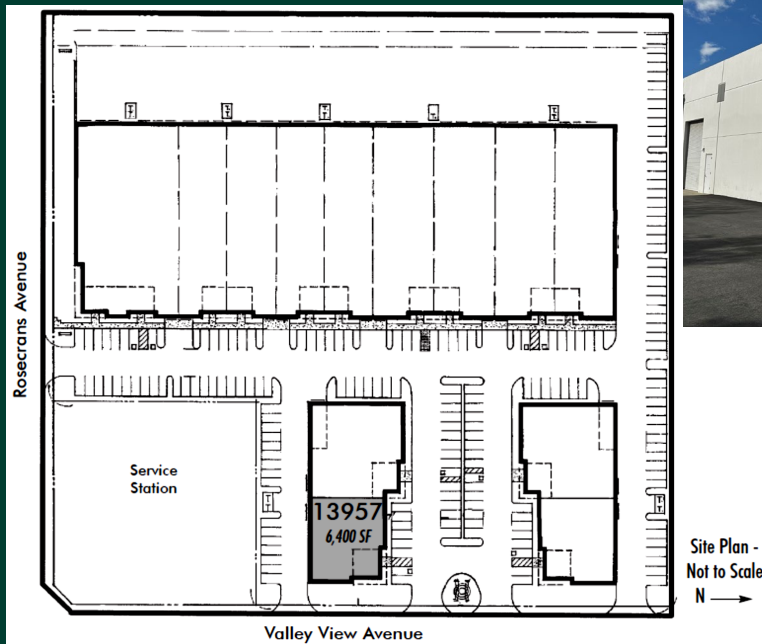

CONTACT US

Laird A. Perkins
Senior Vice President

Lic. 00966207
+1 310 363 4920

laird.perkins@cbre.com

Blake Wade
Associate

Lic. 02118407
+1 949 878 2933

blake.wade@cbre.com

Joshua Kracke
Associate

Lic. 02123022
+1 949 887 2190

joshua.kracke@cbre.com

© 2024 CBRE, Inc. All rights reserved. This information has been obtained from sources believed reliable, but has not been verified for accuracy or completeness. You should conduct a careful, independent investigation of the property and verify all information. Any reliance on this information is solely at your own risk. CBRE and the CBRE logo are service marks of CBRE, Inc. All other marks displayed on this document are the property of their respective owners, and the use of such logos does not imply any affiliation with or endorsement of CBRE. Photos herein are the property of their respective owners. Use of these images without the express written consent of the owner is prohibited.

CBRE