

**MIXED-USE  
RETAIL SPACE  
FOR LEASE**

**GUNBARREL  
CENTER** 

**GUNBARREL CENTER DRIVE | BOULDER, CO 80301**

**1,000 - 3,727 SF  
Retail Space Available**

**CBRE**



**5 buildings**  
with street-level  
retail



**251**  
apartments



**112**  
bike rack spots



**187**  
parking stalls  
*(combined garage and street)*



CREATING  
**A WALKABLE  
COMMUNITY**  
LIKE YOU'VE NEVER  
SEEN BEFORE

# CREATED TO STAND OUT

CLICK BUILDING BELOW TO VIEW  
BUILDING LOCATION ON MAP

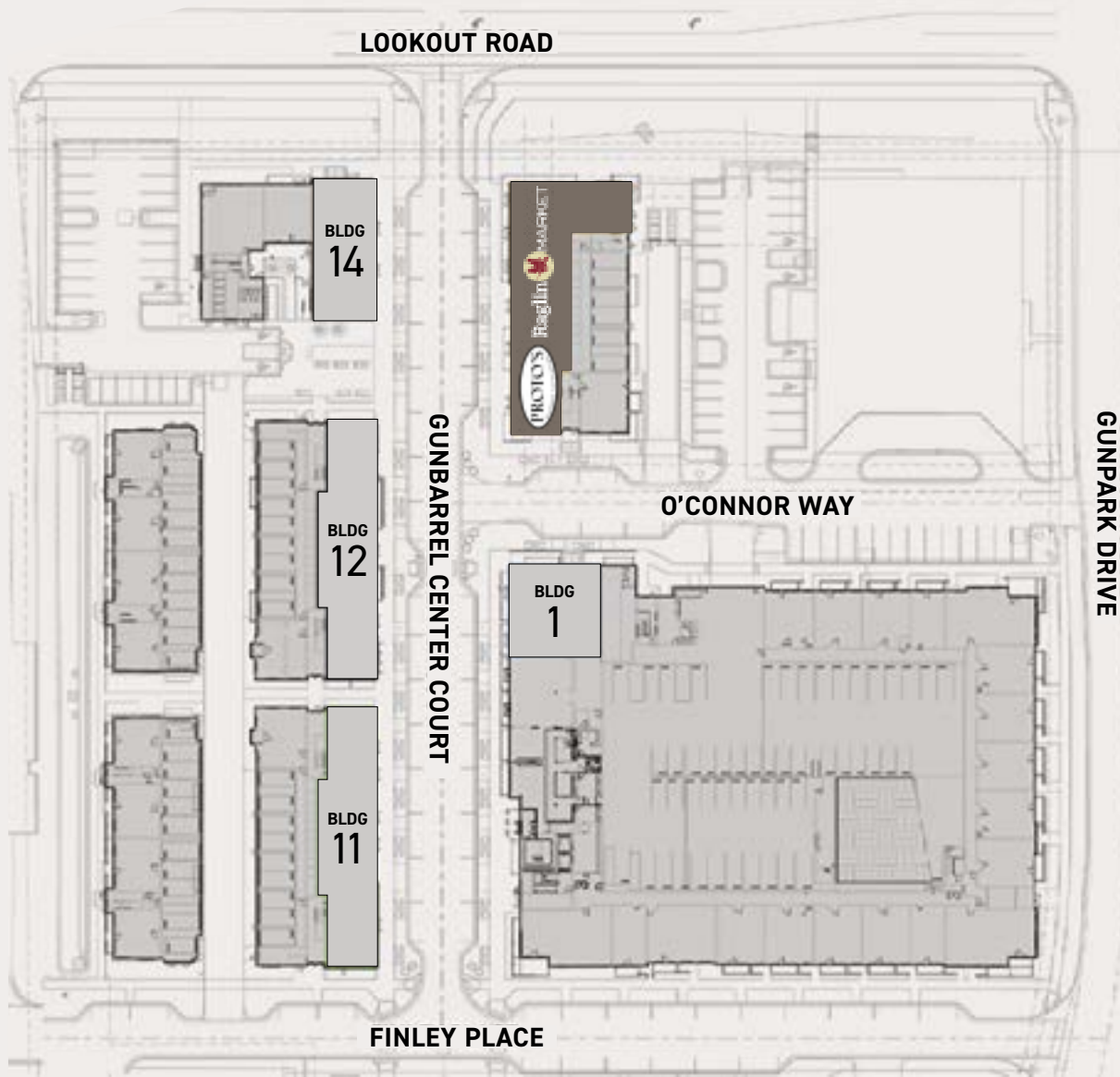

AVAILABLE SPACES



### MEDIAN AGE

1 Mile	41.1
3 Miles	44.7
5 Miles	40.4



### HOUSEHOLDS

1 Mile	2,992
3 Miles	7,693
5 Miles	26,868



### AVG HH INCOME

1 Mile	142,480
3 Miles	169,629
5 Miles	160,269



### DAYTIME POPULATION

1 Mile	11,245
3 Miles	22,819
5 Miles	90,398

BENEFIT FROM THE **DYNAMIC MIX OF RESIDENTS AND DAYTIME WORKERS** COUPLED WITH THE UNMET COMMERCIAL NEEDS OF THIS GROWING AREA

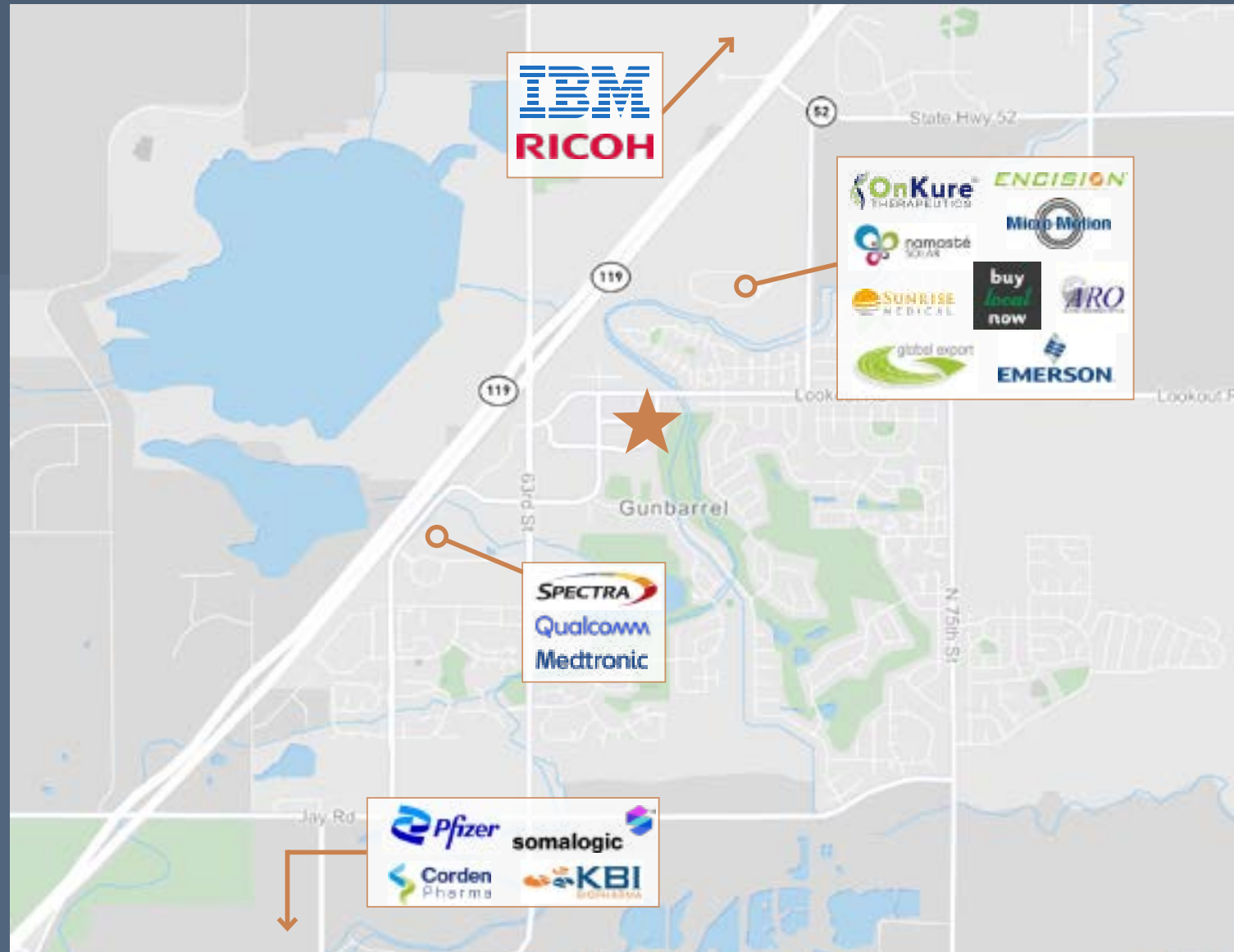

# GUNBARREL CENTER



GUNBARREL CENTER DRIVE | BOULDER, CO 80301



## CBRE

FOR MORE INFORMATION,  
PLEASE CONTACT:

**MOLLY BAYER**

+1 303 870 3441

[molly.bayer@cbre.com](mailto:molly.bayer@cbre.com)

© 2024 CBRE, Inc. All rights reserved. This information has been obtained from reliable sources but has not been verified for accuracy or completeness. CBRE, Inc. makes no guarantee, representation, or warranty and accepts no responsibility or liability for the accuracy, completeness, or reliability of the information contained herein. You should conduct a careful, independent investigation of the property and verify all information. Any reliance on this information is solely at your own risk. CBRE and the CBRE logo are service marks of CBRE, Inc. All other marks displayed on this document are the property of their respective owners, and the use of such marks does not imply any affiliation with or endorsement of CBRE. Photos herein are the property of their respective owners. Use of these images without the express written consent of the owner is prohibited.