



Colliers

W. OKEECHOBEE ROAD

NW 112 COURT

For Lease

Owned By:



**Contact us:**

**Erin Byers, SIOR**

Executive Vice President  
+1 786 493 3178  
erin.byers@colliers.com

**Lauren Pace**

Senior Vice President  
+1 305 710 2994  
lauren.pace@colliers.com

**Frankie Castellanos**

Vice President  
+1 305 972 6323  
frankie.castellanos@colliers.com

**Colliers**

801 Brickell Avenue  
Suite 900  
Miami, FL 33131, USA

colliers.com

## SEAGIS IOS @ MEDLEY INDUSTRIAL PARK

11100 NW 112th Court Medley, FL 33178

### PROPERTY HIGHLIGHTS:

**Site Size:** ±102,366 SF (±2.35 Acres)

**Total Available SF:** ±11,510 SF

**Office Space:** ±3,740 SF

**Maintenance Facility:** ±7,770 SF

**Loading:** 8 Drive-In Doors

**Parking:** 31 Car Spaces

**Outdoor Storage:** Secure, spacious yard available for equipment and vehicle storage.

**Access & Visibility:** Prominent frontage and excellent visibility along Okeechobee Blvd, strategically positioned with strong street presence in the heart of Medley, FL.

This document/email has been prepared by Colliers for advertising and general information only. Colliers makes no guarantees, representations or warranties of any kind, expressed or implied, regarding the information including, but not limited to, warranties of content, accuracy and reliability. Any interested party should undertake their own inquiries as to the accuracy of the information. Colliers excludes unequivocally all inferred or implied terms, conditions and warranties arising out of this document and excludes all liability for loss and damages arising there from. This publication is the copyrighted property of Colliers and /or its licensors(s). © 2025. All rights reserved. This communication is not intended to cause or induce breach of an existing listing agreement. Colliers International Florida, LLC

Accelerating success.



# Property Survey

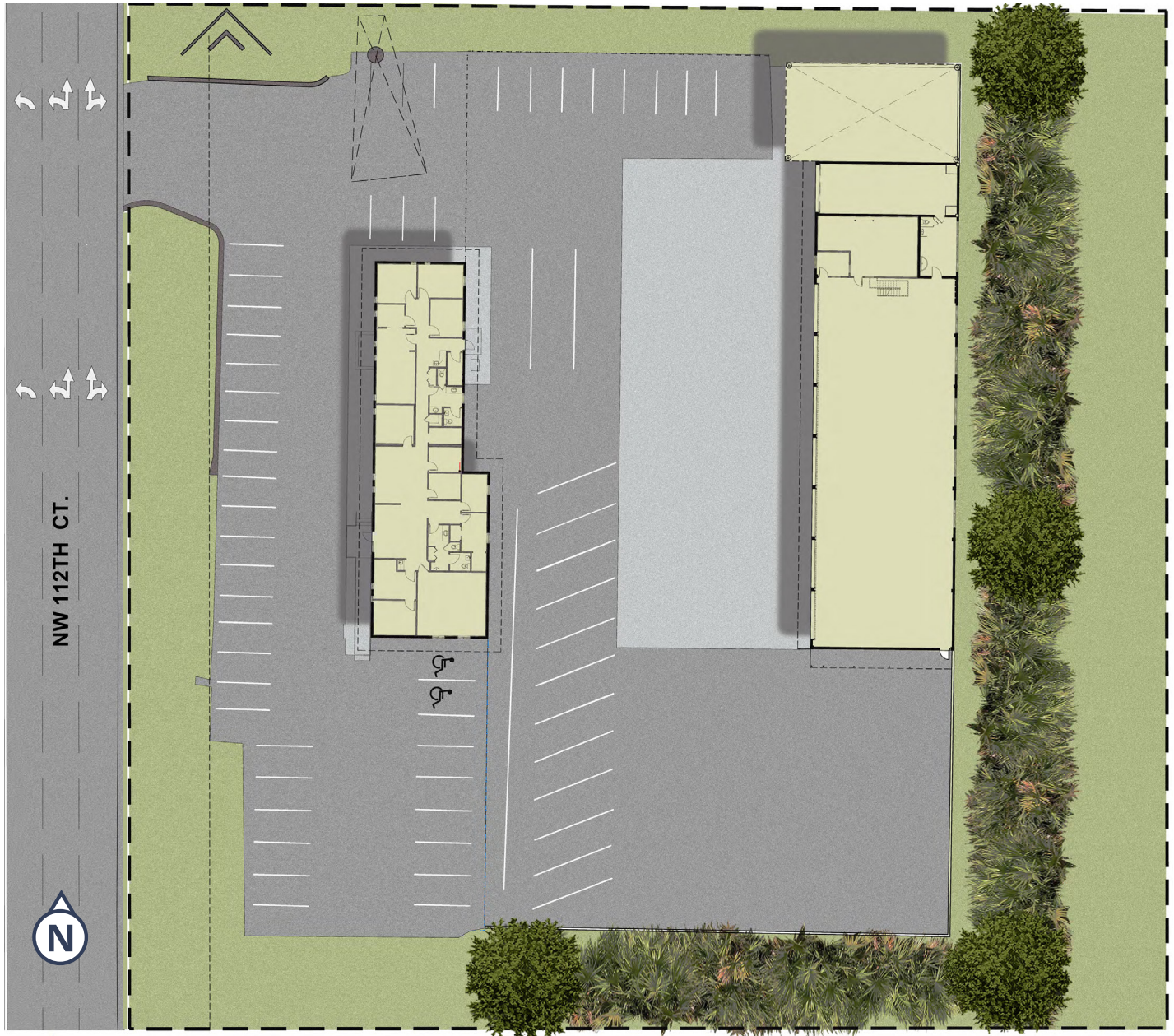



# Location Overview

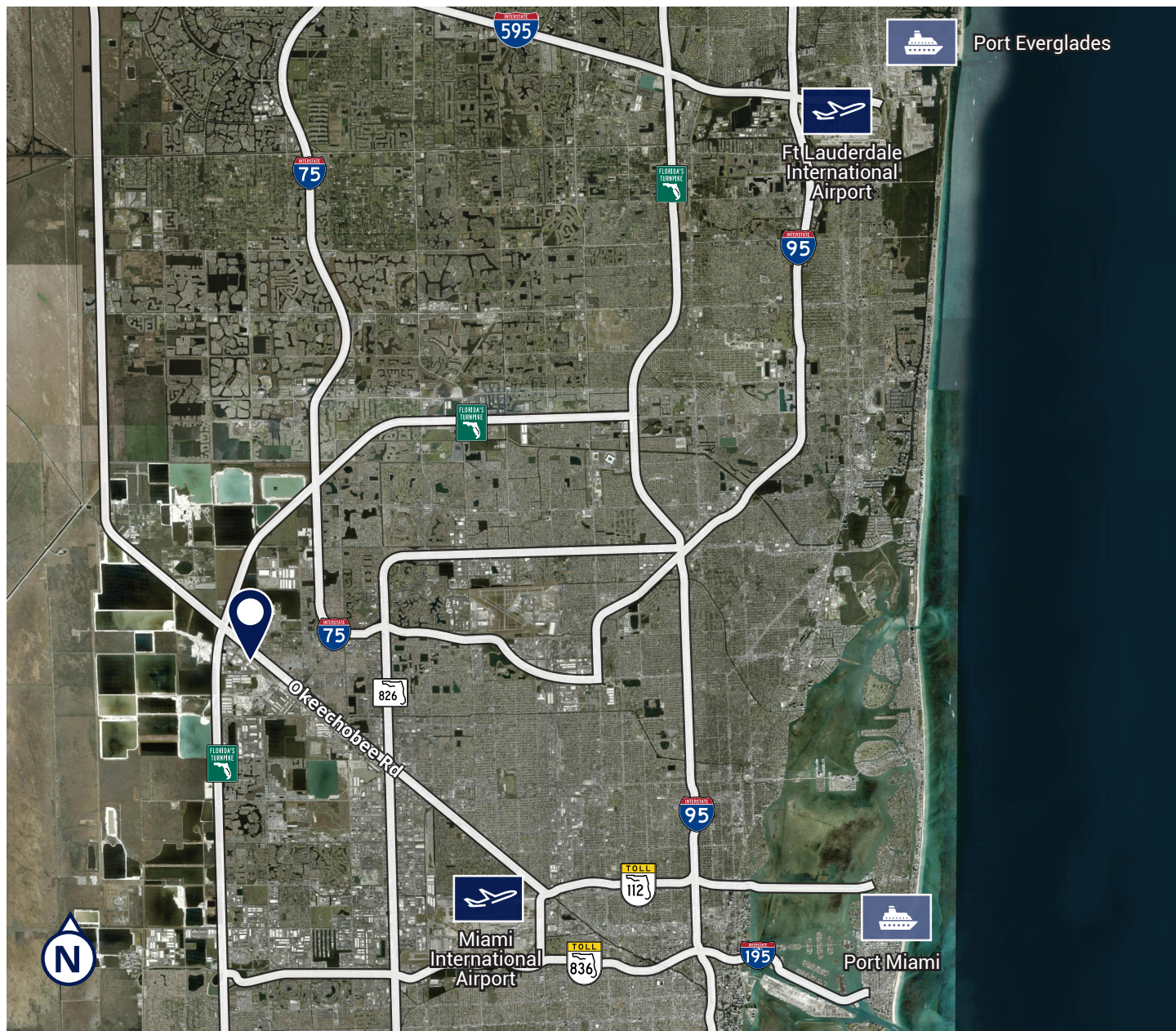

Subject  
property



Miami & FTL  
International Airports



PortMiami &  
Port Everglades

## Legend and Overview

- **Proximity to Major Markets:** Centrally located near both Miami and Fort Lauderdale, offering direct access to South Florida's key business hubs.
- **Transportation Access:** Immediate connectivity to major thoroughfares including the Florida Turnpike, SR-826, and SR-836, with quick access to Miami International Airport, PortMiami, and Port Everglades.