

Property For Lease

33 Queens Street

33 Queens Street Syosset, NY 11791



For More Information:



Christopher Pesce
Licensed Real Estate Salesperson
516.557.5686
christopher.pesce@elliman.com



Kenneth Hester
Licensed Real Estate Salesperson
516.641.0342
kenneth.hester@elliman.com

WWW.ELLIMANCOMMERCIAL.COM

110 WALT WHITMAN ROAD, HUNTINGTON STA., NY 11746, 631.549.7401. © 2021 DOUGLAS ELLIMAN COMMERCIAL, L.L.C. ALL MATERIAL PRESENTED HEREIN IS INTENDED FOR INFORMATION PURPOSES ONLY. WHILE THIS INFORMATION IS BELIEVED TO BE CORRECT, IT IS REPRESENTED SUBJECT TO ERRORS, OMISSIONS, CHANGES OR WITHDRAWAL WITHOUT NOTICE. ALL PROPERTY INFORMATION, INCLUDING, BUT NOT LIMITED TO SQUARE FOOTAGE, ROOM COUNT, ZONING IN THE LISTING SHOULD BE VERIFIED BY YOUR OWN ATTORNEY, ARCHITECT OR ZONING EXPERT. IF YOUR PROPERTY IS CURRENTLY LISTED WITH ANOTHER REAL ESTATE BROKER, PLEASE DISREGARD THIS OFFER. IT IS NOT OUR INTENTION TO SOLICIT THE OFFERINGS OF OTHER REAL ESTATE BROKERS. WE COOPERATE WITH THEM FULLY. EQUAL HOUSING OPPORTUNITY



Office Property For Lease

33 Queens Street Syosset, NY 11791



Offering Summary	
Lease Rate:	\$26.50 SF/yr (MG)
Building Size:	15,670 SF
Available SF:	2,000 - 5,000 SF
Year Built:	1965
Renovated:	2021
Market:	New York-Northern New Jersey-Long Island, NY-NJ-PA

Property Overview

+/- 3,000 SF and 2,000 SF (total of 5,000 SF space also available) of Office Space Available for Lease in Syosset conveniently located just a couple of blocks away from the Syosset Train Station (LIRR). The space consists of 5 partitioned offices, conference room and space for kitchenette. This property has private parking, located across from the Post Office and is surrounded by dense retail area with banks, restaurants, day care, gas stations and more! Contact us today for a showing!

Property Highlights

- Lots of Natural Light
- Next to Syosset LIRR
- Across from the Post Office
- Close to Restaurants, Banks and other Retailers

For More Information:

Christopher Pesce



Licensed Real Estate Salesperson
516.557.5686
christopher.pesce@elliman.com

[Click for Agent Profile](#)

Kenneth Hester



Licensed Real Estate Salesperson
516.641.0342
kenneth.hester@elliman.com

[Click for Agent Profile](#)



WWW.ELLIMANCOMMERCIAL.COM



Office Property For Lease

33 Queens Street Syosset, NY 11791



For More Information:

Christopher Pesce

Licensed Real Estate Salesperson
516.557.5686
christopher.pesce@elliman.com



[Click for Agent Profile](#)

Kenneth Hester

Licensed Real Estate Salesperson
516.641.0342
kenneth.hester@elliman.com



[Click for Agent Profile](#)

Douglas Elliman
COMMERCIAL

WWW.ELLIMANCOMMERCIAL.COM



Office Property For Lease

33 Queens Street Syosset, NY 11791

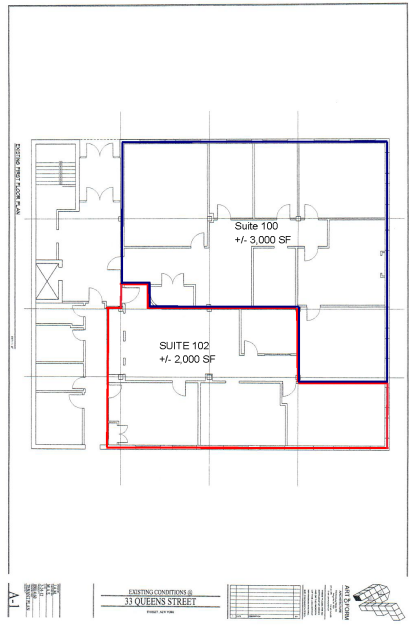
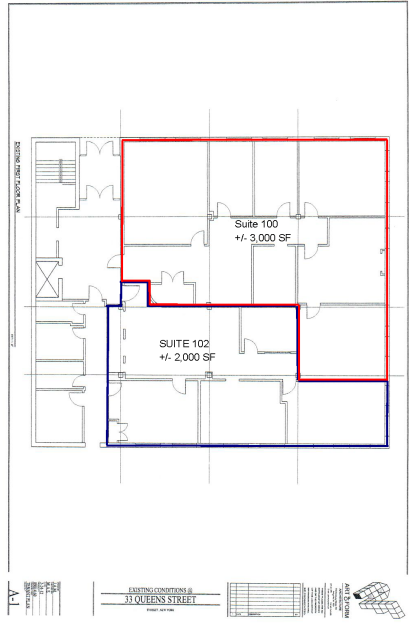

For More Information:

Christopher Pesce



Licensed Real Estate Salesperson
516.557.5686
christopher.pesce@elliman.com

[Click for Agent Profile](#)

Kenneth Hester



Licensed Real Estate Salesperson
516.641.0342
kenneth.hester@elliman.com

[Click for Agent Profile](#)

Douglas Elliman
COMMERCIAL

WWW.ELLIMANCOMMERCIAL.COM



Office Property For Lease

33 Queens Street Syosset, NY 11791

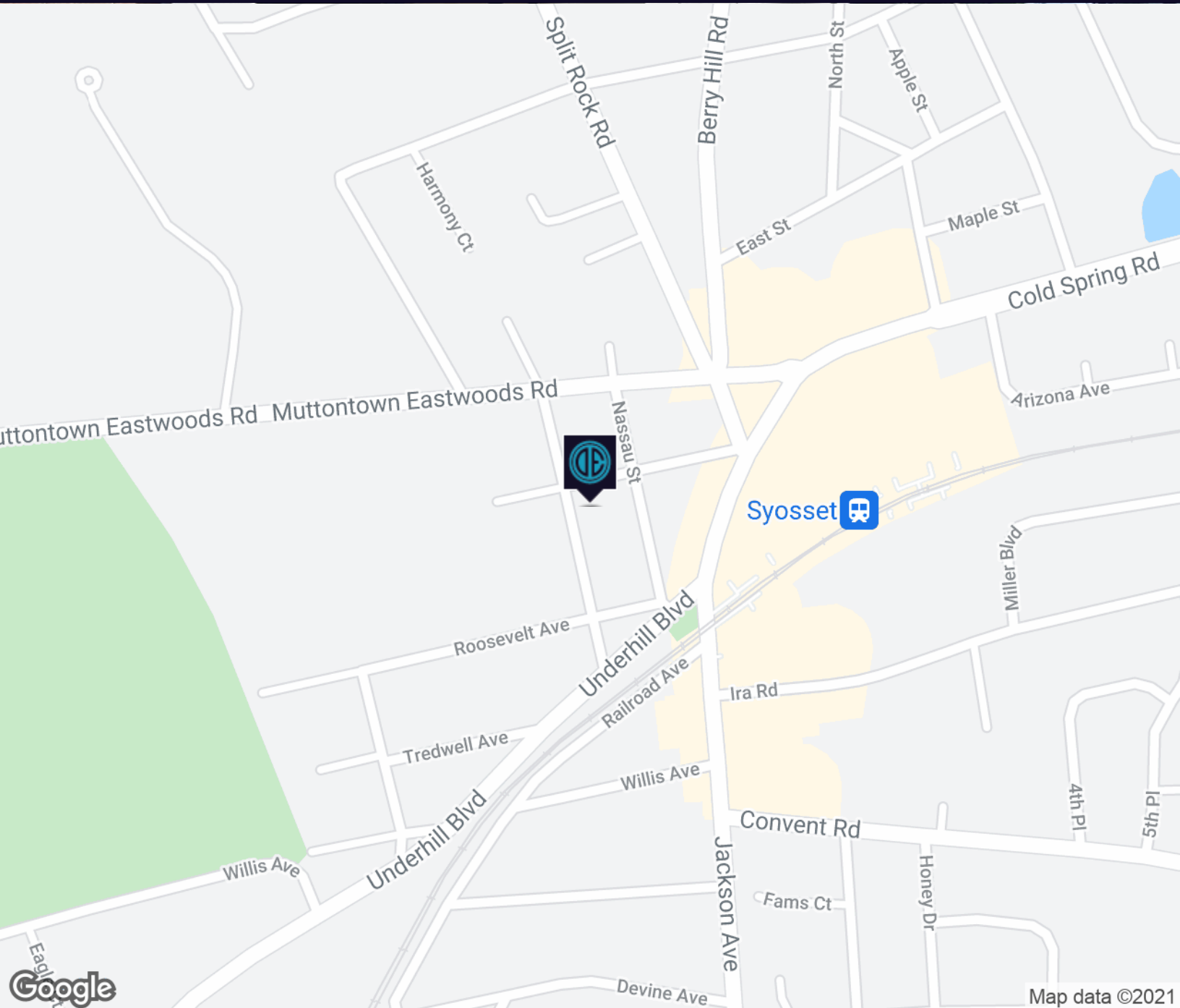

For More Information:

Christopher Pesce

Licensed Real Estate Salesperson
516.557.5686
christopher.pesce@elliman.com



[Click for Agent Profile](#)

Kenneth Hester

Licensed Real Estate Salesperson
516.641.0342
kenneth.hester@elliman.com



[Click for Agent Profile](#)

Douglas Elliman
COMMERCIAL

WWW.ELLIMANCOMMERCIAL.COM



Office Property For Lease

33 Queens Street Syosset, NY 11791

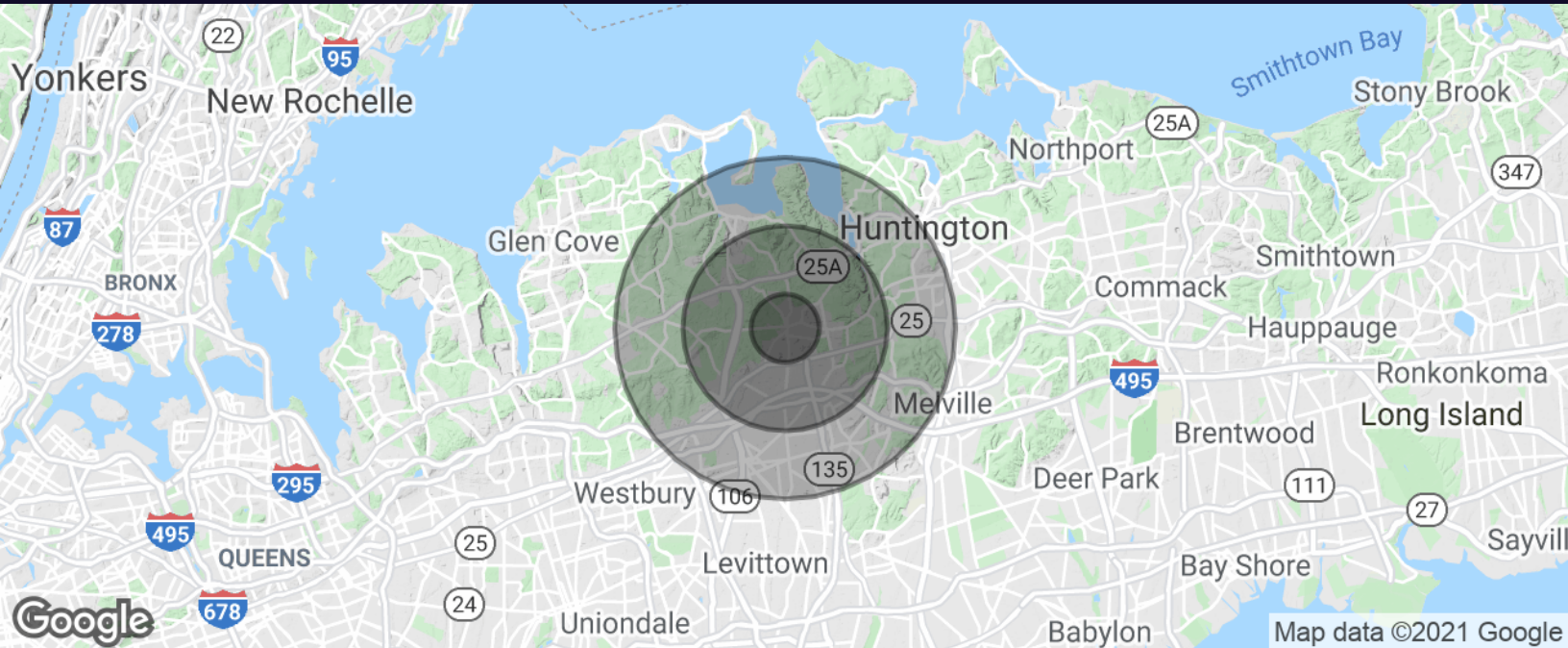

Population	1 Mile	3 Miles	5 Miles
Total Population	8,617	59,290	164,251
Average age	39.8	43.3	43.6
Average age (Male)	38.8	41.9	42.6
Average age (Female)	40.9	44.3	44.3

Households & Income	1 Mile	3 Miles	5 Miles
Total households	2,784	19,426	55,512
# of persons per HH	3.1	3.1	3.0
Average HH income	\$161,720	\$169,089	\$155,070
Average house value	\$718,173	\$656,401	\$635,441

For More Information:

Christopher Pesce



Licensed Real Estate Salesperson
516.557.5686
christopher.pesce@elliman.com

[Click for Agent Profile](#)

Kenneth Hester



Licensed Real Estate Salesperson
516.641.0342
kenneth.hester@elliman.com

[Click for Agent Profile](#)

Douglas Elliman
COMMERCIAL

WWW.ELLIMANCOMMERCIAL.COM

WE ARE COMMERCIAL REAL ESTATE

Commercial real estate involves more than just property listings. To get the most effective results, you need to partner with a company that has a full complement of services and an in-depth team of professionals to help with all of your needs. Douglas Elliman's team of commercial real estate experts is committed to unrivaled performance standards when working with tenants, investors, purchasers and owners. We represent all major property types including office, industrial, retail, apartment and land. We treat each other each assignment with commitment and focus, from a single transaction in a local market to national and multi-market assignments. We help negotiate contracts, coordinate construction and provide both property management as well as ongoing advisory service to satisfy your changing real estate needs. Our breadth of market knowledge, unprecedented network and use of innovative technology extend to all types of property transactions.

For More Information:



Christopher Pesce

Licensed Real Estate Salesperson
516.557.5686
christopher.pesce@elliman.com



Kenneth Hester

Licensed Real Estate Salesperson
516.641.0342
kenneth.hester@elliman.com

Office: 631.858.2405

Fax: 631.543.0851

Huntington, NY 11743

1772 E. Jericho Turnpike Ste. 1A