



3,900 - 19,900 SF OFFICE/WAREHOUSE FOR LEASE

# 6900 SHADY OAK RD

EDEN PRAIRIE, MN 55344

TOM HAYHOE  
+1 952 924 4804  
[tom.hayhoe@cbre.com](mailto:tom.hayhoe@cbre.com)

TOM BENNETT  
+1 952 924 4897  
[tom.bennett@cbre.com](mailto:tom.bennett@cbre.com)

PARKER RICKERT  
+1 612 845 8022  
[parker.rickert@cbre.com](mailto:parker.rickert@cbre.com)

**CBRE**



3,900 - 19,900 SF OFFICE/WAREHOUSE FOR LEASE

# 6900 SHADY OAK RD

EDEN PRAIRIE, MN 55344

## PROPERTY FEATURES

- 16,000 SF warehouse
- 18' clear height
- 2 dock doors
- 1,100 SF + shared restrooms, furnished conference area, kitchen and break area
- All-inclusive rate! Also includes janitorial in all common areas, restrooms, etc.
- Impressive common entry
- 3 private offices plus large area for private conference or cubes
- Signage available on monument if requested
- Available now
- Flexible lease terms!

## PROPERTY SPECIFICATIONS

### TOTAL BUILDING SF

52,203 SF

### AVAILABLE SPACE

Suite 1 Warehouse: 16,000 SF

Suite 2 Office: 3,900 SF

Suite 3 Office/Warehouse: 19,900 SF

(3,900 SF Office/ 16,000 SF Warehouse)

### PARKING

2.09/1,000

### CEILING HEIGHT

18' ceiling height

### LAND AREA

3.82 acres



# FLOOR PLAN

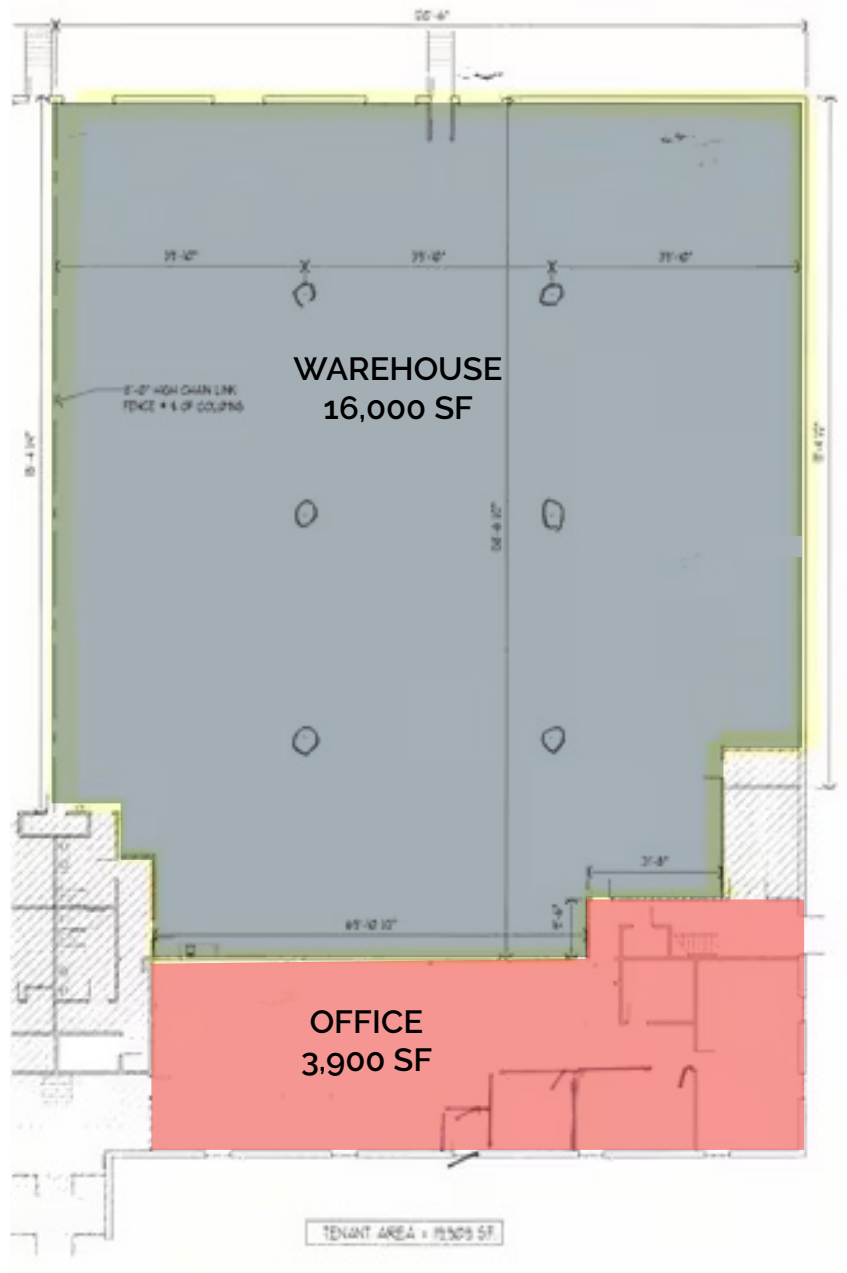



# SITE PLAN





3,900 - 19,900 SF OFFICE/WAREHOUSE FOR LEASE

# 6900 SHADY OAK

EDEN PRAIRIE, MN 55344







3,900 - 19,900 SF OFFICE/WAREHOUSE FOR LEASE

# 6900 SHADY OAK RD

EDEN PRAIRIE, MN 55344

## CONTACT US

**TOM HAYHOE**  
+1 952 924 4804  
[tom.hayhoe@cbre.com](mailto:tom.hayhoe@cbre.com)

**TOM BENNETT**  
+1 952 924 4897  
[tom.bennett@cbre.com](mailto:tom.bennett@cbre.com)

**PARKER RICKERT**  
+1 612 845 8022  
[parker.rickert@cbre.com](mailto:parker.rickert@cbre.com)

# CBRE

© 2025 CBRE, Inc. All rights reserved. This information has been obtained from sources believed reliable, but has not been verified for accuracy or completeness. You should conduct a careful, independent investigation of the property and verify all information. Any reliance on this information is solely at your own risk. CBRE and the CBRE logo are service marks of CBRE, Inc. All other marks displayed on this document are the property of their respective owners, and the use of such logos does not imply any affiliation with or endorsement of CBRE. Photos herein are the property of their respective owners. Use of these images without the express written consent of the owner is prohibited.