



**+/- 39,786 SF AVAILABLE FOR LEASE / SALE**

4601 Lewis Road

Stone Mountain, GA 30127



## PROPERTY INFORMATION

<b>Total Size:</b>	+/- 39,786 SF
<b>Office:</b>	+/- 2,200 SF
<b>Warehouse:</b>	+/- 37,586 SF
<b>Loading:</b>	Five (5) Dock High Doors One (1) Drive-In Door (22' wide x 14' high)
<b>Clear Height:</b>	18' - 20'
<b>Power:</b>	1,000 Amps, 120/208 Volt, 3-Phase
<b>Available:</b>	Immediately
<b>Location:</b>	< 1 mile from Mountain Industrial Blvd and Hwy 78
<b>Features:</b>	Renovated Office Fully Sprinklered IOS Available

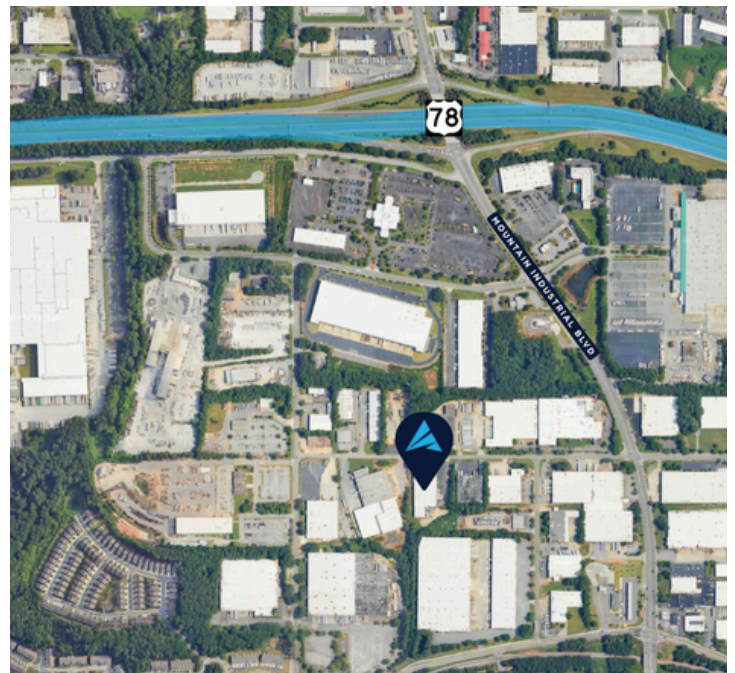

For more information, please contact:

### RYAN BLACKBURN

Office: (404) 974 - 2716  
Cell: (404) 821 - 7715  
rblackburn@apexindustrialre.com

### ADAM JAMAL

Office: (770) 264 - 9423  
Cell: (678) 467 - 5869  
ajamal@apexindustrialre.com



Although the information contained therein was provided from sources believed to be reliable, Apex Industrial makes no representation, expressed or implied, as to its accuracy and said information is subject to errors, omissions or changes.



**+/- 39,786 SF AVAILABLE FOR LEASE / SALE**

4601 Lewis Road

Stone Mountain, GA 30127

# FLOOR PLAN

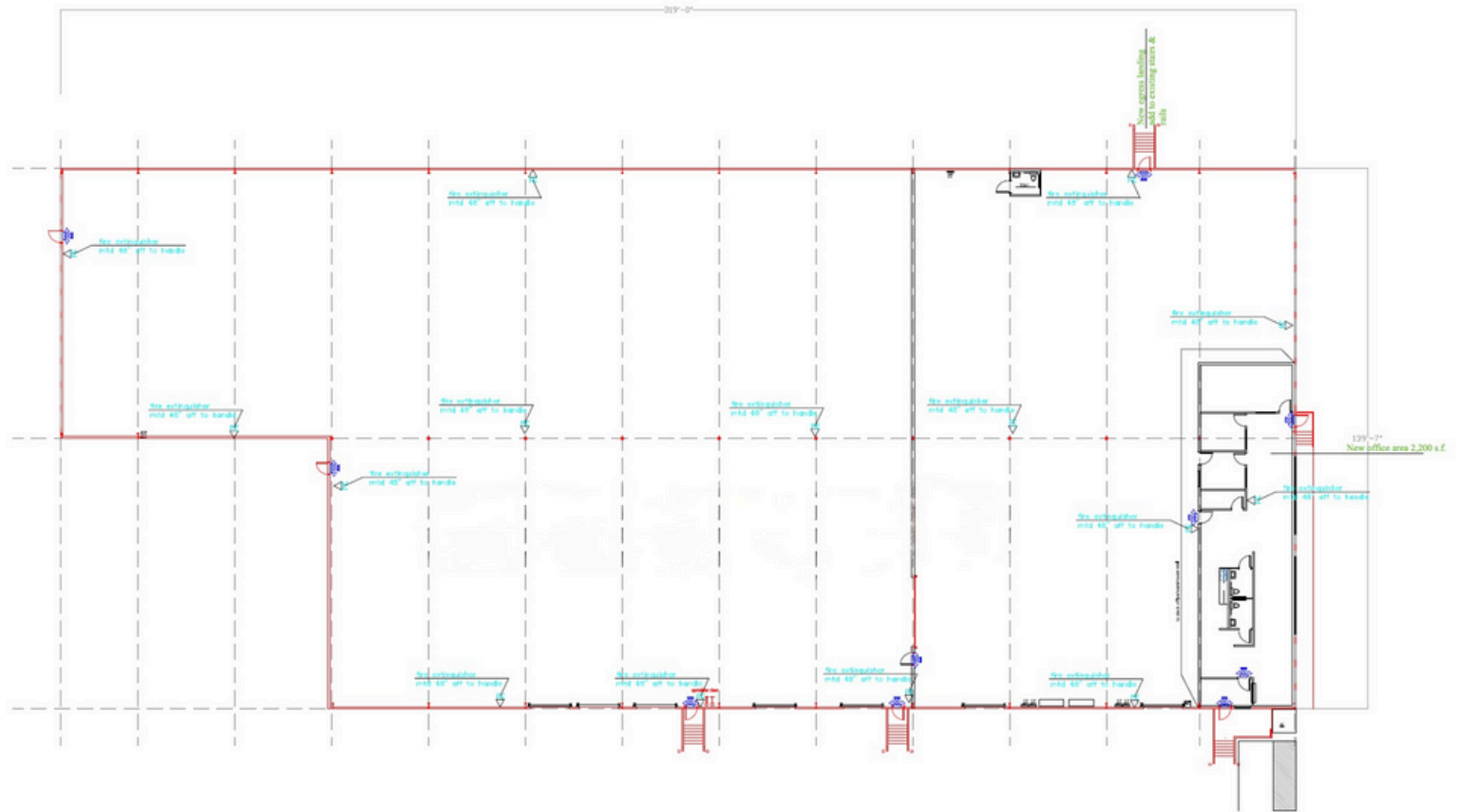

For more information, please contact:

**RYAN BLACKBURN**

Office: (404) 974 - 2716  
Cell: (404) 821 - 7715  
rblackburn@apexindustrialre.com

**ADAM JAMAL**

Office: (770) 264 - 9423  
Cell: (678) 467 - 5869  
ajamal@apexindustrialre.com



Although the information contained therein was provided from sources believed to be reliable, Apex Industrial makes no representation, expressed or implied, as to its accuracy and said information is subject to errors, omissions or changes.





**+/- 39,786 SF AVAILABLE FOR LEASE / SALE**

4601 Lewis Road

Stone Mountain, GA 30127

## ADDITIONAL PHOTOS



For more information, please contact:

**RYAN BLACKBURN**

Office: (404) 974 - 2716

Cell: (404) 821 - 7715

[rblackburn@apexindustrialre.com](mailto:rblackburn@apexindustrialre.com)

**ADAM JAMAL**

Office: (770) 264 - 9423

Cell: (678) 467 - 5869

[ajamal@apexindustrialre.com](mailto:ajamal@apexindustrialre.com)



Although the information contained therein was provided from sources believed to be reliable, Apex Industrial makes no representation, expressed or implied, as to its accuracy and said information is subject to errors, omissions or changes.