

2701 HIGHPOINT DRIVE

MILTON | FOR SUBLEASE



572,192 SQ. FT.
Freezer/Cooler Facility

FOR MORE INFORMATION PLEASE CONTACT:

Kyle Hanna*

Senior Vice President
416.798.6255
kyle.hanna@cbre.com

Evan S. White*

Executive Vice President
416.798.6232
evan.white@cbre.com

*Sales Representative

CBRE Limited | 5935 Airport Road | Suite 700 | Toronto, ON L4V 1W5 | www.cbre.ca

CBRE

2701 HIGHPOINT DRIVE

MILTON | FOR SUBLEASE

PROPERTY SPECIFICATIONS

Total Building Area:	595,376 Sq. Ft.
Total Rentable Area:	572,192 Sq. Ft.
Office Area	26,627 Sq. Ft.
Total Industrial Area:	548,565 Sq. Ft. Ambient: 268,172 Sq. Ft. Cooler/Mechanical Area: 59,495 Sq. Ft. Cooler Area (2): 101,065 Sq. Ft. Freezer Area: 119,833 Sq. Ft.*
Shipping:	136 Truck level doors / 3 Drive-in doors
Clear Height:	39'6"
Zoning:	M2
Possession:	March 1 st , 2017
Asking Rate:	\$7.35 net per sq. ft.
Taxes (2015):	\$1.84 per sq. ft.**
Trailer Parking:	Includes all Trailer Parking and Car Parking

* 35,095 sq.ft would need to be converted to freezer space

** If a potential tenant requires an estimate of total additional rent CBRE is able to provide an estimate.

COMMENTS:

- Sub tenant has the ability to self manage and maintain the space
- Two on-site transformers (3,000/4,000 amps 4,000/5,000 amps 27,600 volts)
- Double load shipping in some areas
- Excellent access to Highway 401 right off of Highway 25
- Temperature Controlled area suitable for produce, fruit, meats etc. with various temperature and humidity settings.
- Some cooler area can be converted to freezer if required
- Public Transit to site

*Speak with Listing Agents for information on all building equipment

2701 HIGHPOINT DRIVE

MILTON | FOR SUBLEASE

RENTABLE AREA

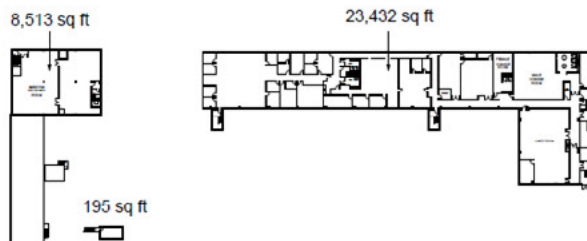
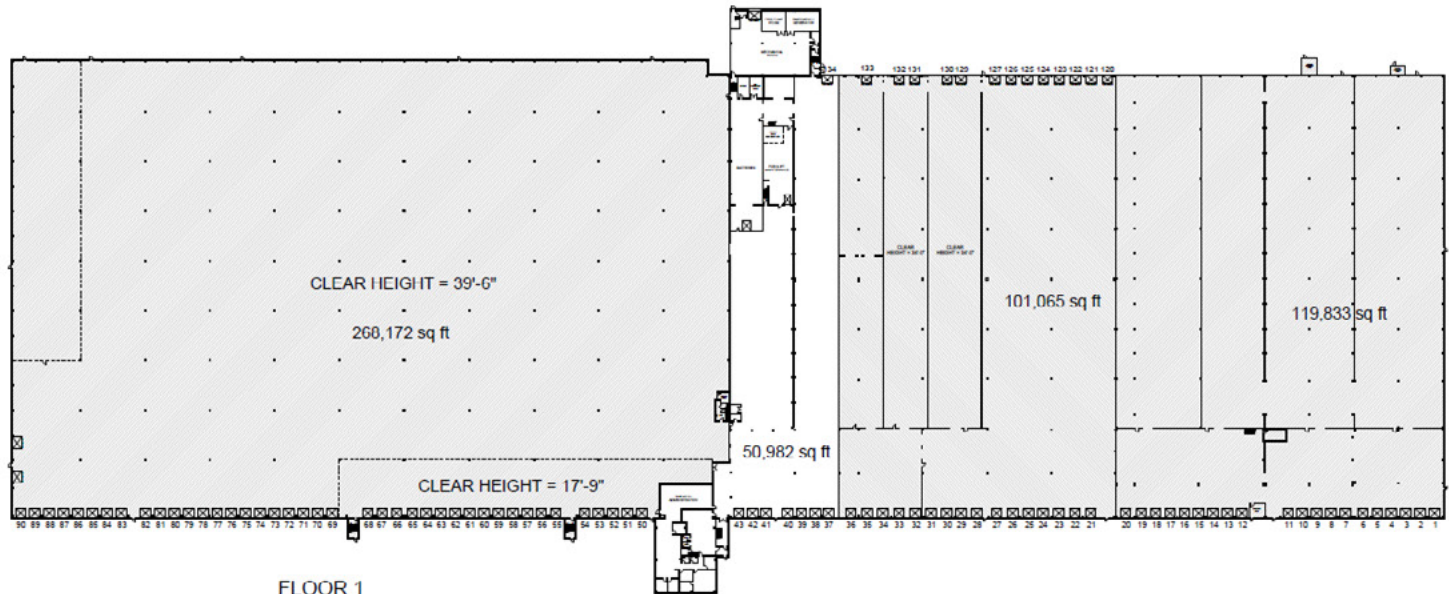

FLOOR 2

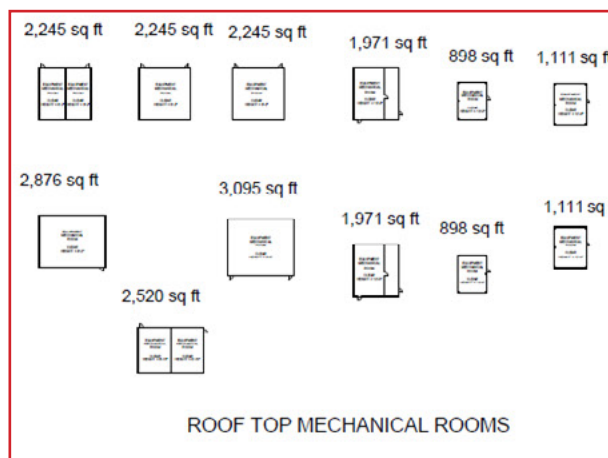

ROOF TOP MECHANICAL ROOMS



Not included in rentable area

2701 HIGHPOINT DRIVE

MILTON | FOR SUBLEASE

WAREHOUSE PLAN DEFINED AREAS

1) Ambient

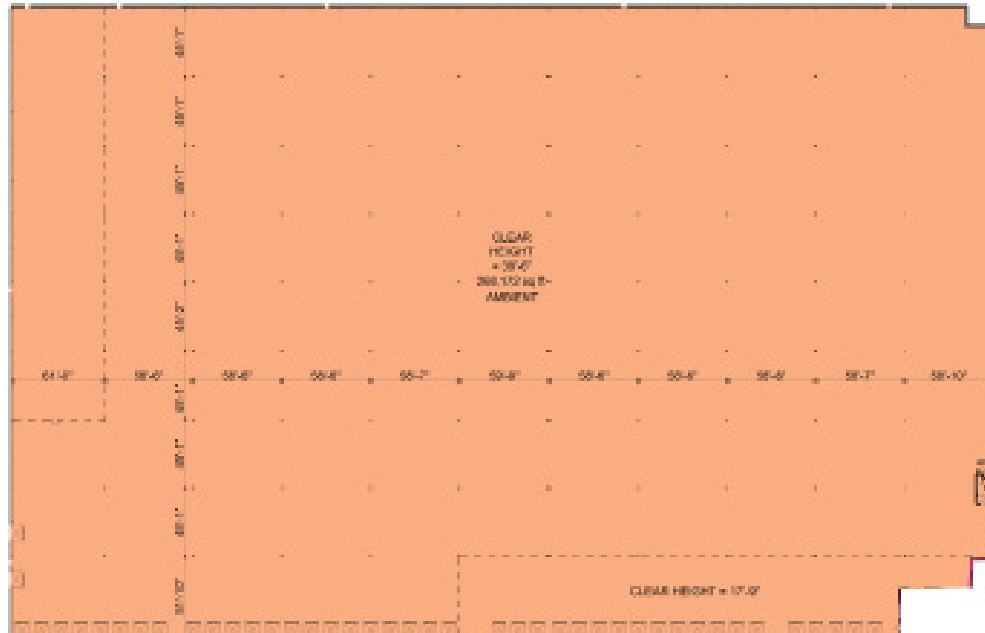

2) Freezer/Cooler



*Temperature settings identified in plan above

2701 HIGHPOINT DRIVE

===== MILTON | FOR SUBLEASE =====

3) Office Area

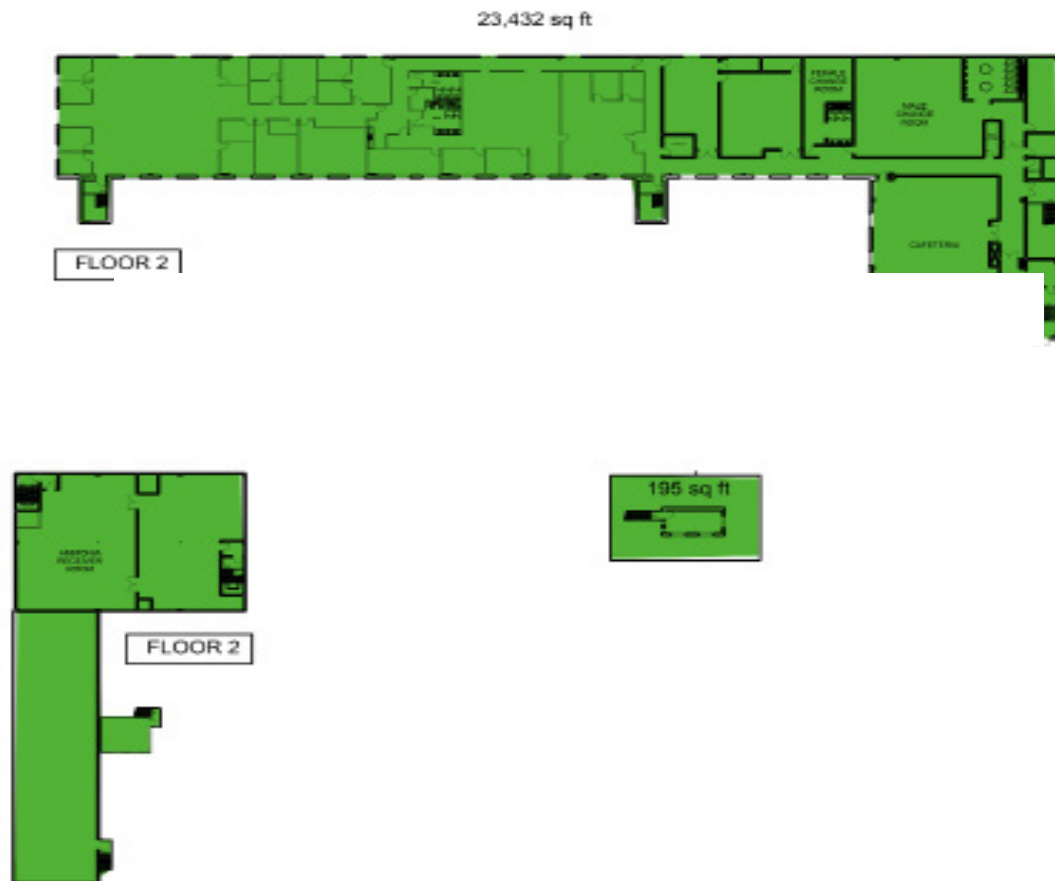

2701 HIGHPOINT DRIVE

MILTON | FOR SUBLEASE

SUBLEASE OPTIONS

OPTION 1.

Entire Building
572,192 Sq. Ft.

*excluding
non-rentable area

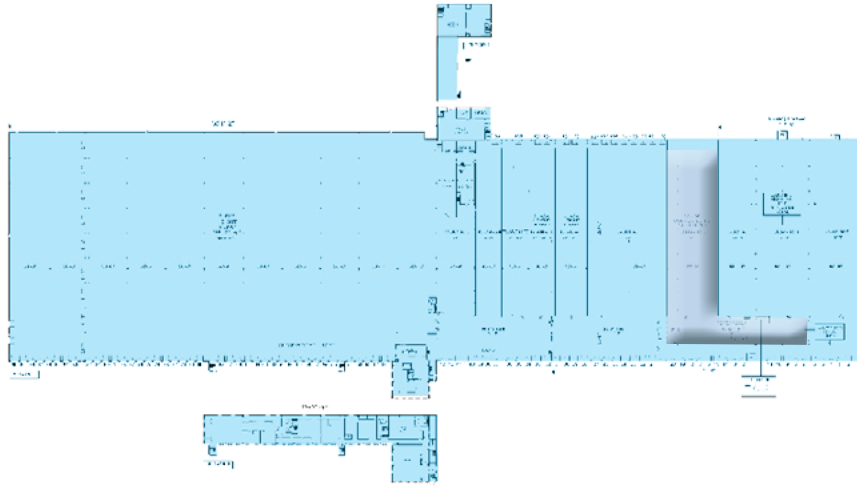

OPTION 2.

Ambient
291,799 Sq. Ft.

Freezer/Cooler
280,393 Sq. Ft.

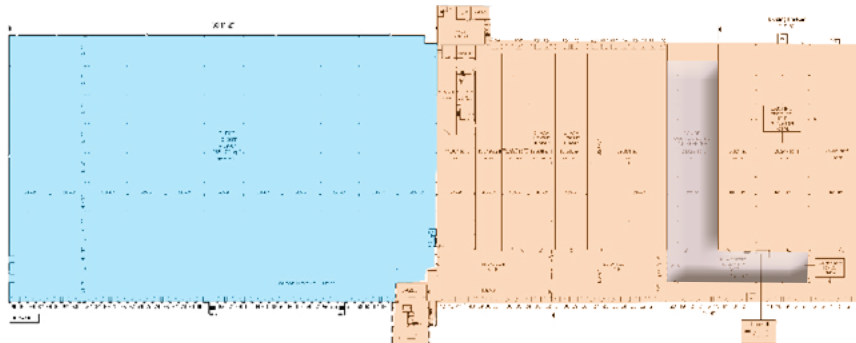

OPTION 2.

Ambient/Cooler
452,395 Sq. Ft.

Freezer
119,833 Sq. Ft.

70,789 Sq. Ft Freezer
13,949 Sq. Ft Staging
35,095 Sq. Ft Conversion

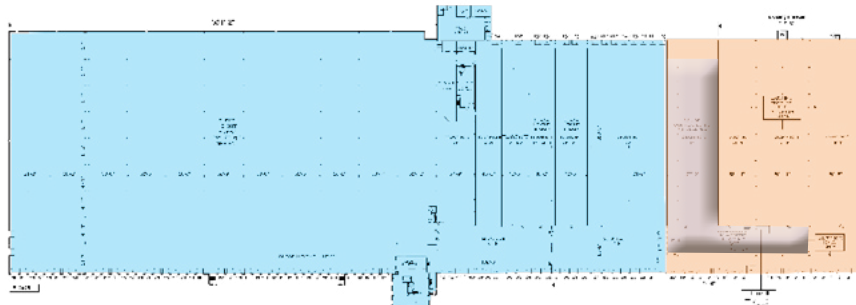

 Area can be converted to Freezer Space
(35,095 sq. ft)

2701 HIGHPOINT DRIVE

===== MILTON | FOR SUBLEASE =====

FREEZER RACKING PLAN

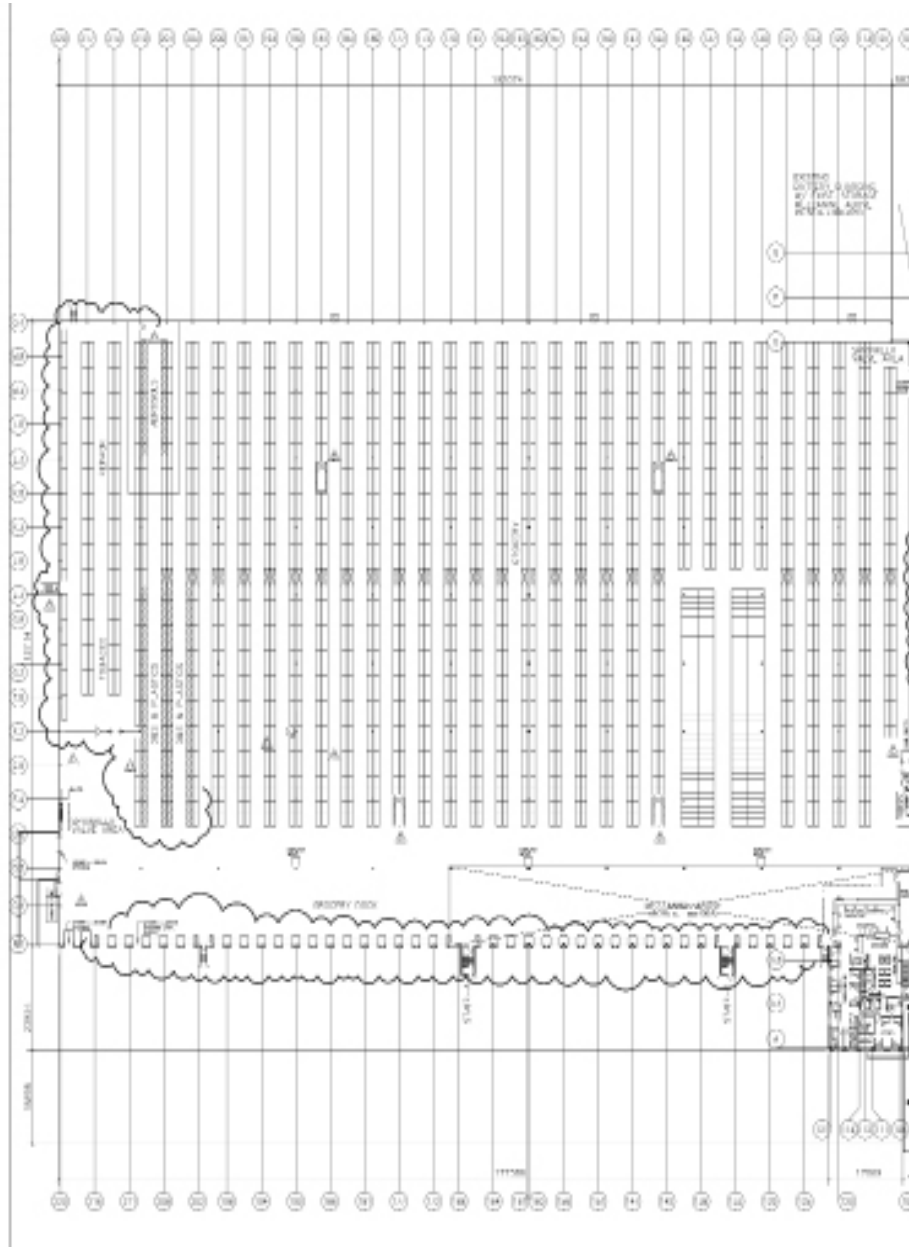

MILTON | FOR SUBLEASE

FLOOR PLAN

2701 HIGHPOINT DRIVE

===== MILTON | FOR SUBLEASE =====

SITE PLAN

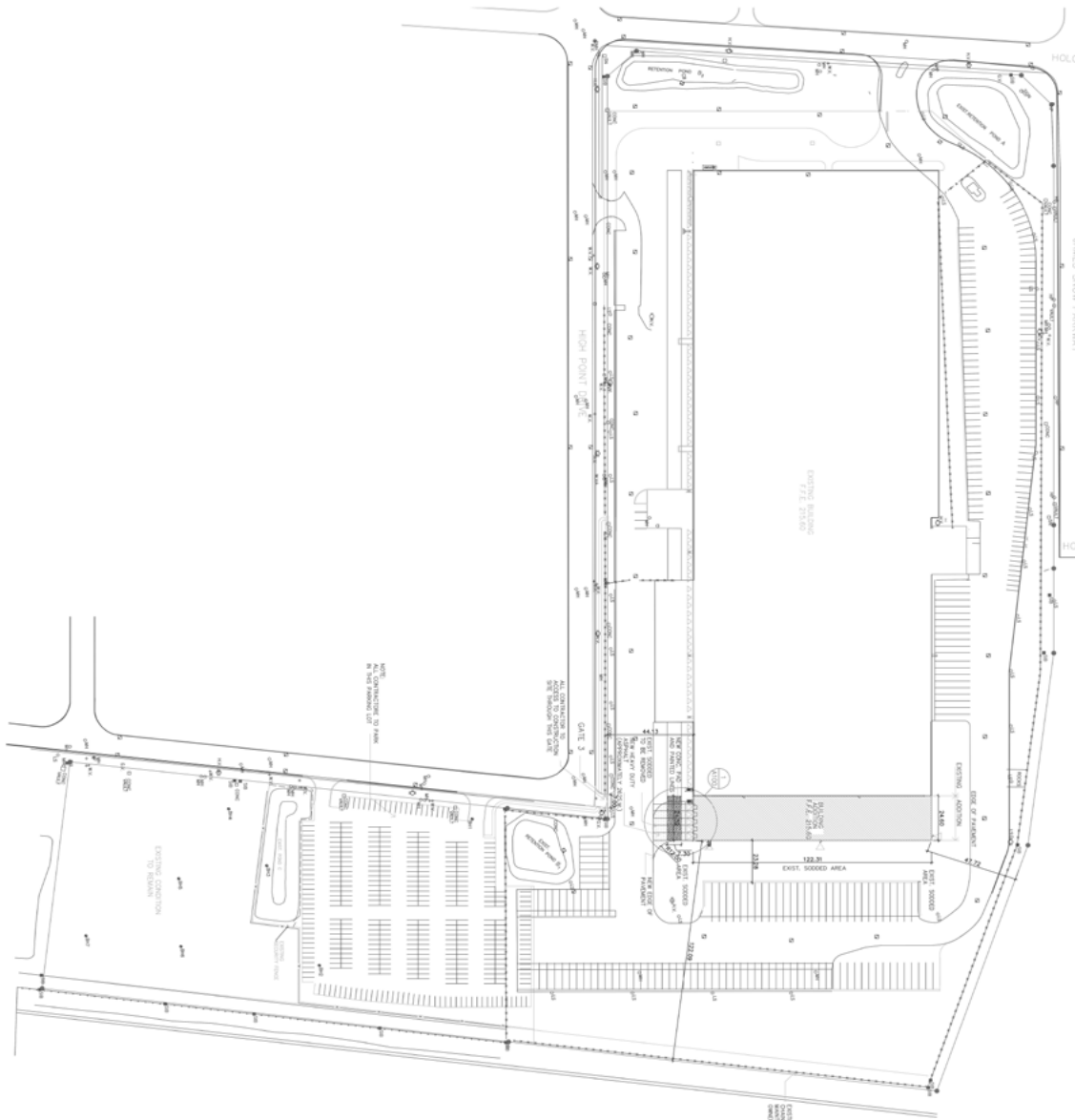

2701 HIGHPOINT DRIVE

MILTON | FOR SUBLEASE

LOCATION MAP

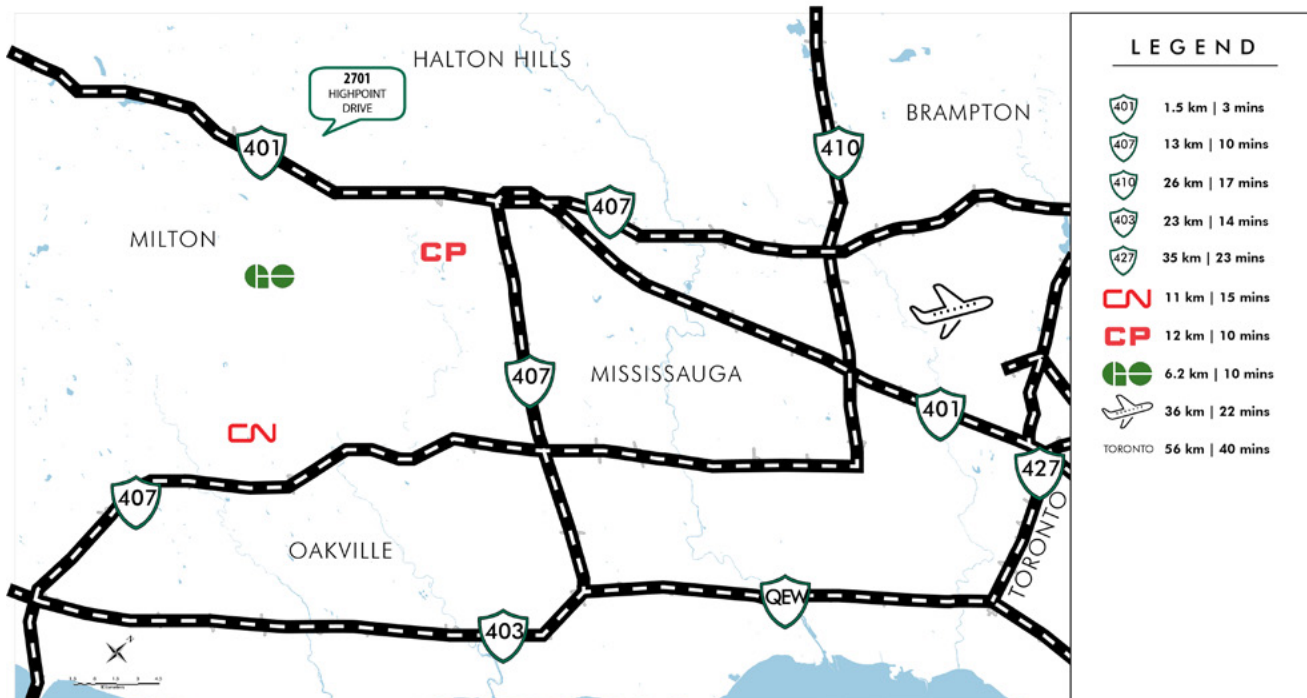

INFRASTRUCTURE IMPROVEMENTS



2701 HIGHPOINT DRIVE

===== MILTON | FOR SUBLEASE =====

BUS ROUTE TO SITE



2701 HIGHPOINT DRIVE

===== MILTON | FOR SUBLEASE =====

EXTERIOR PHOTOS



INTERIOR PHOTOS



CBRE

2701 HIGHPOINT DRIVE

===== MILTON | FOR SUBLEASE =====



FOR MORE INFORMATION PLEASE CONTACT:

Kyle Hanna*

Senior Vice President

416.798.6255

kyle.hanna@cbre.com

Evan S. White*

Executive Vice President

416.798.6232

evan.white@cbre.com

*Sales Representative

CBRE Limited | 5935 Airport Road | Suite 700 | Toronto, ON L4V 1W5 | www.cbre.ca

This disclaimer shall apply to CBRE Limited, Real Estate Brokerage, and to all other divisions of the Corporation ("CBRE"). The information set out herein, including, without limitation, any projections, images, opinions, assumptions and estimates obtained from third parties (the "Information") has not been verified by CBRE, and CBRE does not represent, warrant or guarantee the accuracy, correctness and completeness of the Information. CBRE does not accept or assume any responsibility or liability, direct or consequential, for the Information or the recipient's reliance upon the Information. The recipient of the Information should take such steps as the recipient may deem necessary to verify the Information prior to placing any reliance upon the Information. The Information may change and any property described in the Information may be withdrawn from the market at any time without notice or obligation to the recipient from CBRE. CBRE and the CBRE logo are the service marks of CBRE Limited and/or its affiliated or related companies in other countries. All other marks displayed on this document are the property of their respective owners. All Rights Reserved.
Mapping Sources: Canadian Mapping Services canadamapping@cbre.com; DMTI Spatial, Environics Analytics, Microsoft Bing, Google Earth

CBRE