

SEC 99TH AVENUE
& BUCKEYE ROAD

99TH AVENUE

LOGISTICS CENTER

BUILDING 1

1777 S 99TH AVE

±54,126 SF

99TH AVENUE

JA SOLAR

JA SOLAR

WILDECK



3-BUILDING

INDUSTRIAL DEVELOPMENT

BUILDING 1 ±54,126 SF | **BUILDING 2** - LEASED | **BUILDING 3** - LEASED

MIKE HAENEL | Executive Vice Chair | +1 602 224 4404 | mike.haenel@cushwake.com

ANDY MARKHAM, SIOR | Executive Vice Chair | +1 602 224 4408 | andy.markham@cushwake.com

PHIL HAENEL | Vice Chair | +1 602 224 4409 | phil.haenel@cushwake.com



PROPERTY FEATURES

- ±76.34 Total Acres
- Zoning: CP/GCP (Industrial)
- Direct Access To/From I-10
(on 99th Ave. – 1.7 Miles, 3 Minutes)
- I-10 Interstate Full Diamond Interchanges at 99th Avenue, 91st Avenue, and 107th Avenue
- 7 Points of Ingress/Egress



99TH AVENUE

OFFICE
3,212 SF



260'



BLDG 1
±54,126 SF

270'

50'
TYP.



WILDECK

52'

DURANGO STREET

BUILDING 1

1777 S 99TH AVENUE

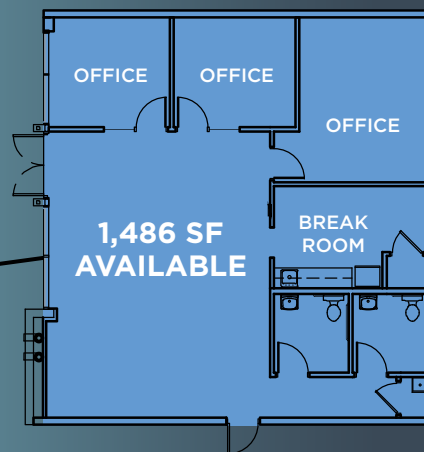

- ±54,126 SF (Divisible)
- Clear Height: 32'
- 9 Dock High Door (12' x 14')
- Power: 500 amps
- 2 Grade Level Doors
- Bay Spacing: 50' X 52' (60' X 52' at Speed Bay)
- 7" Floor Slab Over 4" ABC Unreinforced Slab
- R-30 Insulation with White Scrim
- 1,486 SF Spec Office Suite (NW Corner)
 - Warehouse exterior wall insulation (above 10')
 - Two (2) 35,000 lb capacity mechanical pit levelers
 - Code-min warehouse ventilation system
 - High-bay LED warehouse lighting with motion sensors
 - Demising wall and remote warehouse restrooms designed/ permitted in case needed

99TH AVENUE
LOGISTICS CENTER



STRATEGIC LOCATION



3 MILES
TO THE I-10



319 AMENITIES
WITHIN 3 MILES



20 MINUTES
TO PHX SKY HARBOR AIRPORT



40% LESS
OFFERS UP TO 40% LESS
OPERATIONAL COSTS THAN
CALIFORNIA



216,659
TOTAL RESIDENTIAL POPULATION
IN A 5-MILE RADIUS



TOP 5
STATE FOR PROJECTED GROWTH
PROSPECTS (FORBES)

SAN FRANCISCO
753 MI - 12.1 HRS

RENO
744 MI - 12.3 HRS

SALT LAKE CITY
652 MI - 10.7 HRS

DENVER
909 MI - 13.3 HRS

LAS VEGAS
296 MI - 5.0 HRS

LOS ANGELES
372 MI - 6.0 HRS

SAN DIEGO
355 MI - 5.6 HRS

99TH AVENUE
LOGISTICS CENTER

ALBUQUERQUE
465 MI - 6.9 HRS

TUCSON
118 MI - 1.9 HRS

**MARIPOSA
PORT OF ENTRY**
179 MI - 2.7 HRS

EL PASO
432 MI - 6.4 HRS

DALLAS
1,067 MI - 15.6 HRS

HOUSTON
1,178 MI - 17.2 HRS

**1-2 DAY
DELIVERY ZONE**



99TH AVENUE

— LOGISTICS CENTER



Mike Haenel

Executive Vice Chair
+1 602 224 4404
mike.haenel@cushwake.com

Andy Markham, SIOR

Executive Vice Chair
+1 602 224 4408
andy.markham@cushwake.com

Phil Haenel

Vice Chair
+1 602 224 4409
phil.haenel@cushwake.com

2555 E Camelback Rd, Suite 400 | Phoenix, AZ 85016 | ph +1 602 954 9000 | fax +1 602 253 0528 cushmanwakefield.com



©2025 Cushman & Wakefield. All rights reserved. The information contained in this communication is strictly confidential. This information has been obtained from sources believed to be reliable but has not been verified. NO WARRANTY OR REPRESENTATION, EXPRESS OR IMPLIED, IS MADE AS TO THE CONDITION OF THE PROPERTY (OR PROPERTIES) REFERENCED HEREIN OR AS TO THE ACCURACY OR COMPLETENESS OF THE INFORMATION CONTAINED HEREIN, AND SAME IS SUBMITTED SUBJECT TO ERRORS, OMISSIONS, CHANGE OF PRICE, RENTAL OR OTHER CONDITIONS, WITHDRAWAL WITHOUT NOTICE, AND TO ANY SPECIAL LISTING CONDITIONS IMPOSED BY THE PROPERTY OWNER(S). ANY PROJECTIONS, OPINIONS OR ESTIMATES ARE SUBJECT TO UNCERTAINTY AND DO NOT SIGNIFY CURRENT OR FUTURE PROPERTY PERFORMANCE. COE-PM-WEST- 05/15/25