

FOR LEASE

2285 @ South Salt Lake
 2285 South Main Street • South Salt Lake, UT

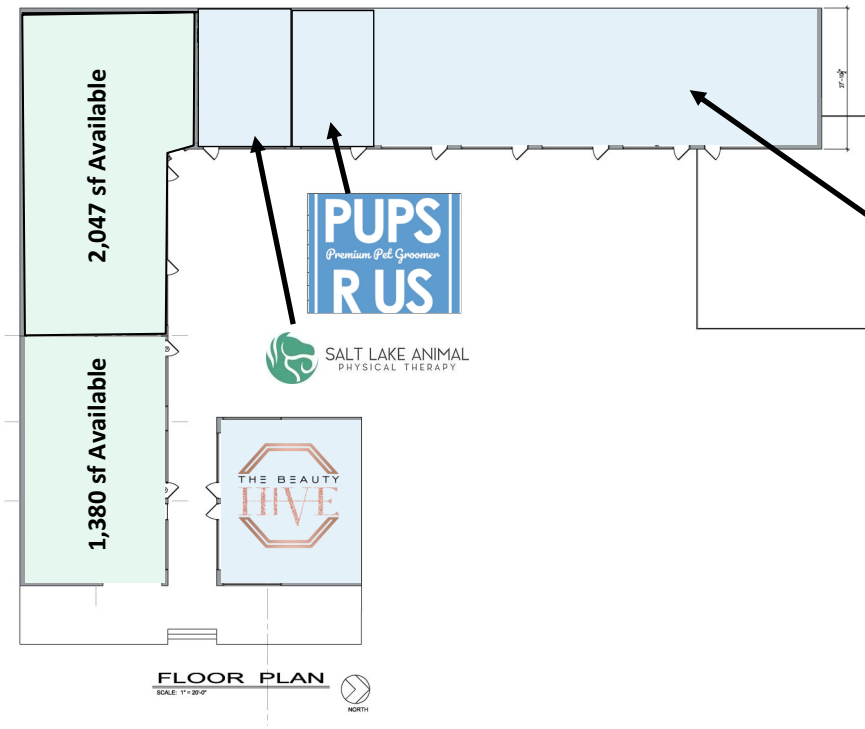

**Chappell
 BREWING**

Property Information:

- 1,380 restaurant space with patio and roll up garage doors (do not disturb current tenant)
- Up 3,427 sf available
- Located in the South Salt Lake's creative industry zone and arts district
 - 3 Million SF of office space
 - 2,600 new residential units

Demographics

Population	1 Mile	3 Mile	5 Mile
2023 Population	15,843	153,709	376,661
2028 Projected	17,086	162,614	387,610

Households	1 Mile	3 Mile	5 Mile
2023 Estimated	7,366	64,937	153,963
2028 Projected	8,139	69,551	159,965

Income	1 Mile	3 Mile	5 Mile
2023 Est. Avg HH	\$72,608	\$92,026	\$102,866
2028 Est Med HH	\$70,743	\$84,919	\$86,032

Lisa Vandersteen
 lisav@amsource.com
 801.741.4530



FOR LEASE 2285 @ South Salt Lake

2285 South Main Street • South Salt Lake, UT



Lisa Vandersteen
lisav@amsource.com
801.741.4530

