

Office/Retail Space For Lease



4605 Roswell Road
Atlanta, GA 30342

Property Highlights

- 5,114± sf for lease
 - 1st Floor/Basement- 4,062± sf available (3,212± sf & 850± sf)
 - 2nd Floor - 1,052± sf available
- Zoned OX - Office Mixed Use
- Lighted monument sign
- 34 parking spaces
- Corner lot with excellent visibility and access
- Conveniently located to Buckhead, I-285, GA 400, Chastain Park, and various other office, retail, and restaurant users
- 37,235 vpd on Roswell Road, south of site
- Lease rate: Negotiable
- Potential ground lease available - please inquire



Gray McWhirter
678.385.2722
gmm@mcwrealty.com

Justin Carswell
678.385.2715
jlc@mcwrealty.com

McWhirter Realty Partners, LLC
294 Interstate North Circle, SE
Building 2, Suite 150
Atlanta, GA 30339
770.955.2000
www.mcwrealty.com



McWhirter
Commercial Real Estate Since 1981

No warranty or representation, express or implied, is made as to the accuracy of the information contained herein, and same is subject to errors, omissions, change of price, rental or other conditions, withdrawal without notice, and to any special listing conditions, imposed by our principals.

4605 Roswell Road
Atlanta, GA 30342

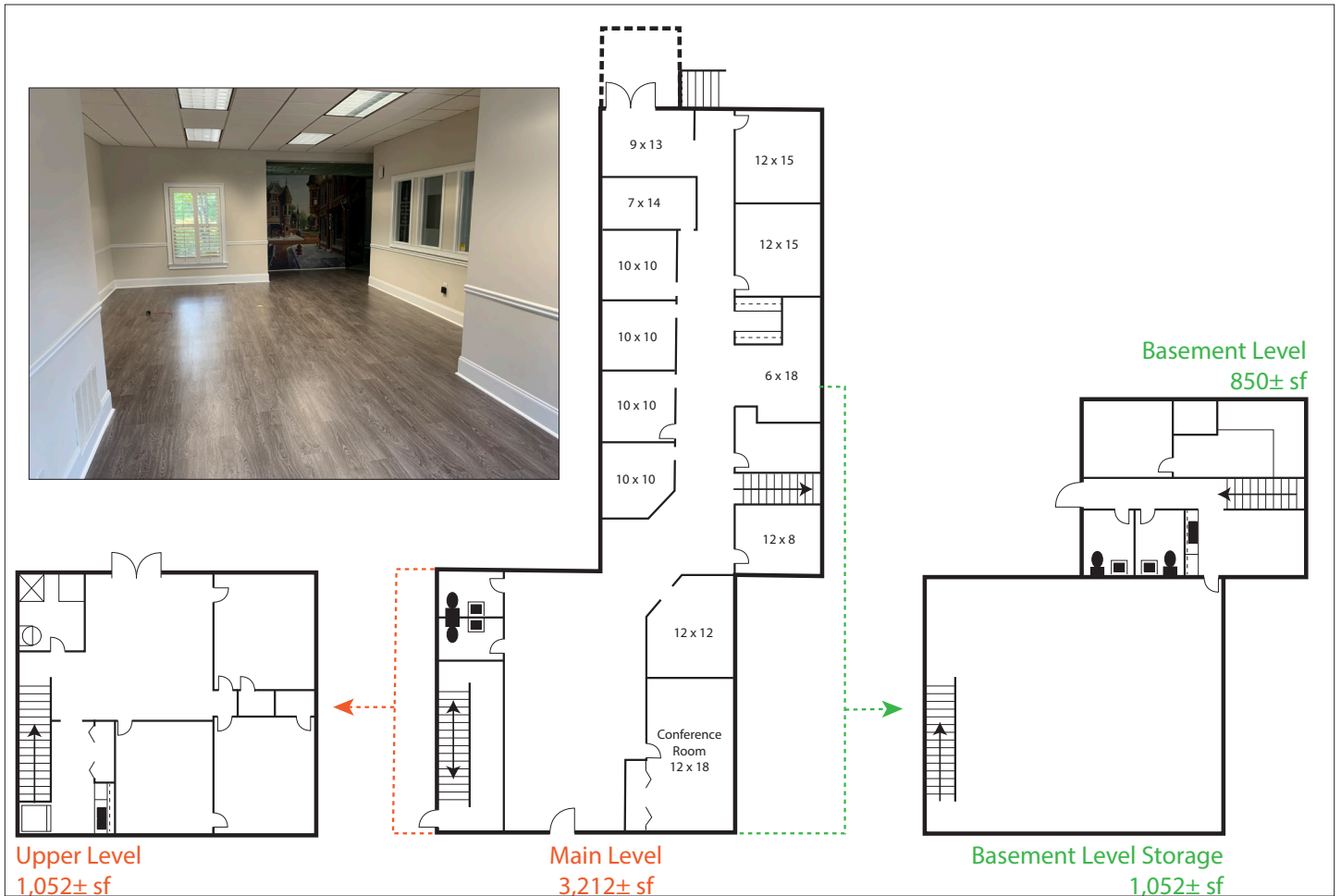

Gray McWhirter
678.385.2722
gmm@mcwrealty.com

Justin Carswell
678.385.2715
jlc@mcwrealty.com

McWhirter Realty Partners, LLC
294 Interstate North Circle, SE
Building 2, Suite 150
Atlanta, GA 30339
770.955.2000
www.mcwrealty.com



McWhirter
Commercial Real Estate Since 1981

No warranty or representation, express or implied, is made as to the accuracy of the information contained herein, and same is subject to errors, omissions, change of price, rental or other conditions, withdrawal without notice, and to any special listing conditions, imposed by our principals.

4605 Roswell Road
Atlanta, GA 30342



Gray McWhirter
678.385.2722
gmm@mcwrealty.com

Justin Carswell
678.385.2715
jlc@mcwrealty.com

McWhirter Realty Partners, LLC
294 Interstate North Circle, SE
Building 2, Suite 150
Atlanta, GA 30339
770.955.2000
www.mcwrealty.com



McWhirter
Commercial Real Estate Since 1981

No warranty or representation, express or implied, is made as to the accuracy of the information contained herein, and same is subject to errors, omissions, change of price, rental or other conditions, withdrawal without notice, and to any special listing conditions, imposed by our principals.

4605 Roswell Road
Atlanta, GA 30342

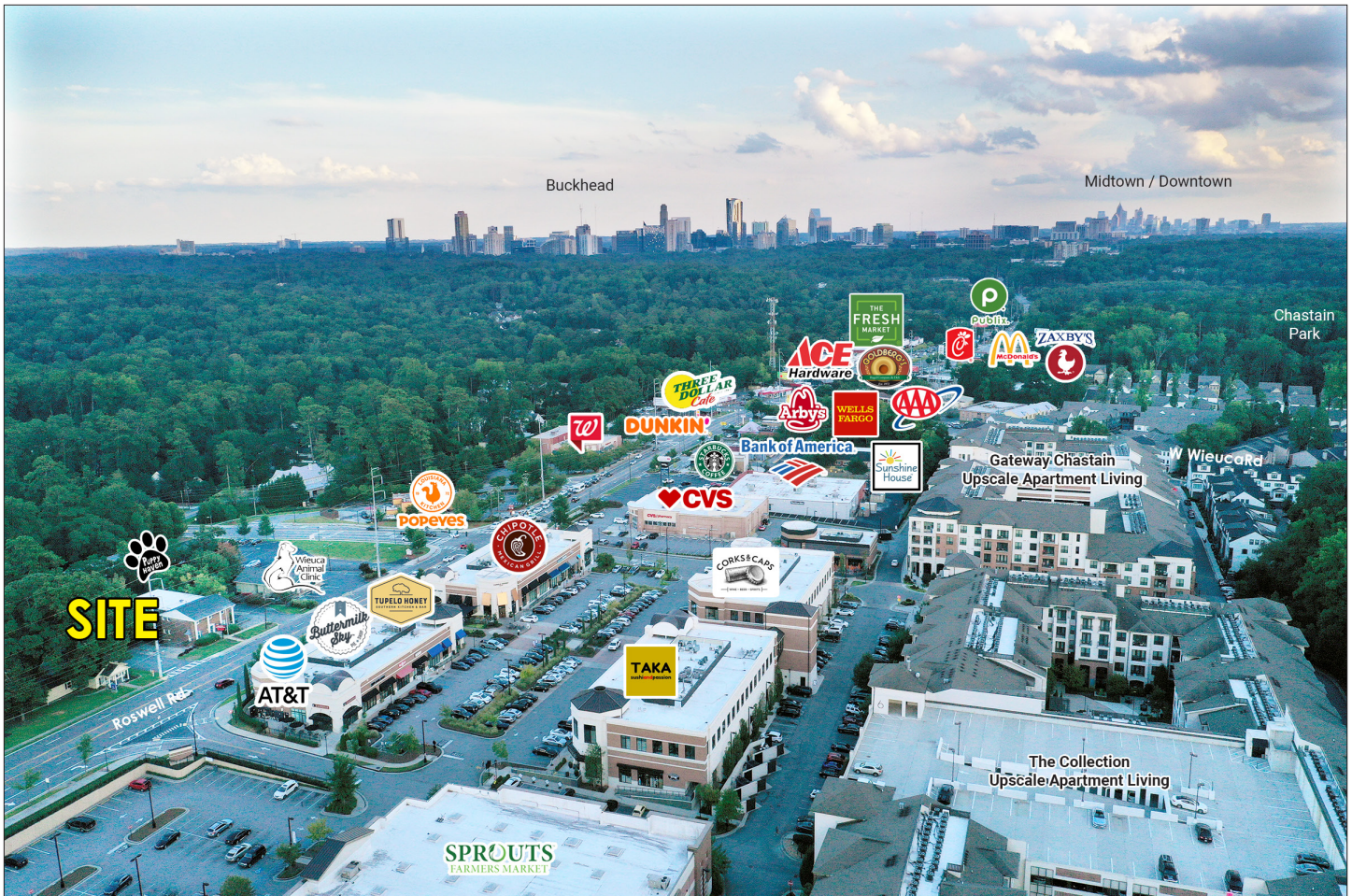

Demographics

	<u>1 mile</u>	<u>3 miles</u>	<u>5 miles</u>
<u>Population</u>			
2027 Projection	12,507	114,253	328,254
2022 Estimate	11,725	104,573	304,991
2010 Census	10,724	75,459	233,252
Daytime Employment	4,892	117,795	275,636
<u>Income</u>			
2022 Avg Household Income	\$161,017	\$151,350	\$136,599

Gray McWhirter
678.385.2722
gmm@mcwrealty.com

Justin Carswell
678.385.2715
jlc@mcwrealty.com

McWhirter Realty Partners, LLC
294 Interstate North Circle, SE
Building 2, Suite 150
Atlanta, GA 30339
770.955.2000
www.mcwrealty.com



McWhirter
Commercial Real Estate Since 1981

No warranty or representation, express or implied, is made as to the accuracy of the information contained herein, and same is subject to errors, omissions, change of price, rental or other conditions, withdrawal without notice, and to any special listing conditions, imposed by our principals.