



WOODCREST
CAPITAL, LLC

Freestanding Hwy 25
33554 State Highway 25 | Advance MO

LEASING
(817) 927-0050

Restaurant
Retail
Office
Medical

AVAILABLE
8,365 SF



- 8,365 SF Center
- Stoddard County, Missouri
- 2012 Construction
- Great Visibility & Access from State Hwy 25

Type	PSF
NNN's	TBD
Lease Rates	Call for Rates

Traffic Counts	
State Hwy 25	5,821 VPD
State Hwy C	2,118 VPD



Demographics	1-mile*	3-mile	5-mile
Population	1,541	2,136	2,595
Households	664	905	1,089
Average HH Income	\$61,412	\$63,813	\$63,406

* 1, 3, and 5 mile radius data provided by CoStar Group, 2023 dataset.

** Traffic Count (VPD) data provided by CoStar Group, 2022 dataset.

Woodcrest Capital, LLC
3113 South University Drive, Suite 600
Fort Worth, TX 76109

The information contained herein has been given to us by the owner of the property or other sources we deem reliable. We have no reason to doubt its accuracy, but we do not guarantee it. All information should be verified prior to purchase or lease.

(817) 927-0050 | woodcrestcapital.com

Freestanding Hwy 25

33554 State Highway 25 | Advance MO

Woodcrest Capital, LLC
3113 South University Drive, Suite 600
Fort Worth, TX 76109

FREESTANDING HWY 25 | Advance, Missouri

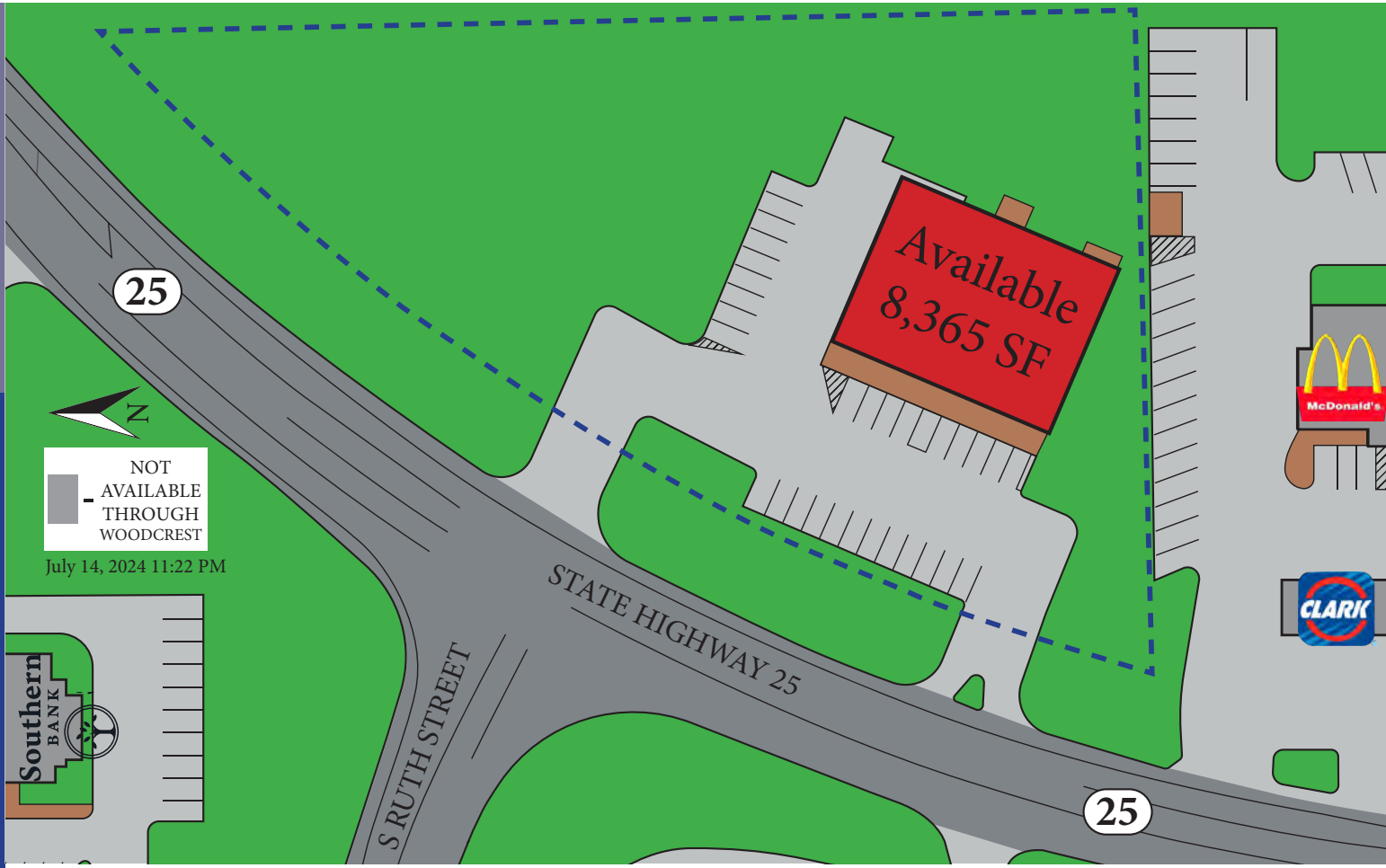

Traffic data by CoStar Group 2022 dataset. Map locations approximate

(817) 927-0050 | woodcrestcapital.com