

±53,393 SF

15 Dana Way | Ludlow, MA



±53,393 SF - Industrial Building

15 Dana Way | Ludlow, MA

For Lease

Property Specifications

- + **Total SF:** ±53,393 SF
- + **Available SF:** ±53,393 SF
- + **Ceiling Height:** 14' clear
- + **Land:** 6.6 acres
- + **Parking:** 108 cars
17 trailers
- + **Zoning:** Industrial A
- + **Loading Docks:** Three (3)
- + **Drive-in Doors:** Two (2)
- + **Sprinkler:** Wet
- + **Power:** 4,000 amp, 120/208-volt
- + **Lighting:** Fluorescent
- + **Water:** Town of Ludlow, 8" main
- + **Sewer:** Town of Ludlow, 4" main
- + **Electric:** Eversource
- + **Gas:** Eversource
- + **Lease Rate:** \$6.95/SF NNN
- + **Location:** 2.2 miles to I-291 and Mass Pike
- + **Comments:** Manufacturing space

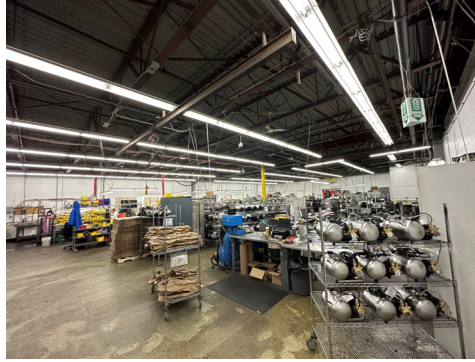

Floor Plan

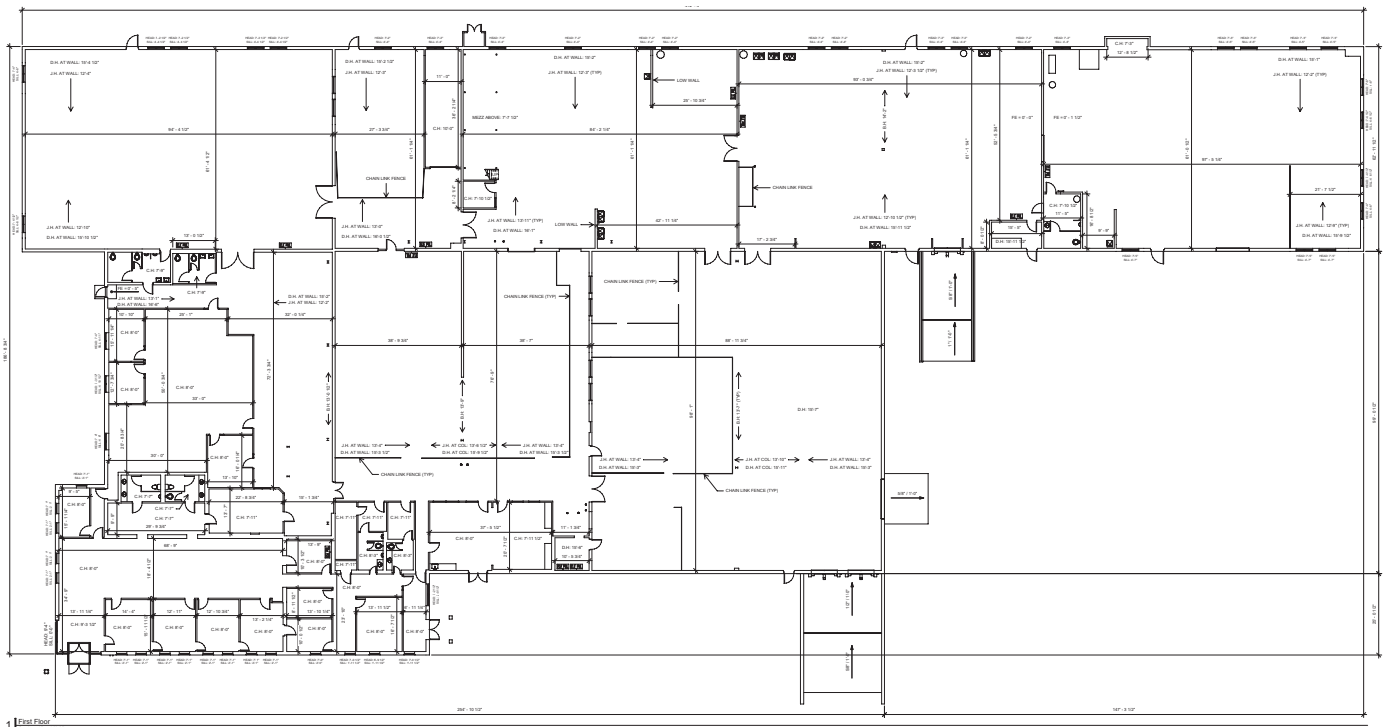

±53,393 SF - Industrial Building

15 Dana Way | Ludlow, MA

For Lease

Location Map

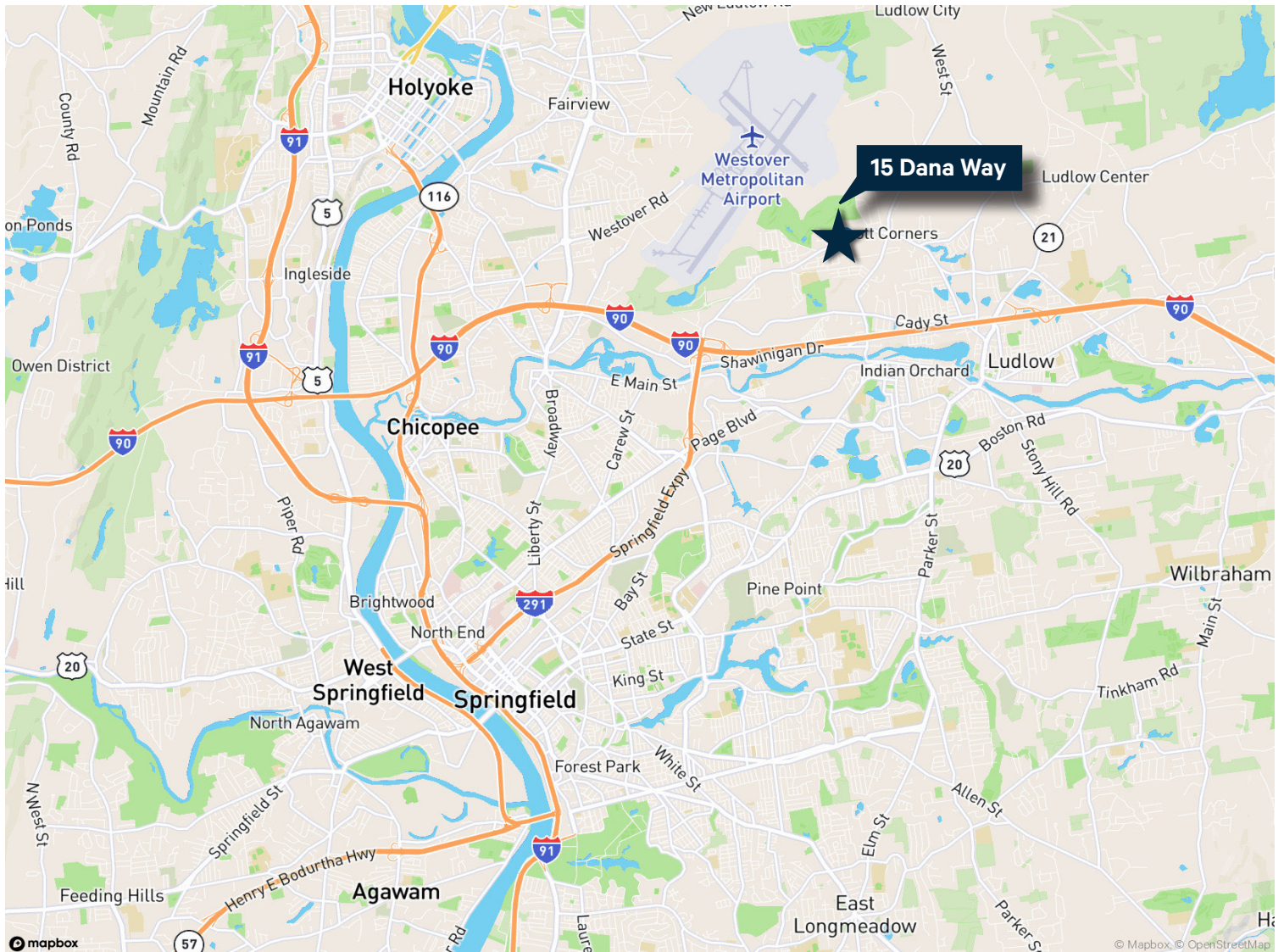

Contact Us

John Reed

Senior Vice President

+1 413 732 9150

+1 860 559 1562 (c)

john.reed@cbre.com

Jack Reed

Vice President

+1 860 987 4789

+1 860 716 8493 (c)

jack.reed@cbre.com

© 2024 CBRE, Inc. All rights reserved. This information has been obtained from sources believed reliable but has not been verified for accuracy or completeness. CBRE, Inc. makes no guarantee, representation or warranty and accepts no responsibility or liability as to the accuracy, completeness, or reliability of the information contained herein. You should conduct a careful, independent investigation of the property and verify all information. Any reliance on this information is solely at your own risk. CBRE and the CBRE logo are service marks of CBRE, Inc. All other marks displayed on this document are the property of their respective owners, and the use of such marks does not imply any affiliation with or endorsement of CBRE. Photos herein are the property of their respective owners. Use of these images without the express written consent of the owner is prohibited.