

NORTH PARK

Build-to-Suit Maintenance Facilities

St. Louis, MO 63134

FOR SALE OR LEASE

**5,000 - 20,000 SF PROPOSED
MAINTENANCE FACILITIES**

State of Missouri Super TIF
Opportunity Zone



Jones Lang LaSalle Americas, Inc. a licensed real estate broker in 48 states



PROPERTY OVERVIEW

Vehicle maintenance facility options available from 5,000 to 20,000 SF (or more) with immediate access to I-70 and I-170 immediately adjacent to St. Louis Lambert International Airport. NorthPark is within a 10 minute drive of Downtown, St. Charles, and the Metro East. Developer owner will sell land sites, build-to-suit for lease or ownership. Complete spectrum of design and construction services available.

POTENTIAL BUILDING SIZES: 5,000 - 20,000 SF

TRAILER/TRUCK STORAGE: Up to 8 acres available

CLEAR HEIGHT: To suit; 24'-30' clear possible

LOADING: Drive-through facility

VISIBILITY: Over 2 miles of interstate frontage

SITE PLAN



FACILITY OPTIONS

OPTION

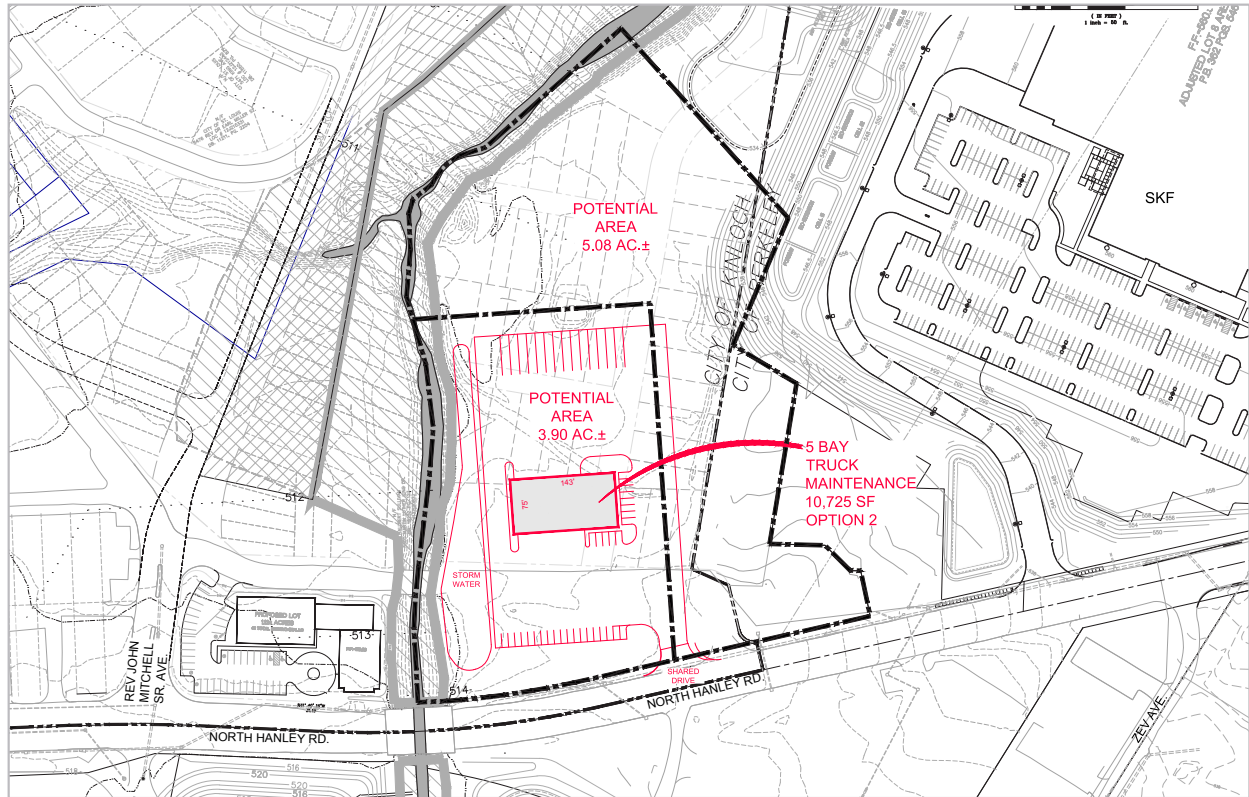

PROPOSED FACILITY RENDERING



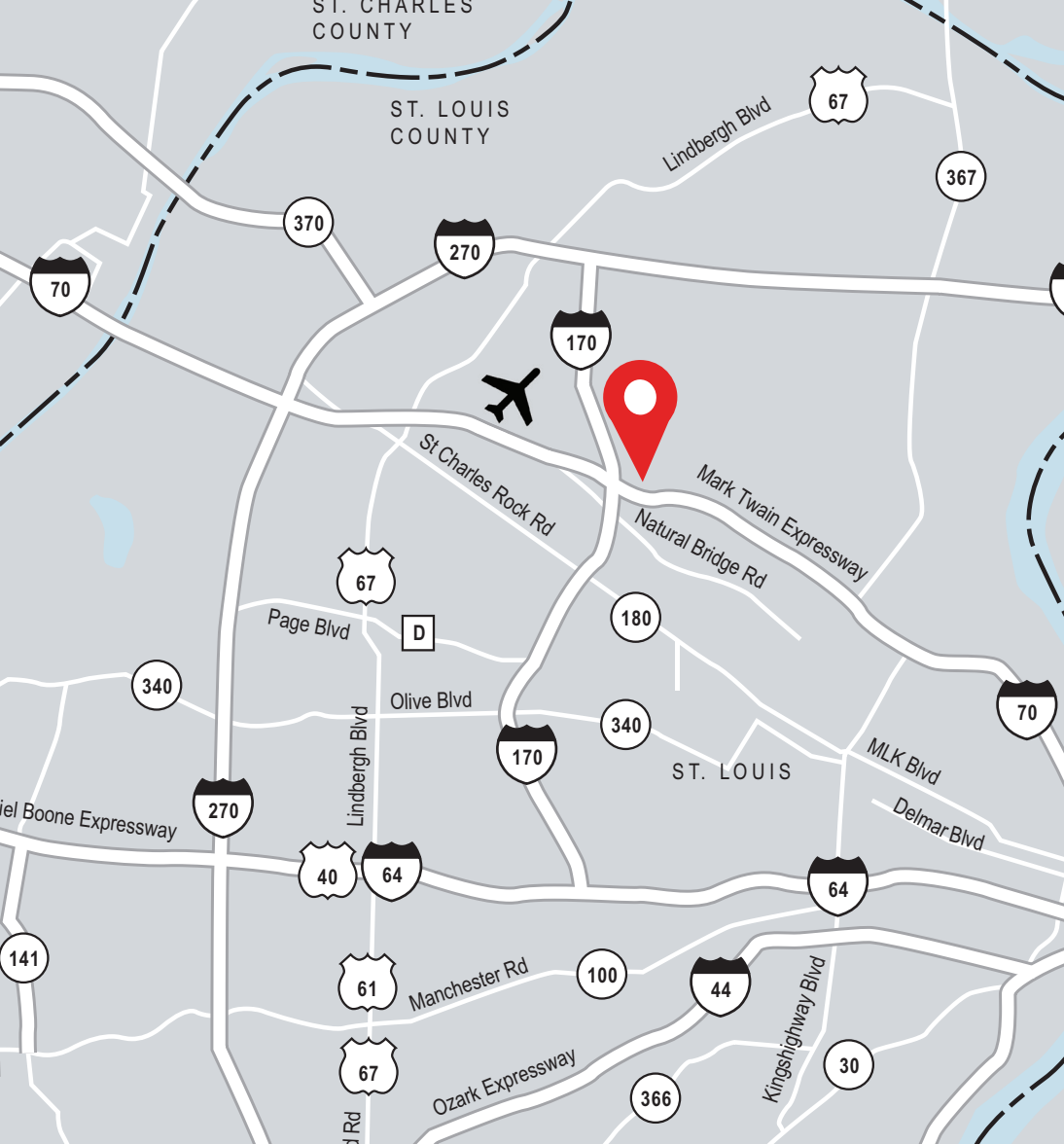

NORTHPARK MAINTENANCE FACILITY

LOCATION:

On I-70 at I-170;
Less than 3 miles from
I-270 and 9 miles from
I-64/40

NORTHPARK

An established hub of commerce

+ 44.246 total acres

+ \$300M Capital invested

+ 2.7M SF developed

+ 5,000 + jobs created

Pat Reilly, SIOR
+1 314 338 2085
patrick.reilly@am.jll.com

Chris Schmidt
+1 314 261 7378
chris.schmidt@am.jll.com

jll.com/st-louis
+1 314 338 2080

Jones Lang LaSalle Americas, Inc.,
a licensed real estate broker in 48 states

DISCLAIMER Although information has been obtained from sources deemed reliable, neither Owner nor JLL makes any guarantees, warranties or representations, express or implied, as to the completeness or accuracy as to the information contained herein. Any projections, opinions, assumptions or estimates used are for example only. There may be differences between projected and actual results, and those differences may be material. The Property may be withdrawn without notice. Neither Owner nor JLL accepts any liability for any loss or damage suffered by any party resulting from reliance on this information. If the recipient of this information has signed a confidentiality agreement regarding this matter, this information is subject to the terms of that agreement. ©2021. Jones Lang LaSalle IP, Inc. All rights reserved.

