

**SINVIN**  
COMMERCIAL REAL ESTATE & ADVISORY

**MADDOX**  
RETAIL

# 262 MOTT STREET

Rare Opportunity To Have Retail, Showroom  
And Office All On One Level





## DETAILS:

Ground Level.....**2,526 Square Feet**  
 Frontage.....**20'**  
 Ceiling Height.....**Approx. 10'**  
 Term.....**Negotiable**  
 Possession.....**Immediate**  
 Asking Rent.....**Please Inquire**

## NOTES:

- Elegant arched storefront on charming Nolita block
- Turnkey store with high-end finishes including custom flooring
- Large format space is ideal for combining retail and showroom
- Great natural light from two exposures
- Open kitchen for entertaining
- Two independent HVAC systems
- Fully alarmed





## NEIGHBORS INCLUDE:

- At The Venue
- Juice Press
- Milk Bar
- Diptyque
- Everlane
- Lunya
- Ba&sh
- Buck Mason
- Le Labo

**SINVIN**  
COMMERCIAL REAL ESTATE & ADVISORY

**MADDOX**  
RETAIL

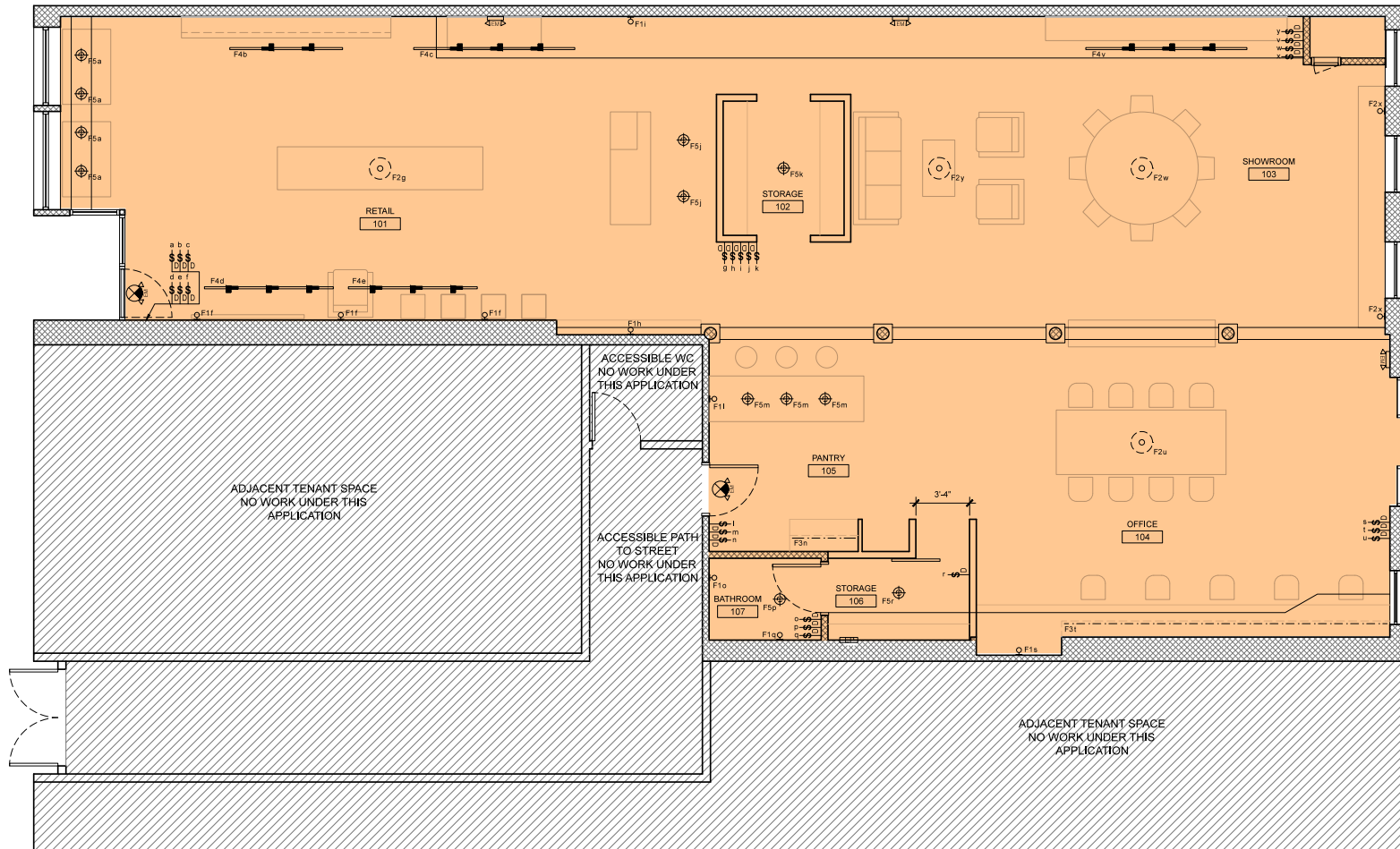

PLEASE CONTACT:

Christopher Owles

212.604.9002

chris@sinvin.com



Arian Ahmadian

212.804.8870

arian@maddoxretail.com



262  
MOTT  
STREET

