

1420 Stoneridge Drive

Middletown, PA

Key Facts

Building type	Industrial space
---------------	------------------

Building size	66,959 SF
---------------	-----------

Space available	19,350 SF
-----------------	-----------



Contact Us

Learn more about this property or schedule a tour by reaching out to our local investment and leasing officer.

Eli Gurwitz

+1 (267) 431-2495

eli.gurwitz@eqtpartners.com

1420 Stoneridge Drive

Middletown, PA

Building Specifications

Total Available: 19,350 SF

Office: 1,828 SF

Storage: 17,522 SF

Clear Height: 24'

Dock Doors: 3

Levelers: 3

Drive-in Door: 1

Parking Spaces: 28

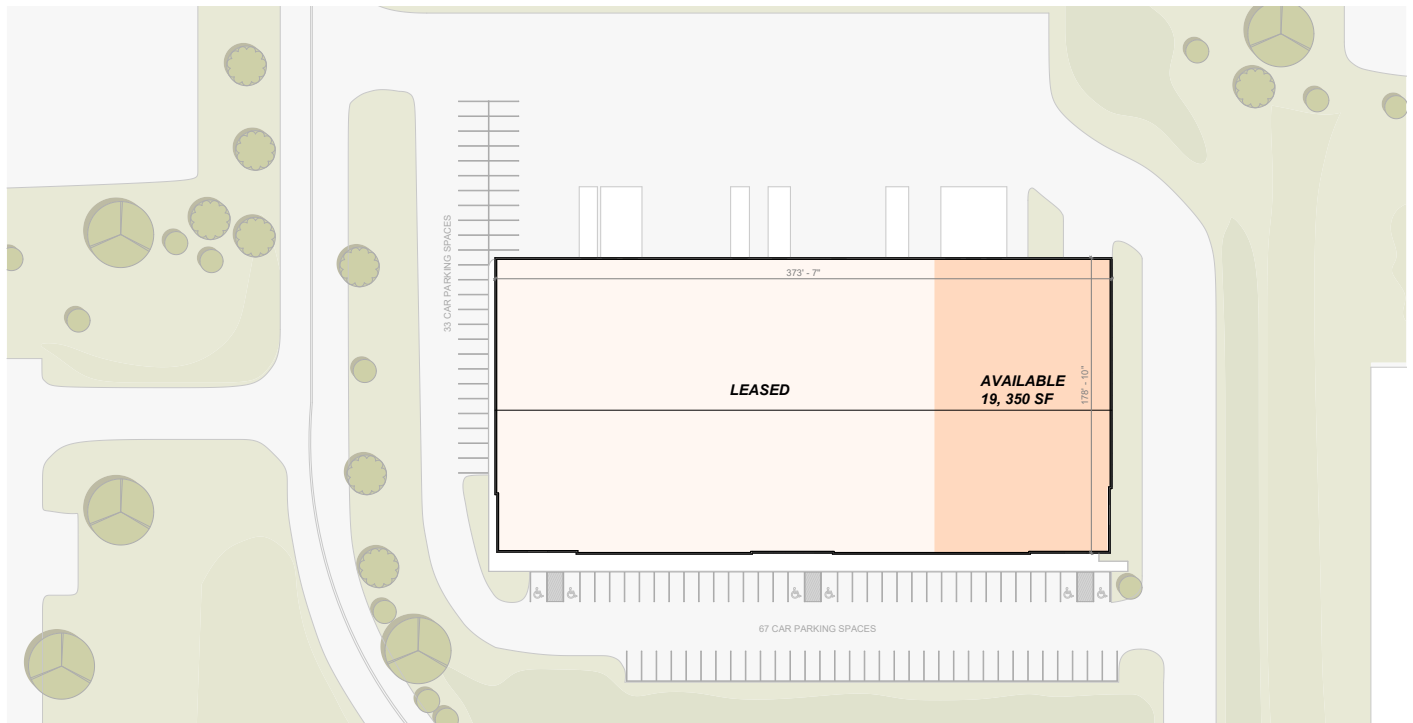

Contact Us

Learn more about this property or schedule a tour by reaching out to our local investment and leasing officer.

Eli Gurwitz

+1 (267) 431-2495

eli.gurwitz@eqtpartners.com

1420 Stoneridge Drive

Middletown, PA

Floor Plan

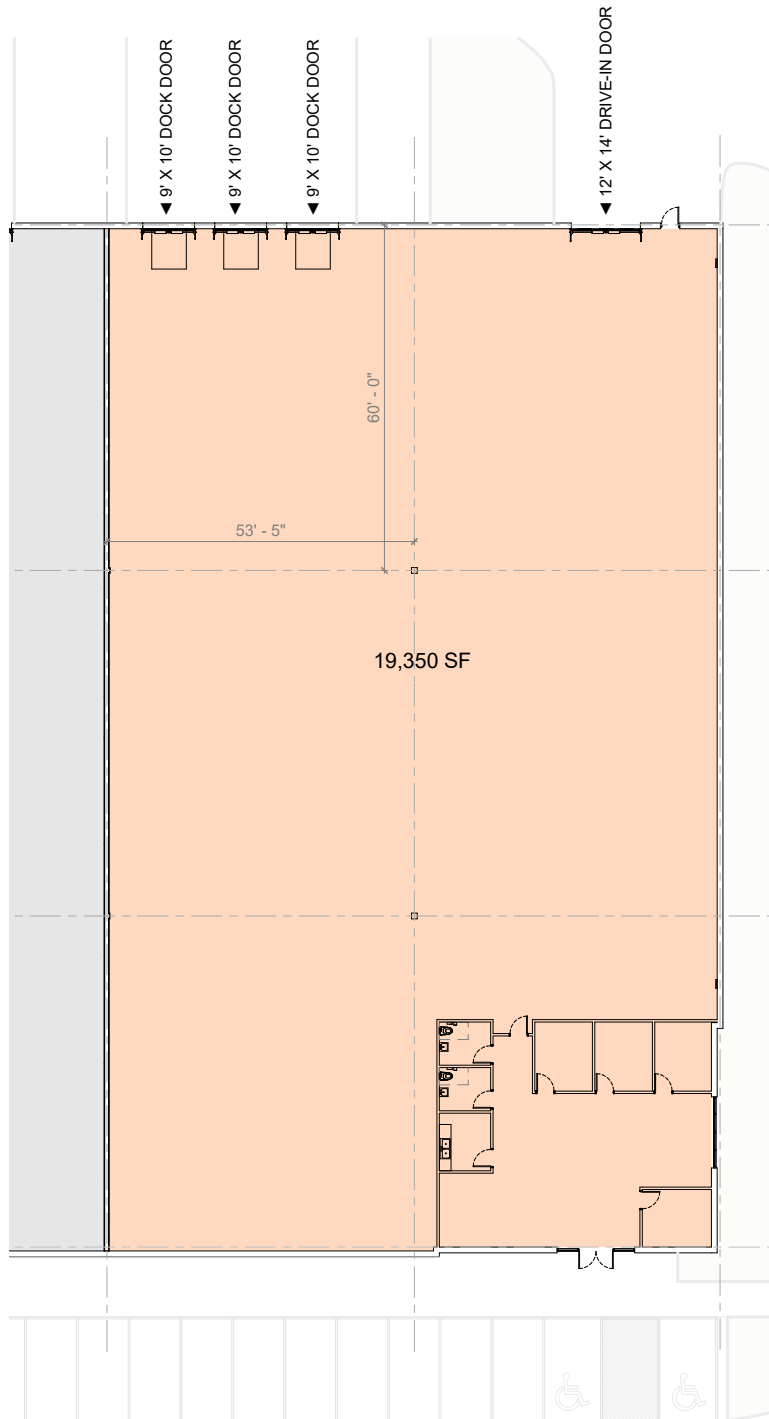

Contact Us

Learn more about this property or schedule a tour by reaching out to our local investment and leasing officer.

Eli Gurwitz

+1 (267) 431-2495

eli.gurwitz@eqtpartners.com

1420 Stoneridge Drive

Middletown, PA

Location

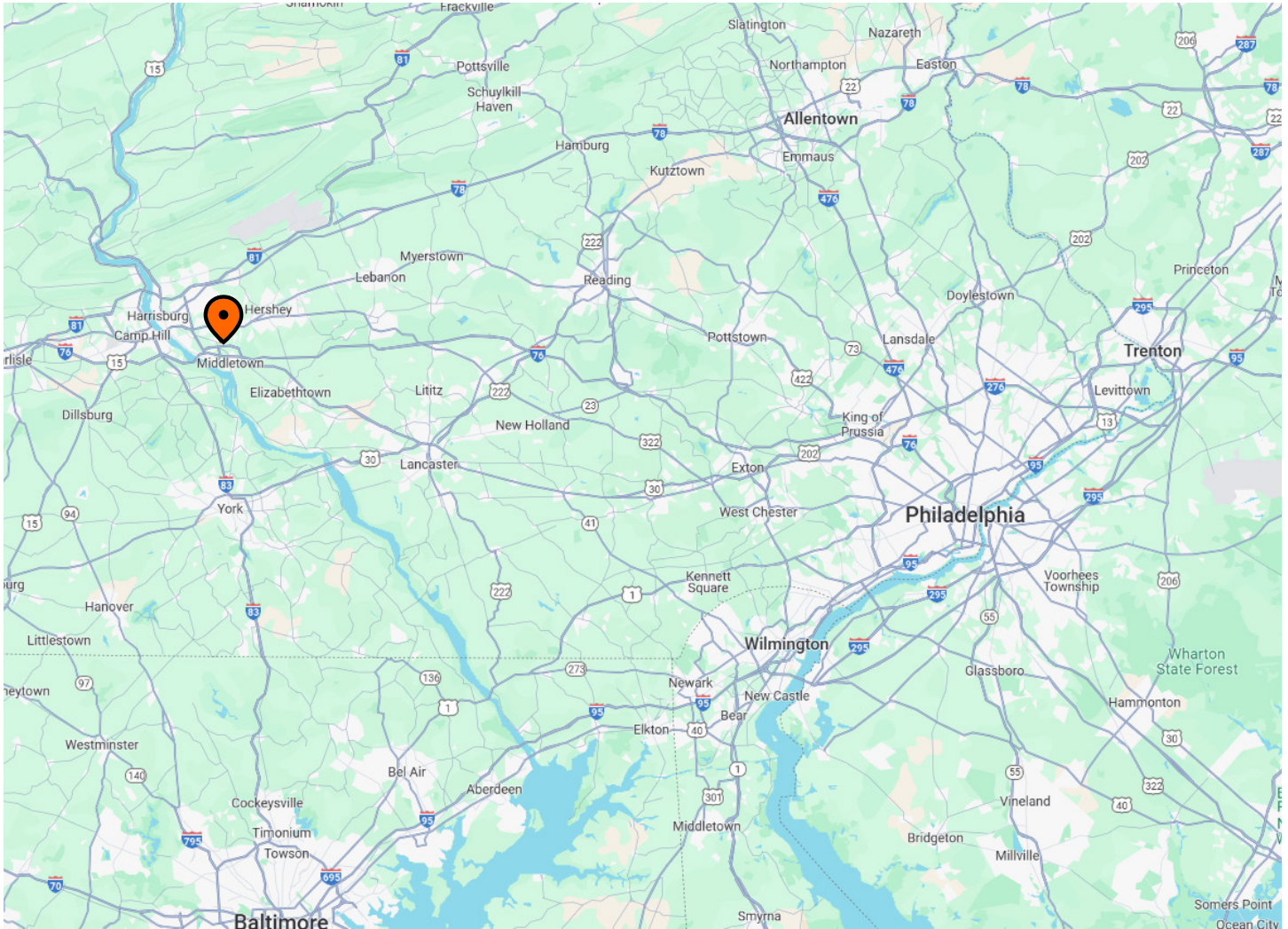

Contact Us

Learn more about this property or schedule a tour by reaching out to our local investment and leasing officer.

Eli Gurwitz

+1 (267) 431-2495

eli.gurwitz@eqtpartners.com