

153 GRAND STREET

BETWEEN BEDFORD AVENUE & BERRY STREET | WILLIAMSBURG



GUAC TIME

Mexican Grill



153

TURNKEY VENTED RESTAURANT FOR LEASE



153 GRAND STREET

BETWEEN BEDFORD AVENUE & BERRY STREET | WILLIAMSBURG

PROPERTY HIGHLIGHTS

- Currently Guac Time
- Fully built QSR / fast food setup
- Existing gas line in place
- Located in the busy Williamsburg corridor with steady day and evening traffic
- Dense mix of students, residents, & professionals in the area
- Neighbors include:
Supreme, Foodtown, Duane Reade, Sephora, Whole Foods, Bon Bon, by Chloe & many more!

SIZE: 1,750 SF Ground Floor
1,750 SF Basement

FRONTAGE: 20'

CEILING HEIGHT: 10'

POSSESSION: Immediate

ASKING RENT: Upon Request

TRANSPORTATION: 

FLOOR PLANS:

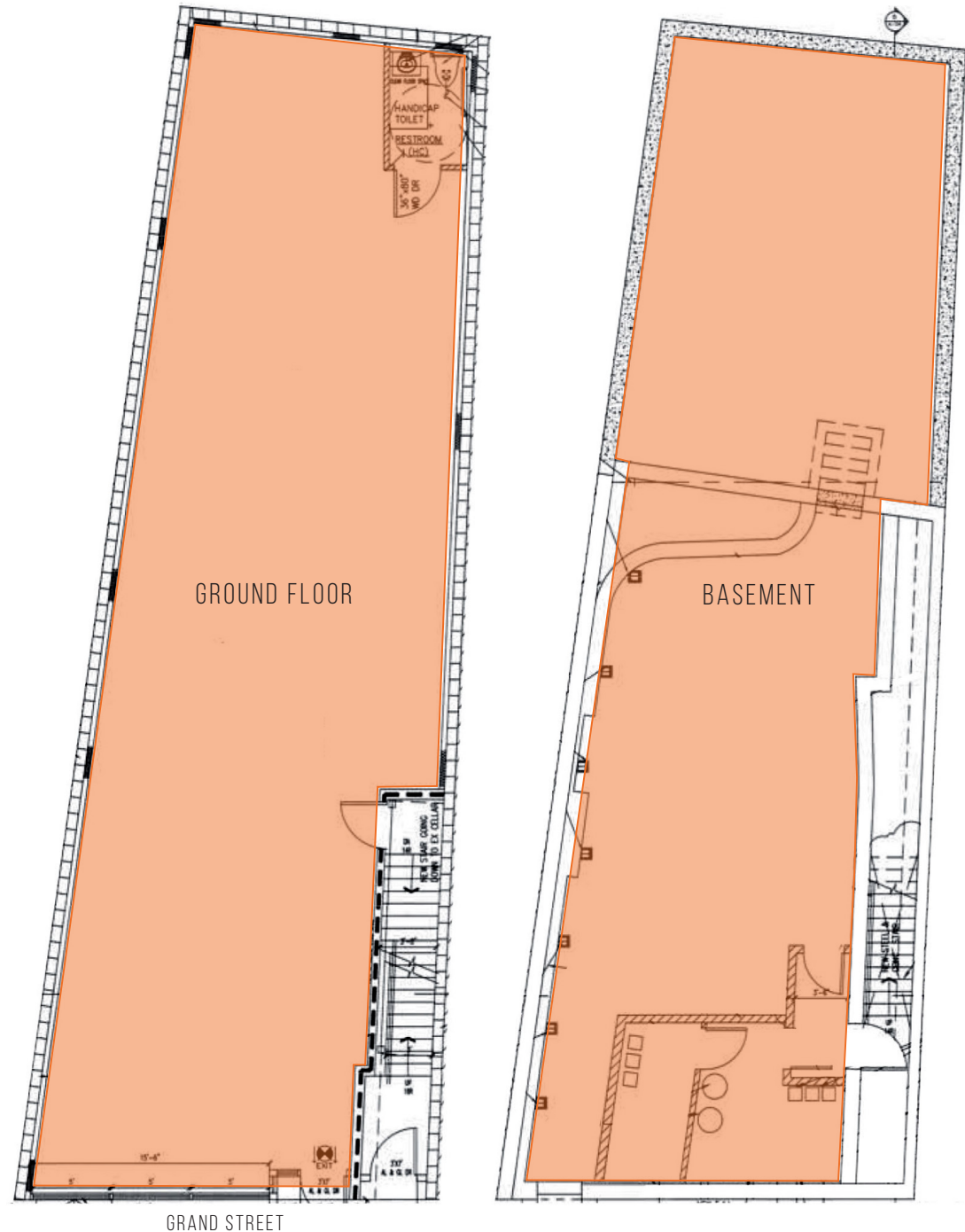

153 GRAND STREET

BETWEEN BEDFORD AVENUE & BERRY STREET | WILLIAMSBURG

INTERIORS:



All information supplied in this marketing presentation and/or flyer is from sources deemed reliable and is furnished subject to errors, omissions, modifications, removal of listings from sale/lease and to any listing condition. Any square footage, dimensions, floor plans and/or technical data set forth are approximations and are subject to further elaboration/confirmation.

BETWEEN BEDFORD AVENUE & BERRY STREET | WILLIAMSBURG

This aerial map of Lower Manhattan features numerous callouts for businesses and transit stations. A yellow star with a line points to a specific location in the Financial District. The callouts include:

- Transit Stations:**
 - BEDFORD AVE STATION:** 8,764,921 RIDERS ANNUALLY
 - MARCY AVE STATION:** 2,864,396 RIDERS ANNUALLY
- Businesses and Landmarks:**
 - 1 DOMINO SQUARE:** 560 UNITS
 - 53 BROADWAY:** 85 UNITS
 - WILLIAMSBURG BRIDGE**
 - Logos:** Trader Joe's, Nordstrom, Penny, Whole Foods, Levain Bakery, CAVA, DR., Just Cooking, SLT, Apple, Devoción, Salt & Charcoal, Aurora, Vice, 12 Chairs Cafe, The Refinery, Michelob's, Freehold, Brooklyn Opera House, Oslo, Fucos, Misi, ByNext, Aska, Taqueria, KEG & LANTERN, Moxy, Pies & Thighs, Continental Army Plaza, Holo, City Acres Market, Hands of Hope, Marlow & Sons, Motorino, Meadowsweet, Peter Fuger, McDonald's, Blink, Industrie Pizzeria, Round Table Brewery, Peccole, and Round Table.

153 GRAND STREET

BETWEEN BEDFORD AVENUE & BERRY STREET | WILLIAMSBURG

FOR MORE INFORMATION,
PLEASE CONTACT:

JORDAN RAPHAN

516.776.4771 | JRaphan@ksrny.com

AKRAM MOZEB

646.897.4792 | AMozeb@ksrny.com

ALBERT MANOPLA

212.380.8369 | AManopla@ksrny.com

