

# SOCO HARBOR

3601, 3611, 3621 & 3631 S. HARBOR BLVD. | SANTA ANA, CA

FOR LEASE

1,600 SF to 12,000 SF



Long and Short-Term Available



HARBOR

## PROPERTY HIGHLIGHTS

- 150,189 RSF, 2-story, 4-building, Class B high quality office complex
- Elevator served
- Located in the dynamic SOCO micro-market
- Campus style environment, beautiful park-like grounds with extensive landscaping and free surface parking
- Award winning design and architecture
- Extensive glass lines
- Options for indoor/outdoor patios on select ground floor spaces
- Close proximity to John Wayne Airport, restaurants, hotels and other retail amenities
- 2 Blocks from the I-405



SOCO



**4** MINUTES TO SOCO/THE OC MIX

**<10** MINUTES TO SOUTH COAST PLAZA, THE LAB, THE CAMP & OTHER LOCAL RETAIL

**10** MINUTES TO JOHN WAYNE AIRPORT



3601, 3611, 3621 & 3631

# SOUTH HARBOR BOULEVARD

santa ana, ca

Contact  
SOCO Harbor

[info@socoharbor.com](mailto:info@socoharbor.com)

Phone: (657) 325 8400

**On-site Management**

# SOCO HARBOR

3621 S. HARBOR BLVD | SANTA ANA, CA



**1**  
First Floor

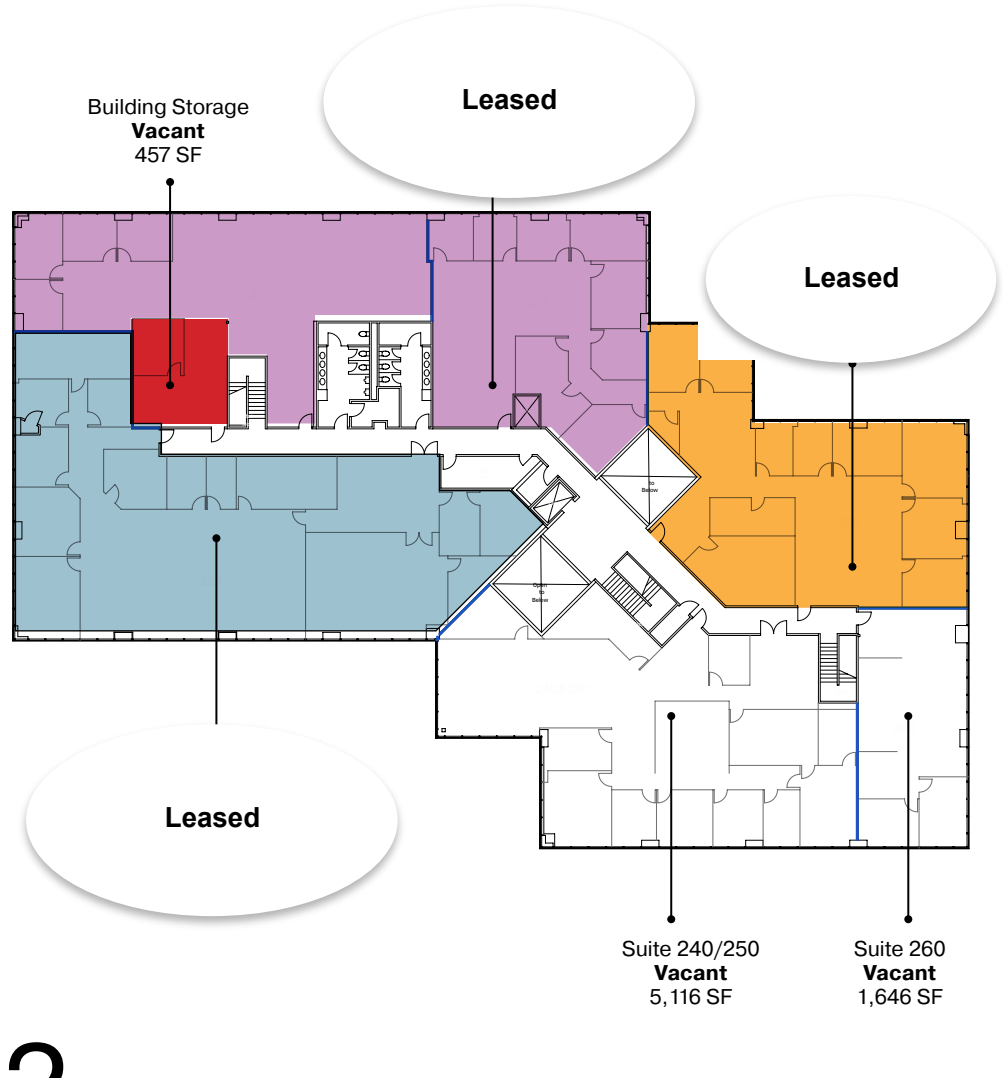

**2**  
Second Floor

Vacant	2025	2026	2027	2028	2029	2030+	MTM	CRHS
--------	------	------	------	------	------	-------	-----	------