

AVAILABLE FOR LEASE

720 FRONT STREET, SANTA CRUZ

CLASS A OFFICE SPACE FOR SUBLEASE DOWNTOWN SANTA CRUZ

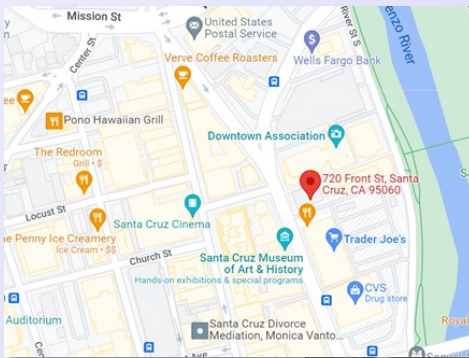

- 5,760 SF
- ONE OF THE HIGHEST QUALITY OFFICE SPACES IN DOWNTOWN SANTA CRUZ
- 9 PRIVATE OFFICES, 3 CONFERENCE ROOMS AND 34 WORKSTATIONS
- KITCHEN, PRIVATE RESTROOMS
- 11 DEDICATED PARKING SPACES
- \$1.75/NNN
- SUBLEASE THROUGH 12/31/2028
- EASY ACCESS TO ALL DOWNTOWN AMENITIES
- EASY ACCESS TO HIGHWAYS 1 and 17
- LOCATED IN THE HEART OF THE DOWNTOWN BUSINESS CORRIDOR

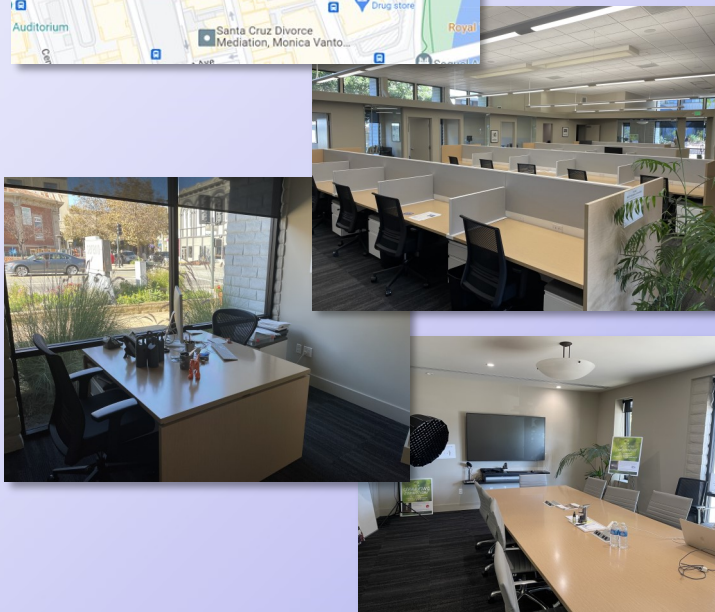

JIM WISEMAN

831-818-5454

DRE #01104278

jwiseman@sheldonwiseman.com

STEVEN SHELDON

831-818-0800

DRE #10208650

ssheldon@sheldonwiseman.com



While the information contained herein is deemed reliable, we cannot guarantee its accuracy. All information should be verified.

1200 Pacific Avenue, Suite 390 ■ Santa Cruz, CA 95060
Tel: 831 • 454 • 9400 ■ Fax: 831 • 459 • 7988 ■ www.sheldonwiseman.com

INTEGRITY ■ SERVICE ■ RESULTS

FLOOR PLAN

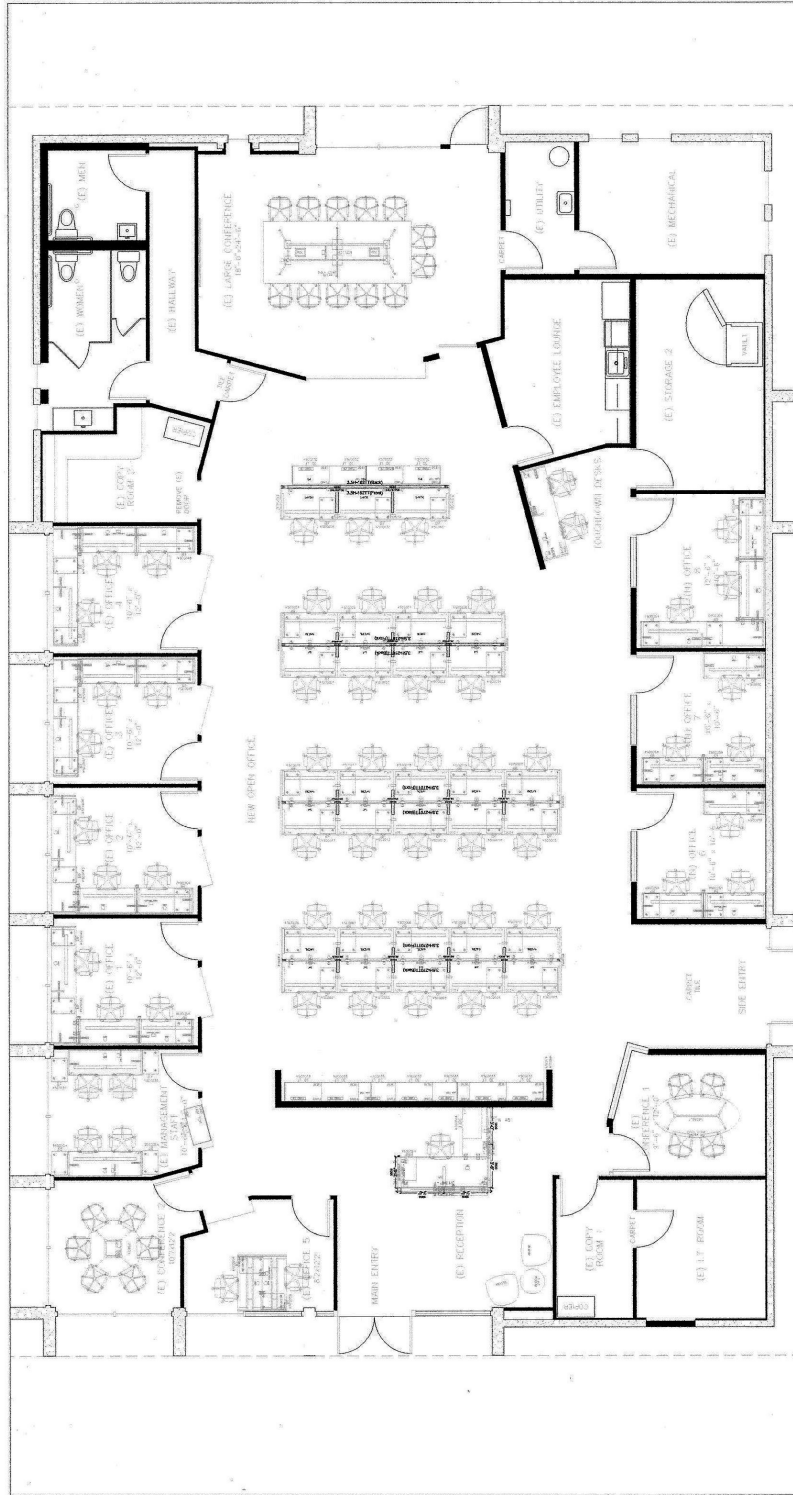

DATE	2018.11.28	REVISION
JOB #		
SCALE	NIS	
SHEET	1 OF 1	
DRAWN BY	P. SANTOS	

T. 916.674.1500
F. 408.769.3549

SERENO GROUP
FRONT STREET, SANTA CRUZ, CA
PROPOSED FURNITURE PLAN, REVISION

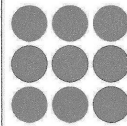

While the information contained herein is deemed reliable, we cannot guarantee its accuracy. All information should be verified.

INTEGRITY ■ SERVICE ■ RESULTS

