

FOR LEASE | Flemington Trade Center | 23 Royal Road | Flemington, NJ 08822

# 670-2,170 SF CLASS A OFFICE SUITES



## PROPERTY HIGHLIGHTS

- **Building:** Class A Office Building with 29,000 SF total
- **Year Built:** 2005
- **Availability:** Suite 201 (1,500 SF) and Suite 203 (670 SF) - can be combined
- **Suite 201** includes 3 offices, conference room and reception area
- **Suite 203** includes a large office/conference room and reception area
- Available in 30 days
- **Lease Rate:** \$24.75 SF gross
- **Amenities:** Beautifully appointed lobbies, elevator, spiral staircase, conference/training facilities, cafeteria-kitchen with outdoor seating and secure building access
- Abundant parking
- **Location:** This building is located just north of Church Street between Routes 202 and 31, minutes from shopping, restaurants and downtown

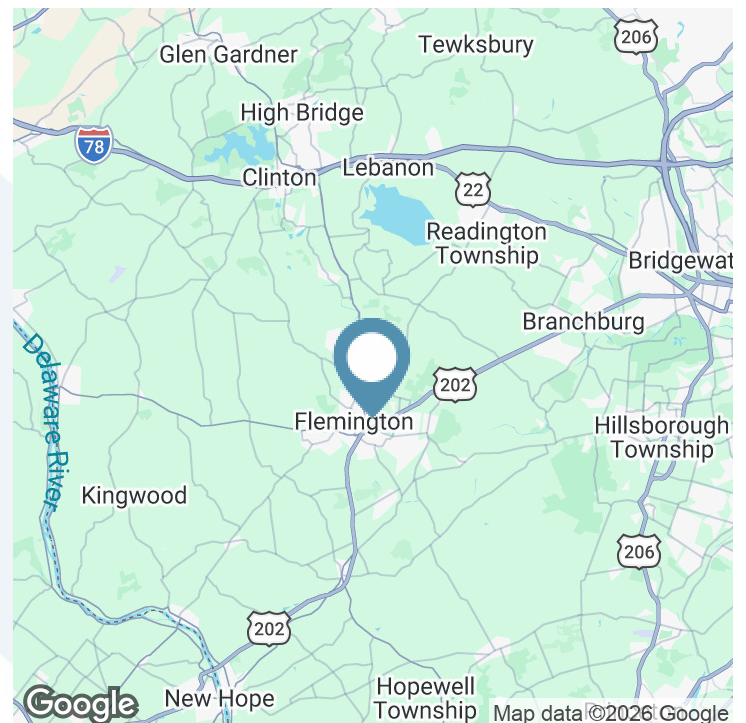

**SARA SOLIMAN**

Vice President  
908.360.8051  
ssoliman@kislakrealty.com

Kislak Commercial Real Estate Services, Inc.  
10 Woodbridge Center Drive, Suite 701  
Woodbridge, NJ 07095  
908.360.8050 | kislakrealty.com

Flemington Trade Center | 23 Royal Road | Flemington, NJ 08822

# COMMON AREAS



**SARA SOLIMAN**  
Vice President  
908.360.8051  
[ssoliman@kislakrealty.com](mailto:ssoliman@kislakrealty.com)

Kislak Commercial Real Estate Services, Inc.  
10 Woodbridge Center Drive, Suite 701  
Woodbridge, NJ 07095  
908.360.8050 | [kislakrealty.com](http://kislakrealty.com)

Flemington Trade Center | 23 Royal Road | Flemington, NJ 08822

# SUITE 201



**SARA SOLIMAN**  
Vice President  
908.360.8051  
ssoliman@kislakrealty.com

Kislak Commercial Real Estate Services, Inc.  
10 Woodbridge Center Drive, Suite 701  
Woodbridge, NJ 07095  
908.360.8050 | kislakrealty.com

Flemington Trade Center | 23 Royal Road | Flemington, NJ 08822

# SUITE 203



**SARA SOLIMAN**  
Vice President  
908.360.8051  
[ssoliman@kislakrealty.com](mailto:ssoliman@kislakrealty.com)

Kislak Commercial Real Estate Services, Inc.  
10 Woodbridge Center Drive, Suite 701  
Woodbridge, NJ 07095  
908.360.8050 | [kislakrealty.com](http://kislakrealty.com)

# FLOOR PLAN

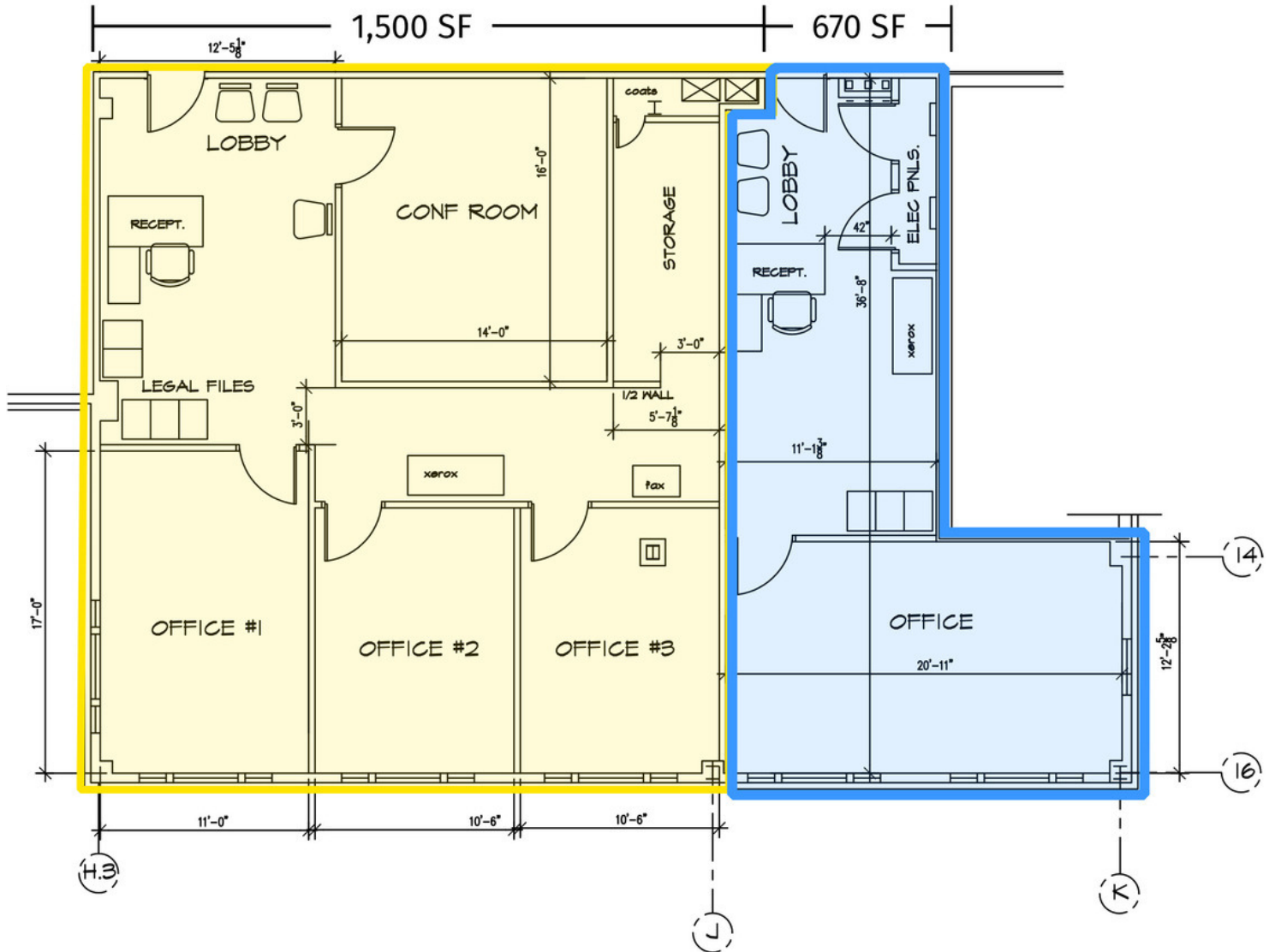

## EXISTING SECOND FLOOR PLAN- NEW OFFICES Concept Plan#1 (2,170 SF)

SCALE : 1/8" = 1'-0"

12-18-09

**SARA SOLIMAN**  
Vice President  
908.360.8051  
ssoliman@kislakrealty.com

Kislak Commercial Real Estate Services, Inc.  
10 Woodbridge Center Drive, Suite 701  
Woodbridge, NJ 07095  
908.360.8050 | kislakrealty.com